

STREET RETAIL/RESTAURANT/MIXED-USE

2053 FREDERICK DOUGLASS BLVD

Between West 111th and 112th Streets

HARLEM

MANHATTAN | NY

Approx.

1,375 SF

For Lease



RIPCO
REAL ESTATE

SPACE DETAILS

GROUND FLOOR

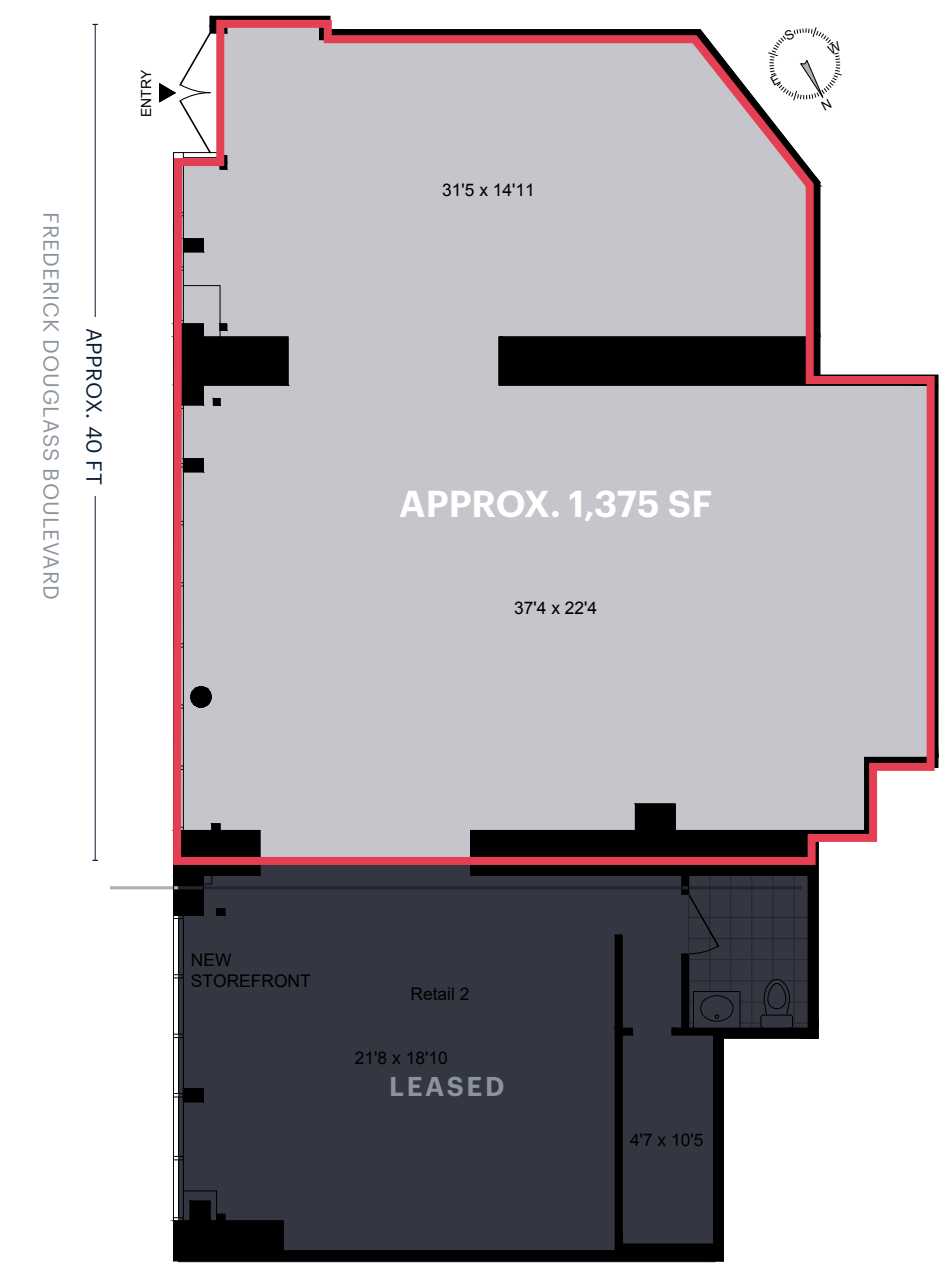

LOCATION

West side of Frederick Douglass Boulevard between West 111th and 112th Streets

SIZE

Ground Floor Approx. 1,375 SF

FRONTAGE

Frederick Douglass Blvd Approx. 40 FT

NEIGHBORS

Blvd Bistro, 67 Orange, Melba's Restaurant, Row House, Paint N' Pour, Tribeca Pediatrics, Citizens Bank, Catina Taqueria & Tequila Bar, Cafe Amrita, Paw Country Club

COMMENTS

Can be vented for restaurant use

Located on Frederick Douglass Blvd, also known as Harlem's Restaurant Row

Steps from 110th Street/Cathedral Pkwy B, C Subway Station

HVAC in place

One Block from the NWC of Central Park

TRANSPORTATION

2019 Ridership Report

110th Street/
Cathedral Pkwy

Annual	2,396,624
Weekday	7,382
Weekend	9,539



M3

Annual	4,032,735
Weekday	12,516
Weekend	15,554



M10

Annual	6,597,695
Weekday	20,579
Weekend	24,912



AREA RETAIL

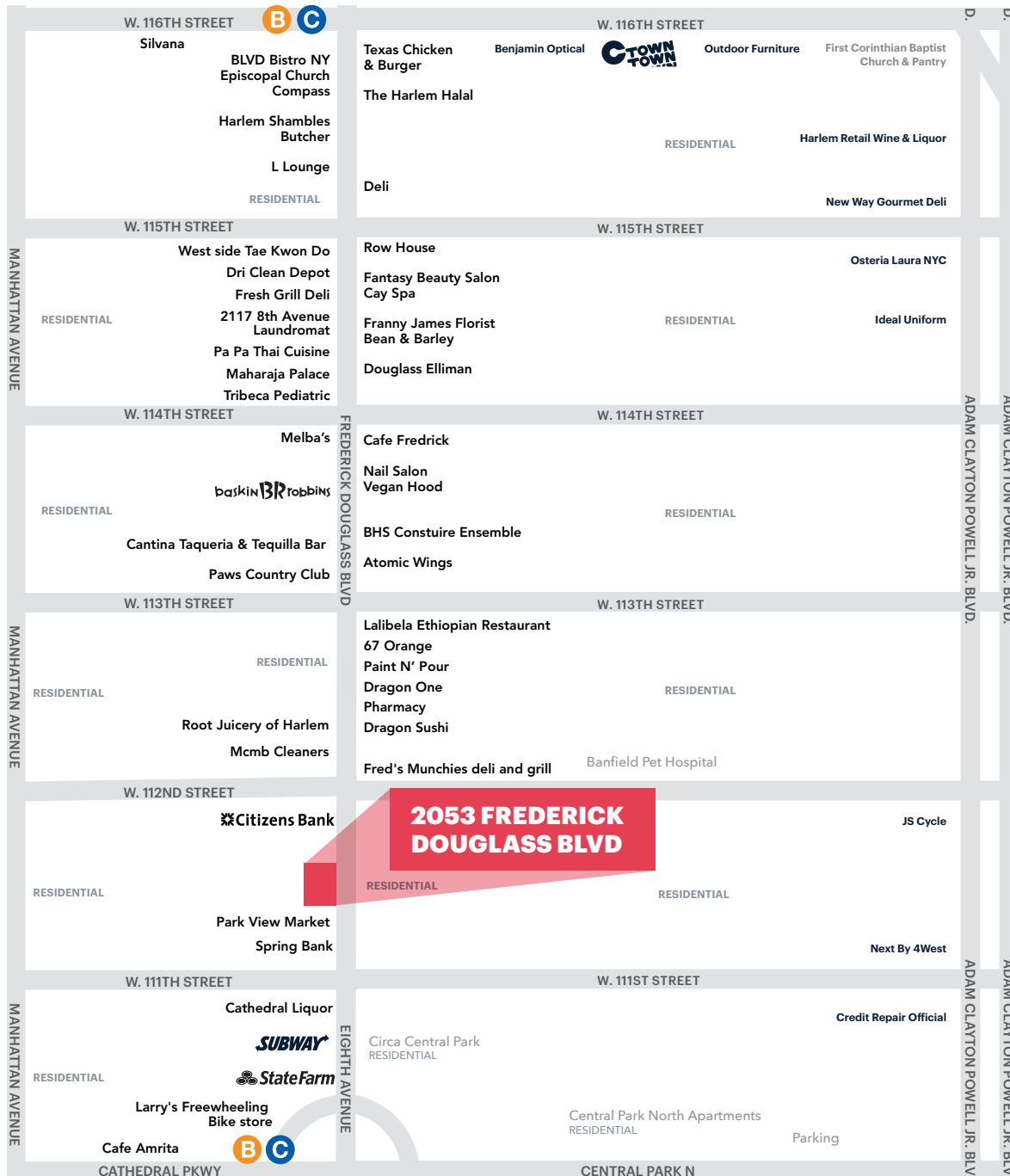

CONTACT EXCLUSIVE AGENTS

JASON PENNINGTON

jpennington@ripcony.com | 212.750.6565

JESSICA HEDRINGTON

jhedrington@ripcony.com | 212.750.6565

RIPCO
REAL ESTATE

150 East 58th Street
15th Floor
New York, NY 10115
212.750.6565

Please visit us at ripcony.com for more information

This information has been secured from sources we believe to be reliable, but we make no representations as to the accuracy of the information. References to square footage are approximate. Buyer must verify the information and bears all risk for any inaccuracies.