

Industrial | For Sublease

Townsend Way Distribution Center - Building C

CBRE

REDUCED ASKING RATE!



For Sublease

22875 NE Townsend Way | Fairview, OR, 97024

PROPERTY OVERVIEW

- + Available SF: \pm 47,395 (can be demised down to \sim 20,000)
- + Office SF: \pm 1,694
- + Dock Doors: 10
- + Grade Doors: 1
- + Clear Height: \pm 26'
- + Sublease through 5/31/2028
- + Available: Now

Asking Rate: \$0.45/SF/Mo (blended)
NNNs: \$0.22/SF/Mo

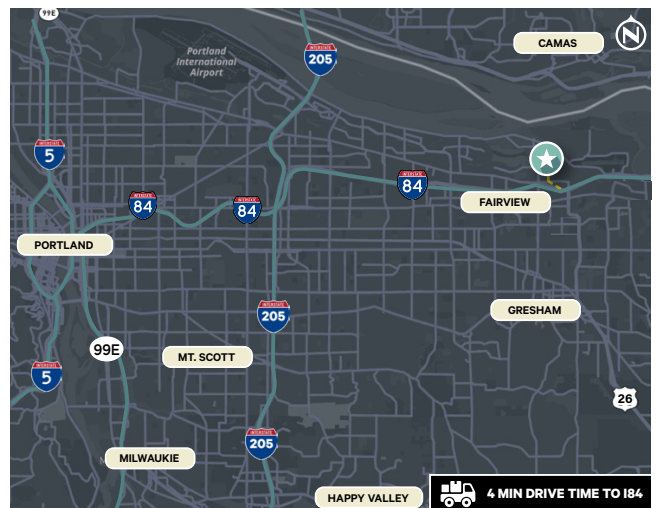

Floor Plan

22875 NE Townsend Way
Fairview, OR, 97024

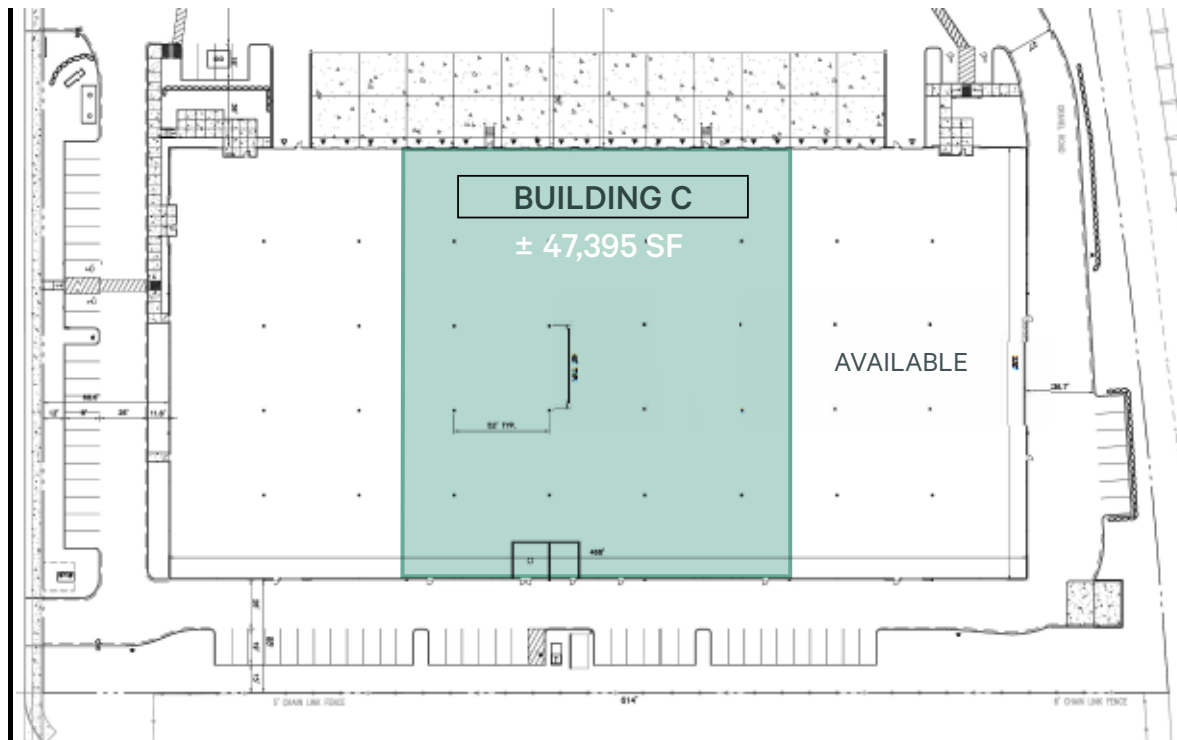

STUART SKAUG, SIOR

Executive Vice President
+1 503 221 4822
stuart.skaug@cbre.com
Licensed in OR & WA

CARA NOLAN, SIOR

Senior Vice President
+1 503 221 4840
cara.nolan@cbre.com
Licensed in OR & WA

LAYLA EVANS

Transaction Specialist
+1 503 221 4851
layla.evans@cbre.com
Licensed in OR & WA

© 2025 CBRE, Inc. All rights reserved. This information has been obtained from sources believed reliable, but has not been verified for accuracy or completeness. You should conduct a careful, independent investigation of the property and verify all information. Any reliance on this information is solely at your own risk. CBRE and the CBRE logo are service marks of CBRE, Inc. All other marks displayed on this document are the property of their respective owners, and the use of such logos does not imply any affiliation with or endorsement of CBRE. Photos herein are the property of their respective owners. Use of these images without the express written consent of the owner is prohibited.