



**SOUTHEASTERN**  
DEVELOPMENT • BROKERAGE • CONSULTING



# Savannah River Trade Center

**2917 Riverwest Drive | Augusta, GA 30907**

----- **FOR LEASE!** -----

**Two Spaces Available 2,150 SQFT | \$9.50/SF/NNN**

Luke Coffey  
706.854.6731  
[Luke.coffey@southeastern.company](mailto:Luke.coffey@southeastern.company)

**CONTACT:**



**SOUTHEASTERN**  
DEVELOPMENT • BROKERAGE • CONSULTING

2743 Perimeter Pkwy | Augusta, GA 30909 | 706.722.5565 | [www.southeastern.company](http://www.southeastern.company)



# EXECUTIVE SUMMARY



## OFFERING SUMMARY

**Space Available:** 2,382 SF (Usable)  
**Rate:** \$12.00/SF/YR (NNN)  
**Term:** 36 Months (Minimum)  
**Zoning:** HI – Heavy Industrial

## AVAILABLE SPACES

**Suite 206 – 2,382 SF**  
**Suite 305 – 2,155 SF**

## PROPERTY OVERVIEW

2917 Riverwest Drive is located conveniently ¼ mile west of the I-20 ramp at Riverwatch Parkway and minutes from downtown Augusta and Evans, GA. The building offers the flexibility to lease a smaller suite of 2,150 SF. Great location and floorplans for office/showroom, light distribution or service needs.

## LOCATION OVERVIEW

**DIRECTIONS:** From I-20 coming from Atlanta, take exit 200 and turn onto Riverwatch Parkway. From I-20 coming from Columbia, take exit 200 and turn right onto Riverwatch Parkway.









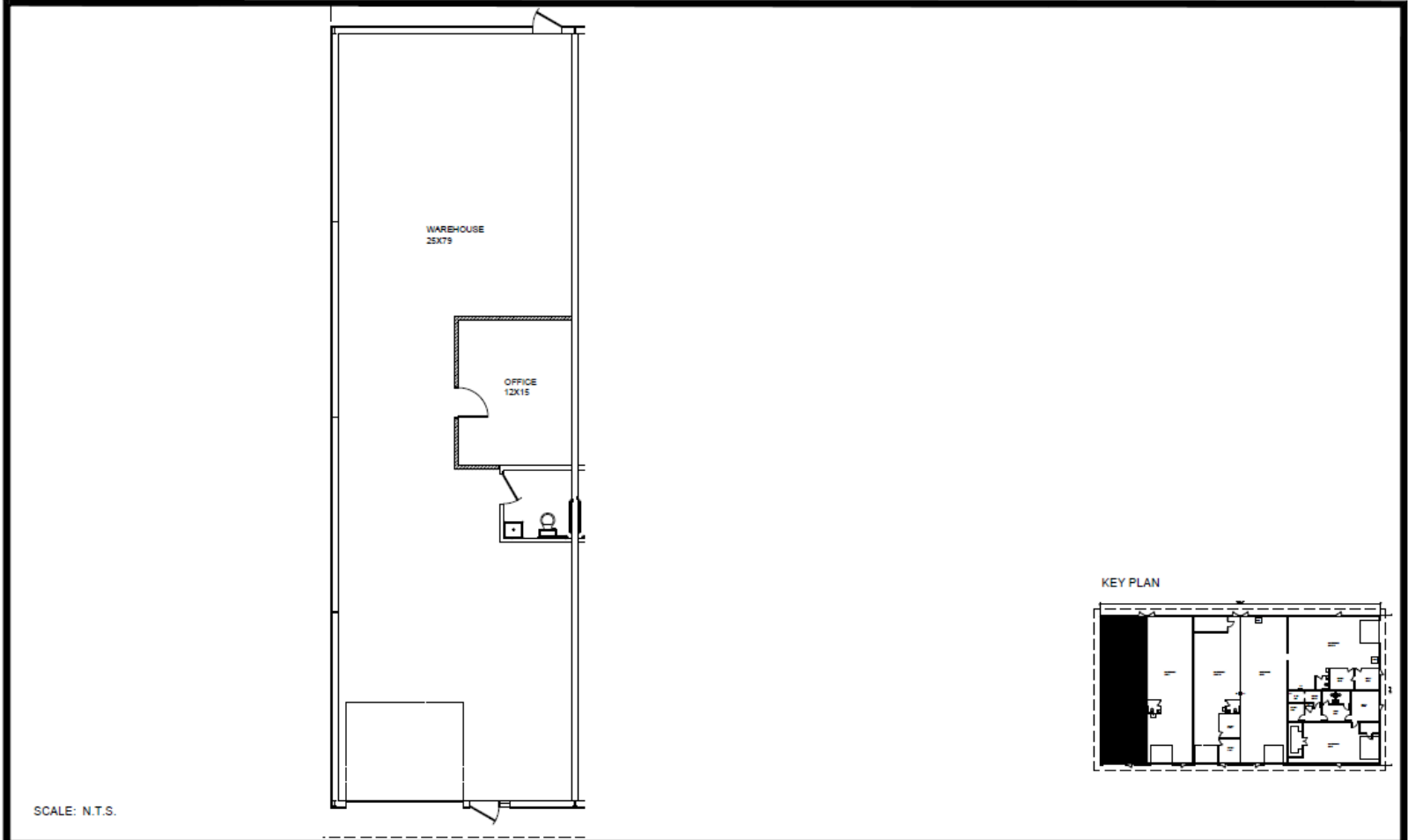

AS-BUILT PLAN--SUITE 206--2,382 RSF

RIVERWATCH  
2917 RIVERWEST DRIVE  
AUGUSTA, GA 30907

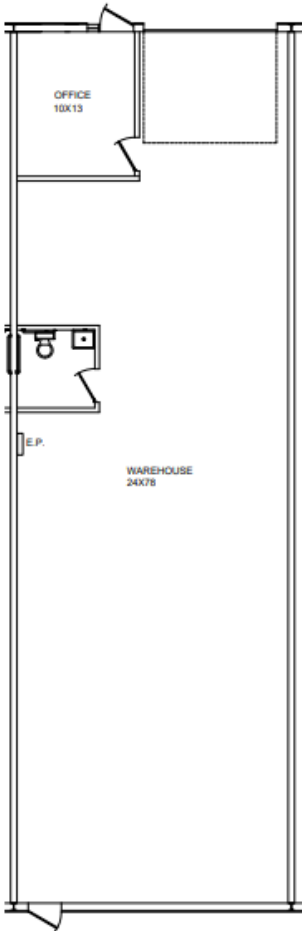

SCALE: N.T.S.

KEY PLAN



AS-BUILT PLAN--SUITE 305  
2,155 RSF

RIVERWATCH  
2917 RIVERWEST DRIVE  
AUGUSTA, GA 30907