



FOR LEASE

# 1518 W Knudsen Dr, Unit 102

PHOENIX, ARIZONA 85027

Lease Rate: \$1.05/SF Gross

Available: ±5,268 SF

**BUILDING** ±20,120 SF

**CLEAR HEIGHT** 18'

**ZONING** CP-BP, City of Phoenix

**CONSTRUCTION** 2006

**WAREHOUSE** EVAP cooled

**UPGRADED** office buildout

**COVERED** parking

**INCLUDES** reception, four private offices, two restrooms, break room

**POWER** 200a, 120/208v

**COMMON** fenced yard

**ERIC BELL, SIOR**  
602.513.5151  
eric.bell@kidder.com

**MIKE CIOSEK, SIOR**  
602.513.5135  
mike.ciosek@kidder.com

**DYLAN SCOTT**  
602.513.5104  
dylan.scott@kidder.com

**Kidder Mathews**

[KIDDER.COM](http://KIDDER.COM)

This information supplied herein is from sources we deem reliable. It is provided without any representation, warranty, or guarantee, expressed or implied as to its accuracy. Prospective Buyer or Tenant should conduct an independent investigation and verification of all matters deemed to be material, including, but not limited to, statements of income and expenses. Consult your attorney, accountant, or other professional advisor.

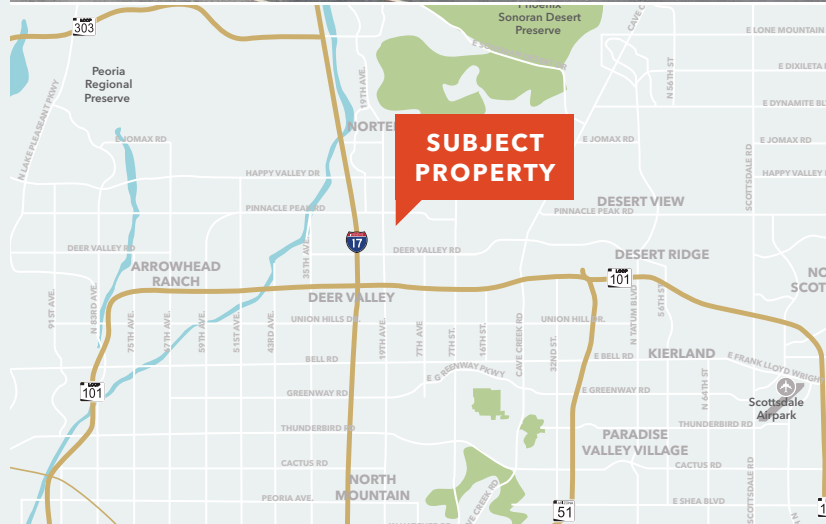

FOR LEASE

# 1518 W Knudsen Dr, Unit 102

PHOENIX, ARIZONA 85027

±5,268

SQUARE FEET

\$1.05

SF GROSS



## Unit 102

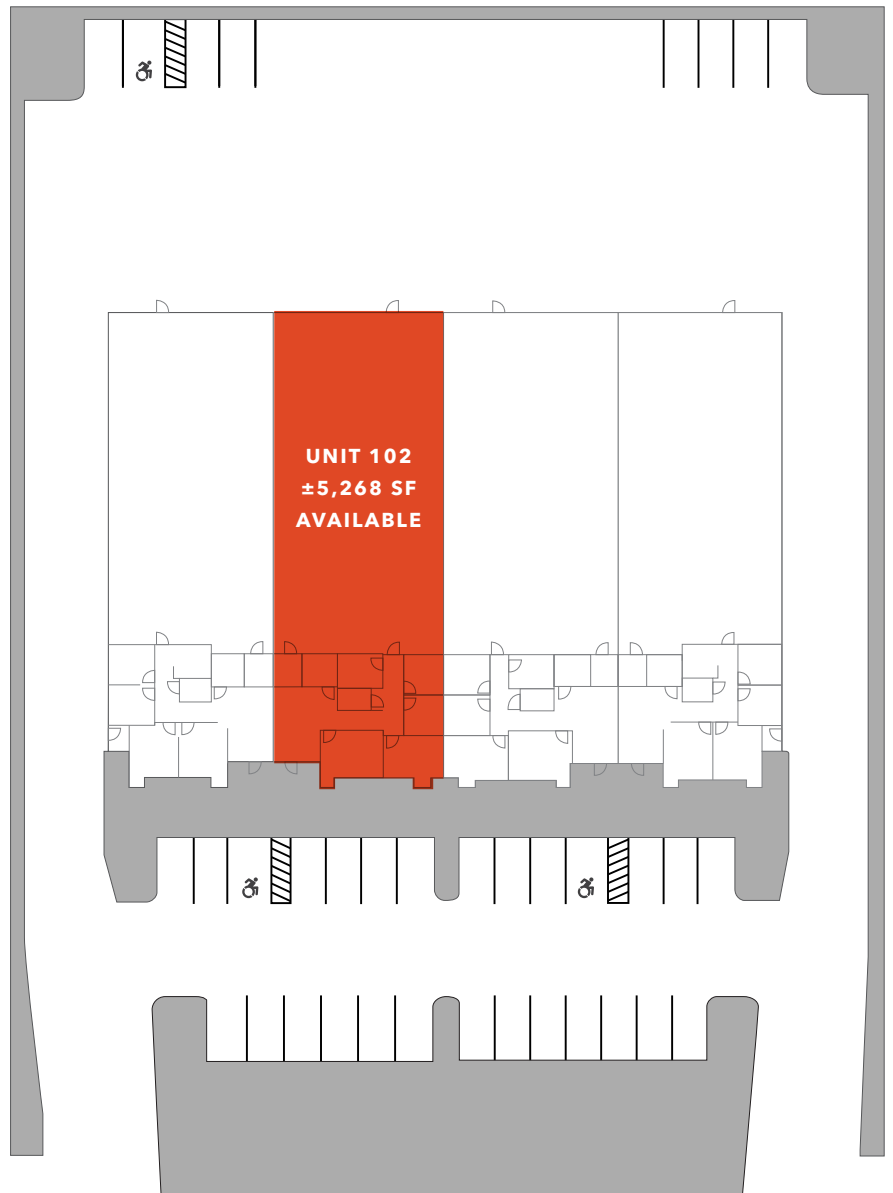

ERIC BELL, SIOR  
602.513.5151  
[eric.bell@kidder.com](mailto:eric.bell@kidder.com)

MIKE CIOSEK, SIOR  
602.513.5135  
[mike.ciosek@kidder.com](mailto:mike.ciosek@kidder.com)

DYLAN SCOTT  
602.513.5104  
[dylan.scott@kidder.com](mailto:dylan.scott@kidder.com)

[KIDDER.COM](http://KIDDER.COM)



This information supplied herein is from sources we deem reliable. It is provided without any representation, warranty, or guarantee, expressed or implied as to its accuracy. Prospective Buyer or Tenant should conduct an independent investigation and verification of all matters deemed to be material, including, but not limited to, statements of income and expenses. Consult your attorney, accountant, or other professional advisor.