

±1,907 SF

RETAIL FOR LEASE



GATEWAY SQUARE

10 East Hamilton Ave | Campbell, CA



the econic company®



±1,907 SF
AVAILABLE

PROPERTY HIGHLIGHTS



GATEWAY SQUARE
10 E Hamilton Ave,
Campbell, CA



Corner of E. Hamilton
& Winchester Blvd



Former Charles Schwab Space



Anchored by Walgreens with
Drive Up Pharmacy Window



Co-Tenant: Fedex, Taqueria Y
Mariscos La Jaiba, Club Pilates,
Stanford Health Care

DEMOGRAPHICS

	1 MILE	3 MILES	5 MILES
Population	30,292	240,472	593,925
Avg. HH Income	\$181,657	\$214,923	\$227,442
Daytime Population	34,218	251,126	623,194

TRAFFIC COUNTS

E Hamilton Ave	54,904 ADT
S Winchester Blvd	36,760 ADT

Source: 2025 Esri.

FULL PROPERTY SITE PLAN



E Hamilton Ave

Winchester Blvd

Esther Street

PROJECT FLOOR PLAN

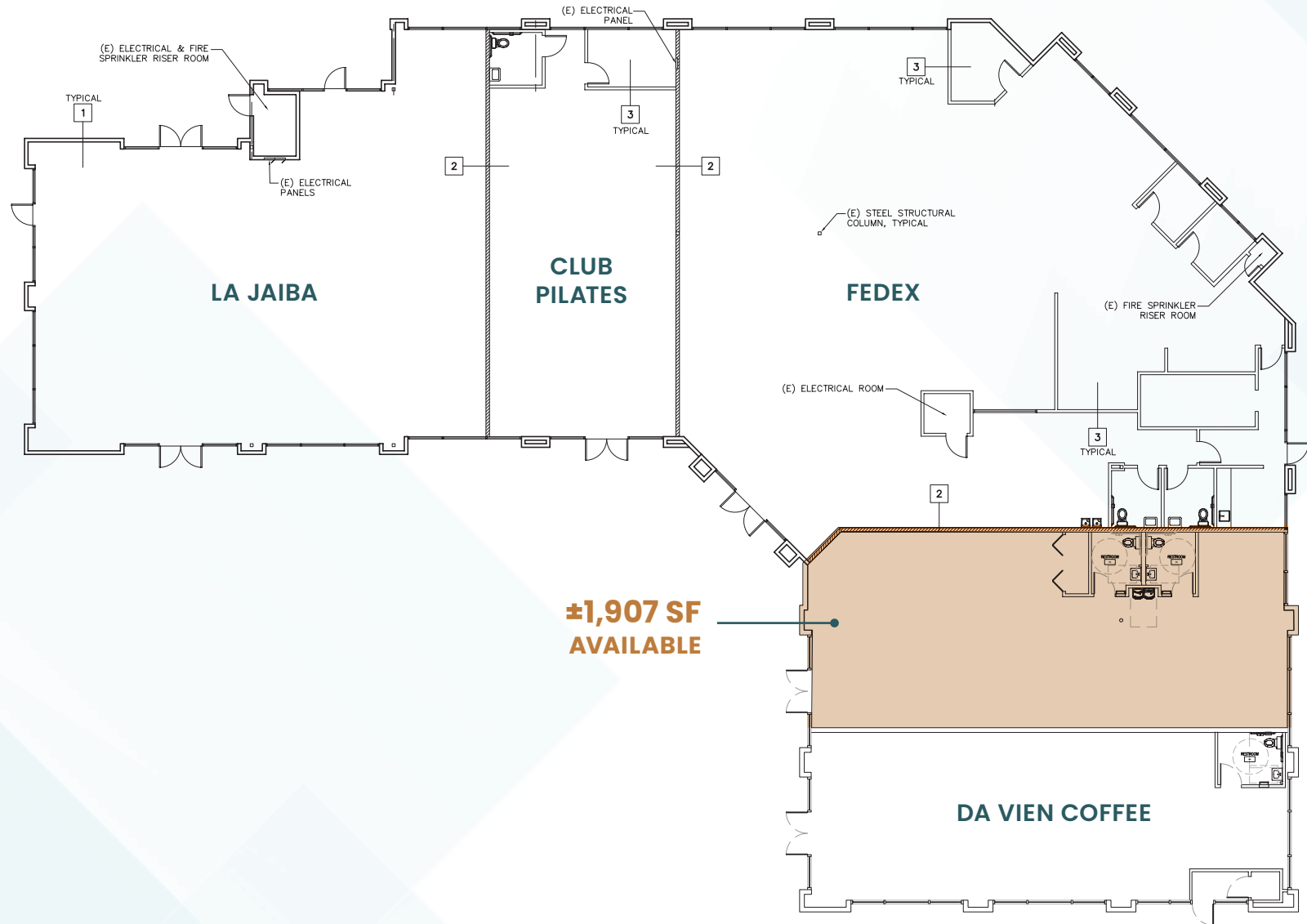

PROPERTY GALLERY



MARKET AERIAL

West Park Plaza

SAFeway   **Chevron** **SUPERCUTS**



KOHL'S

Hamilton Plaza



west elm



See's CANDIES



OREN'S HUMMUS

WHOLE BODY

Local Kitchens

W HAMILTON AVE

STAPLES

Gateway Square



Walgreens **FedEx**

CLUB  **PILATES**

**CAMPBELL
COMMUNITY
CENTER**

The Pruneyard

Marshalls

**TRADER
JOE'S**



PASTA
ARMELLINO



Pacific Catch

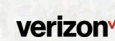

**DOWNTOWN
CAMPBELL**

**Mancini's
SLEEPWORLD**

SAN TOMAS EXPY

DRIVE TIME

DEMOGRAPHICS

DEMOGRAPHICS (2023)	5 MINS	10 MINS	15 MINS
2028 Total Population (Estimated)	30,902	247,011	612,114
2023 Total Population	31,021	244,006	601,444
Median Age	38.2	39.3	39.1
Total Households	12,156	92,642	221,570
Total % Owner Occupied Housing Units	38.6	47.7	47.9
Total % Renter Occupied Housing Units	55.8	47.2	47.1
Average Household Income	\$156,768	\$186,135	\$196,575
Median Household Income	\$112,510	\$139,314	\$147,498
Per Capita Income	\$63,628	\$72,683	\$69,271
Average Household Size	2.51	2.61	2.65

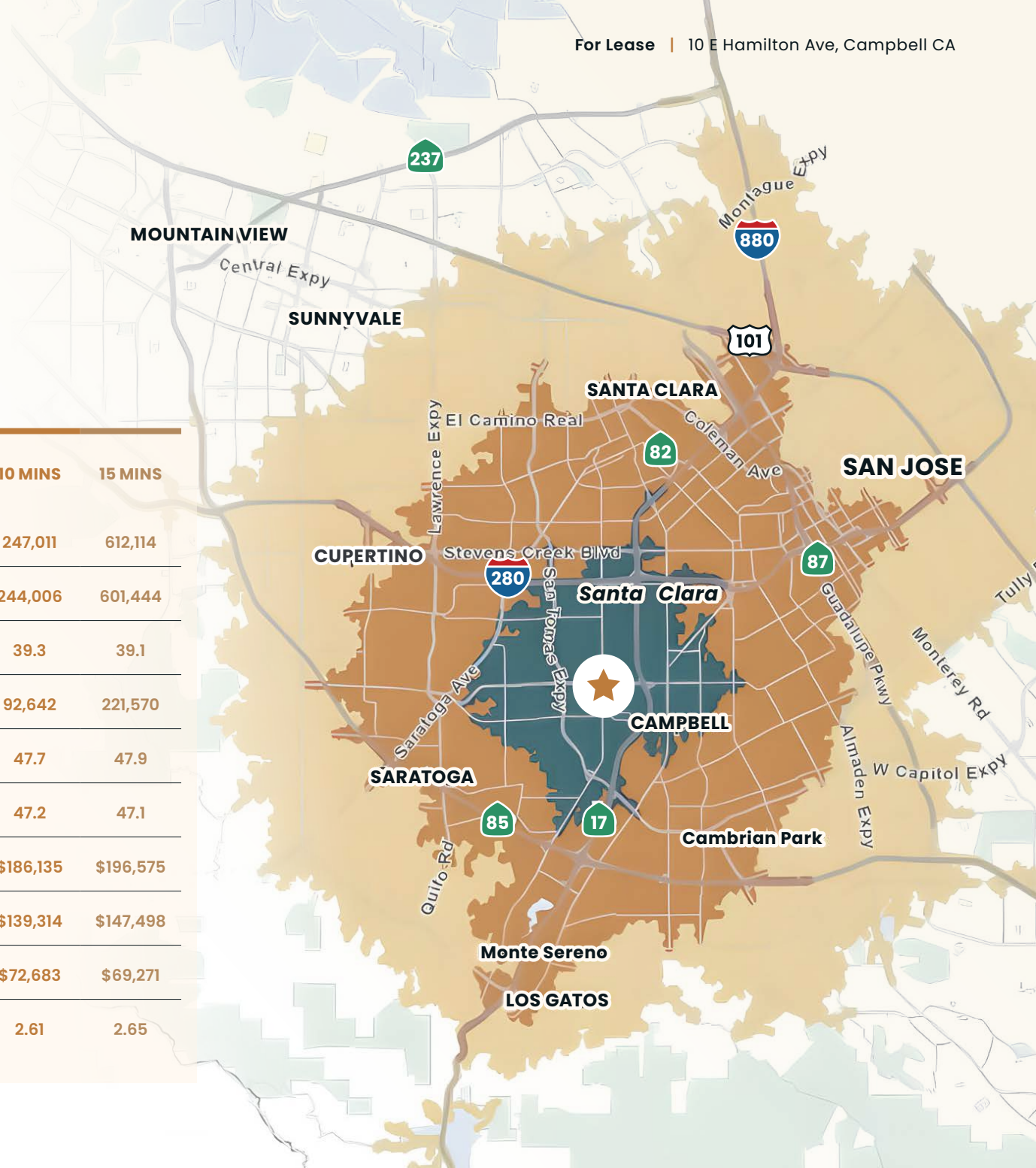

GATEWAY SQUARE

10 East Hamilton Avenue | Campbell, CA

MATT SWEENEY

msweeney@theeconiccompany.com
(408) 863-1444
LIC. 01746896

SEAN O'CARROLL

socarroll@theeconiccompany.com
(408) 863-1447
LIC. 01058587

RON CRUZ

rcruz@theeconiccompany.com
(408) 400-7003
LIC. 02018499

