

CUTTING EDGE AT THE WATERS EDGE

CREATIVE OFFICE

TECHNOLOGY

LIFE SCIENCE

CHINA
BASIN



MC⁺
Experience the Relationship
McCARTHY • COOK

NEWMARK McCARTHY • COOK
RELATIONSHIP DRIVEN EXPERIENCE

THINK BIG

*We have room for any business to grow –
execute your vision at China Basin.*

Located on Mission Creek and Berry Street between 3rd and 4th streets, China Basin has been an enduring symbol of commerce and industry for nearly a century.

The landmark Wharfside Building was constructed by Southern Pacific Railroad in 1922. The Berry Building was added in 1991 and further supplemented in 2008 by a 2-story add-on using a mid-structure base isolation system, a first in U.S. history.

The 940,000 square foot campus stretches over 800 linear feet and provides efficient rectangular floorplates averaging over 85,000 square feet accommodating corporate office, technology, and life science tenants.



**Design is not just
what it looks like
and feels like.
Design is how it
works.**

STEVE JOBS



China Basin is the place to execute your vision:

- **ICONIC BUILDING**
- **PREEMINENT LOCATION**
- **SEASONED OWNERSHIP**
- **RELATIONSHIP DRIVEN MANAGEMENT**
- **STATE OF THE ART AMENITIES**
- **TRANSIT CENTRIC**
- **SPORTY NEIGHBORHOOD**

REINFORCING A MISSION BAY LANDMARK USING
ANCIENT PRINCIPLES OF PHYSICS AND ENGINEERING



SEISMIC UPGRADE



WIDE OPEN

Innovative open spaces for balanced work and social experience.

China Basin has the longest floorplates in San Francisco and over 55,000 square feet open space, more than any privately owned building in the city. A multi-level promenade with outdoor seating allows tenants to enjoy spectacular Bay views everyday and provides a space to host truly memorable events for employees and clients.

Our newly designed Courtyard features multiple outdoor living rooms and meeting areas complete with comfortable seating, fire pits and overhead heating elements.





TENANT EXCLUSIVE OUTDOOR BALCONIES ALLOWING FOR INDOOR/ OUTDOOR WORKSPACE OR SOCIAL EVENTS ANY TIME OF DAY.

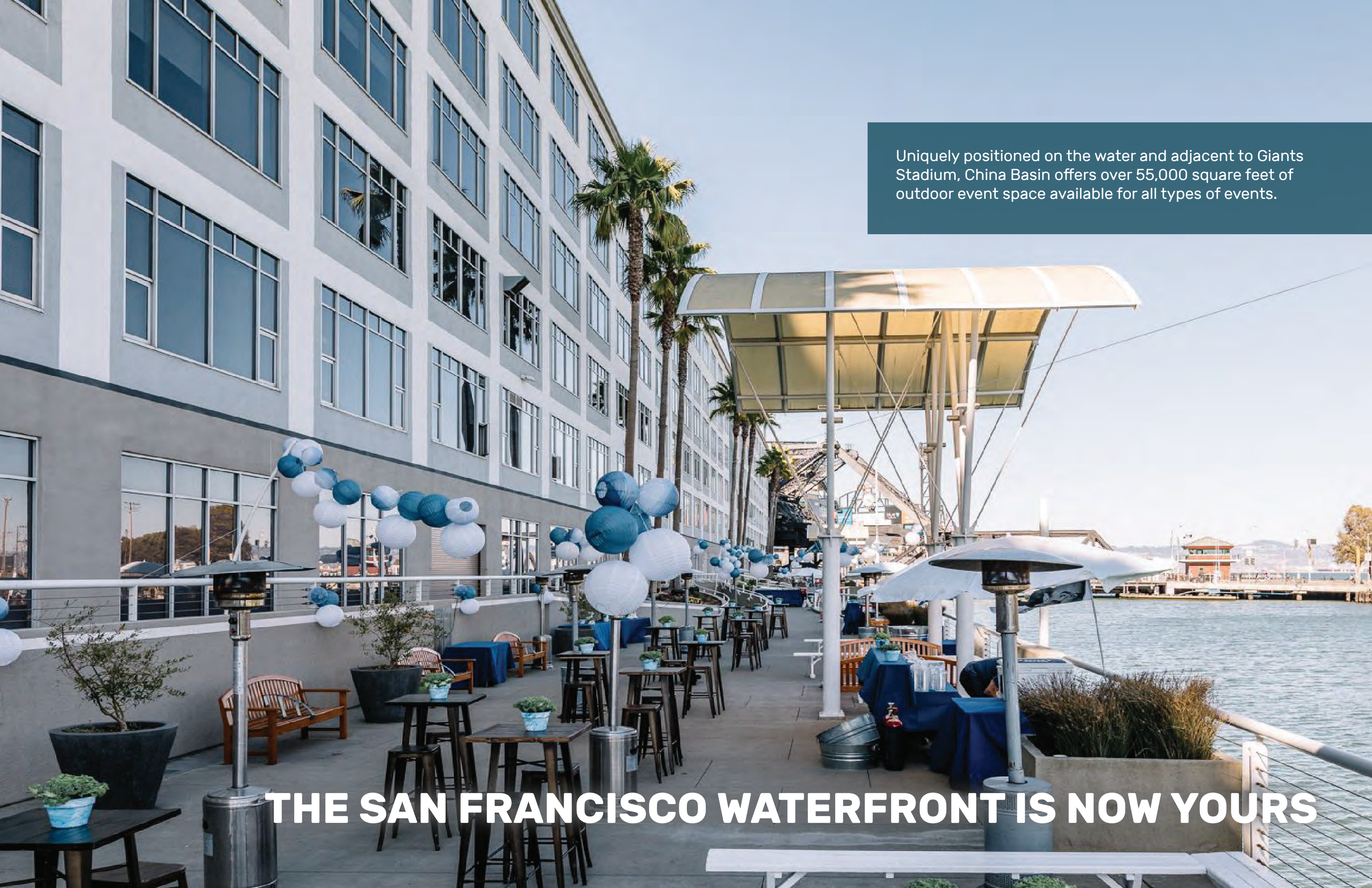

A wide-angle photograph of a waterfront terrace. On the left is a multi-story modern building with a grid of windows. The terrace is paved and features several small wooden tables with stools, some with blue tablecloths. Decorative blue and white paper lanterns are strung across the area. A large, modern white umbrella with a glass top provides shade. In the background, palm trees and a body of water are visible, with a bridge and city skyline in the distance.

Uniquely positioned on the water and adjacent to Giants Stadium, China Basin offers over 55,000 square feet of outdoor event space available for all types of events.

THE SAN FRANCISCO WATERFRONT IS NOW YOURS





REJUVENATE

RINSE | RELAX | REFRESH



LUXURY SHOWERS AVAILABLE TO ALL CHINA BASIN TENANTS ON A MEMBERSHIP BASIS

DIRECTIONS TO CHINA BASIN



FROM THE AIRPORT (SFO)/PENINSULA

Take 101 North to 280 North and exit King Street. Turn right on 4th Street and go ½ block and make a left turn onto Berry Street. The main entrance is in the middle of the block. To access the garage continue to Third Street, take a right and the garage entrance is immediately on the right.

FROM THE BAY BRIDGE

Take the 5th Street exit. Make a sharp left onto 5th Street. Go one block and make a left on Brannan, then another block and make a right on 4th. Follow 4th Street to Berry Street and turn left. The main entrance is in the middle of the block. To access the garage continue to Third Street, take a right and the garage entrance is immediately on the right

FROM THE GOLDEN GATE BRIDGE

Take the Marina exit. Follow Marina Blvd to Bay Street and make a left. Follow Bay Street to the end and make a Right onto The Embarcadero. Take a left onto 4th Street then go ½ block to Berry Street, make a left. The main entrance is in the middle of the block. To access the garage continue to Third Street, take a right and the garage entrance is immediately on the right.

DIRECTIONS TO CAMPUS CENTER

The Campus Center, Suite 140 is located in the courtyard. After entering the property in the parking garage on the 3rd Street side of the campus, take the elevator up to the ground level and come out the elevator lobby to the courtyard. Our Customer Engagement Center is directly across the courtyard.

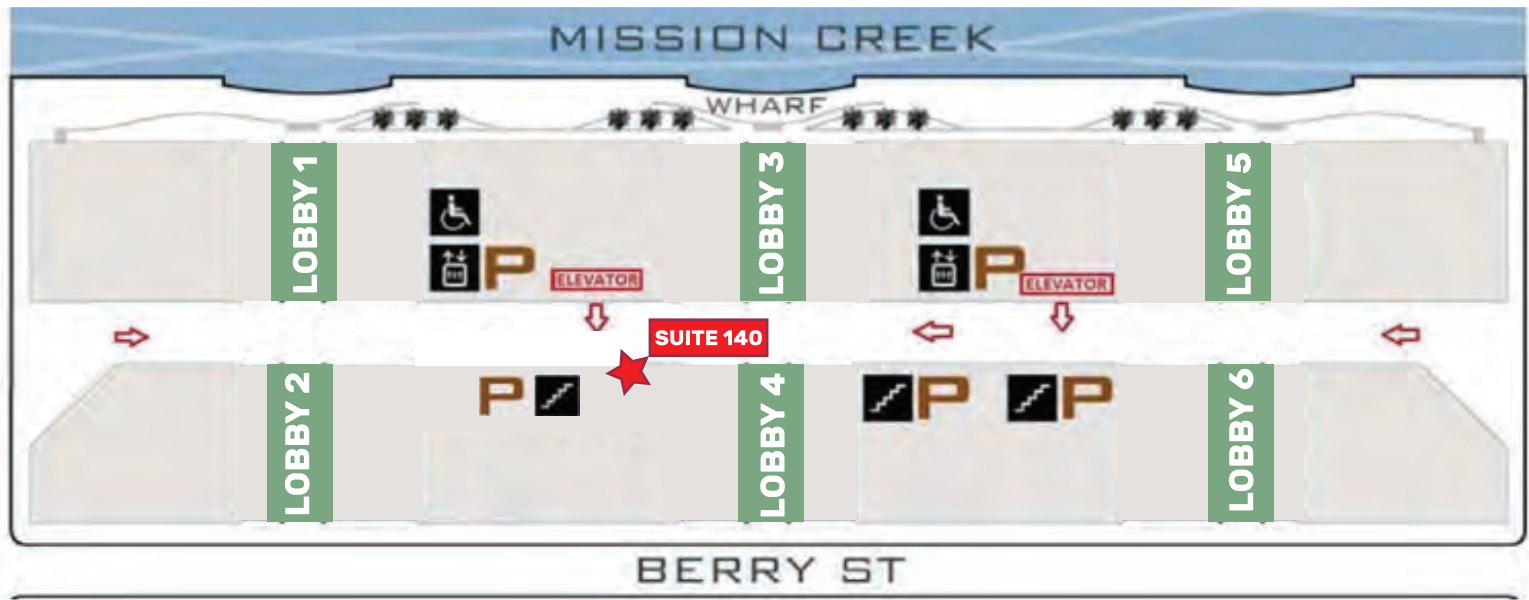

CHINA
BASIN

McCARTHY • COOK
RELATIONSHIP DRIVEN EXPERIENCE

MC⁺
Experience the Relationship
McCARTHY • COOK

AMENITY RICH



Electric Vehicle
Charging Stations



On-Site Parking
and Valet Assist



Bike storage +
quarterly free
tune-ups



24 Hour Security

Walk from downtown San Francisco in 15 minutes. Access public transportation, excellent amenities, and countless social hotspots at our doorstep. **Life at China Basin is full of options.**



Courtyard lighting
to stimulate
and inspire



Event
Coordination



Conference
Facilities



Campus Center



Outdoor
Collaboration
Areas



Pick up/dropoff
Dry Cleaning
Service



Luxury Shower
Suites



Beehives

REFRESHING WALKS

The Embarcadero/ Rincon Park
China Basin Park
Mission Creek Park
South Park
South Beach Park

FINE DINING

EPIC Steak
Alexander's Steakhouse
25 Lusk
CENTO Osteria
Waterbar

CASUAL BITES

Little Skillet
CB Kitchen
SAJJ
Mediterranean
The American Grilled Cheese Kitchen

LOCAL BREWERIES

21st Amendment Brewing
Local Brewing Company
Black Hammer
New Belgium Brewery

ENTERTAINMENT VENUES

Petit Marlowe
District San Francisco
Local Tap
Lucky Strike
Spark Social
Oracle Park
Chase Center

WORKOUTS

Barry's Bootcamp
Core Power Yoga
United Barbell
Body Mechanix Fitness
Pizzo Training

TOP HOTELS

Hyatt Place
Virgin Hotels
Hotel Via
St. Regis SF

WHAT'S IN THE NEIGHBORHOOD?

Just about everything you need.



Fitness & Wellness
Classes



Steps to
Oracle Park, home
to the SF Giants



Steps to
Chase Center,
home to the GSW



China Basin App

COMING 2022



Fire Pits



Events/
Happy Hours



Beer & Wine
Service



Onsite Cafe

SENSE OF PLACE

LOCAL FLAIR

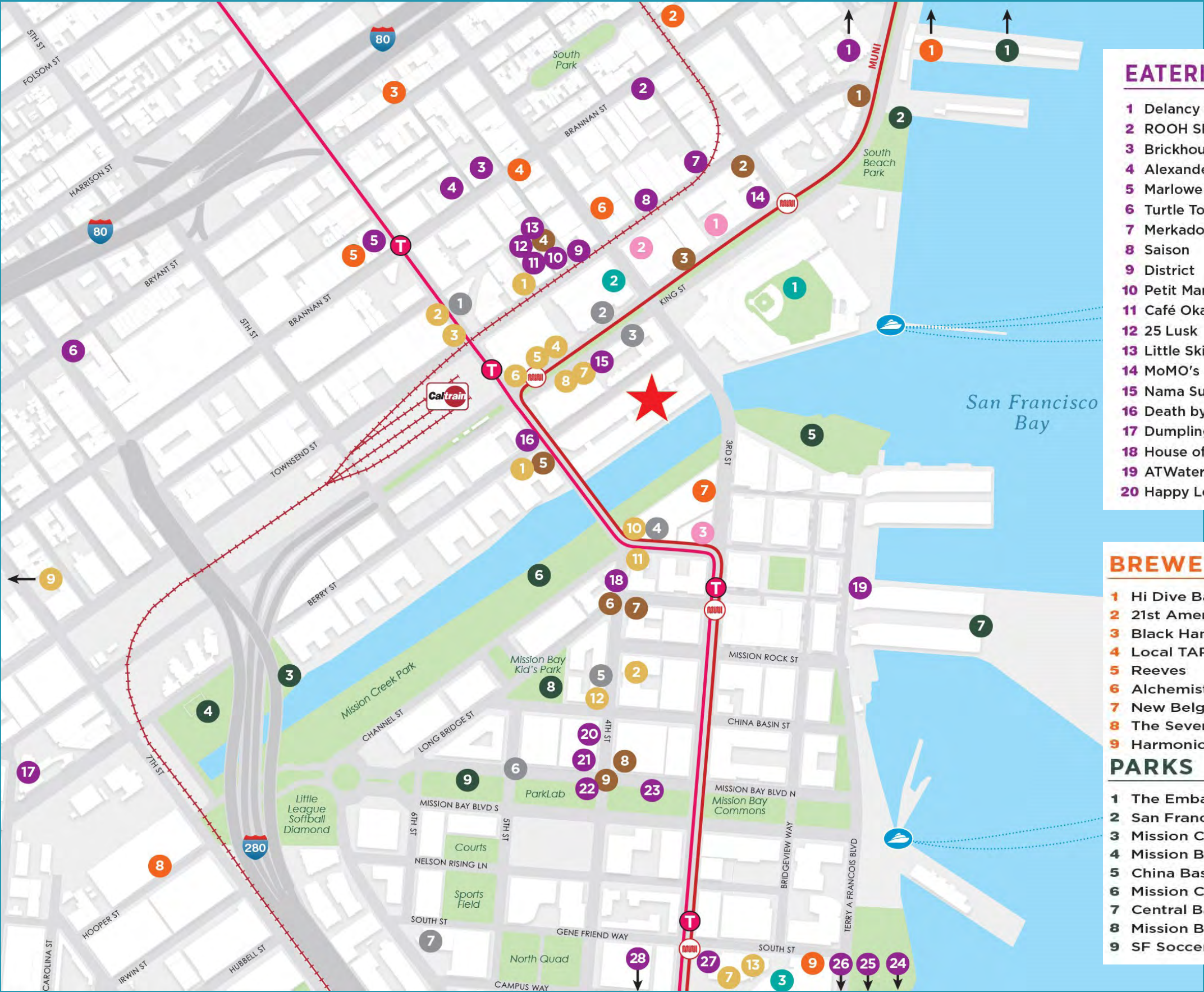

EATERIES

- 1 Delancy Street
- 2 ROOH SF
- 3 Brickhouse
- 4 Alexander's Steakhouse
- 5 Marlowe
- 6 Turtle Tower
- 7 Merkado
- 8 Saison
- 9 District
- 10 Petit Marlowe
- 11 Café Okawari
- 12 25 Lusk
- 13 Little Skillet
- 14 MoMO's
- 15 Nama Sushi
- 16 Death by Tacos
- 17 Dumpling Time
- 18 House of Tadu
- 19 ATWater Tavern
- 20 Happy Lemon
- 21 Man vs Fries
- 22 Spark Social
- 23 Domingo's Intl. Kitchen
- 24 Mission Rock Resort
- 25 STEM
- 26 The Ramp
- 27 Gott's Roadside
- 28 SF Kebab

CAFÉS & COFFEE

- 1 South Beach Café
- 2 Café Lambretta
- 3 Bravado
- 4 Cento
- 5 Philz Coffee
- 6 Café Reveille
- 7 Joe & The Juice
- 8 Blue Bottle Coffee
- 9 SPRO Coffee Lab

FITNESS & HEALTH

- 1 United Barbell
- 2 Barry's Bootcamp
- 3 Orange Theory
- 4 Lagree Fit 415
- 5 CorePower Yoga
- 6 Pizzo Training
- 7 Bakar Fitness Center

ENTERTAINMENT

- 1 Oracle Park
- 2 Lucky Strike
- 3 Chase Center

HOTELS

- 1 Hotel Via
- 2 Hyatt Place
- 3 LUMA Hotel

BREWERIES/BARS/PUBS

- 1 Hi Dive Bar
- 2 21st Amendment Brewery
- 3 Black Hammer Brewing
- 4 Local TAP
- 5 Reeves
- 6 Alchemist Bar
- 7 New Belgium Brewery
- 8 The Seven Stills
- 9 Harmonic Brewing

PARKS

- 1 The Embarcadero
- 2 San Francisco Bay Trail
- 3 Mission Creek Kayak Launch
- 4 Mission Bay Basketball/Tennis Courts
- 5 China Basin Park
- 6 Mission Creek Park
- 7 Central Basin Waterfront
- 8 Mission Bay Kids Park
- 9 SF Soccer Park

SHOPPING/SERVICES

- 1 Mulberry's Cleaners & Alterations
- 2 The UPS Store
- 3 Walgreens
- 4 Tan Bella
- 5 Wells Fargo Bank
- 6 Safeway
- 7 Chase Bank
- 8 Thy Spa
- 9 REI
- 10 Mission Bay Wine & Cheese
- 11 Gus's Community Market
- 12 Healthy Spot Pet Store
- 13 Mission Bay Farmer's Maerket

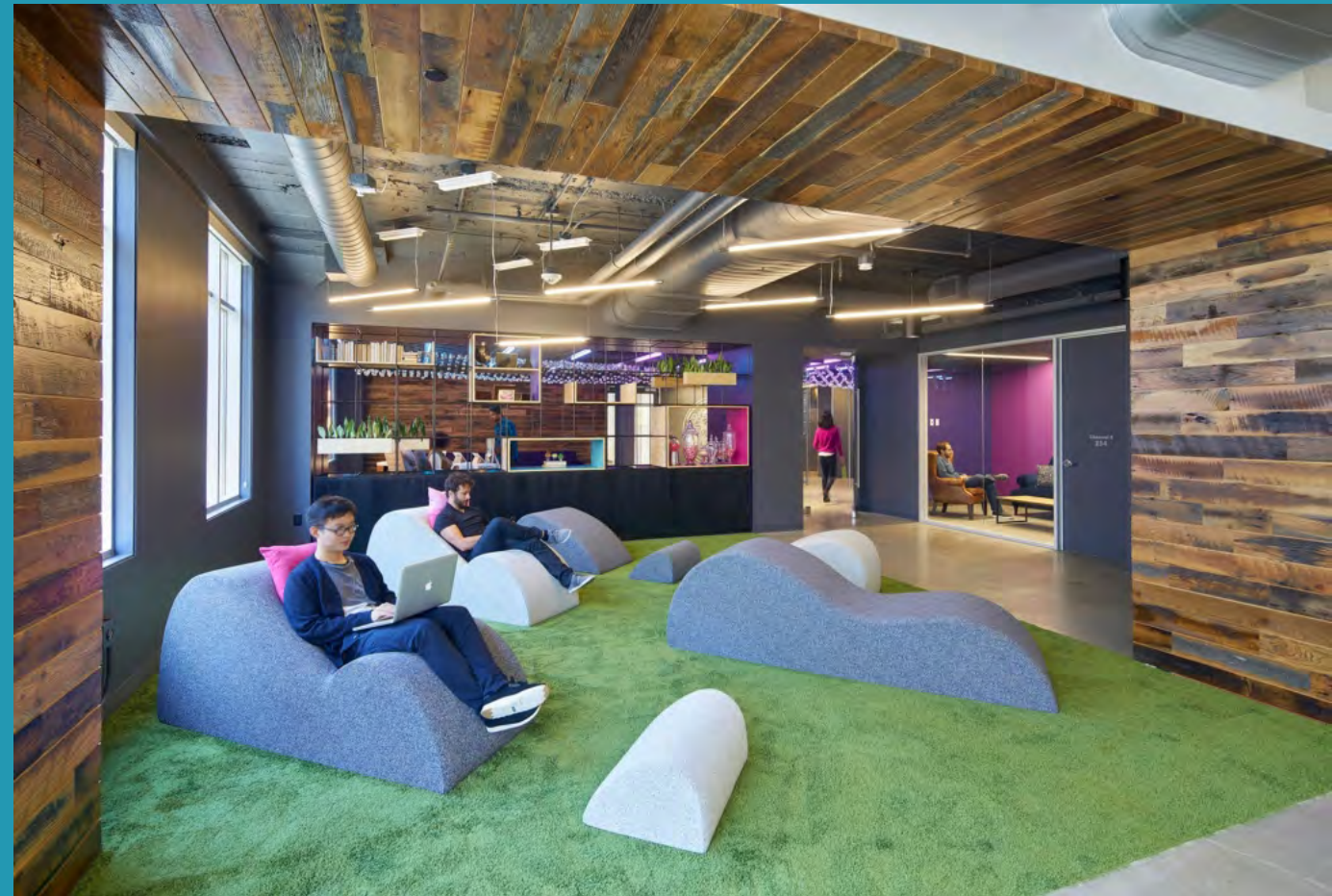
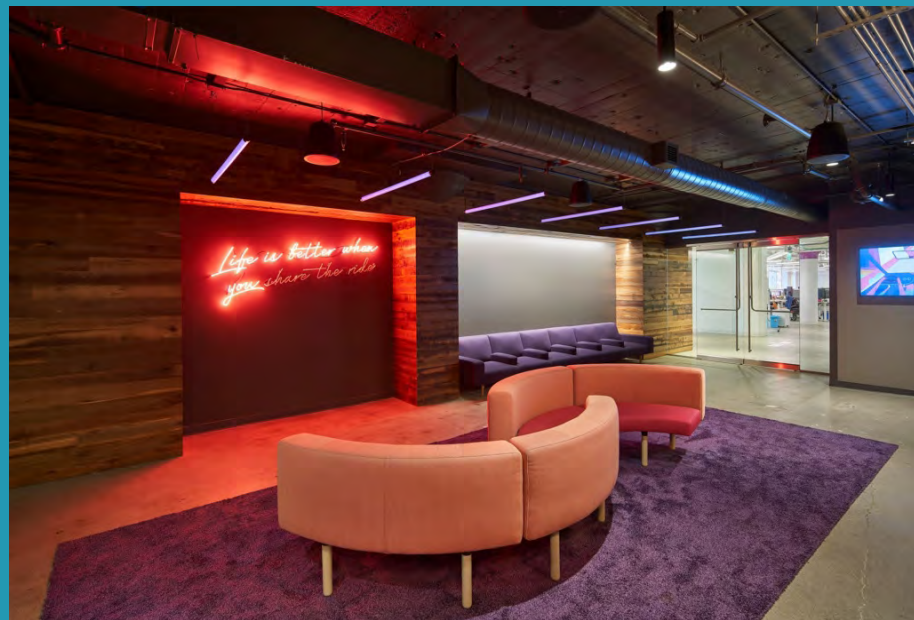
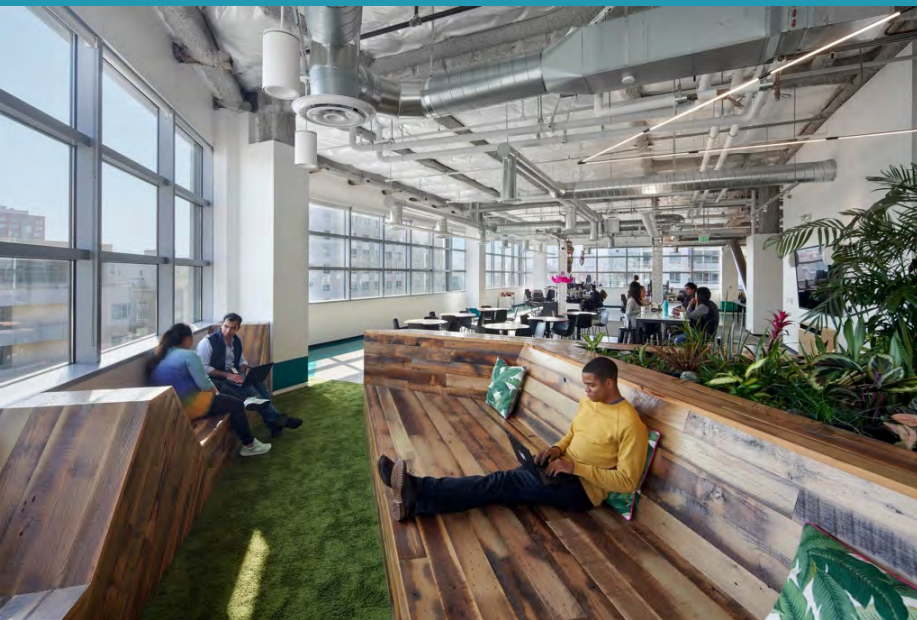

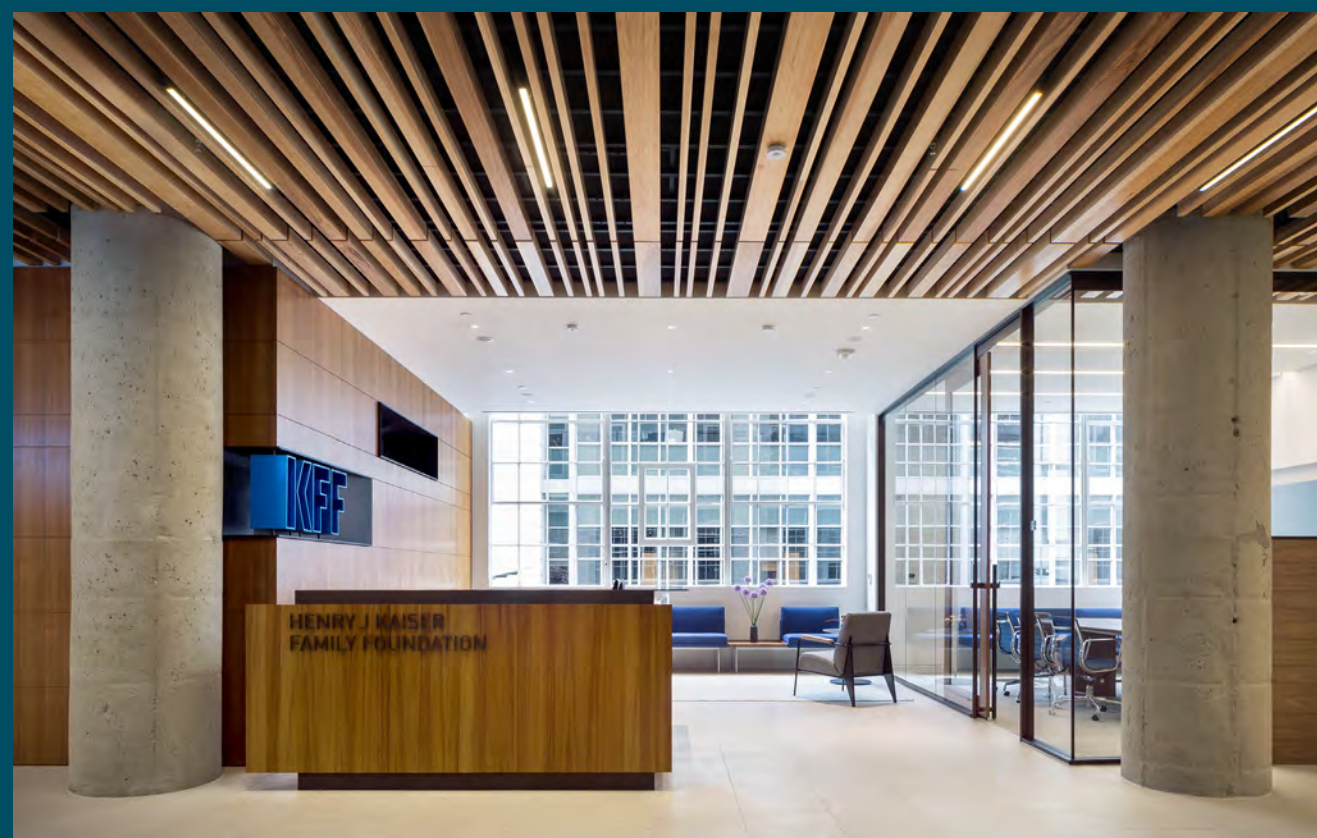
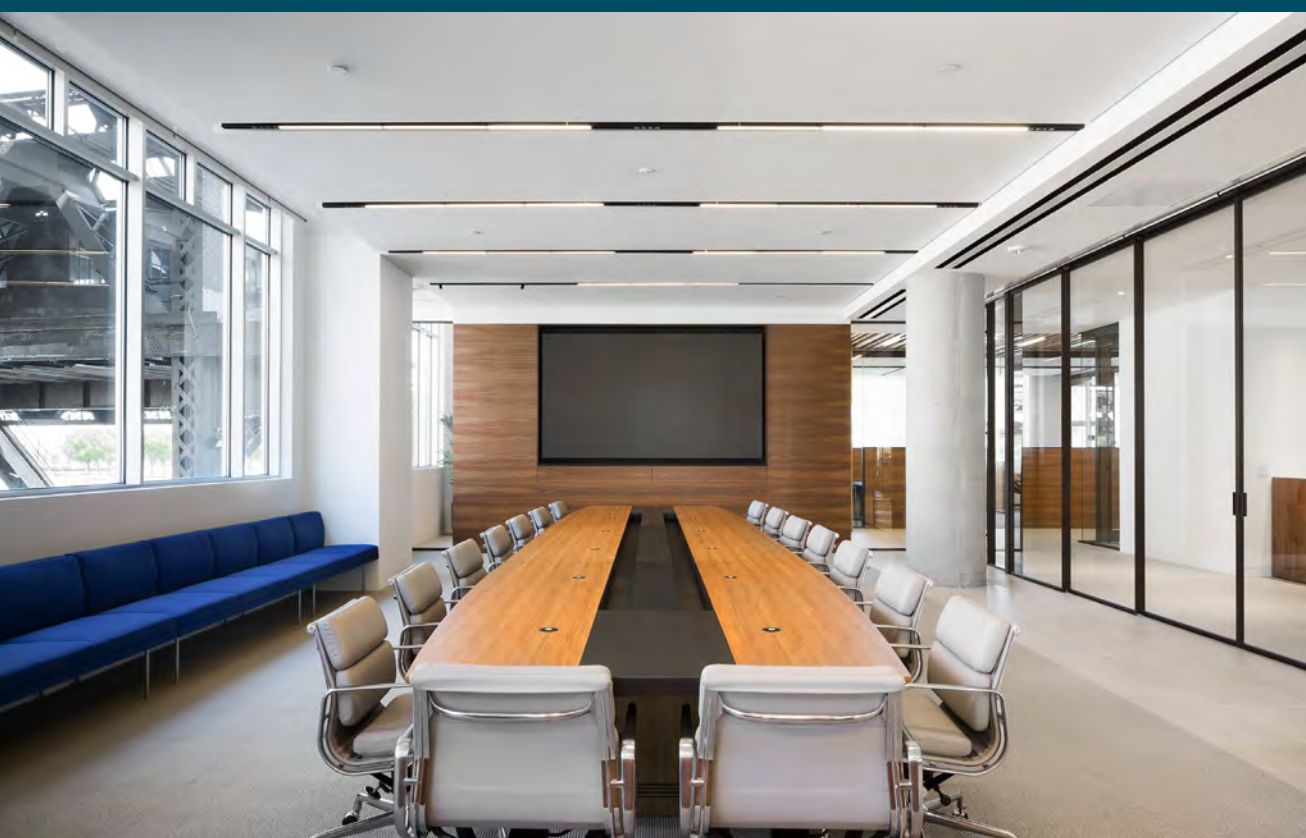



CHINA
BASIN

NEWMARK

McCARTHY • COOK
RELATIONSHIP DRIVEN EXPERIENCE

MC⁺
Experience the Relationship
McCARTHY • COOK

BOB GARNER
EXECUTIVE MANAGING DIRECTOR
(650) 358-5266
BOB.GARNER@NMRK.COM

CA Real Estate License #00936790

CASSIDY ZERRER
SENIOR MANAGING DIRECTOR
(415) 283-9910
CASSIDY.ZERRER@NMRK.COM

CA Real Estate License #01779321

KARL BALDAUF
EXECUTIVE MANAGING DIRECTOR
(415) 445-5117
KARL.BALDAUF@NMRK.COM

CB Real Estate License #01055368

HANNAH POTTER
MANAGING DIRECTOR
(415) 445-5113
HANNAH.POTTER@NMRK.COM

CB Real Estate License #01924485

MAURICE SPIKES
SENIOR MANAGING DIRECTOR
(415) 445-5190
MAURICE.SPIKES@NMRK.COM

CB Real Estate License #02001506

RICHARD HAYES
(415) 992-5778
RBH@MCCARTHYCOOK.COM

CB Real Estate License #01055368