

DETAIL OVERVIEW

PROJECT PROFILE

Industrial, Warehouse, Office, Showroom, Flex, Parking, and Outdoor Storage

ZONE TYPE

M1-2 Commercial Service

TOTAL BUILDING SIZE/GLA

- 60,000 sqft



HIGHLIGHTS

- Property renovations completed 2024
- Onsite - 200 Car Secured Parking Lot
- Updated Office Space
- Immediate Occupancy
- Ceiling Height 10' - 23'
- 2 Loading Docks
- 2 Drive in Doors
- Power 2000 amps, 3-phase 480/277 volt
- Located at Kostner, Grand & North Avenue
- Surrounding Retail Includes McDonalds, Menards, Aldi and Burlington

PROPERTY NAME

1657MoREProperties.com

ADDRESS

1657 North Kostner Avenue,
Chicago, IL 60639

SPACE AVAILABLE

500 - 30,000 sqft (divisible)

TOTAL POPULATION

231,170	2 Miles
1,218,968	5 Miles

AVERAGE HOUSEHOLD INCOME

\$67,148	2 Miles
\$101,825	5 Miles

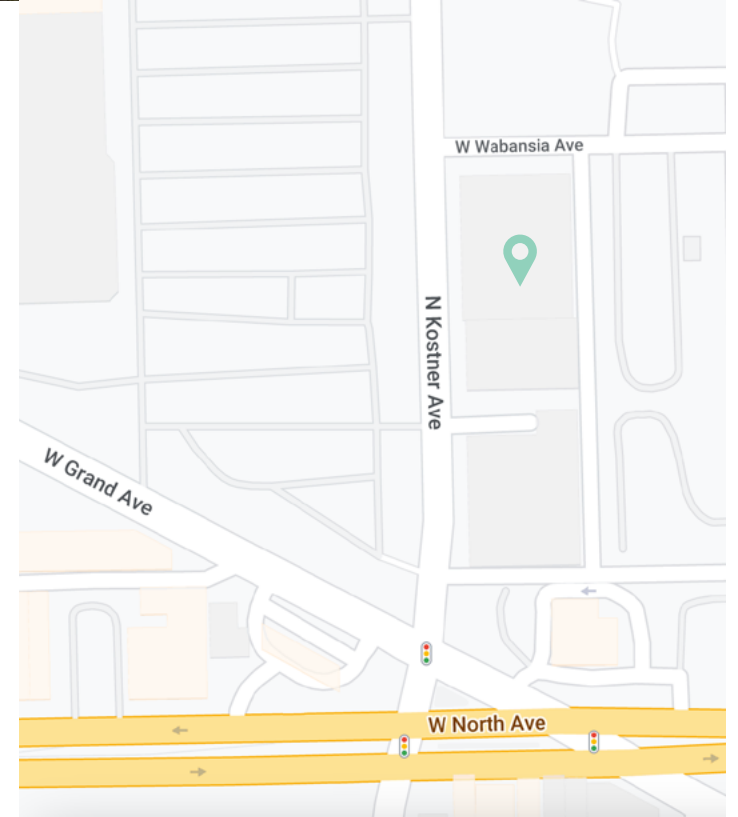



SUITE 600 | WAREHOUSE



SUITE 350 | FLEX



SUITE 400 | OFFICE



SUITE 300 | STORAGE



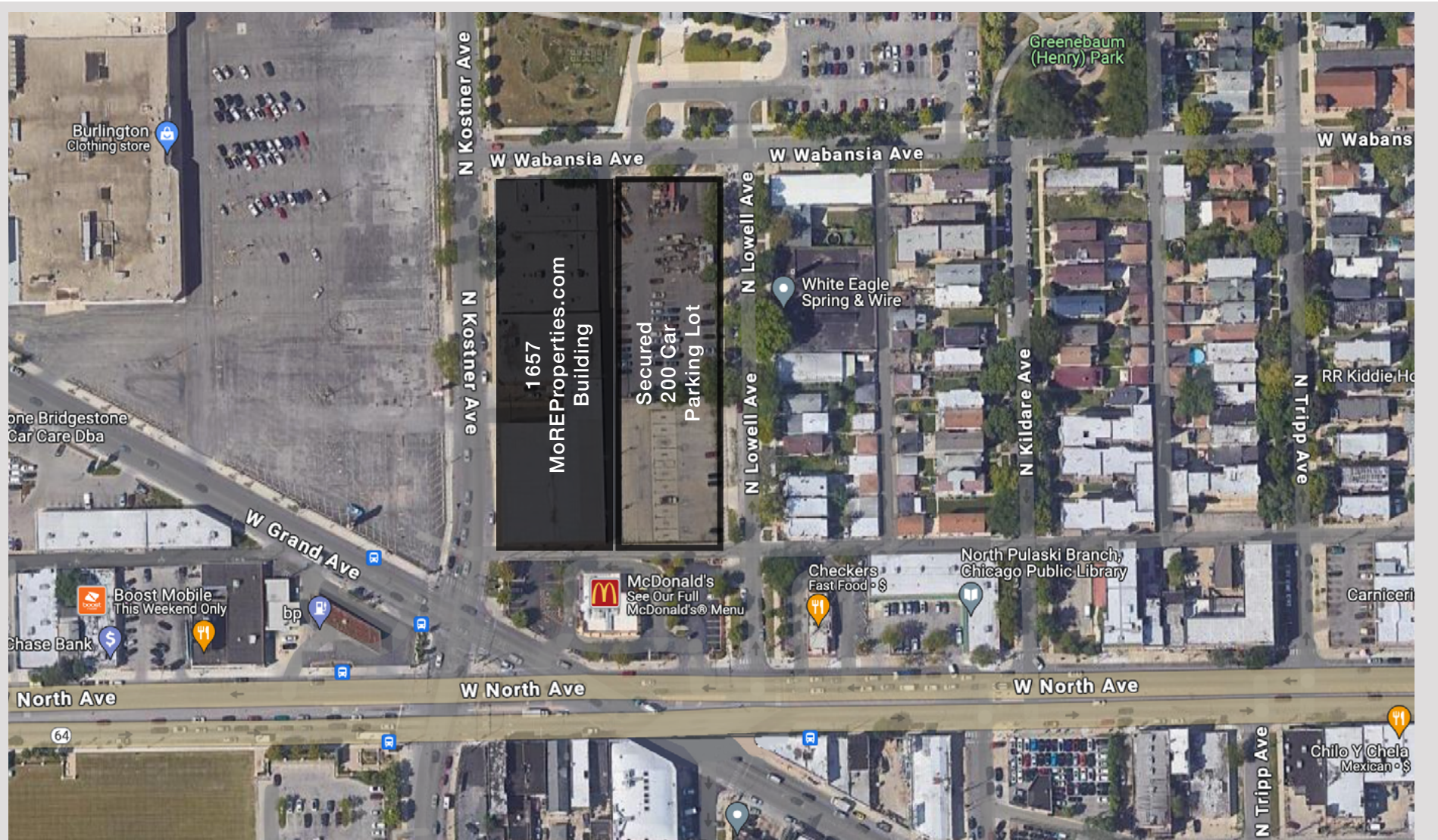

1657 NORTH KOSTNER AVENUE
CHICAGO, IL 60639

AERIAL VIEW

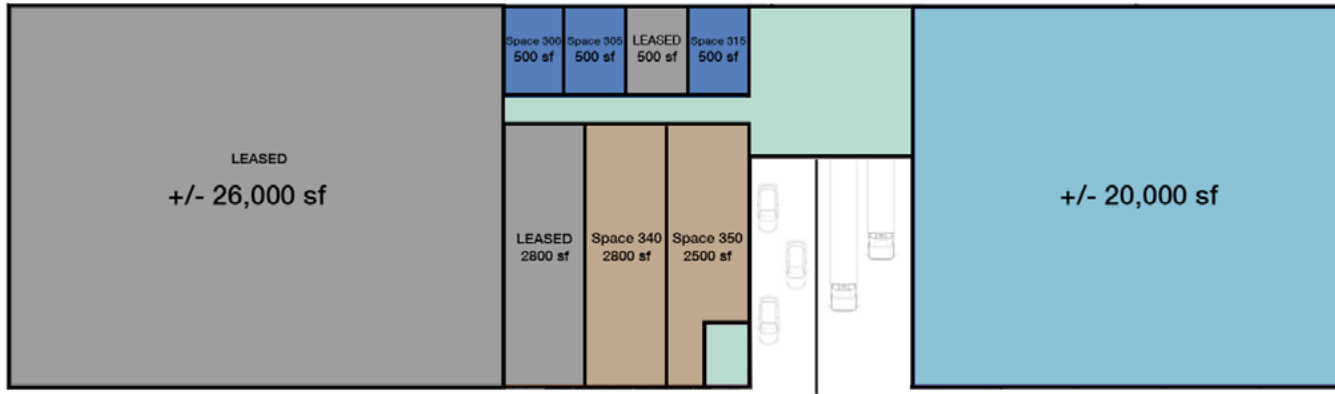

Second Floor

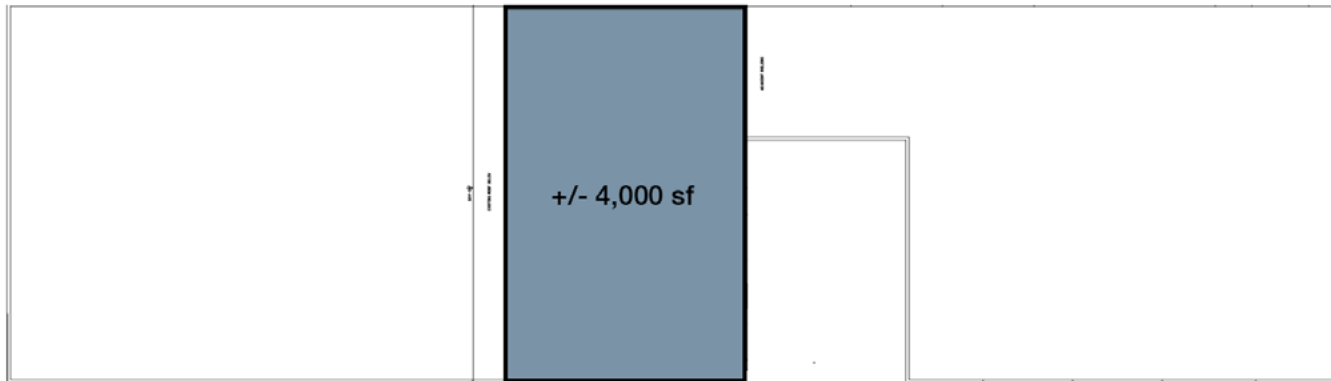

- LEASED
- Space 340 - 350
- Space 300
- Space 400
- Space 600
- Common Space

1657 NORTH KOSTNER AVENUE
CHICAGO, IL 60639

LEASING PLAN