

±28,380 SF | FOR SALE
4713 CARLISLE PIKE
MECHANICSBURG, PA 17050

PRIME RETAIL OPPORTUNITY



CARLISLE PIKE (ROUTE 11)

SITE HIGHLIGHTS:

- 28,380 SF +/- Multi Unit
- Neighborhood Strip Center
- Former Furniture Store
- Prominent Signage Available
- Will Sub Divide
- 85+ Surface Spaces
- Cell Tower On Site

LOCATION HIGHLIGHTS:

- Strong retail market.
- Great visibility with over 21,000 CPD.
- Dense demographics.

Contact:

Bradley Swidler
bswidler@lee-associates.com
D 717.208.8669



CARLISLE PIKE (ROUTE 11)

Carlisle Pike

All information furnished regarding property for sale, rental or financing is from sources deemed reliable, but no warranty or representation is made as to the accuracy thereof and same is submitted subject to errors, omissions, change of price, rental or other conditions prior to sale, lease or financing or withdrawal without notice. No liability of any kind is to be imposed on the broker herein.

±28,380 SF | FOR SALE
4713 CARLISLE PIKE
MECHANICSBURG, PA 17050

FLOOR PLANS

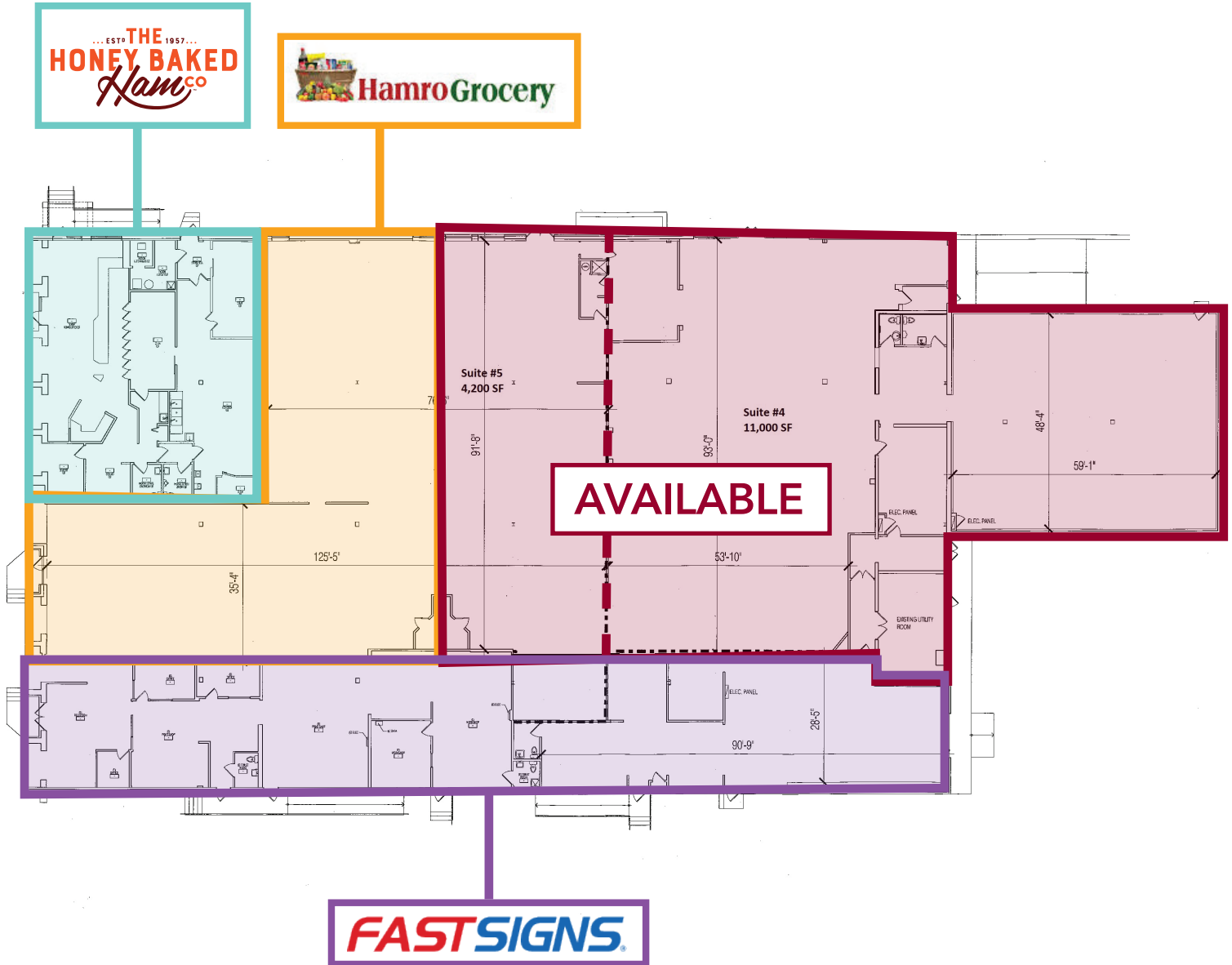

Contact:

Bradley Swidler
bswidler@lee-associates.com
D 717.208.8669

All information furnished regarding property for sale, rental or financing is from sources deemed reliable, but no warranty or representation is made as to the accuracy thereof and same is submitted subject to errors, omissions, change of price, rental or other conditions prior to sale, lease or financing or withdrawal without notice. No liability of any kind is to be imposed on the broker herein.

±28,380 SF | FOR SALE
 4713 CARLISLE PIKE
 MECHANICSBURG, PA 17050

RETAIL MAP



Contact:

Bradley Swidler
 bswidler@lee-associates.com
 D 717.208.8669

All information furnished regarding property for sale, rental or financing is from sources deemed reliable, but no warranty or representation is made as to the accuracy thereof and same is submitted subject to errors, omissions, change of price, rental or other conditions prior to sale, lease or financing or withdrawal without notice. No liability of any kind is to be imposed on the broker herein.

±28,380 SF | FOR SALE
4713 CARLISLE PIKE
 MECHANICSBURG, PA 17050

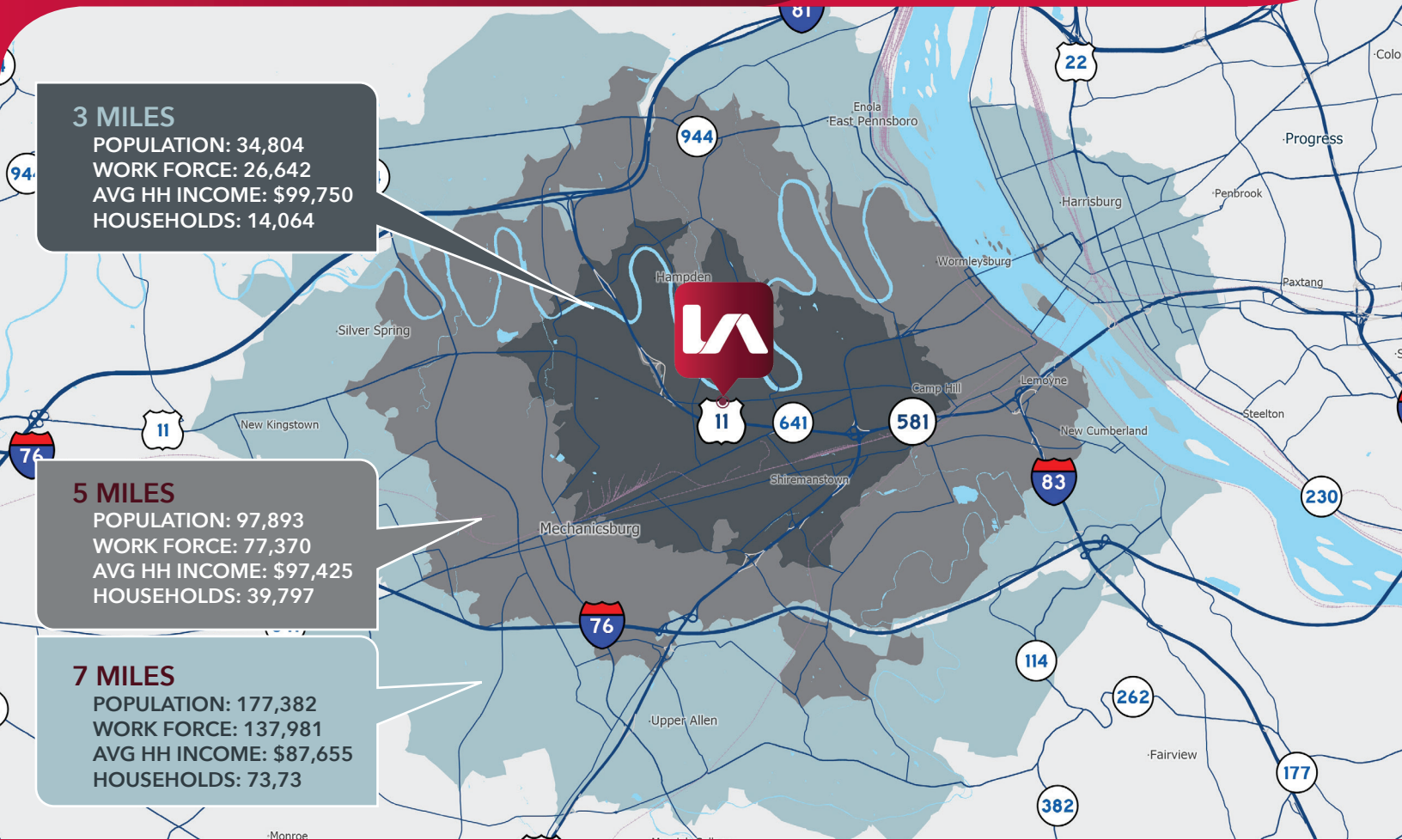

PROPERTY DETAILS:

APN:	10-21-0279-018
County:	Cumberland
Zoning:	C-L Hampden Township
Vacancy:	15,200 SF (54%) Suite 4: 11,000 SF Suite 5: 4,200 SF
Year Built:	1960 - Renovated 2010
Business Sign:	Available - Facia, 1 Pylon Signs

Lot Size:	4.50 Acres
Utilities:	Public
Tenants:	Honeybaked Ham, Fast Signs
Sprinkler System:	Yes
Electric:	400 amp
Parking:	3/1000
Sale Price:	\$5,000,000

EXISTING TENANTS:

American Tower	Ground Lease
Honey Baked Ham	3,000 SF
Hamro Grocery & Boutique	5,000 SF
Fast Signs	5,454 SF

Contact:
 Bradley Swidler
 bswidler@lee-associates.com
 D 717.208.8669

All information furnished regarding property for sale, rental or financing is from sources deemed reliable, but no warranty or representation is made as to the accuracy thereof and same is submitted subject to errors, omissions, change of price, rental or other conditions prior to sale, lease or financing or withdrawal without notice. No liability of any kind is to be imposed on the broker herein.