

SPACE FOR LEASE

6500 MINERAL DRIVE is a well maintained, multi-story professional office building located just off Highway 95, adjacent to the Federal Courthouse in Coeur d'Alene, ID.

Multiple Suites Available

Lease Type: Gross + Janitorial

Lease Term: 3+ years (5 years preferred)

Lease Rate: \$24.00 PSF / year
\$2.00 PSF / month)

PROPERTY HIGHLIGHTS

- Easy access & central location
- Abundant on-site parking
- Expansive common area
- Fully elevator served
- Fitness room with locker rooms and showers
- Lots of natural light throughout
- Secured Building w/afterhour access

PROFESSIONAL OFFICE SUITES

6500 N Mineral Drive
Coeur d'Alene, ID 83815

[View
Location](#)



CHRIS SCHREIBER

208.770.2593

chris.schreiber@kiemleahagood.com

CASEY BRAZIL

208.770.2595

casey.brazil@kiemleahagood.com

**KIEMLE
HAGOOD**

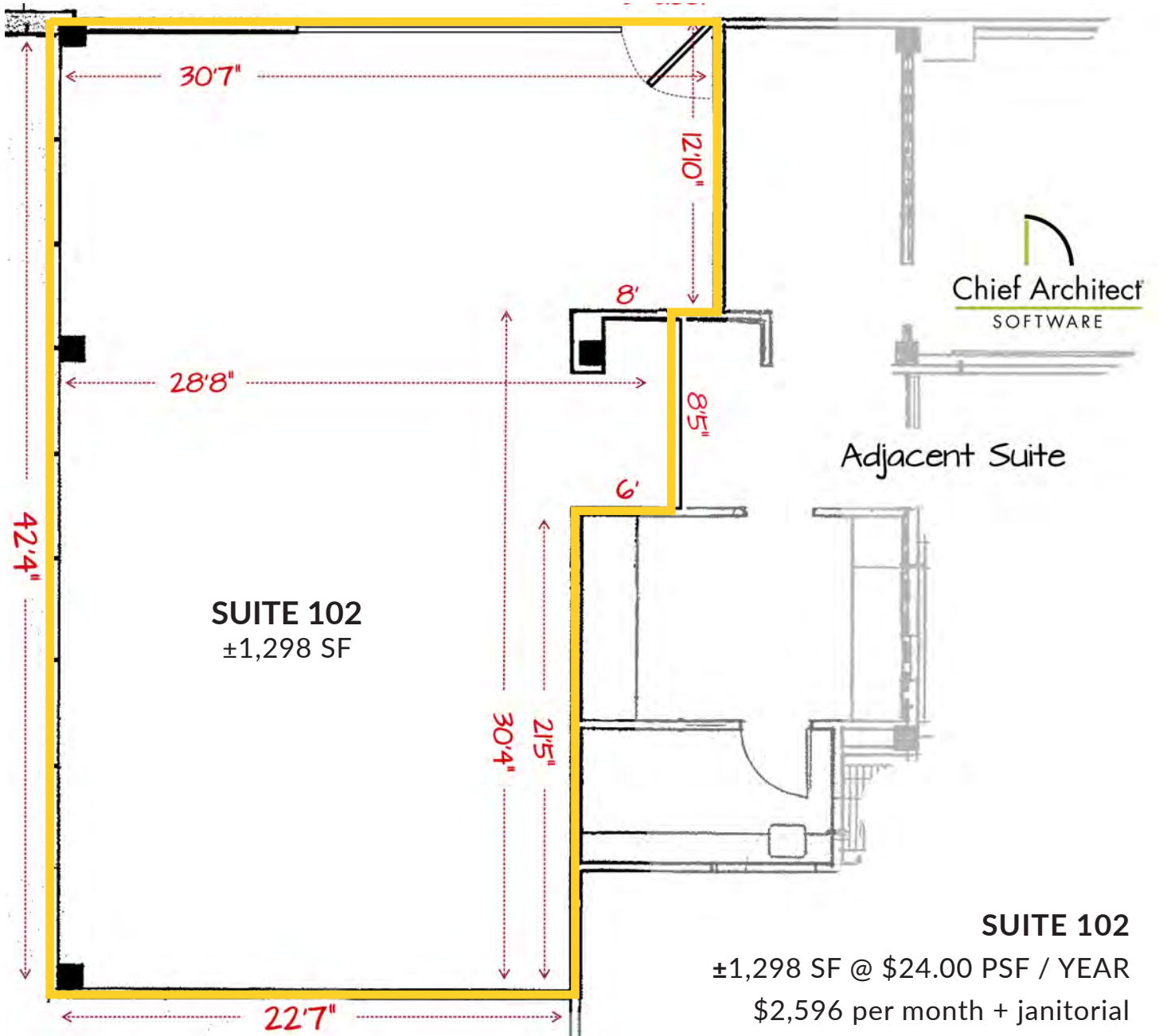

SPACE HIGHLIGHTS

- Ground floor suite
- Adjacent to main entrance
- Open floor plan
- Floor to ceiling windows
- Laminate wood flooring
- Drop ceilings
- Central HVAC





SPACE HIGHLIGHTS

- Second floor (elevator served)
- 5 x 14x14 Offices
- Breakroom with sink
- Floor to ceiling windows

SUITE 204

±3,540 SF @ \$24.00 PSF / YEAR
\$7,080 per month + janitorial

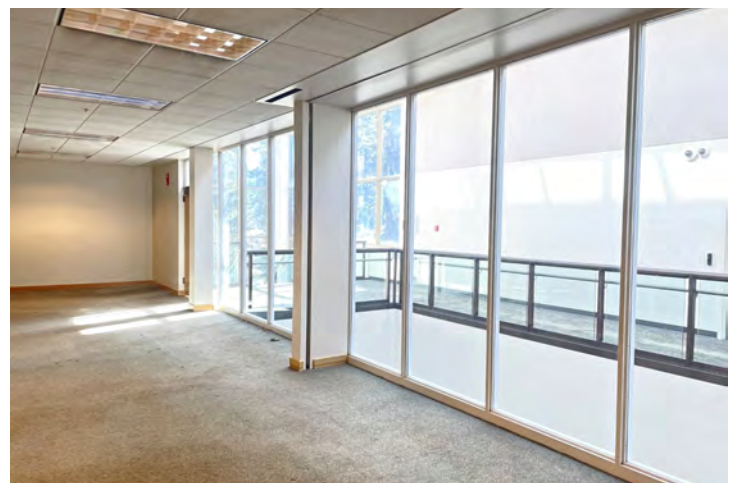

PROFESSIONAL OFFICE SUITES

6500 N Mineral Drive | Coeur d'Alene, ID



PROFESSIONAL OFFICE SUITES

6500 N Mineral Drive | Coeur d'Alene, ID

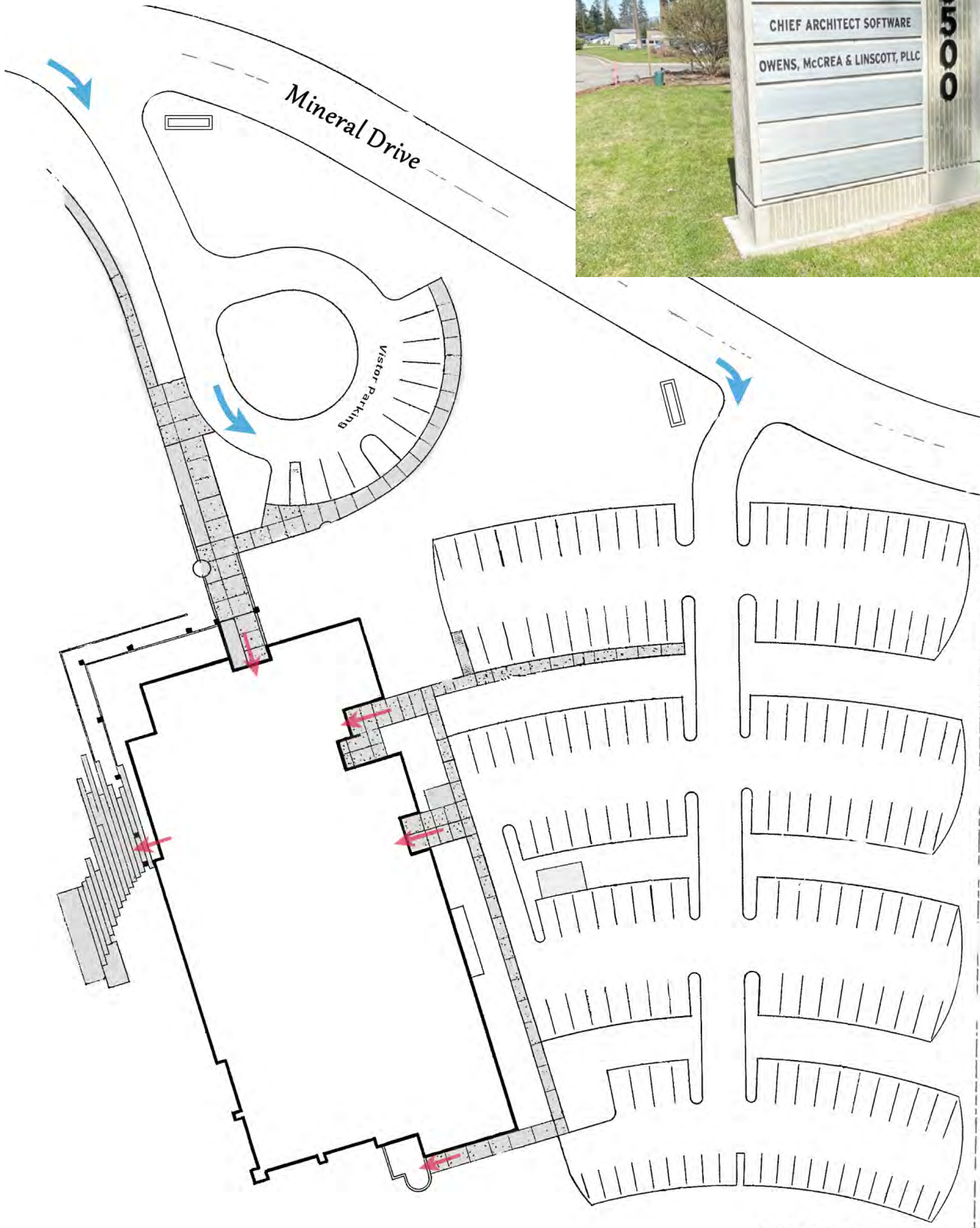

PARKING	
118	STANDARD
16	COMPACT
4	HANDICAP
168	TOTAL

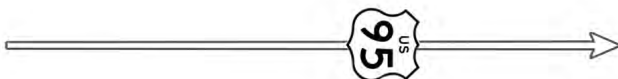

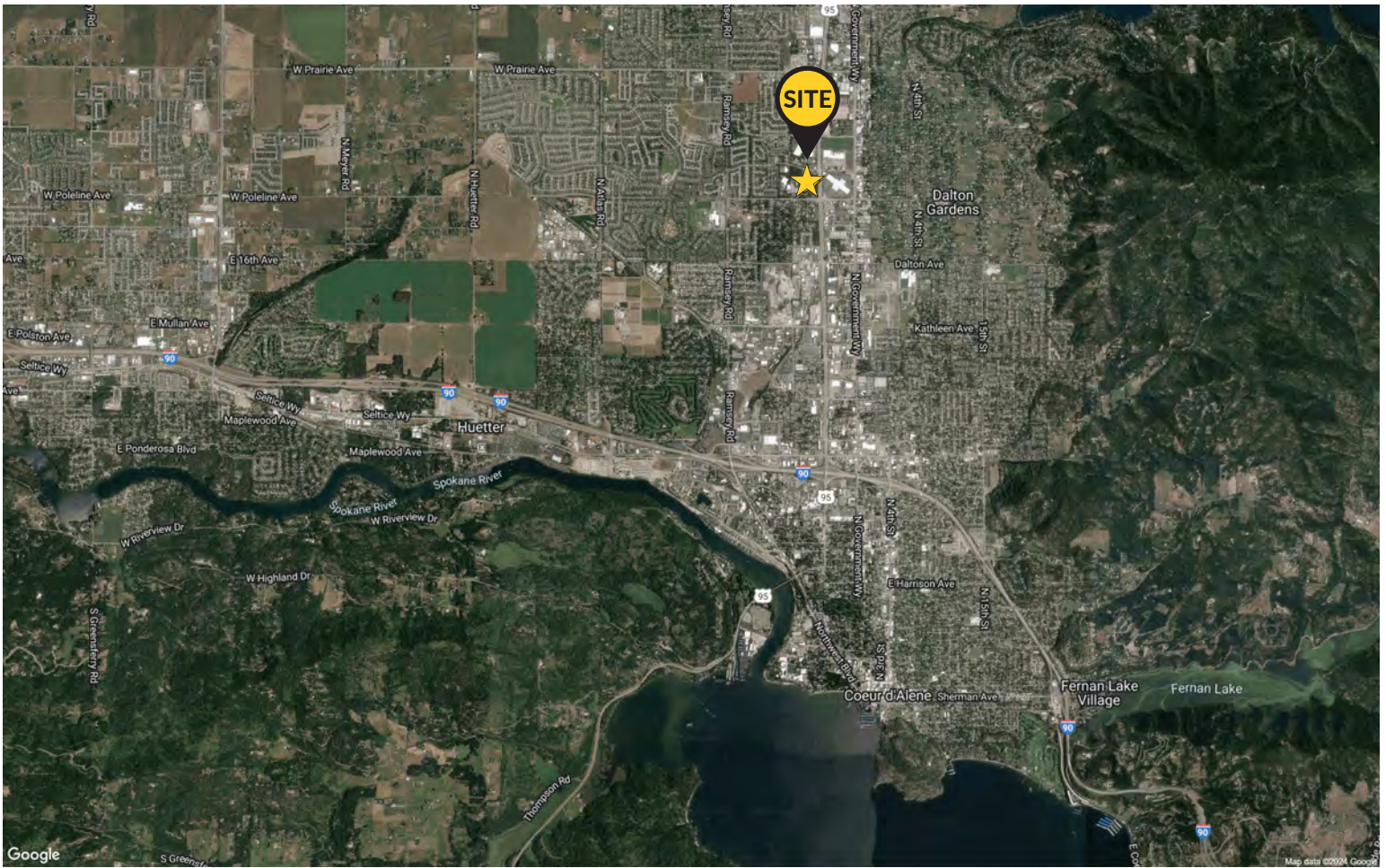

PROFESSIONAL OFFICE SUITES

6500 N Mineral Drive
Coeur d'Alene, ID 83815

CHRIS SCHREIBER

208.770.2593 chris.schreiber@kiemlehagood.com

CASEY BRAZIL

208.770.2595 casey.brazil@kiemlehagood.com



1579 W RIVERSTONE DRIVE, SUITE 102
COEUR D'ALENE, ID 83814

OFFICE LOCATIONS

SPOKANE | COEUR D'ALENE | TRI-CITIES | PALOUSE | MISSOULA

No warranty or representation, expressed or implied, is made by Kiemle Hagood, its agents or its employees as to the accuracy of the information contained herein. All information furnished is from sources deemed reliable and submitted subject to errors, omissions, change of terms and conditions, prior sale, lease or financing, or withdrawal without notice. No one should rely solely on the above information, but instead should conduct their own investigation to independently satisfy themselves.

Kiemle Hagood respects the intellectual property of others:

If you believe the copyright in your work has been violated through this Website, please contact our office for notice of claims of copyright infringement. For your complaint to be valid under the Digital Millennium Copyright Act of 1998 (DMCA), you must provide the following information when providing notice of the claimed copyright infringement: Identify the material on the Website that you believe infringes your work, with enough detail so that we may locate it on the Website; provide your address, telephone number and email address; provide a statement that you have a good faith belief that the disputed use is not authorized by the copyright owner, its agent, or the law; provide a statement that the information in the notification is accurate, and under penalty of perjury, that the complaining party is authorized to act on behalf of the owner of an exclusive right that is allegedly infringed; and provide your physical or electronic signature. Upon receiving your complaint, Kiemle Hagood will, upon review, remove content that you believe infringes your copyright if the complaint is found to be valid.