

OFFICE SPACE FOR LEASE  
1,506 SQ. FT.  
AVAILABLE

TALBERT EXECUTIVE BUILDING



10061 TALBERT AVENUE, FOUNTAIN VALLEY, CA 92708

PROPERTY FEATURES:

- CONVENIENT CENTRAL ORANGE COUNTY LOCATION WITH IMMEDIATE FREEWAY ACCESS TO THE 405 FREEWAY FOR SHORTER COMMUTE TIMES
- CLOSE BY TO A WIDE RANGE OF SERVICES INCLUDING RESTAURANTS, SHOPPING, FINANCIAL & RECREATIONAL OPPORTUNITIES MAXIMIZING TENANT'S AVAILABLE TIME FOR WORK & PERSONAL NEEDS
- CLEAN ARCHITECTURAL STYLING PROVIDING A PROFESSIONAL OFFICE APPEARANCE
- LARGE OFFICE WINDOWS WITH AN ABUNDANCE OF NATURAL LIGHT FOR A PLEASANT & PRODUCTIVE WORKING ENVIRONMENT
- ABOVE STANDARD QUALITY BUILDING FINISHES

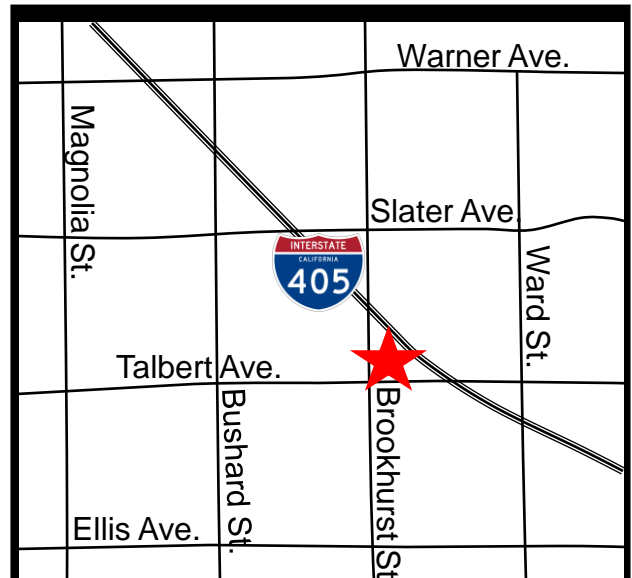

FOR MORE INFORMATION CONTACT:

**FRED SPITZKEIT, CCIM**

CAL DRE Lic#00857810

[WWW.ASHWILLASSOCIATES.COM](http://WWW.ASHWILLASSOCIATES.COM)

(714) 456-0500 x131

FRED@ASHWILLASSOCIATES.COM

**Ashwill  
Associates**  
COMMERCIAL REAL ESTATE

Information contained herein has not been verified by real estate brokers. Although we have no reason to doubt its accuracy, we do not guarantee it. Buyers and tenants should verify information independently.

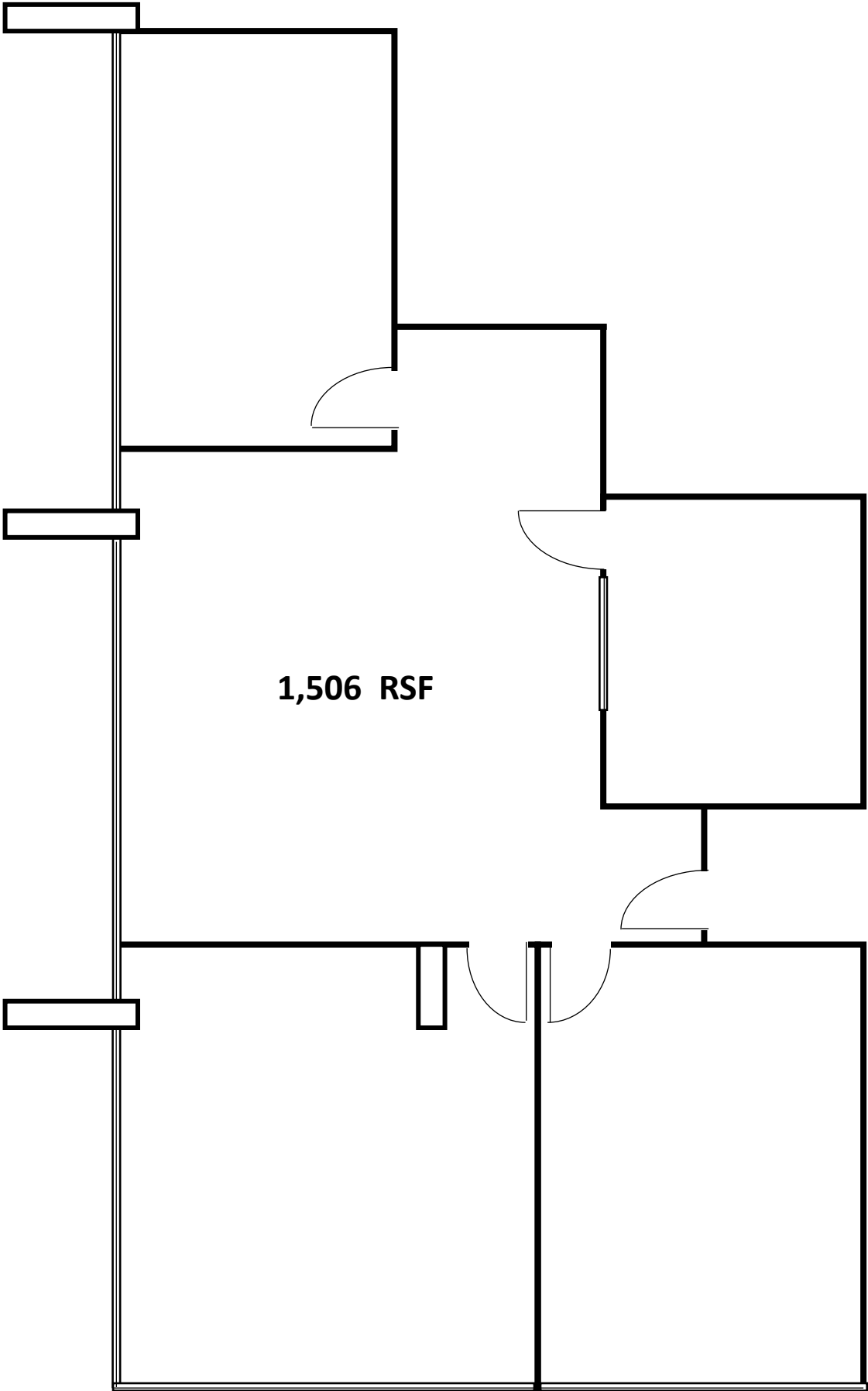

1,506 RSF

10061 Talbert Ave., Suite 390  
Fountain Valley, CA

*\*\*NOT TO SCALE\*\**