

The Klabin Company

19700 S Vermont Ave, Suite 100 Torrance, CA 90502 | 310-329-9000

Available SF 23,949 SF

Industrial For Sublease

Building Size 46,479 SF

Address:

1521 Francisco St, Unit B, Torrance, CA 90501

Cross Streets:

Normandie Ave/Francisco St

Sublease Through 9/30/2026
 Image, Loading & Location
 5 Dock High Positions
 Racking Can be Included
 ESFR Sprinkler System
 Concrete Yard

Lease Rate/Mo: \$29,936
Lease Rate/SF: \$1.25
Lease Type: Net / Op. Ex: \$0.25
Available SF: 23,949 SF
Minimum SF: 23,949 SF
Prop Lot Size: POL
Term: Sublease Through 9/30/2026
Sale Price: NFS
Sale Price/SF: NFS
Taxes:
Yard: Paved
Zoning: M3-1

Sprinklered: ESFR
Clear Height: 30'
GL Doors/Dim: 1
DH Doors/Dim: 5
A: 600 V: 277/480 O: 3 W: 4
Construction Type: TILT UP
Const Status/Year Blt: Existing / 2012
Whse HVAC: No
Parking Spaces: 22 / **Ratio:** 0.9:1
Rail Service: No
Specific Use: Warehouse/Distribution

Office SF / #: 6,189 SF / 5
Restrooms: 6
Office HVAC: Heat & AC
Finished Ofc Mezz: 2,776 SF
Include In Available: Yes
Unfinished Mezz: 0 SF
Include In Available: No
Possession: 30 Days
Vacant: No
To Show: Call broker
Market/Submarket: Torrance
APN#: 7351021045

Listing Company: The Klabin Company

Agents: [Matt Stringfellow 310-329-9000](#), [Scott Andersen 310-329-9000](#), [Tyler Rollema 310-329-9000](#)
Listing #: 41811876

Listing Date: 01/24/2025

FTCF: CB300N000S000/A0AA

Notes: Sublessee to verify all information.

1521 Francisco Street, Unit B | Torrance, CA 90501 | 23,949 SF

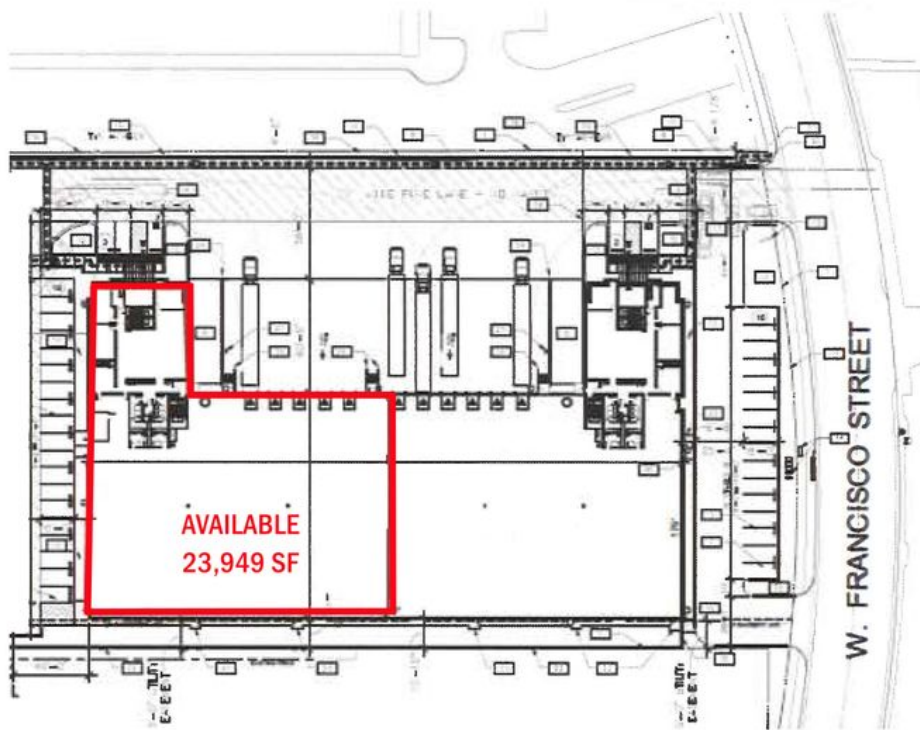
SITE PLAN
INDUSTRIAL PROPERTY FOR LEASE

KLABIN
 A member of the CORFAC International network

MATT STRINGFELLOW, SIOR
 Principal
 310.329.9000 X1120
 matts@klabin.com
 Lic. 01410219

SCOTT ANDERSEN
 Senior Associate
 310.329.9000 X1242
 scotta@klabin.com
 Lic. 02070384

TYLER ROLLEMA, SIOR
 Principal
 310.329.9000 X1140
 tyler@klabin.com
 Lic. 01917920



Matt Stringfellow
 matts@klabin.com
 310-329-9000