

**INDUSTRIAL PROPERTY // FOR SALE**

# 43,522 SF "CLASS A" CORPORATE IMAGE FACILITY AT I-96 SERVICE DRIVE

32235 INDUSTRIAL RD  
LIVONIA, MI 48150



- 43,522 SF corporate image facility
- Excellent owner/user opportunity
- 6,542 SF office space
- 100% AC throughout
- 22' clear height, two overhead doors, two truckwells
- 2,000 amp, 3-phase power
- Four cranes with 1-5-ton capacity



**P.A. COMMERCIAL**  
Corporate & Investment Real Estate

26555 Evergreen Road, Suite 1500  
Southfield, MI 48076  
248.358.0100  
[pacommercial.com](http://pacommercial.com)

We obtained the information above from sources we believe to be reliable. However, we have not verified its accuracy and make no guarantee, warranty or representation about it. It is submitted subject to the possibility of errors, omissions, change of price, rental or other conditions, prior sale, lease or financing, or withdrawal without notice. We include projections, opinions, assumptions or estimates for example only, and they may not represent current, past or future performance of the property. You and your tax and legal advisors should conduct your own investigation of the property and transaction.



32235 INDUSTRIAL RD, LIVONIA, MI 48150 // FOR SALE

# EXECUTIVE SUMMARY

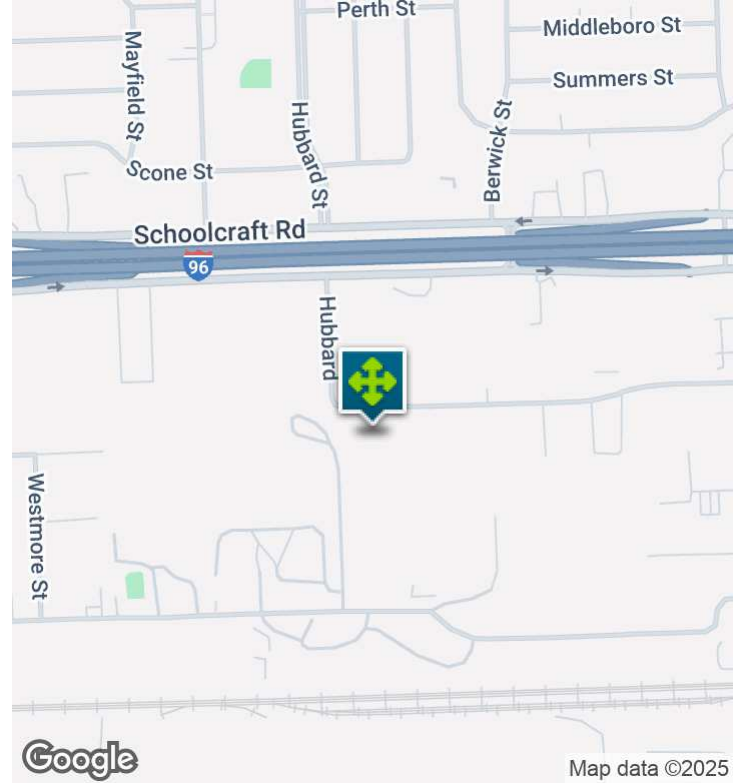

<b>Sale Price</b>	<b>\$4,875,000</b>
-------------------	--------------------

## OFFERING SUMMARY

<b>Building Size:</b>	43,522 SF
<b>Lot Size:</b>	2.58 Acres
<b>Price / SF:</b>	\$114.65
<b>Year Built:</b>	1995
<b>Renovated:</b>	2006
<b>Zoning:</b>	M-2
<b>Market:</b>	Detroit
<b>Submarket:</b>	Livonia
<b>Traffic Count:</b>	144,304

## PROPERTY OVERVIEW

Rare owner/user opportunity to purchase a high-image, 100% AC industrial building in Livonia! This building was built-to-suit for Interlink Technologies in 1995 and no expense was spared. The building is full brick and block construction, and features a 43,522 SF warehouse, 22' clear height, two overhead doors with 16' height, two truckwells, four cranes ranging from 1 ton to 5-tons, 2,000 amp, 3-phase power, sprinkler system, buss duct, airlines, and exhaust fans. The office is 6,542 SF and there is an additional 6,144 SF mezzanine that isn't included in the building size. M-2 Zoning district allows for a broad range of industrial applications.

## LOCATION OVERVIEW

Excellent location in one of metro Detroit's most desirable industrial areas - on the south side of the -96 service drive, just west of Merriman Rd.

## PROPERTY HIGHLIGHTS

- 43,522 SF corporate image industrial building
- 6,542 SF office space
- 100% AC throughout
- 22' clear height, two overhead doors, two truckwells



**Dave Plumley** CFO/MANAGING MEMBER

D: 248.281.9901 | C: 248.877.9202

dave@pacommercial.com

We obtained the information above from sources we believe to be reliable. However, we have not verified its accuracy and make no guarantee, warranty or representation about it. It is submitted subject to the possibility of errors, omissions, change of price, rental or other conditions, prior sale, lease or financing, or withdrawal without notice. We include projections, opinions, assumptions or estimates for example only, and they may not represent current, past or future performance of the property. You and your tax and legal advisors should conduct your own investigation of the property and transaction.

32235 INDUSTRIAL RD, LIVONIA, MI 48150 // FOR SALE

## INDUSTRIAL DETAILS

<b>Property Type:</b>	Industrial / Manufacturing
<b>Building Size:</b>	43,522 SF
<b>Shop SF:</b>	36,980 SF
<b>Office SF:</b>	6,542 SF
<b>Mezzanine SF:</b>	6,144 SF (not included in gross building area)
<b>Occupancy:</b>	Owner will vacate at sale
<b>Zoning:</b>	M-2
<b>Lot Size:</b>	2.58 Acres
<b>Parking Spaces:</b>	128
<b>Year Built / Renovated:</b>	1995 / 2006
<b>Construction Type:</b>	Brick & Block
<b>Clear Height:</b>	22'
<b>Overhead Doors:</b>	One (1) 12' W x 16' H One (1) 14' W x 16' H
<b>Truckwells/Docks:</b>	Two (2) 9' x 12'
<b>Cranes:</b>	Two (2) 1-Ton One (1) 3-Ton One (1) 5-Ton
<b>Underhook:</b>	1-Ton at 18" 3-Ton and 5-Ton at 16"
<b>Column Spacing:</b>	44' x 48'
<b>Power:</b>	480 Volt, 2000 Amp, 3-Phase
<b>Buss Duct:</b>	Yes
<b>Air Conditioning:</b>	Yes, 100% AC in entire Building
<b>Heat Type:</b>	Forced Air
<b>Lighting:</b>	Fluorescent
<b>Sprinklers:</b>	Yes
<b>Floor Drains:</b>	N/A
<b>Taxes:</b>	\$62,000 (2023)



**P.A. COMMERCIAL**  
Corporate & Investment Real Estate

**Dave Plumley** CFO/MANAGING MEMBER

**D:** 248.281.9901 | **C:** 248.877.9202

[dave@pacommercial.com](mailto:dave@pacommercial.com)

We obtained the information above from sources we believe to be reliable. However, we have not verified its accuracy and make no guarantee, warranty or representation about it. It is submitted subject to the possibility of errors, omissions, change of price, rental or other conditions, prior sale, lease or financing, or withdrawal without notice. We include projections, opinions, assumptions or estimates for example only, and they may not represent current, past or future performance of the property. You and your tax and legal advisors should conduct your own investigation of the property and transaction.

32235 INDUSTRIAL RD, LIVONIA, MI 48150 // FOR SALE

# SITE PLANS

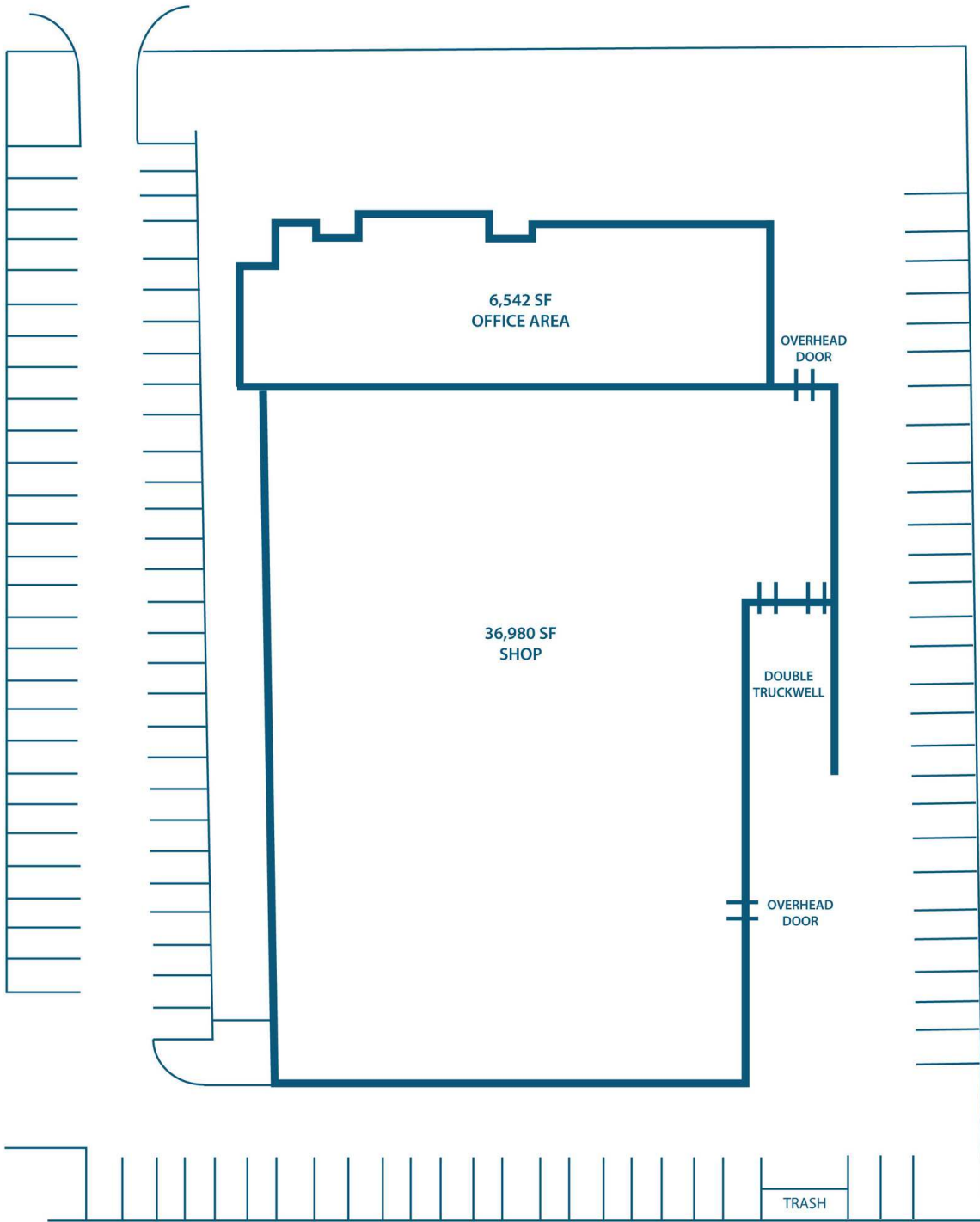



32235 INDUSTRIAL RD, LIVONIA, MI 48150 // FOR SALE  
FLOOR PLANS

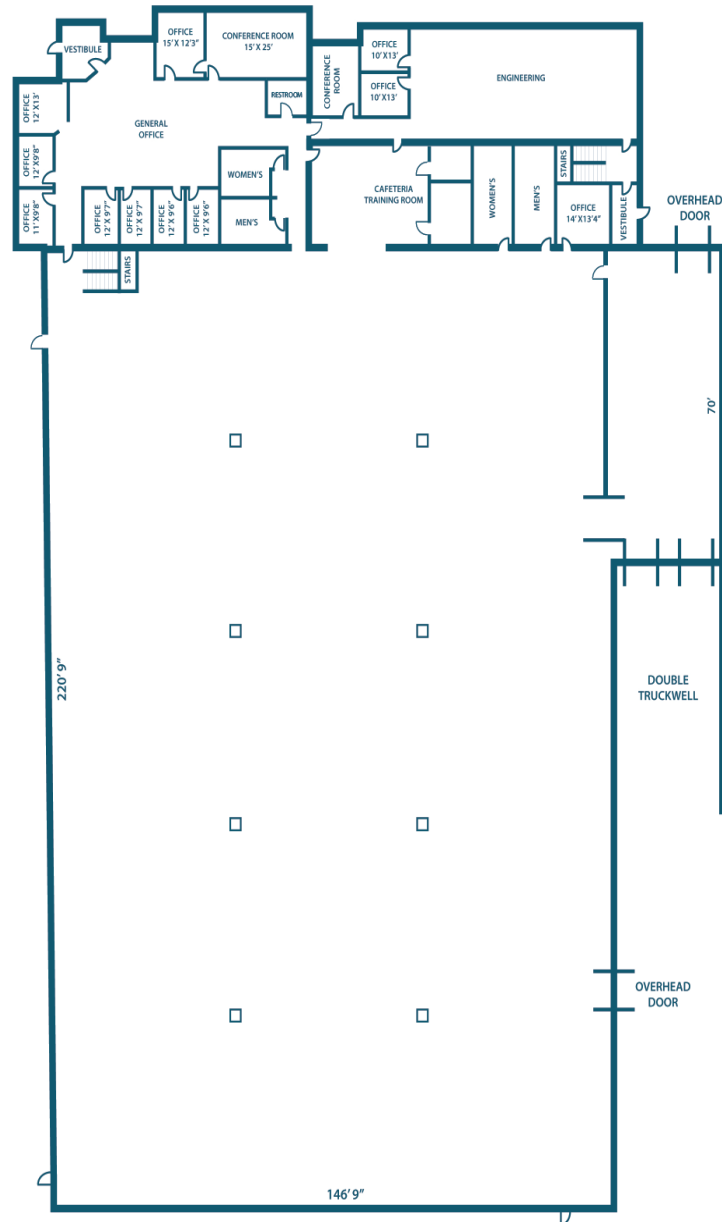



32235 INDUSTRIAL RD, LIVONIA, MI 48150 // FOR SALE

# ADDITIONAL PHOTOS





// FOR SALE

# ADDITIONAL PHOTOS





32235 INDUSTRIAL RD, LIVONIA, MI 48150 // FOR SALE

# AERIAL MAP

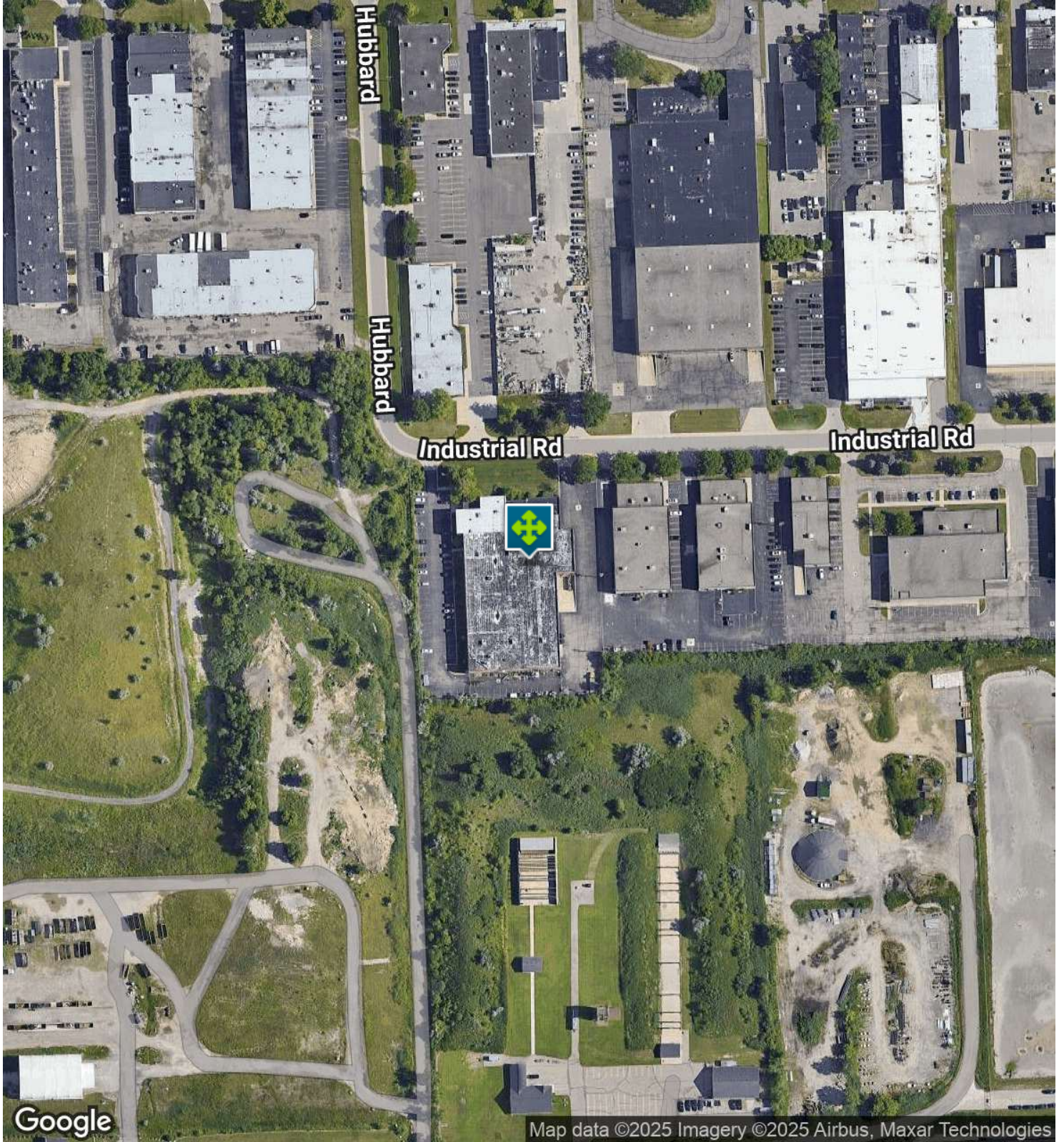



32235 INDUSTRIAL RD, LIVONIA, MI 48150 // FOR SALE

# LOCATION MAP

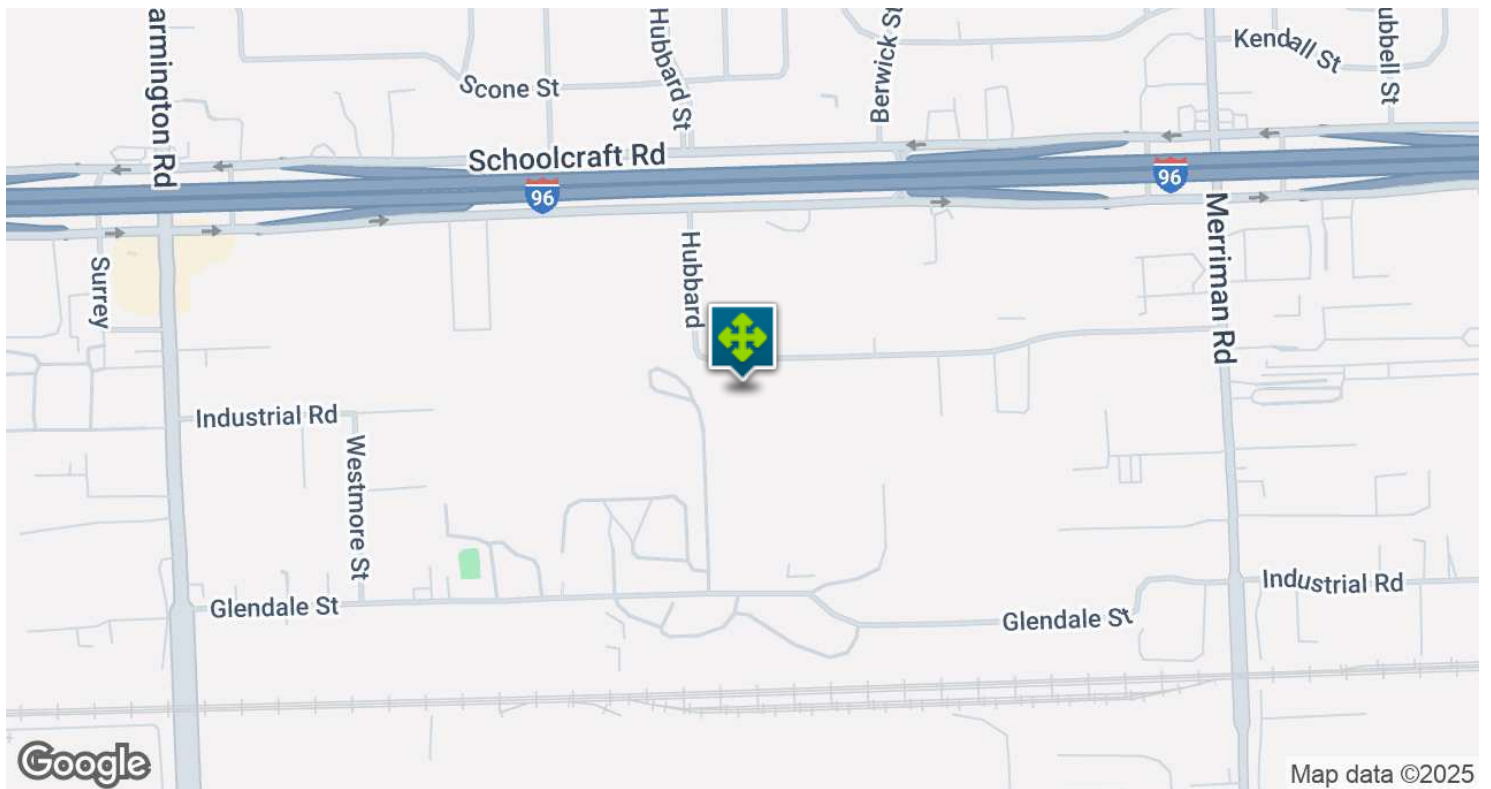
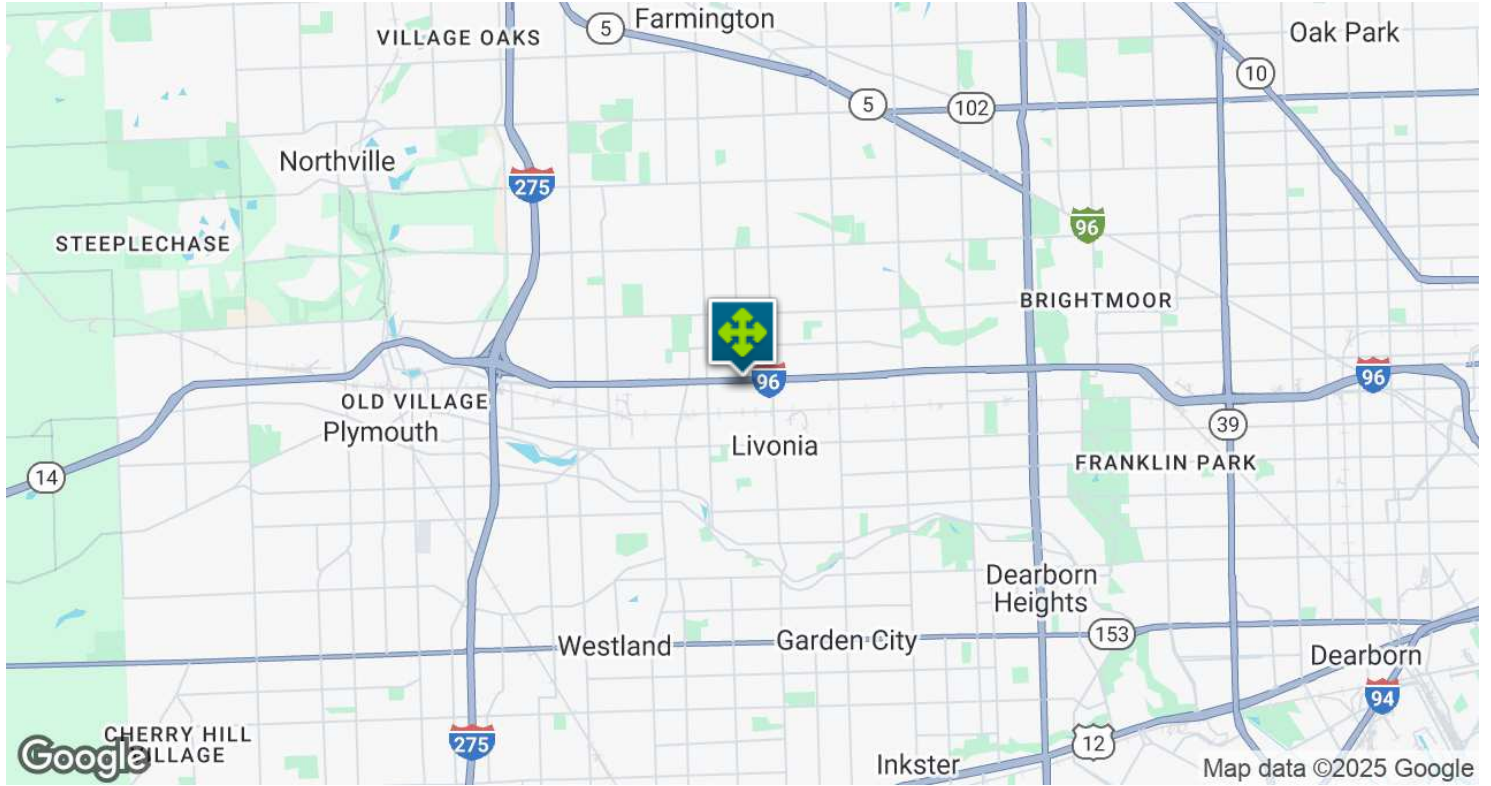

**Dave Plumley** CFO/MANAGING MEMBER  
D: 248.281.9901 | C: 248.877.9202  
dave@pacommercial.com

We obtained the information above from sources we believe to be reliable. However, we have not verified its accuracy and make no guarantee, warranty or representation about it. It is submitted subject to the possibility of errors, omissions, change of price, rental or other conditions, prior sale, lease or financing, or withdrawal without notice. We include projections, opinions, assumptions or estimates for example only, and they may not represent current, past or future performance of the property. You and your tax and legal advisors should conduct your own investigation of the property and transaction.



32235 INDUSTRIAL RD, LIVONIA, MI 48150 // FOR SALE

# DEMOGRAPHICS MAP & REPORT

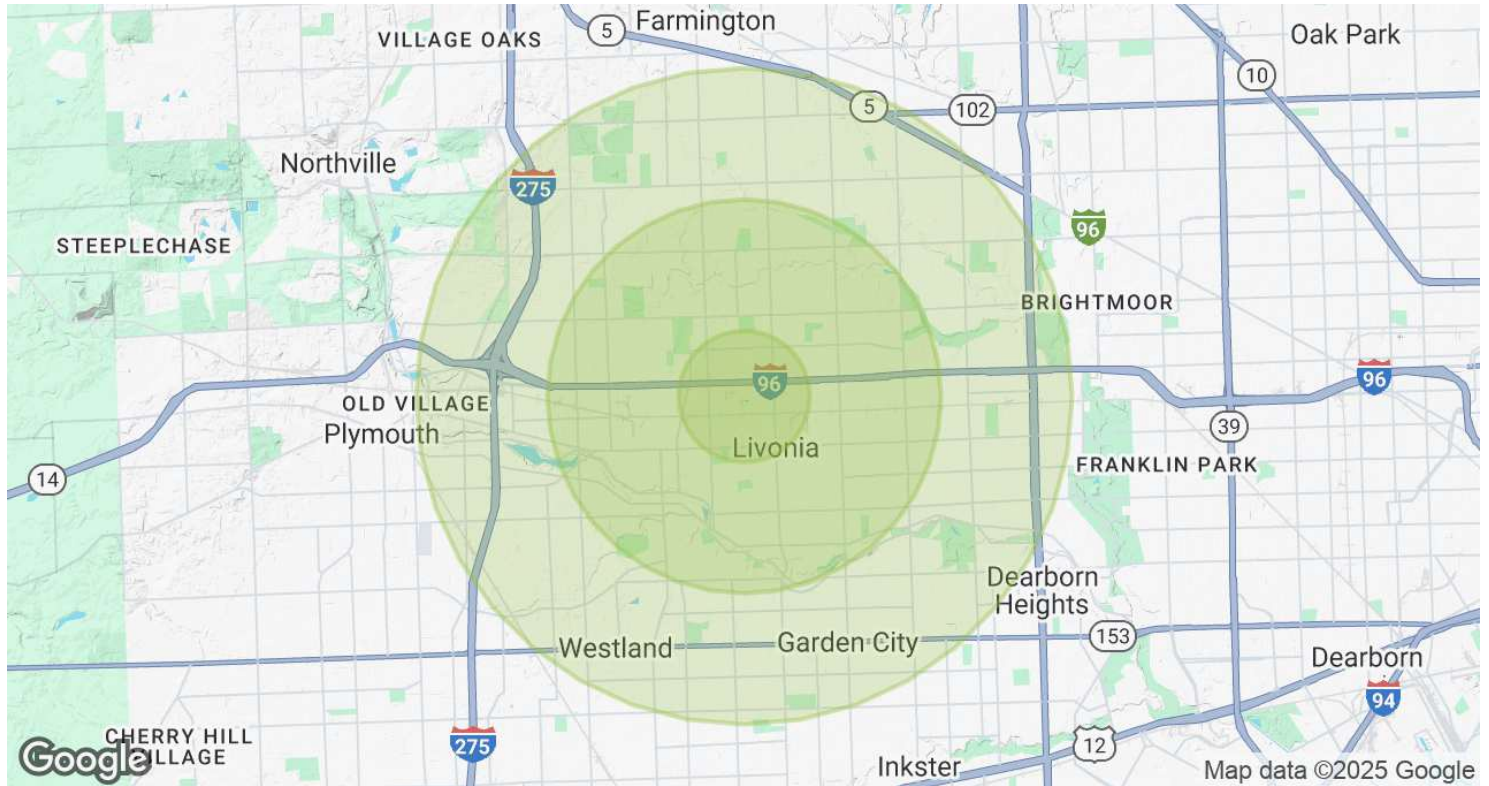

POPULATION	1 MILE	3 MILES	5 MILES
Total Population	5,994	82,196	256,944
Average Age	41.3	43.3	42.6
Average Age (Male)	40.9	41.8	40.6
Average Age (Female)	40.5	44.6	44.1
HOUSEHOLDS & INCOME	1 MILE	3 MILES	5 MILES
Total Households	2,403	34,439	112,617
# of Persons per HH	2.5	2.4	2.3
Average HH Income	\$88,586	\$85,498	\$74,330
Average House Value	\$212,675	\$179,753	\$164,628

2020 American Community Survey (ACS)



32235 INDUSTRIAL RD, LIVONIA, MI 48150 // FOR SALE

CONTACT US



FOR MORE INFORMATION, PLEASE CONTACT:



**Dave Plumley**

CFO/MANAGING MEMBER

**D:** 248.281.9901

**C:** 248.877.9202

dave@pacommercial.com

**P.A. Commercial**

26555 Evergreen Road, Suite 1500

Southfield, MI 48076

**P:** 248.358.0100

**F:** 248.358.5300

[pacommercial.com](http://pacommercial.com)

Follow Us!



We obtained the information above from sources we believe to be reliable. However, we have not verified its accuracy and make no guarantee, warranty or representation about it. It is submitted subject to the possibility of errors, omissions, change of price, rental or other conditions, prior sale, lease or financing, or withdrawal without notice. We include projections, opinions, assumptions or estimates for example only, and they may not represent current, past or future performance of the property. You and your tax and legal advisors should conduct your own investigation of the property and transaction.