



Up to 13,000 SF
Prime Endcap Retail Space Available

montclair place

CIM

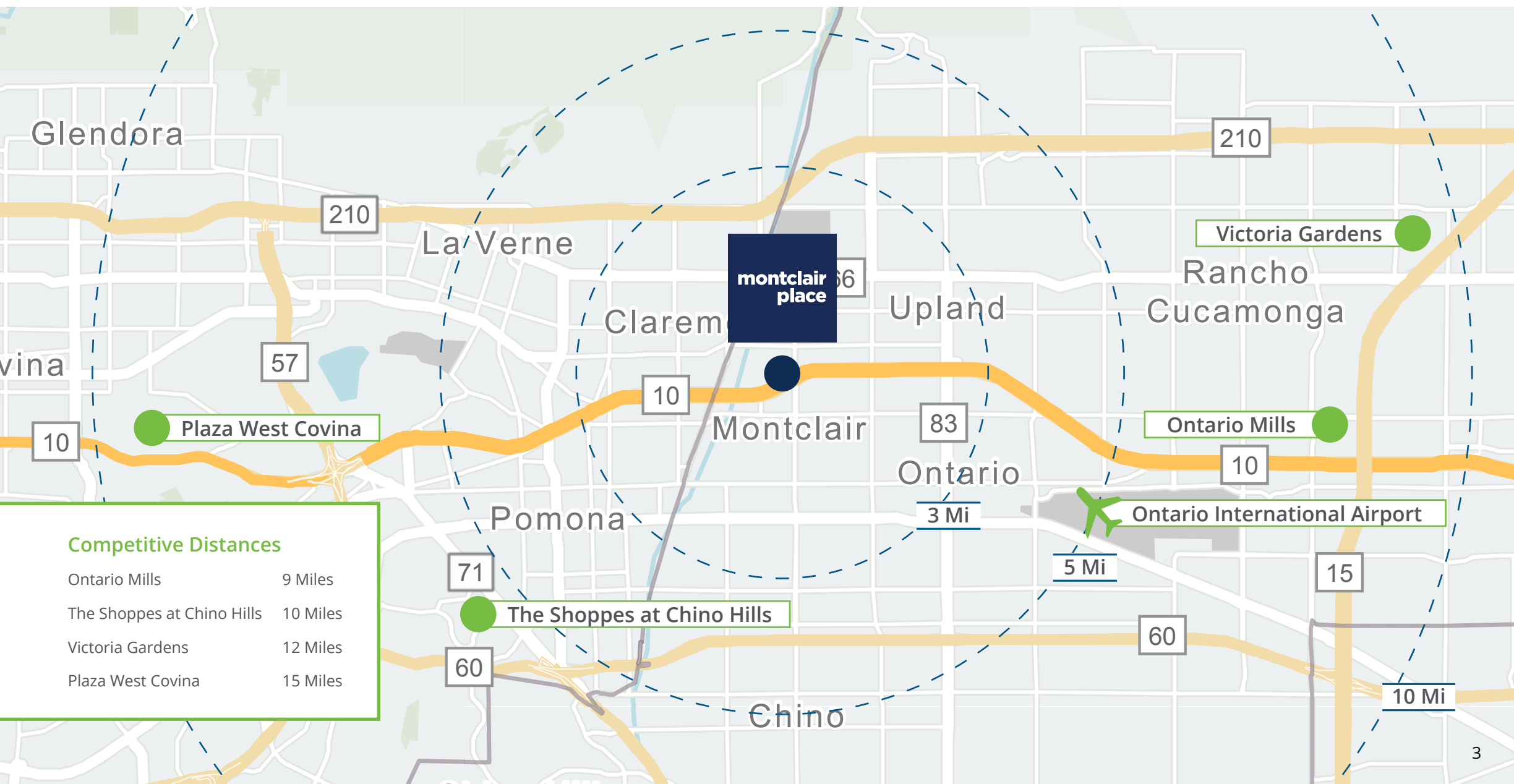

Table Of Contents

- [3 True Trade Area](#)
- [4 Aerial View](#)
- [5 Space Highlights](#)
- [6 Views of Space](#)
- [7 Montclair Place Highlights](#)

Montclair Place's Competitive Advantage

Montclair Place boasts a strategic location, offering a diverse array of retail options and dining experiences unparalleled within a five-mile radius. Its blend of desirable shops, entertainment venues, and convenient amenities establishes it as the premier destination for shoppers seeking both fun and convenience in the vicinity.



Aerial View



Available Space: Up to 13,000 SF

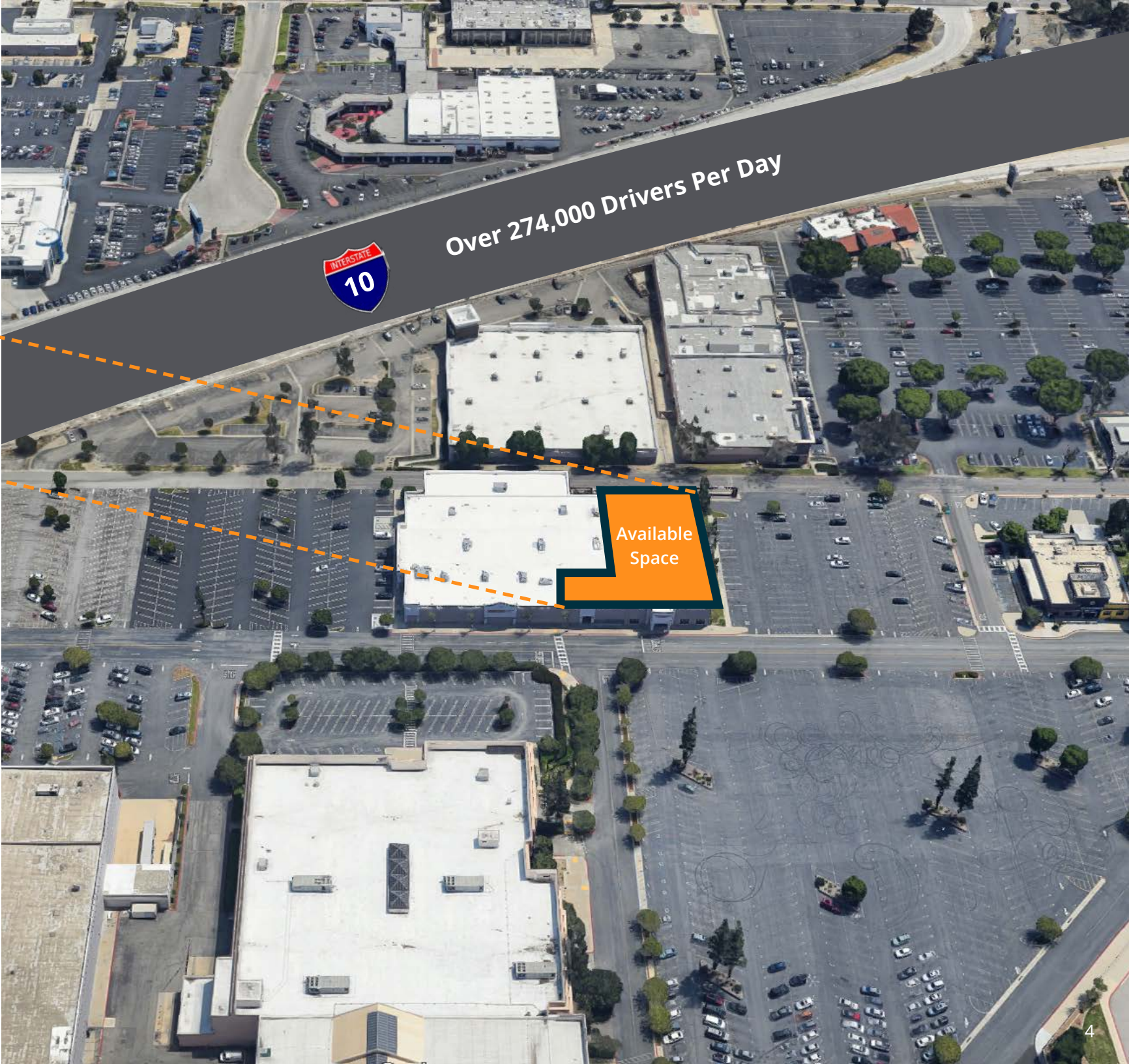

Available Floor Plan

Available Space up to 13,000 SF
(Can be Combined or Demised)

Unit B: 1,231 SF

Unit C: 12,000 SF

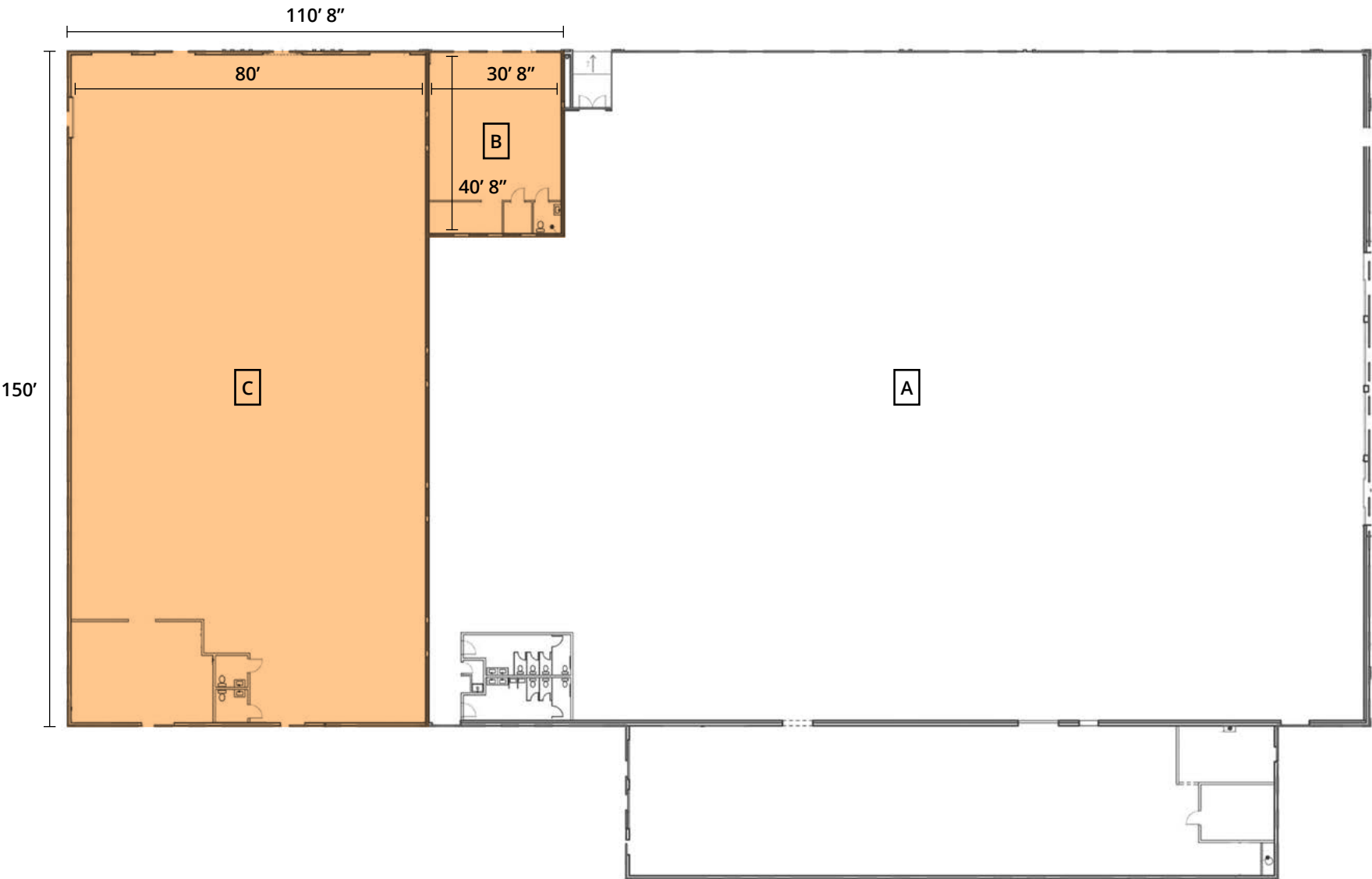





#1 Shopping Center Within a Five-Mile Radius

Montclair Place Highlights

Montclair Place is a 1.2 million-square-foot shopping and dining destination on the southwestern edge of San Bernardino County. This center recently unveiled a complete interior remodel including a twelve-unit Food Hall, and family entertainment.

6 Million
Annual Visits

110+
Retailers

56.7%
Returning Customers

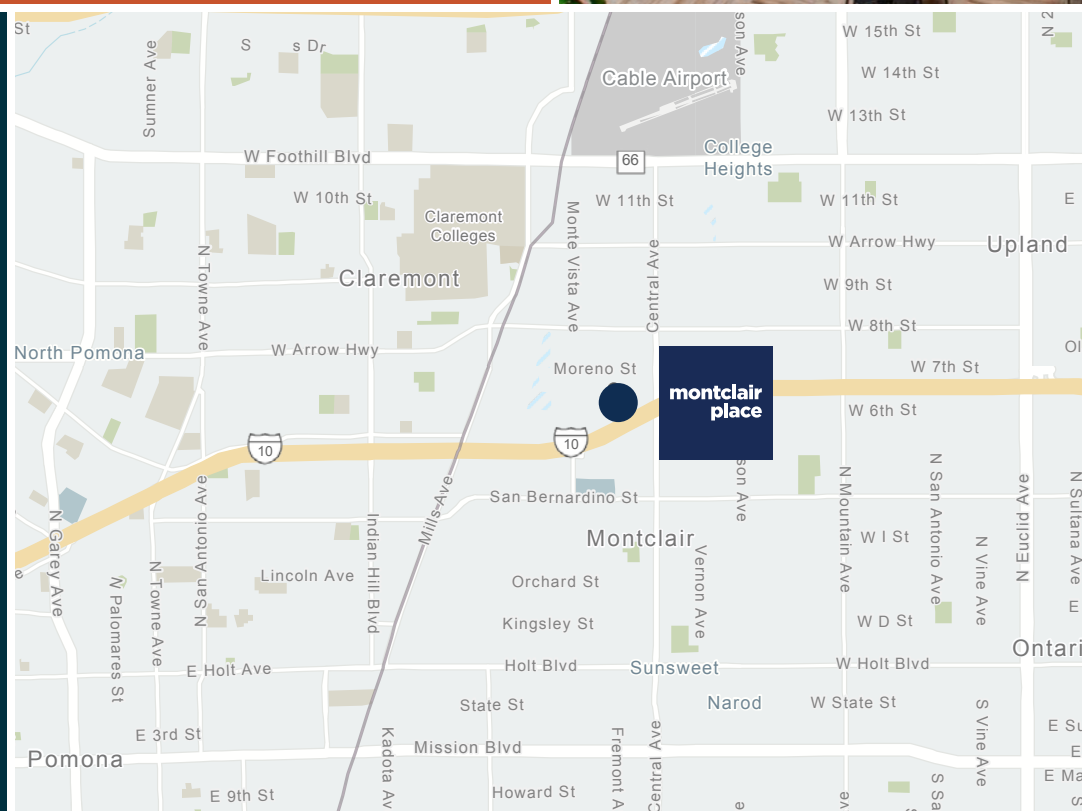

Convenient access to Interstate 10, Interstate 210 and Interstate 15

- Walking distance to the Metrolink Station and upcoming Gold Line Station
- 15 colleges within a 15-minute drive including: (110,000 combined student enrollment)
- A block away from Gold's Gym and LA Fitness
- Adjacent to major retail anchors such as Target, Costco, Walmart, Best Buy and Home Depot
- \$50.8 million annual food and beverage sales
- Average stay of 79 Minutes

For Leasing Opportunities Contact

Jennifer Meade

323.860.9523

jmeade@cimgroup.com

Lic #01298843



Creating Value. **Enhancing Communities.**

CIM is a community-focused real estate and infrastructure owner, operator, lender and developer. Our in-house team of experts work together to identify and create value in real assets, benefiting the communities in which we invest.

www.cimgroup.com