

# East Roslyn Business Center

## 548 Southpark Blvd. Colonial Heights, VA

*Flex Space with I-95 visibility, exit 53 (111,000 VPD) & directly off Southpark Blvd (51,000 VPD)*

*Adjacent tenants are a mix of local & national retailers*

*Close to retail stores & restaurants*

*Build to Suit options*

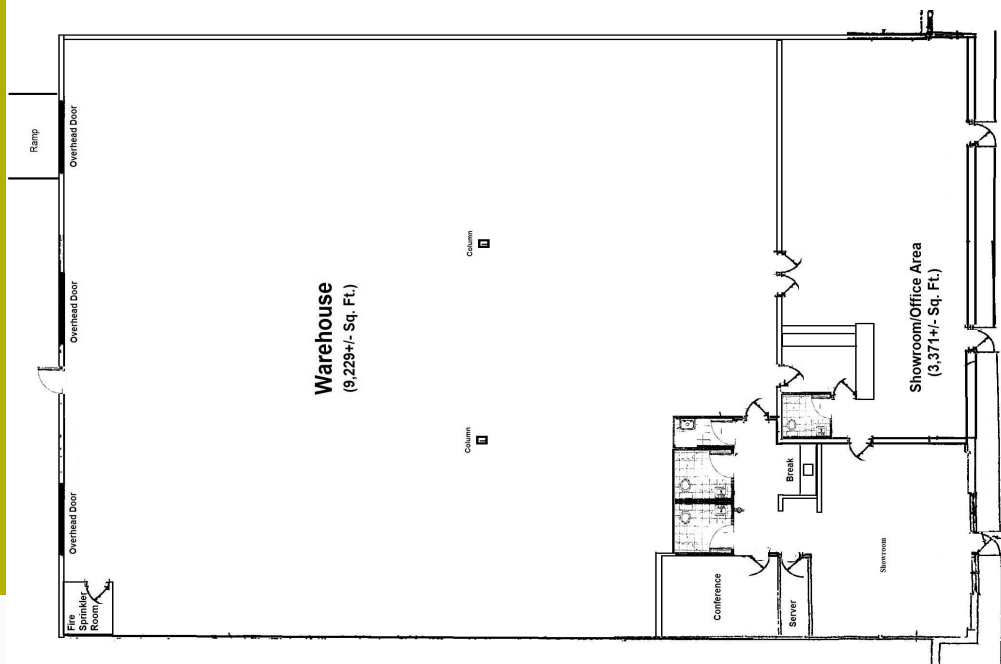

**548 Southpark Boulevard**  
**12,600 Sq. Ft.**  
**Colonial Heights, Virginia**  
**Roslyn Farm Corporation**  
**804.526.0820**



- 12,600 total sq. ft. broken up between 3,371 sq. ft. of office & 9,229 of warehouse
- Central Location Near Southpark Mall and Fort Lee
- Number of Docks: 2 with 1 drive-in bay
- 2 showrooms, counter area, 1 large conference room, 2 private bathrooms & a breakroom

**Fielding Quarles**  
**fquarles@roslynfarmcorp.com**  
**Phone: 804.526.0820**  
**Fax: 804.526.0931**  
**www.roslynfarmcorp.com**