

# Maison au Pont

INTRODUCING

2444, 2446, 2450 & 2452 LOMBARD STREET

## The Marina's Most Anticipated New Retail Addresses

**JS SULLIVAN**  
SALES | MARKETING

**URBANGROUP**  
REAL ESTATE



# A Unique Collection of Streetfront Retail Spaces

## HIGHLIGHTS

- Beautiful glass storefront on Lombard Street
- Gorgeous new construction offers blank canvas ready to be individualized
- Delivered in warm shell condition
- ADA restroom
- Comprehensive sprinkler system
- 200-amp electric service



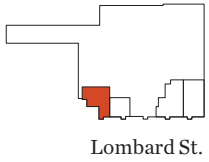
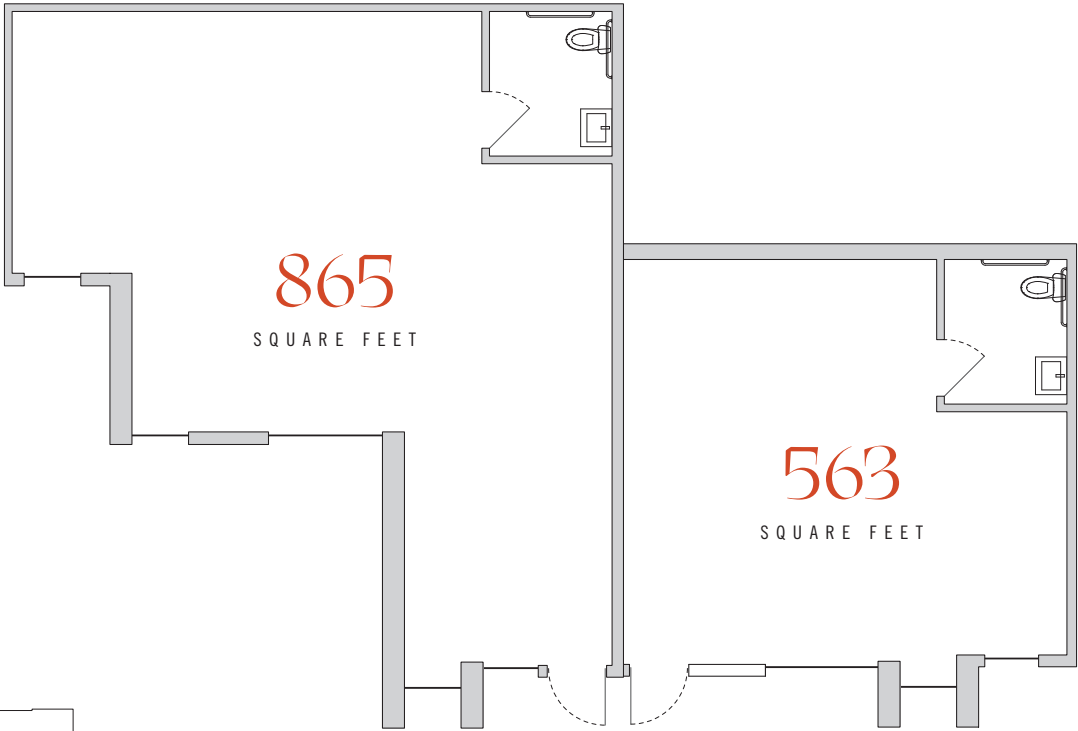

**2452 Lombard Street**  
(COMMERCIAL A)

**2450 Lombard Street**  
(COMMERCIAL B)

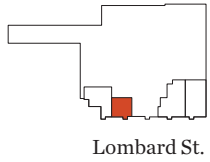

**2446 Lombard Street**  
(COMMERCIAL C)

**2444 Lombard Street**  
(COMMERCIAL D)

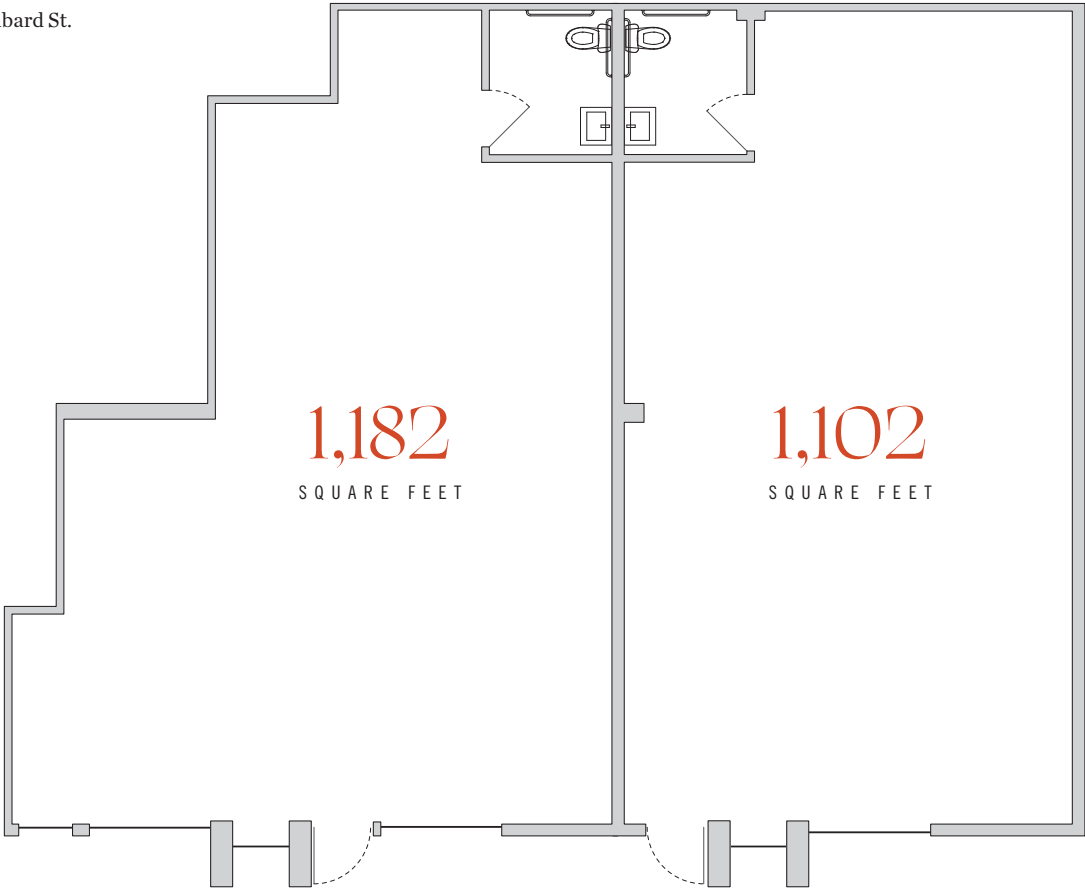
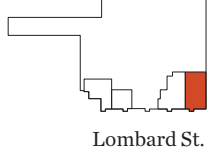



# Location

This collection of ground-level retail units is connected to the vibrant, new residential community at Maison au Pont and is nestled perfectly into San Francisco's highly sought-after Marina District, a high-end shopping and dining destination popular for trendy boutiques, an eclectic mix of restaurants and a hip, bustling nightlife.

# Maison au Pont

2448 Lombard St.  
San Francisco, Ca 94123

Louis Cornejo  
Louis@UrbanGroupSF.com  
415 786 3662

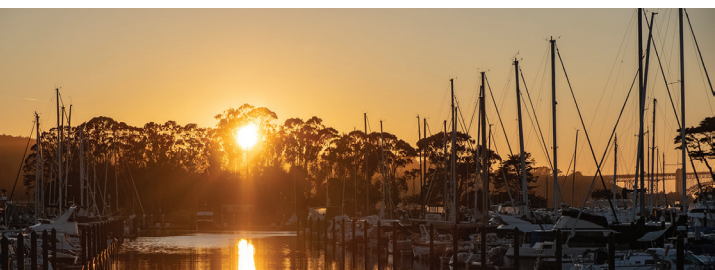

**JS SULLIVAN**  
SALES | MARKETING

 **URBANGROUP**  
REAL ESTATE

The information contained herein has been secured from sources we believe to be reliable but have not verified the information and we make no representations or warranties, expressed or implied, as to the accuracy of this information. References to square footage, zoning, or use are approximate. All renderings, floor plans and handouts are artists' conceptions and are not intended to be an actual depiction of the building. Floor Plans are not to scale and drawn to varying scales to maximize visibility when printed. The floor plans, elevations, renderings, features, finishes and specifications are subject to change at any time and should not be relied on as representations, express or implied. The materials should not be relied upon in deciding to obtain the property. The information contained herein is not a substitute for thorough due diligence investigation. Tenant must verify the information at its own expense and bears all the risk for any inaccuracies.

CA DRE #01885834 & CA DRE #01518102

