



SUBLEASE
THROUGH JANUARY 2027

1000
HARVESTER
ROAD
WEST CHICAGO, ILLINOIS

**67,339 SF
AVAILABLE**

 **CONTACT US:**

DANIEL WILKINS

Executive Managing Director
+1 312-470-2342
daniel.wilkins@cushwake.com

LOU HALL

Executive Managing Director
+1 312-470-2343
lou.hall@cushwake.com



PROPERTY HIGHLIGHTS



Total Building Size:	67,339 SF on 3.84 Acres
Clear Height:	22' Clear
Loading:	8 Interior Loading Docks with Levelers
Fire Suppression:	Fully Sprinklered
Electrical:	800 Amps, 277/480 Volts
Parking:	Ample
Column Spacing:	45' x 35' (Typical)
Lease Rate:	Subject to Offer

COMMENTS

- Recent renovations include new architectural metal panel façade, storefront and window system. New energy efficient LED warehouse, exterior lighting, Cambridge warehouse heating system. New parking lot, concrete stairs, sidewalk, and curbing. New oversized dock exterior doors. Recently installed professionally designed front landscaped areas.
- Available Immediately •
- Professionally Owned and Managed by MWI Property Group
- Sublease through January 2027

SITE PLAN

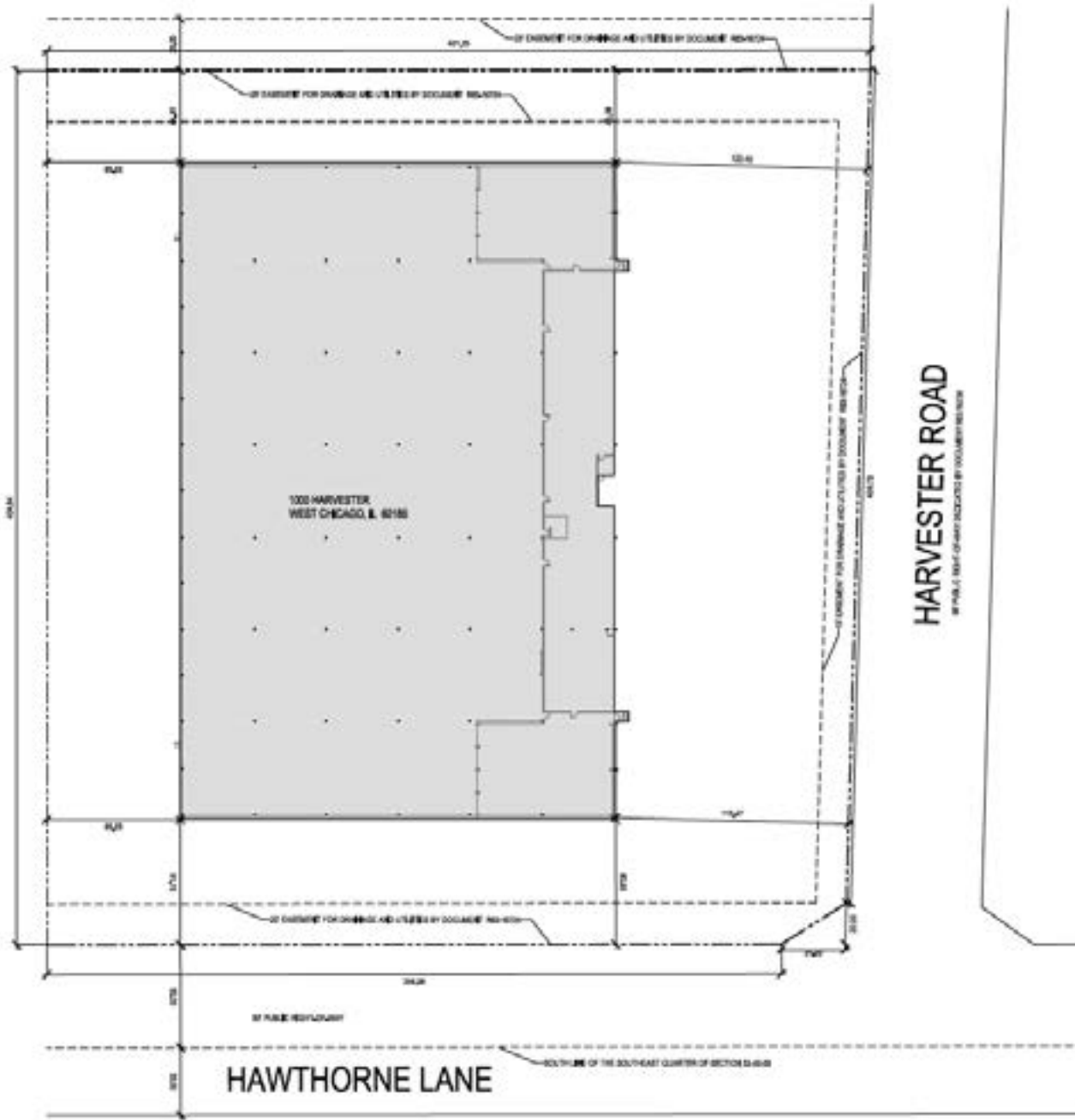

DANIEL WILKINS
Executive Managing Director
+1 312-470-2342
daniel.wilkins@cushwake.com

LOU HALL
Executive Managing Director
+1 312-470-2342
lou.hall@cushwake.com