

FOR LEASE

TURNKEY MEDICAL/DENTAL OFFICE BUILDING

The Offices on Dowdell

7630 Dowdell Rd - Building 4 | Spring, TX 77389



Building Features

- 3,096 Total Rentable Square Feet
- Landlord to fully build out a dental or medical office per the Tenant's requirements
- Turnkey Dental/Medical Building For Lease
- 3.4 / 1000 SF Parking Ratio
- 2 Access Points
- **Lease Rate: Contact Brokers**



Leasing Information:

Nathan Donahue

281.727.9464

Nathan.Donahue@transwestern.com

Claudia Fuentes

281.686.2697

Claudia.Fuentes@transwestern.com

 **TRANSWESTERN**

The information provided herein was obtained from sources believed reliable; however, Transwestern makes no guarantees, warranties or representations as to the completeness of accuracy thereof. The presentation of this property is submitted subject to errors, omissions, change of price or conditions, prior to sale or lease, or withdrawal without notice. Copyright © 2024 Transwestern.

Premier Location

Household

\$299k

Median Home Value

2006

Median Year Built

64K

Total Housing Units

Economics

36

Median Age

\$133k

Median Household Income

Employment

85%

Service Employment

14%

Blue Collar Employment

37,378

Total Employees

Population

183k

Total Current Population

193k

Projected Population in 2028

*Demographics is within 5 miles of the property

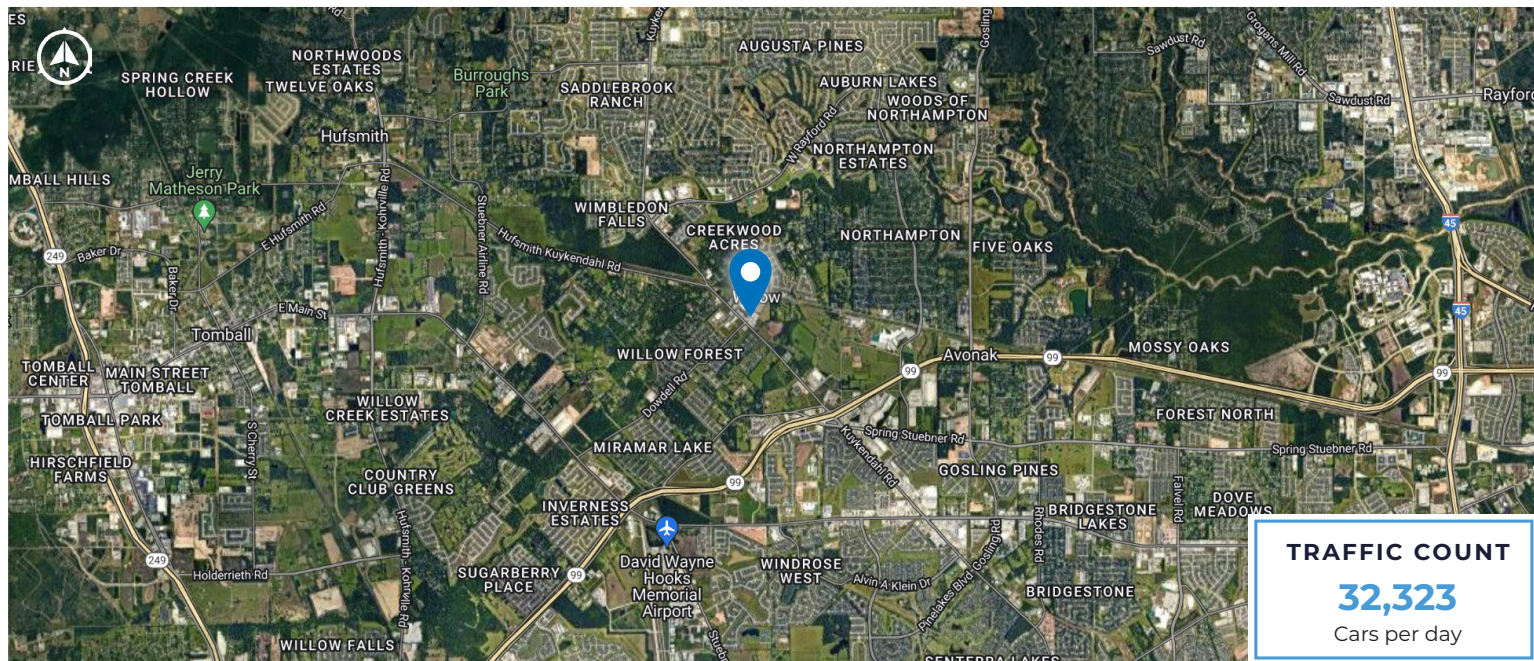

Leasing Information:

Nathan Donahue

281.727.9464

Nathan.Donahue@transwestern.com

Claudia Fuentes

281.686.2697

Claudia.Fuentes@transwestern.com



FOR LEASE TURNKEY MEDICAL/DENTAL OFFICE BUILDING

The Offices on Dowdell

7630 Dowdell Rd - Building 4 | Spring, TX 77389

Floor Plan - Building 4

3,096 SF

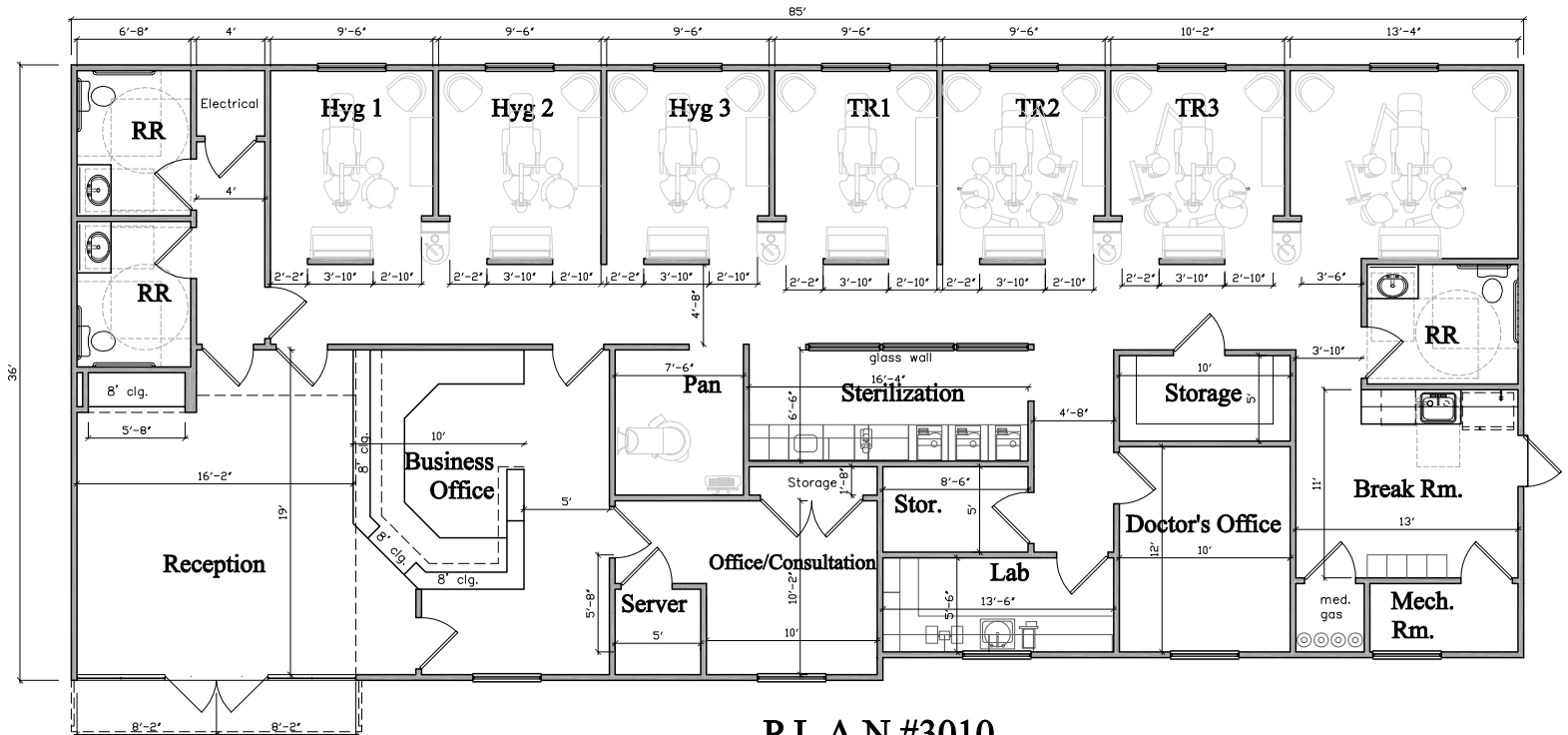

PLAN #3010
The Offices on Dowdell
Building 4

Leasing Information:

Nathan Donahue

281.727.9464

Nathan.Donahue@transwestern.com

Claudia Fuentes

281.686.2697

Claudia.Fuentes@transwestern.com

