

# AIRPORT BUSINESS CENTER

6135 NE 80th Avenue | Portland, OR 97218

## FOR LEASE



## OFFICE SPACE AVAILABLE FOR LEASE

### DETAILS – Call for pricing

Suite	Size	Notes
A2	± 1,541 SF	Available now
B3	± 2,000 SF	Available now
B9/10	± 3,105 SF	Available now
Combined B3/B9/B10	± 5,105 SF	Available now
C2	± 2,000 SF	Available now

## FEATURES

- On-site deli restaurant service
- Adjacent hotel service
- One mile from PDX
- Close highway access to I-205
- Minutes to Cascade Station
- Parking ratio: 4/1,000



05.06.2026

For more information or a property tour, please contact:

**TIM BUDELMAN**

503.225.8472

TimB@norris-stevens.com

# Norris & Stevens

INVESTMENT REAL ESTATE SERVICES



Information contained herein has been obtained from others and considered to be reliable; however, a prospective purchaser or lessee is expected to verify all information to his/her own satisfaction.

900 SW 5th Avenue • 17th Floor • Portland, OR 97204  
503.223.3171 • norris-stevens.com

# AIRPORT BUSINESS CENTER

6135 NE 80th Avenue | Portland, OR 97218

# FOR LEASE

## FLOOR PLANS

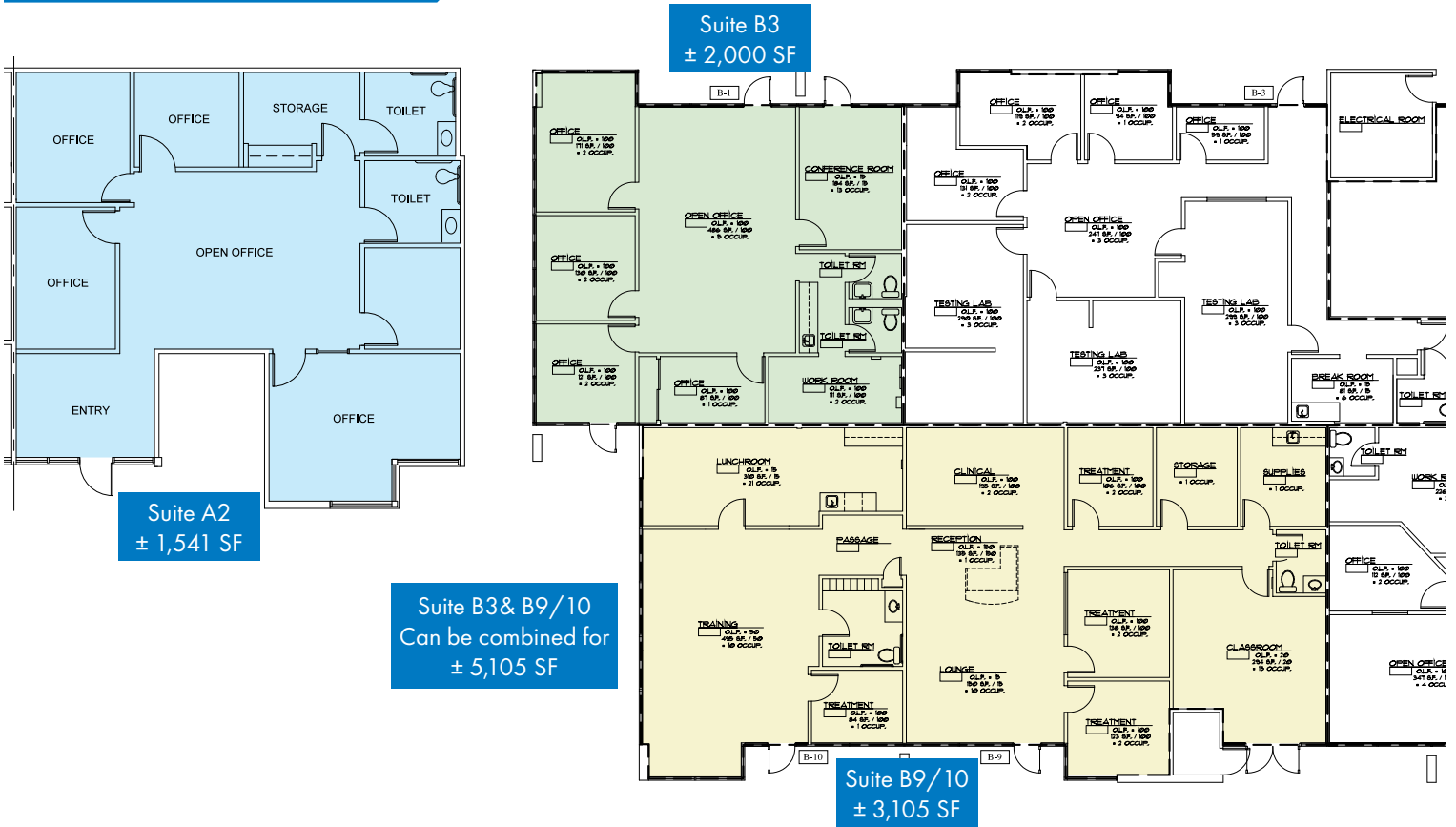

## CONCEPTUAL PLANS

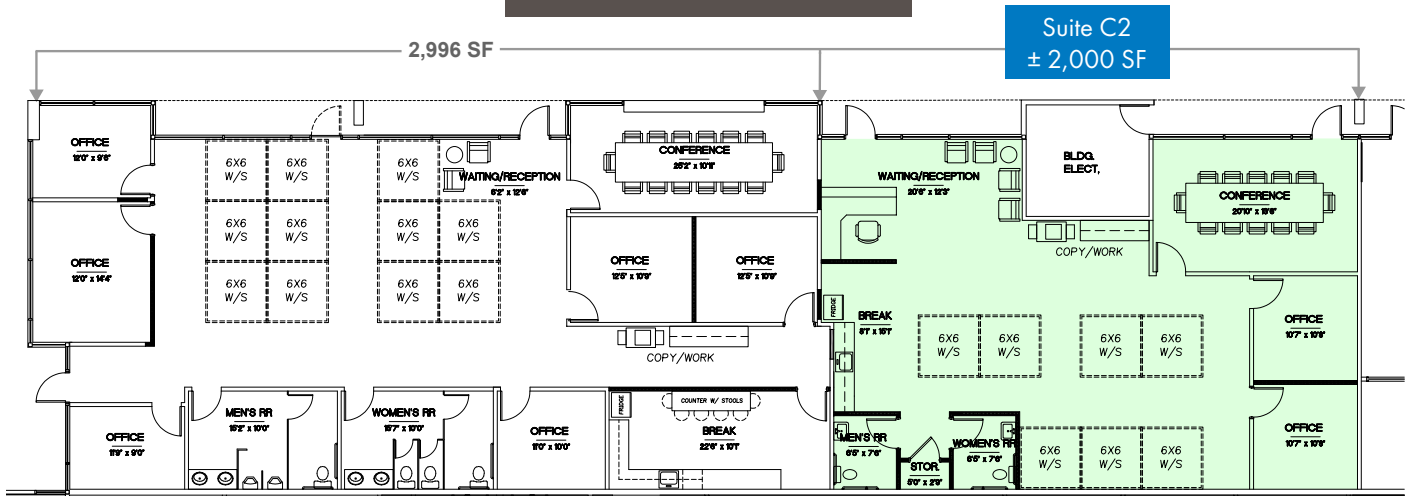

For more information or a property tour, please contact:

**TIM BUDELMAN**

503.225.8472

TimB@norris-stevens.com

# Norris & Stevens

INVESTMENT REAL ESTATE SERVICES



Information contained herein has been obtained from others and considered to be reliable; however, a prospective purchaser or lessee is expected to verify all information to his/her own satisfaction.

900 SW 5th Avenue • 17th Floor • Portland, OR 97204  
503.223.3171 • norris-stevens.com

# AIRPORT BUSINESS CENTER

6135 NE 80th Avenue | Portland, OR 97218

# FOR LEASE

## PHOTOS & SITE PLAN

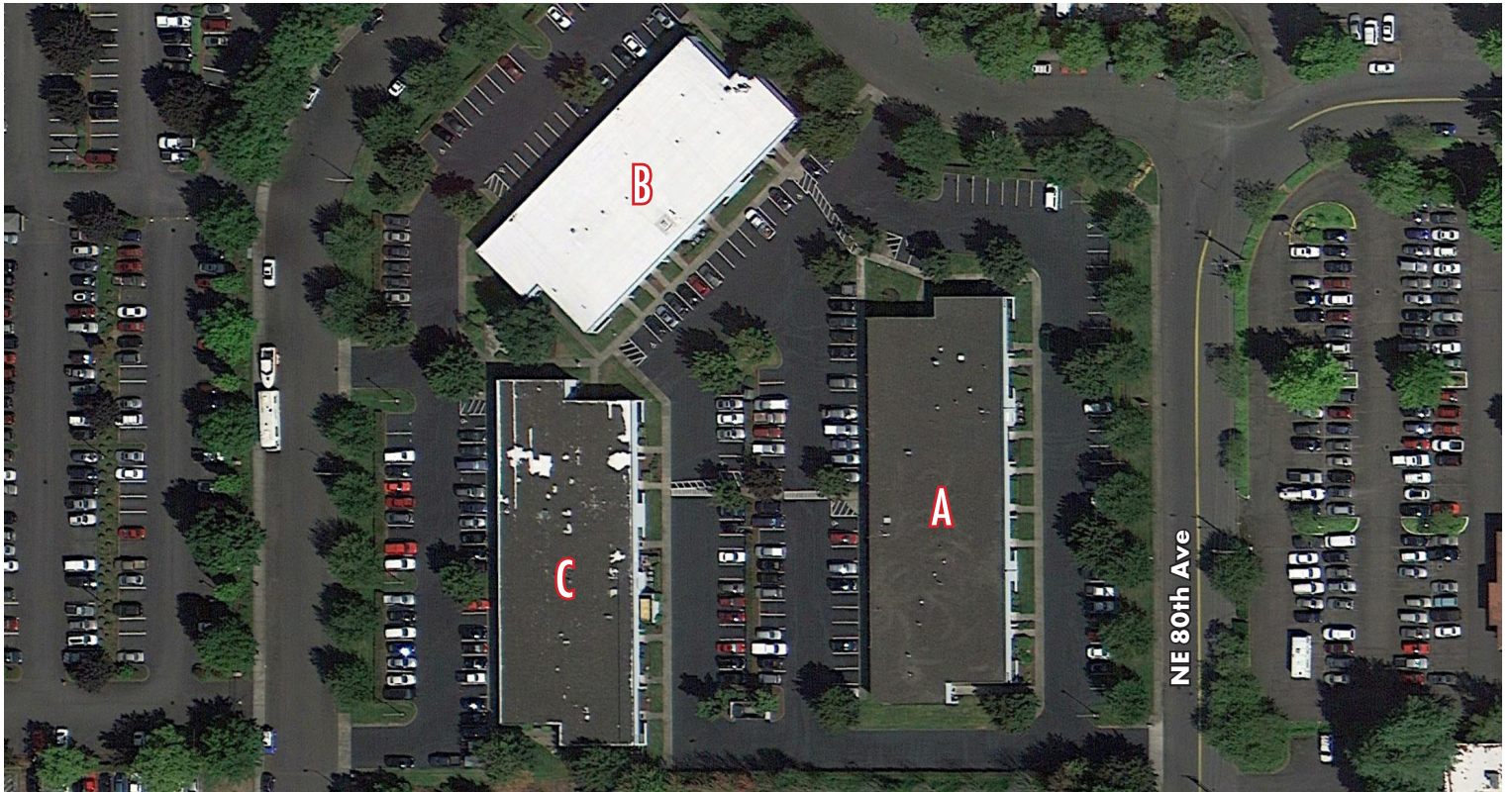

For more information or a property tour, please contact:

**TIM BUDELMAN**

503.225.8472

TimB@norris-stevens.com

# Norris & Stevens

INVESTMENT REAL ESTATE SERVICES



*Information contained herein has been obtained from others and considered to be reliable; however, a prospective purchaser or lessee is expected to verify all information to his/her own satisfaction.*

900 SW 5th Avenue • 17th Floor • Portland, OR 97204  
503.223.3171 • norris-stevens.com