

MARKLAND PLAZA - SUBLEASE

1419 South Reed Road Kokomo, IN 46902



MIDLAND ATLANTIC
PROPERTIES



PROPERTY OVERVIEW

Former 2,000 square foot medical/retail space available for sublease at Markland Plaza; anchored by Best Buy, Bed Bath & Beyond, Five Below, Noble Romans, Starbucks and Panda Express.

PROPERTY HIGHLIGHTS

- Located in the Heart of Kokomo's Retail Trade Area at Markland Plaza
- Target / Aldi Shadow Anchored
- Sublease Opportunity – Expires 9/30/2026
- Excellent Condition – Build Out Completed in Late 2016
- Prime Location Along Reed Road (US HWY 931)
- Over 32,000 Employees in 3 Mile Radius
- \$57,206 AHHI in 3 Miles
- Trade Area Expands over 10 Miles

DEMOGRAPHICS

	3 MILES	5 MILES
Total Population	44,330	66,158
Average HH Income	\$58,596	\$66,224
Businesses	1,948	2,375
Employees	27,313	32,121

TRAFFIC COUNTS

South Reed Road	25,098
-----------------	--------



MIDLAND ATLANTIC PROPERTIES

Indianapolis Office
3801 East 82nd Street, Suite B
Indianapolis, IN 46240

MIDLANDATLANTIC.COM

SHAWN HEFFERN

Direct: 317.597.1715
Cell: 317.695.8938
sheffern@midlandatlantic.us

DEVELOPMENT • BROKERAGE • ACQUISITIONS • MANAGEMENT

Information contained herein has been obtained from sources deemed reliable but is not guaranteed and is subject to change without notice.

MARKLAND PLAZA – SUBLEASE

1419 South Reed Road Kokomo, IN 46902



MIDLAND ATLANTIC
PROPERTIES

LAYOUT

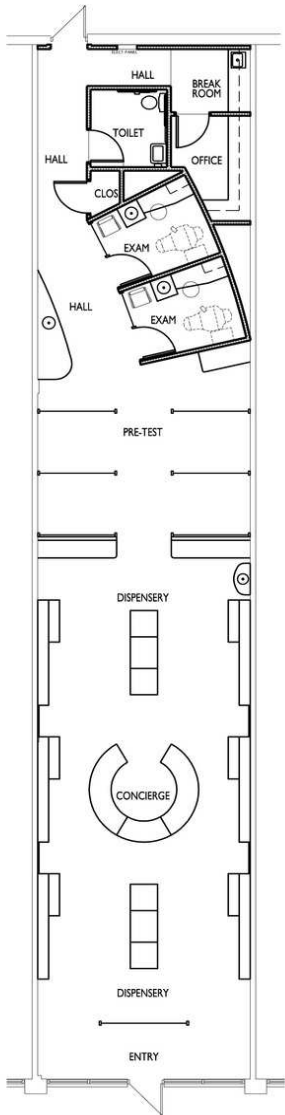

SITE

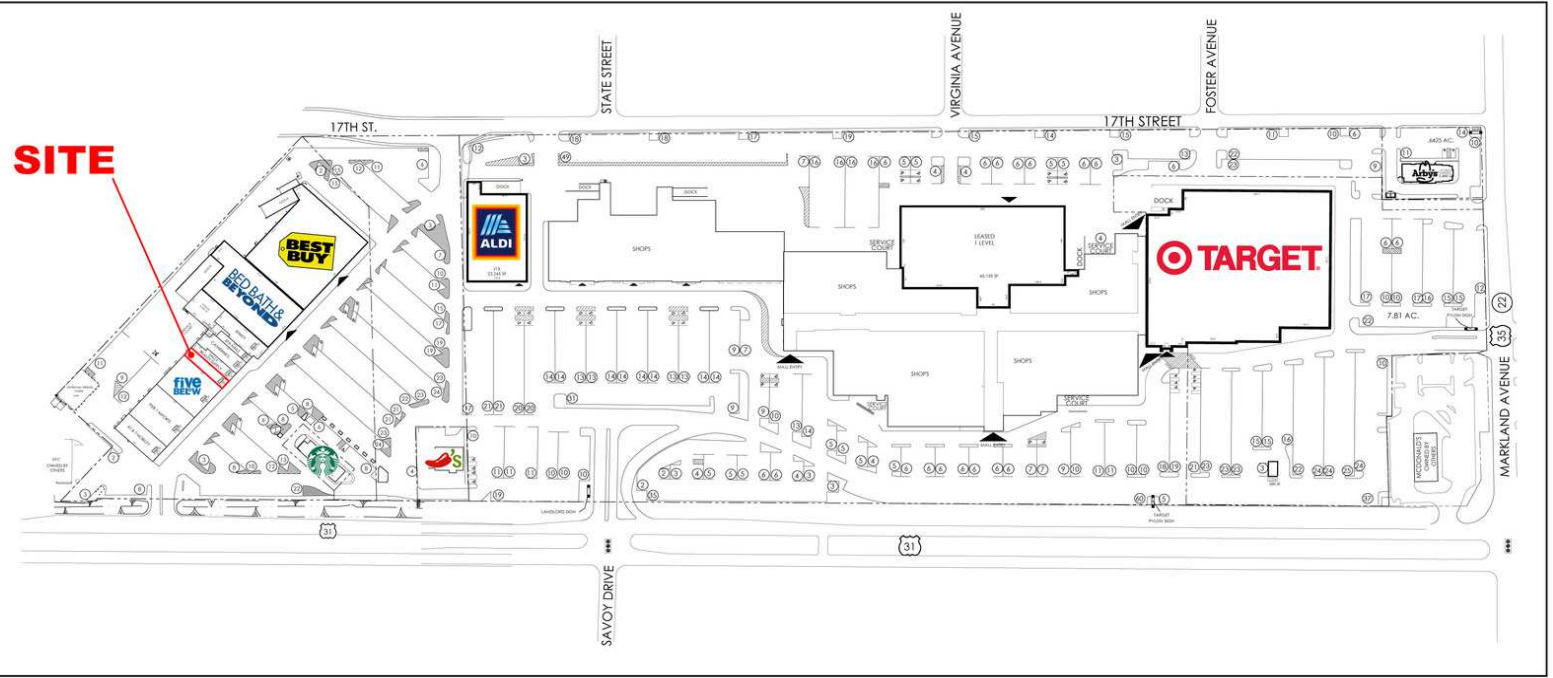

MARKLAND PLAZA - SUBLEASE

1419 South Reed Road Kokomo, IN 46902



MIDLAND ATLANTIC
PROPERTIES

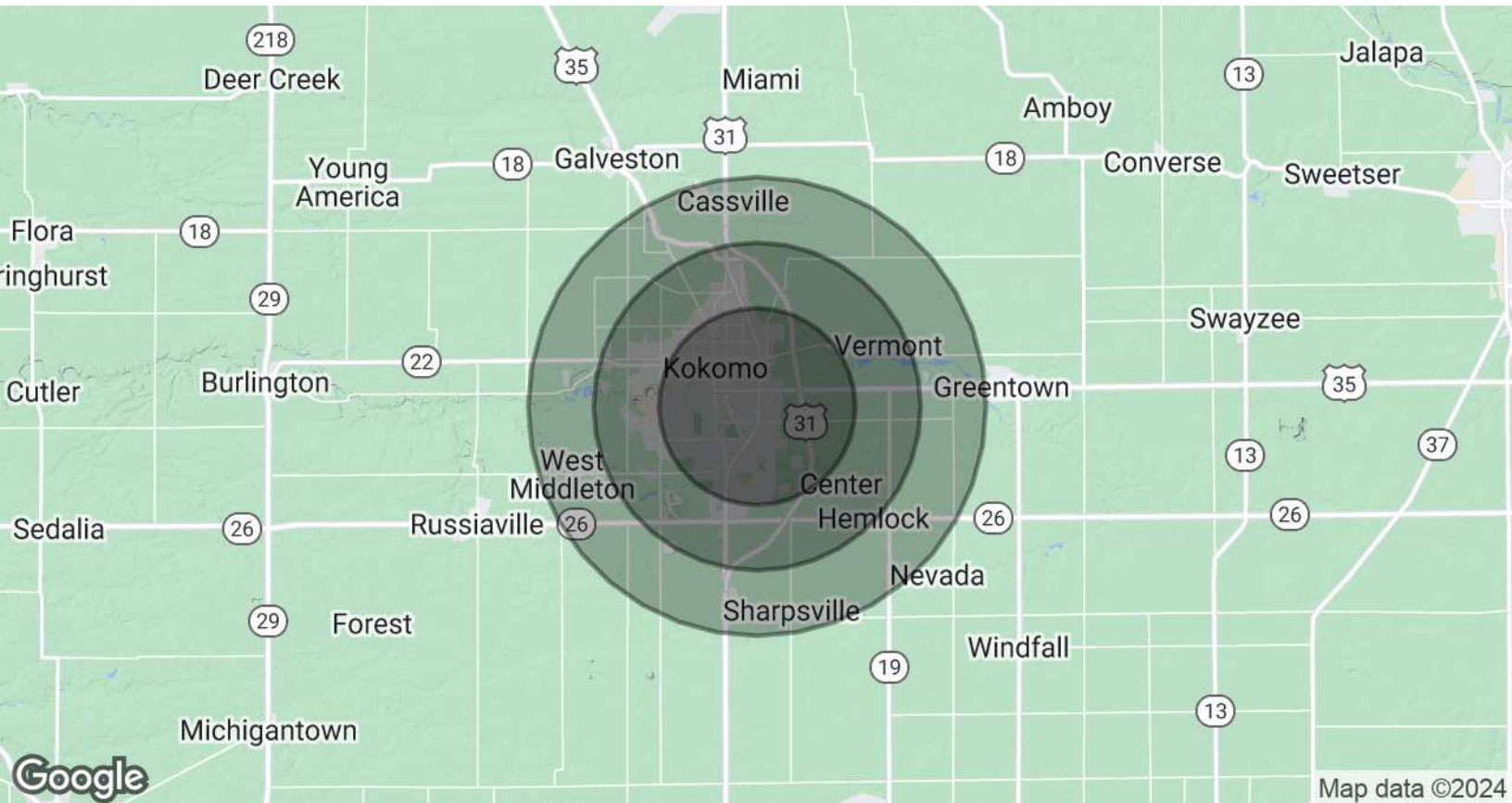

POPULATION & HOUSING

	3 MILES	5 MILES	7 MILES
Total Population	44,330	66,158	73,768
Projected Population (2026)	45,482	67,729	75,327
Total Households	19,562	28,838	33,289
Median Home Value	\$93,572	\$110,202	\$115,462

INCOME & BUSINESS

	3 MILES	5 MILES	7 MILES
Average HH income	\$58,596	\$66,224	\$69,567
Daytime Population (16+ years)	43,951	57,424	60,683
Total Businesses	1,948	2,375	2,488
Total Employees	27,313	32,121	32,839

MIDLAND ATLANTIC PROPERTIES

Indianapolis Office
3801 East 82nd Street, Suite B
Indianapolis, IN 46240

MIDLANDATLANTIC.COM

SHAWN HEFFERN

Direct: 317.597.1715
Cell: 317.695.8938
sheffern@midlandatlantic.us

DEVELOPMENT • BROKERAGE • ACQUISITIONS • MANAGEMENT

Information contained herein has been obtained from sources deemed reliable but is not guaranteed and is subject to change without notice.