

CLASS A OFFICE BUILDINGS FOR SALE



SALE PRICE: \$4,106,982 (\$289.00 PSF)

INVESTMENT OPPORTUNITY

291 & 299 Bradley Boulevard – Richland, WA 99352

LANCE BACON, MANAGING BROKER |

509.396.0509

lance.bacon@kiemlehagood.com

KIEMLEHAGOOD

OFFERING SUMMARY

FOR SALE

291 & 299 Bradley Boulevard – Richland, WA

Two Class A Office Buildings located on Columbia Point in Richland, WA.

BUILDING 1

Address: 291 Bradley Boulevard
City, State, Zip: Richland, WA 99352
Parcel Number: 114981012813003
Building Size: ±6,152 SF
Lot Size: ±31,860 SF
Zoning: C-LB
Property Type: Office
Year Built: 2018

BUILDING 2

Address: 299 Bradley Boulevard
City, State, Zip: Richland, WA 99352
Parcel Number: 114981012813002
Building Size: ±8,056 SF
Lot Size: ±33,106 SF
Zoning: C-LB
Property Type: Office
Year Built: 2019



BUILDING 1 - FLOOR PLAN & PHOTOS

291 Bradley Boulevard - Richland, WA

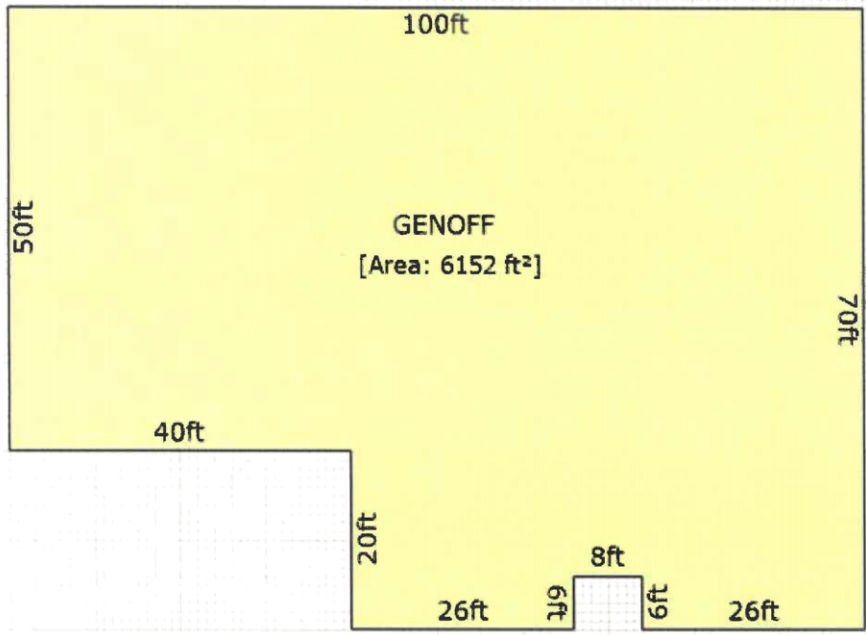

BUILDING 2 – FLOOR PLAN & PHOTOS

299 Bradley Boulevard – Richland, WA

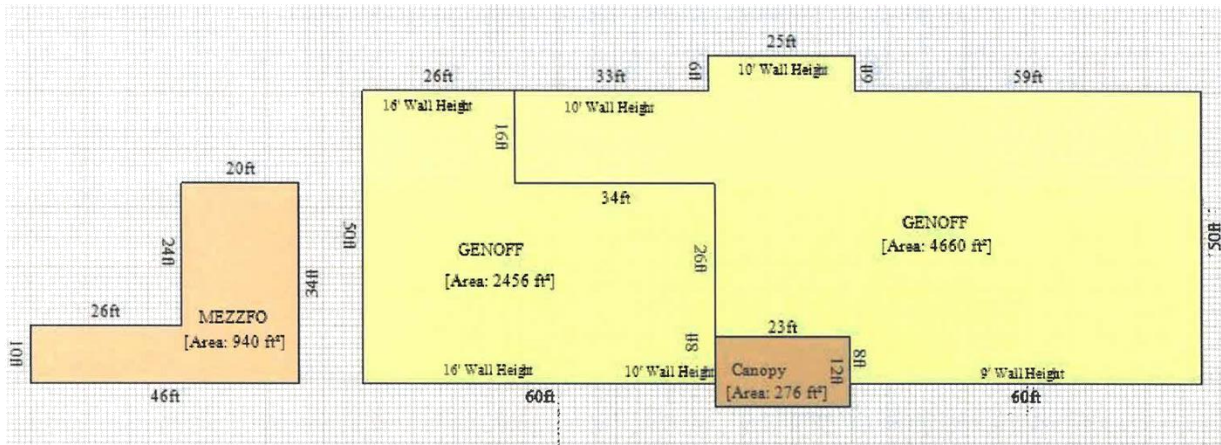

TENANT & LEASE INFORMATION

FOR SALE
291 & 299 Bradley Boulevard – Richland, WA

CURRENT LEASES

TENANT	BLDG	TERM	SQUARE FOOTAGE	BASE RENT
VACANT SUITE	BLDG 291	On Market at \$24.00 PSF	±4,152 SF	\$8,304.00
Jeff Seitz dba Integrity Financial Services	BLDG 291	8.31.2023 - 7.31.2028	±2,000 SF	\$4,286.67
Superior Health Care, LLC	BLDG 299	6.1.2024 – 5.31.2027	±3,856 SF	\$7,259.10
Washington Real Estate	BLDG 299	12.1.2023 - 11.30.2028	±4,200 SF	\$8,445.50
TOTAL=			±14,208 SF	\$28,295.27

PRO FORMA

Annual Gross Rents:	\$339,543.24
5% Vacancy Rate	(\$16,682.40)
Operating Expenses	(\$51,736)
Net Operating Income	\$271,124.86
Cap Rate	6.6%

DEMOGRAPHICS & TRAFFIC COUNTS

FOR SALE

291 & 299 Bradley Boulevard – Richland, WA



	1MILE	2MILES	3MILES	5MILES
POPULATION 2023	12,106	30,412	53,330	109,723
PROJ POPULATION 2028	11,831	30,625	53,918	112,757
AVERAGE HHI	\$123,330	\$142,045	\$146,045	\$121,806
MEDIAN HHI	\$92,575	\$102,135	\$104,648	\$88,394
MEDIAN AGE	41.7	42.8	42.7	40.6
DAYTIME DEMOS	5,848	15,150	24,833	104,698



GEORGE WASHINGTON WAY
±35,697 ADT



NEARBY BUSINESSES

- Apple Bee's
- AT&T
- Bento Teriyaki
- Big 5 Sporting Goods
- Jack in the Box
- Navigate Wireless
- Perfect Look Salon
- Starbucks
- Valvoline
- WinCo Foods

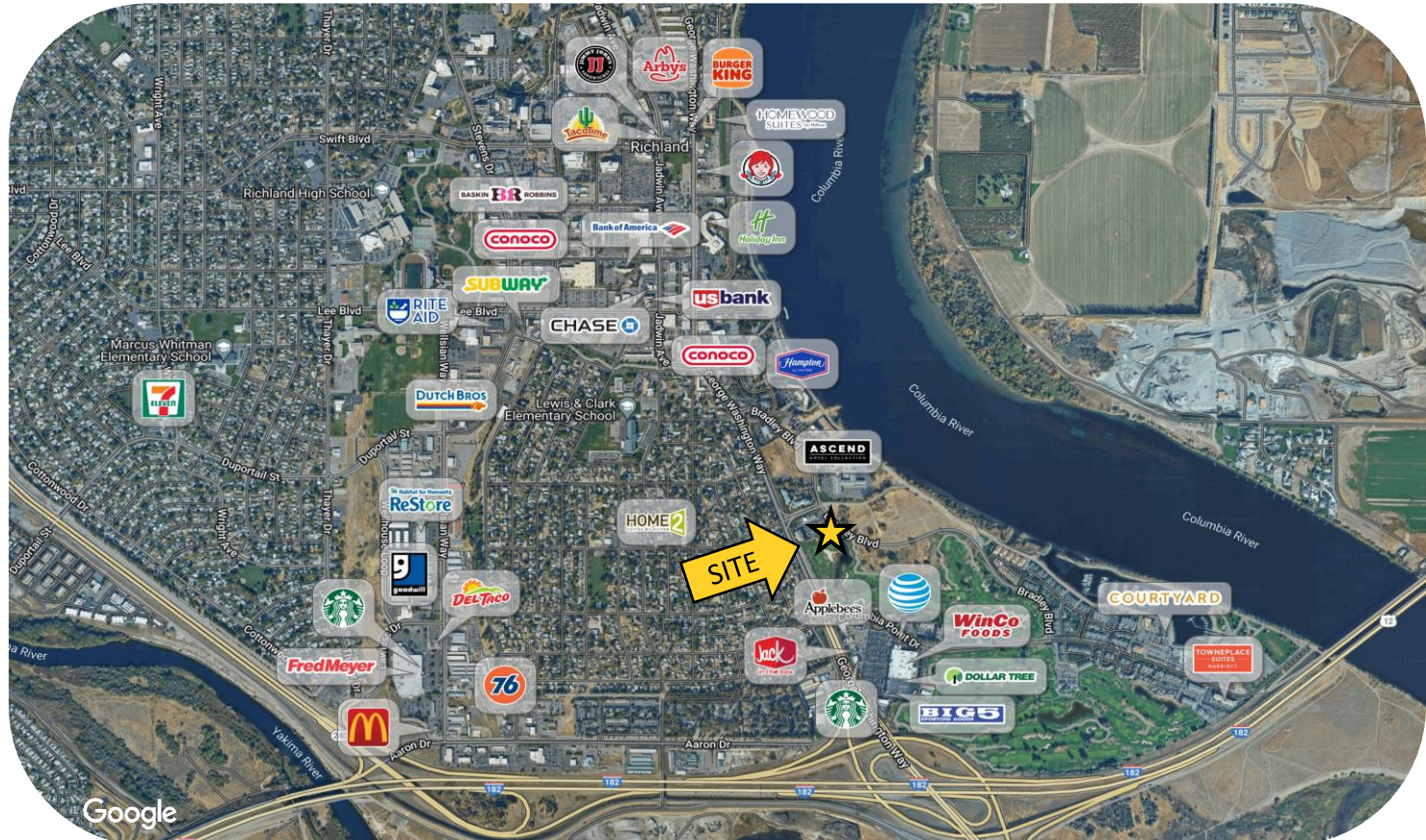

FOR SALE

291 & 299 Bradley Boulevard – Richland, WA



No warranty or representation, expressed or implied, is made by Kiemle Hagood, its agents or its employees as to the accuracy of the information contained herein. All information furnished is from sources deemed reliable and submitted subject to errors, omissions, change of terms and conditions, prior sale, lease or financing, or withdrawal without notice. No one should rely solely on the above information, but instead should conduct their own investigation to independently satisfy themselves.

Kiemle Hagood respects the intellectual property of others:

If you believe the copyright in your work has been violated through this Website, please contact our office for notice of claims of copyright infringement. For your complaint to be valid under the Digital Millennium Copyright Act of 1998 (DMCA), you must provide the following information when providing notice of the claimed copyright infringement: Identify the material on the Website that you believe infringes your work, with enough detail so that we may locate it on the Website; provide your address, telephone number and email address; provide a statement that you have a good faith belief that the disputed use is not authorized by the copyright owner, its agent, or the law; provide a statement that the information in the notification is accurate, and under penalty of perjury, that the complaining party is authorized to act on behalf of owner of an exclusive right that is allegedly infringed; provide your physical or electronic signature. Upon receiving your complaint, Kiemle Hagood will, upon review, remove content that you believe infringes your copyright if the complaint is found valid.

LANCE BACON, MANAGING BROKER

509.396.0509

lance.bacon@kiemlehagood.com

KIEMLEHAGOOD
CREATING REAL ESTATE SOLUTIONS 