

PLANET FITNESS PLAZA

**Churchland Boulevard/Tyre Neck Rd/West Norfolk Rd
Portsmouth, VA
FLEX SPACE AVAILABLE**



- Approx. 4,931 SF flex space available with two grade level overhead doors
- Ideal for contractor's office or other similar use
- Mezzanine available
- Other tenants include Planet Fitness Plaza and Fresenius Kidney Care
- Convenient to Western Freeway (Rte. 164) and I-664



Demographics (2024)

	1 Mile	3 Miles	5 Miles
Population	11,730	64,431	138,771
Households	4,958	25,256	54,087
Ave. HH Inc.	\$83,301	\$103,817	\$102,144

CONTACT:

LARRY HECHT
Senior Vice President
Phone: (757) 640-8230
larryhecht@harveylindsay.com

HARVEY LINDSAY
COMMERCIAL REAL ESTATE

A Tradition of Forward Thinking

PLANET FITNESS PLAZA

Churchland Boulevard/Tyre Neck Rd/West Norfolk Rd
Portsmouth, VA

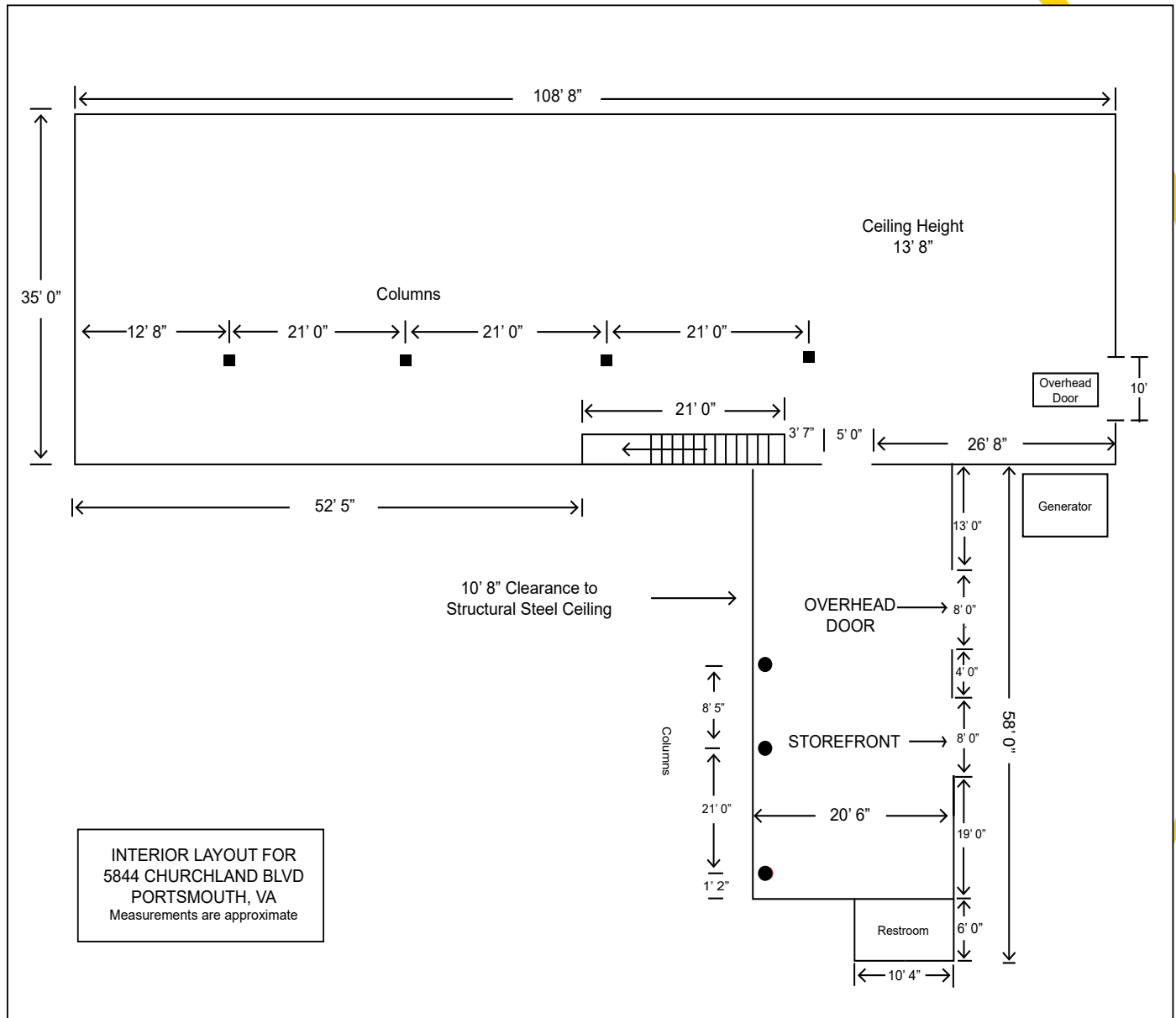

CONTACT:

LARRY HECHT

(757) 640-8230

larryhecht@harveylindsay.com

HARVEY LINDSAY

COMMERCIAL REAL ESTATE

A Tradition of Forward Thinking

The information contained herein has been obtained from sources believed to be reliable but is not warranted.
We cannot be responsible for errors, omissions, withdrawal, or prior lease. Broker has ownership interest in this property.

PLANET FITNESS PLAZA

Churchland Boulevard/Tyre Neck Rd/West Norfolk Rd
Portsmouth, VA

3 Pylon Signs



CONTACT:

LARRY HECHT
(757) 640-8230

larryhecht@harveylindsay.com

HARVEY LINDSAY

COMMERCIAL REAL ESTATE

A Tradition of Forward Thinking

The information contained herein has been obtained from sources believed to be reliable but is not warranted.
We cannot be responsible for errors, omissions, withdrawal, or prior lease. Broker has ownership interest in this property.