

# FOR LEASE

1615 MCGARRY ST  
LOS ANGELES, CA 90021



For more information, please contact:

**Daniel Park**

(213) 446-0396

[Danielpark777@hotmail.com](mailto:Danielpark777@hotmail.com)

DRE# 01227056



Park Industrial Realty  
800 McGarry St, 5<sup>th</sup> Floor  
Los Angeles, CA 90021  
Corporation DRE# 01983713

Available SF:	33,607 SF - 40,107 SF	• Excellent manufacturing/warehouse space located close to Downtown LA
Land SF:	47,112 SF	• Dock high loading & ground level loading
Office SF:	1,275 SF	• Secure fenced & gated parking
Year Built:	1923	• Clean & well maintained office area
Clear Height:	12' – 18'	• Heavy electrical power – 600 amps
Power:	600a, 240v, 3p, 4w	• Wood bow truss ceiling
Loading:	2 GL, 4 DH	• Immediate freeway access
# Parking:	17	• Potential uses are manufacturing, warehousing, creative or production studio, e-commerce, printing, embroidery, import/export & wholesale.
Sprinklered:	Yes	
Zoning:	MR2	
Lease Rate/Mo:	\$0.85/SF Gross	

All information has been furnished from sources which we deem reliable, but for which we assume no liability. All measurements are approximate. Broker/Owner do not warrant its accuracy. Buyer/Lessee must verify all information.



5167 | 3  
SCALE 1" = 80'

1996

8810180200100  
31101710005001-2  
960223

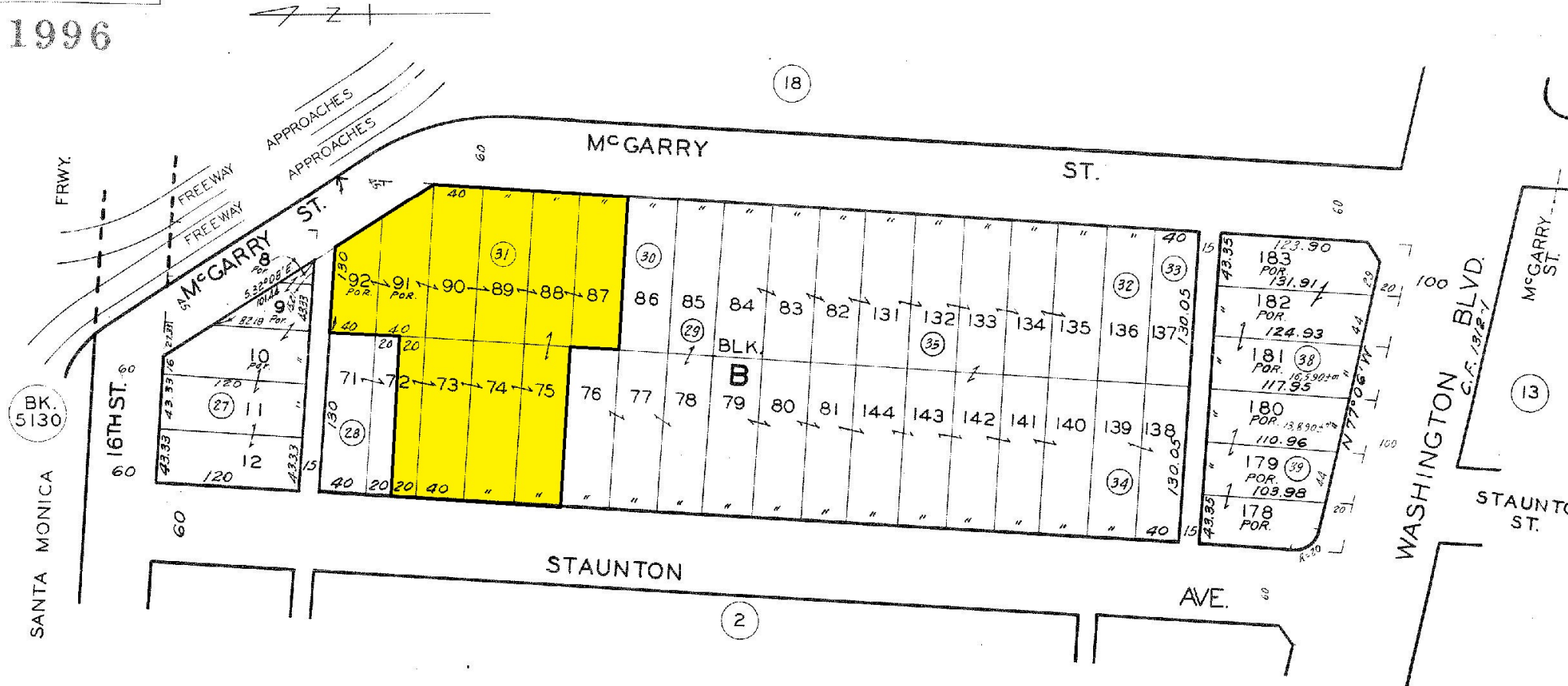

**MEADE AND DALTON TRACT**

M. R. 37 - 50

CODE  
6658

FOR PREV. ASSMT SEE:  
5167 - 49

ASSESSOR'S MAP  
COUNTY OF LOS ANGELES, CALIF.



