



W15TH ST

STILLWELL AVE

KSR EXCLUSIVE OPPORTUNITY

**INDUSTRIAL COLD WAREHOUSE
A TOTAL OF 28,000 SF FOR SALE**

2715 W 15th Street | 2709 W 15th Street | 2688 Stillwell Avenue Brooklyn NY



2715 W15th Street | 2709 W 15th Street
2688 Stillwell Avenue | Coney Island
Brooklyn NY 11224

INVESTORS SUMMARY

Kassin Sabbagh Realty (KSR) is handling the exclusive sale of three prime properties in the Coney Island section of Brooklyn: 2715 W 15th Street, 2709 W 15th Street, and 2688 Stillwell Avenue, but being sold as a one package deal. This exceptional real estate opportunity consists of industrial food processing cold storage warehouses, offering a total of 28,000 square feet of space situated on a 32,000+ square foot lot.

The properties are conveniently located near the Belt Parkway, providing easy access to major transportation routes. Coney Island, known for its rich history, is located in the southernmost part of Brooklyn, bordered by the Atlantic Ocean and Lower New York Bay.

This vibrant neighborhood attracts both locals and tourists with its unique blend of traditional amusement, beach relaxation, and modern entertainment. Accessible by subway and ferry, Coney Island continues to captivate visitors while reflecting Brooklyn's cultural heritage.

**ASKING PRICE:
UPON REQUEST**



PROPERTY OVERVIEW

Property Type	Food processing cold warehouse
Buildings	1
Lot Size	32,000+ SF
Total Building SF	28,000 SF
Zoning	M1-2 Industrial
Taxes	\$149,000

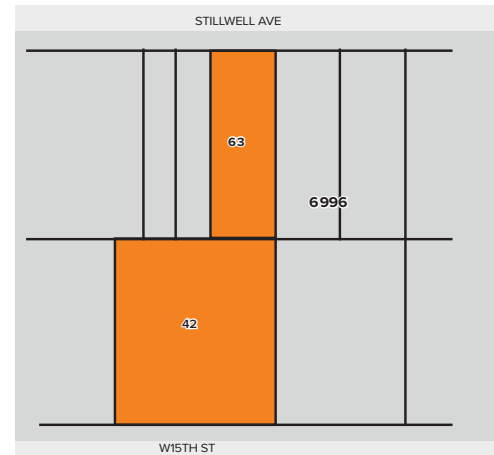

SITE PLAN

W15TH ST

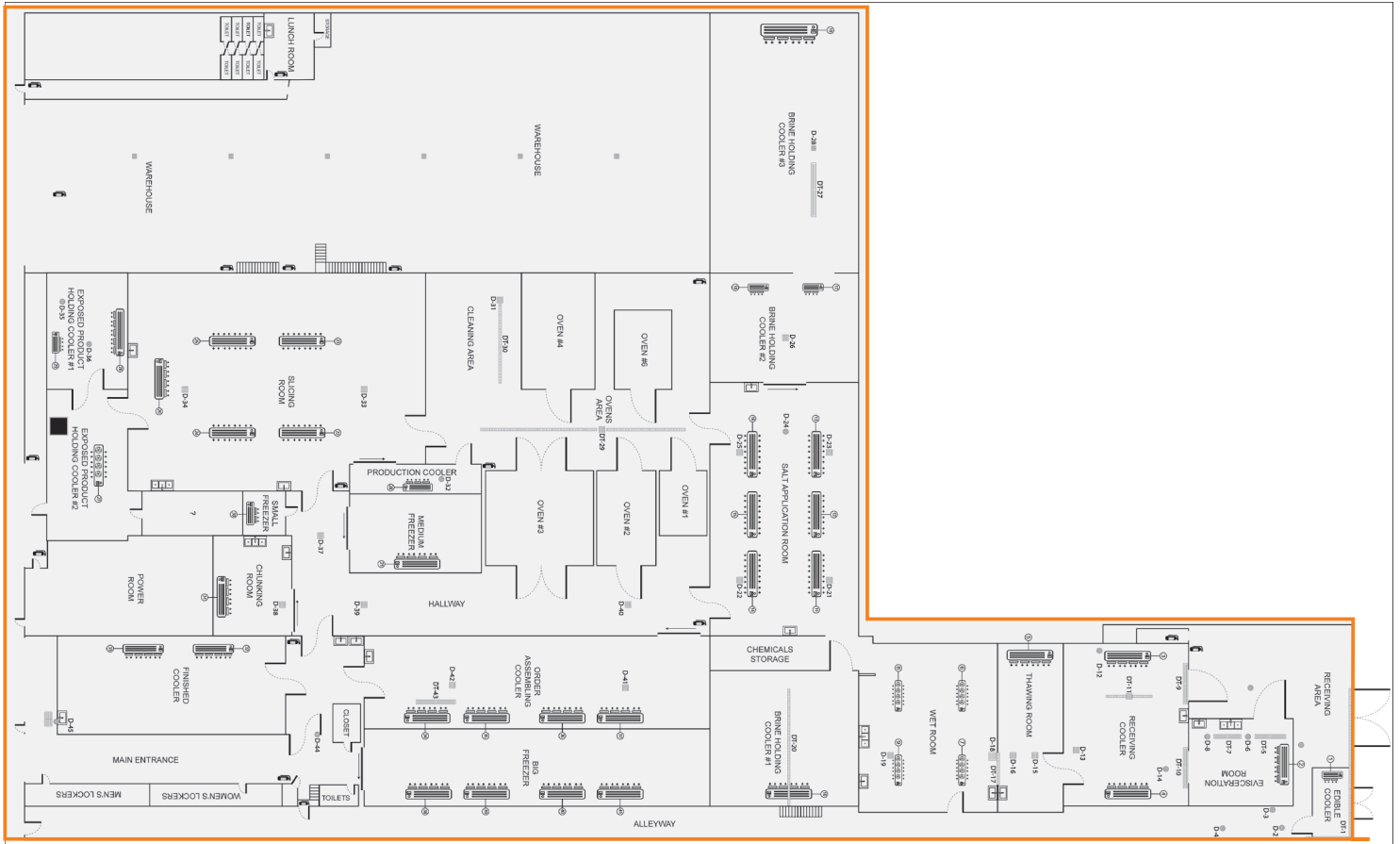

STILLWELL AVE

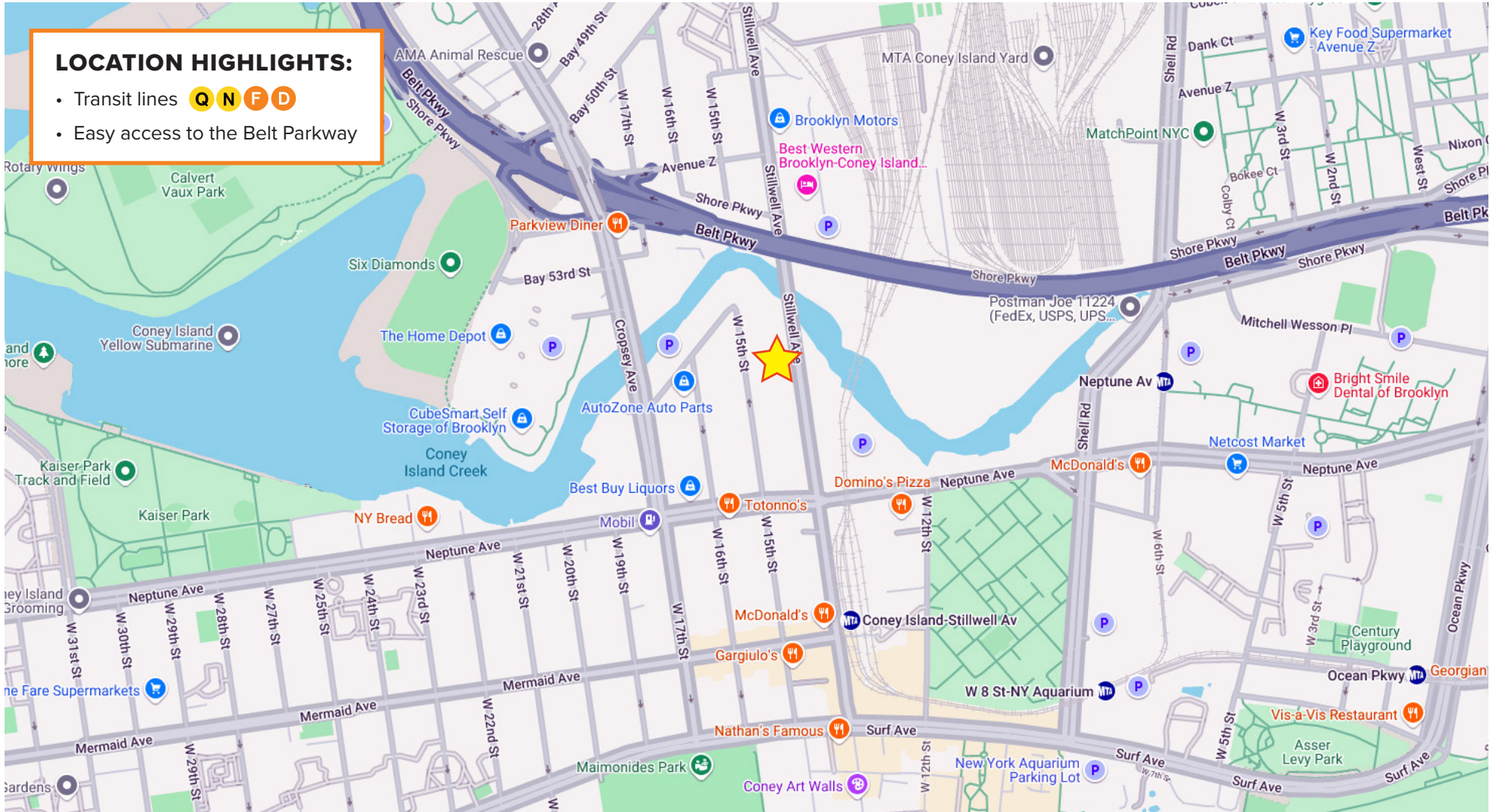

FOR MORE INFORMATION, PLEASE CONTACT:

BRYNA FLAUM

M: 516.322.4831 | E: BFlaum@ksrny.com

ksr 1385 Broadway, 22nd Floor | New York 10018 | 212.417.9217 | ksrny.com