

# 10463

PARK MEADOWS DR.  
LONE TREE, CO 80124

SUITE 111/113

**3,683 RSF**



## Medical/Office Condo Opportunity!

NEW PRICING - **\$995,000**

### Building Description

- Available Space:** Suite 111/113 - 3,683 RSF
- Listing Price:** \$995,000
- Signage:** Building & suite-entry signage
- Parking:** Ample free surface parking



[\*\*View the  
Virtual Tour\*\*](#)



Numerous retail amenities nearby including Park Meadows Mall



4.68:1,000 SF parking ratio



Within walking distance to Lincoln Light Rail Station



Professionally managed condo association

SUITE 111/113  
**3,683 RSF**

- Building signage available
- Two (2) private exterior entrances
- Windowed reception with enclosed foyer
- Large procedure room/lab
- 2 exam rooms
- 2 offices
- Kitchen/Breakroom
- Storage room
- Heavy power

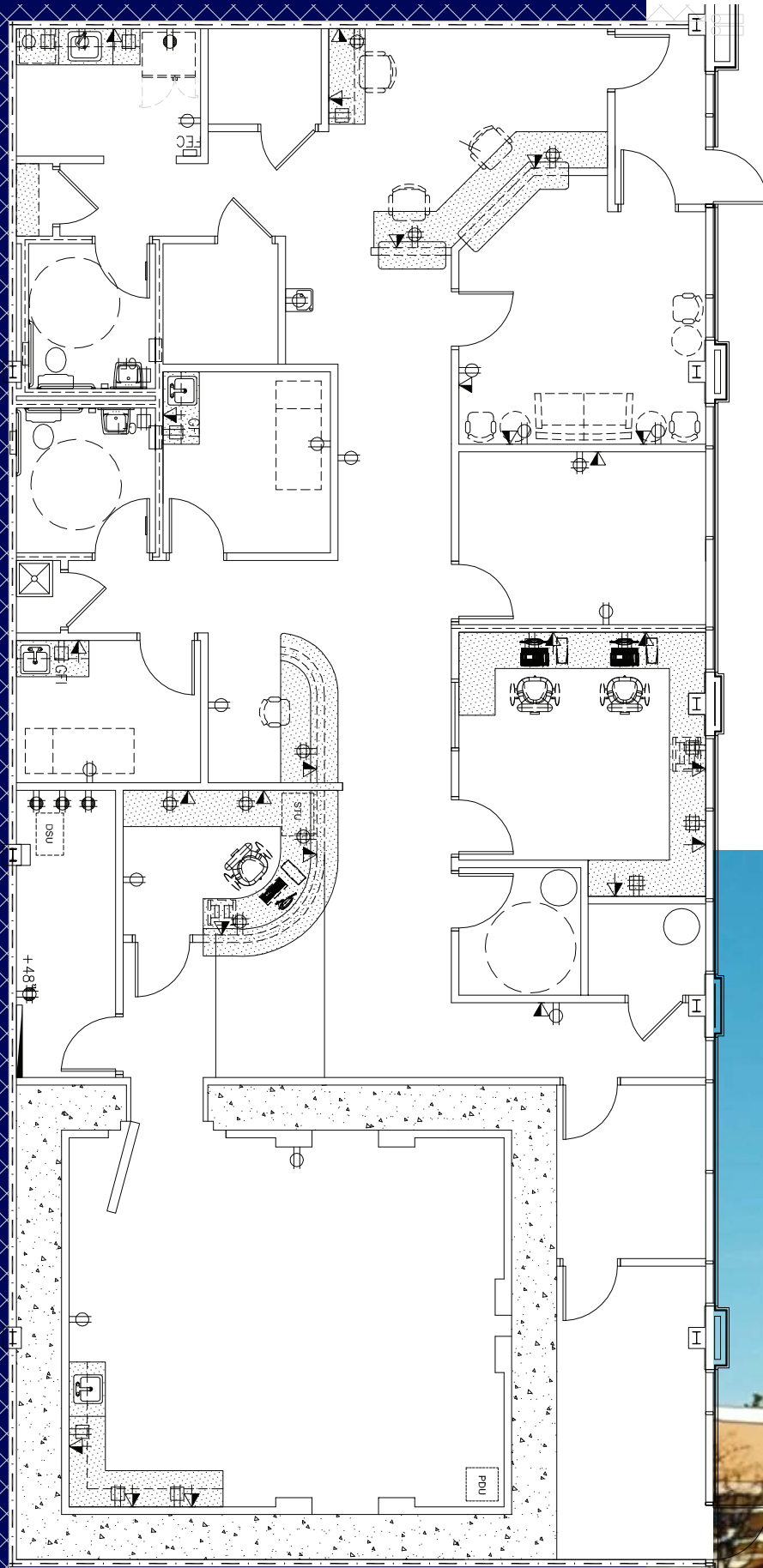

# PARK MEADOWS



S. YOSEMITE ST.



LINCOLN AVE.



**CODY SHEESLEY**

303 309 3520

cody.sheesley@colliers.com

**ABBY PATTILLO**

303 283 4579

abby.pattillo@colliers.com

**DANIEL KRULIG**

303 283 4570

daniel.krulig@colliers.com

4643 S. Ulster St. Suite 1000

Denver, CO 80237

303 745 5800

colliers.com/denver

This communication has been prepared by Colliers Denver for advertising and/or general information only. Colliers Denver makes no guarantees, representations or warranties of any kind, expressed or implied, regarding the information including, but not limited to, warranties of content, accuracy and reliability. Any interested party should undertake their own inquiries as to the accuracy of the information. Colliers Denver excludes unequivocally all inferred or implied terms, conditions and warranties arising out of this document and excludes all liability for loss and damages arising there from. This publication is the copyrighted property of Colliers Denver and/or its licensor(s). © 2023. All rights reserved. This communication is not intended to cause or induce breach of an existing listing agreement.