



We're helping to make
**Berks County one of the safest
counties in the United States.**

Spartan Properties, LLC, a real estate property investment and management company specializing in developing, acquiring, and managing the highest quality corporate, professional, and medical complexes throughout Berks and its surrounding counties supports HeartSAFE Berks County.

That's why we've purchased Automatic External Defibrillators (AEDs*) for three of the properties we manage. Since the inception of the HeartSAFE Berks County initiative in 2010, the survivability of sudden cardiac arrest victims living and working in Berks County has dramatically improved.

The Marlin Miller, Jr., Regional Heart Center – in partnership with The Friends of The Reading Hospital – encourage citizens to get involved and know the Chain of Survival for a victim of sudden cardiac arrest.

- Call 9-1-1
- Start CPR immediately
- Use an AED – even before help arrives
- Access advanced emergency medical care



*An Automatic External Defibrillator, or AED, is a portable lifesaving device that delivers an electric shock to restore normal heart rhythm in a person who has suffered sudden cardiac arrest.



**PRIME OFFICE
SPACE
AVAILABLE**

610-478-1884
mail@spartanproperties.com

Leasing Contact:

Ico Koullias

Cell: 610 334-0891

E-mail: icok@aol.com

1100 Berkshire Blvd, Wyomissing, PA 19610

1st Floor



FILE NUMBER	DRAWING INDEX
109867	86-07269
160630	87-10666
159877	87-10665

TENANT RETROFIT
 OFFICE BUILDING
 1100 BERKSHIRE BLVD.
 WYOMISSING, PA 19610
 ALTERATIONS FOR STEWART ABSTRACT
 1ST FLOOR
EDWARD A. REIDER, INC.
 BUILDING CONSTRUCTION
 321 VAN REED ROAD
 WYOMISSING, PA 19610

OWNER: RIDGEWOOD ASSOCIATES
 292 N. MAIN AVE.
 SCRANTON, PA 18504
 PHONE: 610-376-2802
 DWG. BY: RWP
 CHK. BY:
 DATE: 10/22/03
 FAX: 610-376-5099
 SCALE: 1/8" = 1'-0"
 PAGE NUMBER: 1-1
 FILE NAME: IBM BLDG.DWG

First Floor Vacancies

No first floor Vacancies

1100 Berkshire Blvd, Wyomissing, PA 19610

3rd Floor

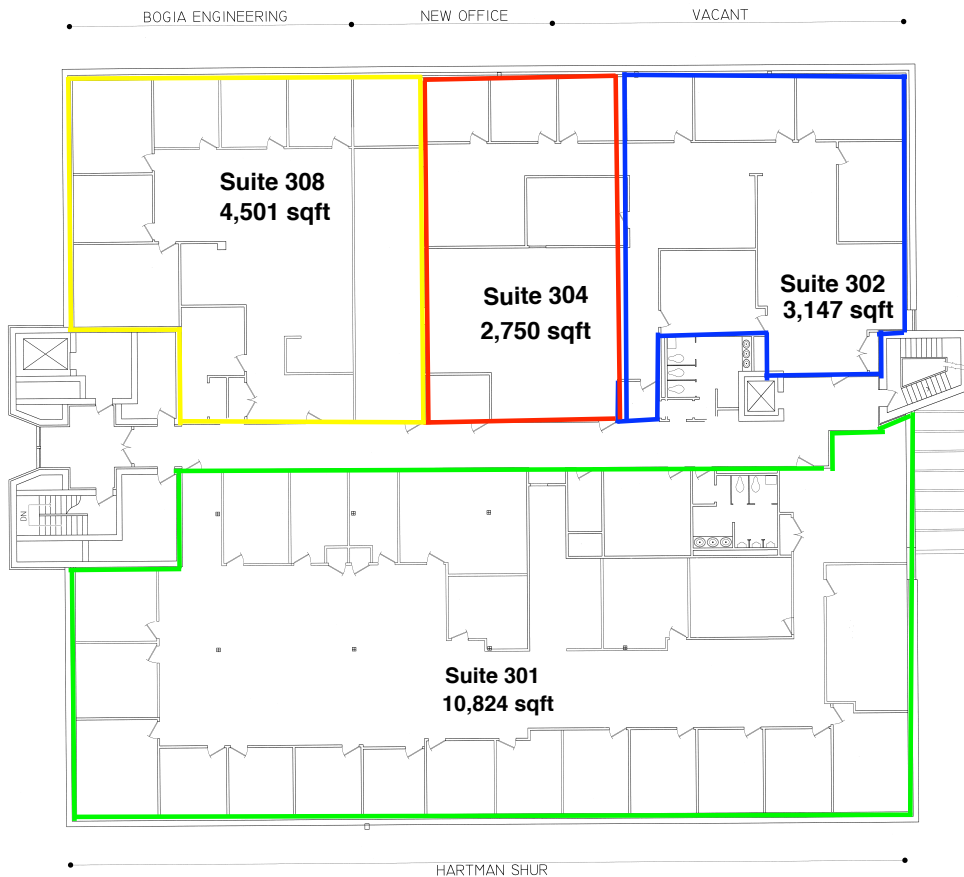

TENANT RETROFIT
OFFICE BUILDING
1100 BERKSHIRE BLVD.
WYOMISSING, PA 19610
ALTERATIONS FOR
3RD FLOOR
EDWARD A. REIDER, INC.
BUILDING CONSTRUCTION
521 VAN REED ROAD
WYOMISSING, PA 19610
PHONE: 610-376-2802 FAX: 610-376-5099
OWNER: RIDGEWOOD ASSOCIATES
200 N. MAIN AVE.
SCRANTON, PA 18504
DWG. BY: MDM
CHK. BY:
DATE: 3/13/08
SCALE: 1/8" = 1' - 0"
PAGE NUMBER: 3-3
FILE NAME: IIR BLDG ALL FLR

Third Floor Vacancies

- Suite 301: 10,824 sqft
- Suite 302: 3,147 sqft
- Suite 304: 2,750 sqft
- Suite 308: 4,501 sqft

- (1) All the third floor suites may be combined for a total of 21,222 sqft.
- (2) Suites 302&304 may be combined for a total of 5,897 sqft.
- (3) Suites 302&304&308 may be combined for a total of 10,398 sqft.
- (4) Suites 304&308 may be combined for a total of 7,251 sqft.

Leasing Contact:

Ico Koullias

Cell: 610 334-0891

E-mail: icok@aol.com



SPARTAN
PROPERTIES, LLC

**PRIME OFFICE
SPACE
AVAILABLE**

610-478-1884

mail@spartanproperties.com