



LONGWOOD, FL

SOUTH SEMINOLE INDUSTRIAL

4,864 - 5,144 RSF AVAILABLE FOR LEASE

LONGWOOD, FL

AVAILABLE FOR LEASE

SOUTH SEMINOLE INDUSTRIAL



1175 FLORIDA CENTRAL PKWY

SUITE 3200 5,144 SF FOR LEASE

PROPERTY SPECIFICATIONS

TOTAL SF	5,144 SF
LEASE RATE	\$15.50 SF
LOADING	Front Load
ZONING	IND, City of Longwood
CLEAR HEIGHT	20' 6"
AVAILABLE	Immediately
TRUCK COURT	115'

PROPERTY FEATURES

- Unique location in Longwood. Only three miles east of I-4 and 8.5 miles from SR 417
- Easy access to US HWY 17-92, Ronald Reagan Blvd., SR 436 and I-4
- Near South Seminole Hospital, UPS, USPS & FedEx



FOR MORE INFORMATION, PLEASE CONTACT:

JUSTIN RUBY, SIOR, CCIM | 407.865.0311
Justin.Ruby@foundrycommercial.com
Licensed Real Estate Broker

JOEY WOODMAN | 407.748.5888
Joey.Woodman@foundrycommercial.com
Licensed Real Estate Broker

FOUNDRY
COMMERCIAL

Although the information contained herein was provided by sources believed to be reliable, Foundry Commercial makes no representation, expressed or implied, as to its accuracy and said information is subject to errors, omissions or changes.

foundrycommercial.com

SOUTH SEMINOLE INDUSTRIAL

975 FLORIDA CENTRAL PKWY

SUITE 1200
4,864 SF FOR LEASE
PROPERTY SPECIFICATIONS

TOTAL SF	4,864 SF
LEASE RATE	\$15.95 SF
LOADING	Front Load
ZONING	IND, City of Longwood
CLEAR HEIGHT	20' 6"
AVAILABLE	Immediately
TRUCK COURT	115'

PROPERTY FEATURES

- Unique location in Longwood. Only three miles east of I-4 and 8.5 miles from SR 417
- Easy access to US HWY 17-92, Ronald Reagan Blvd., SR 436 and I-4
- Near South Seminole Hospital, UPS, USPS & FedEx

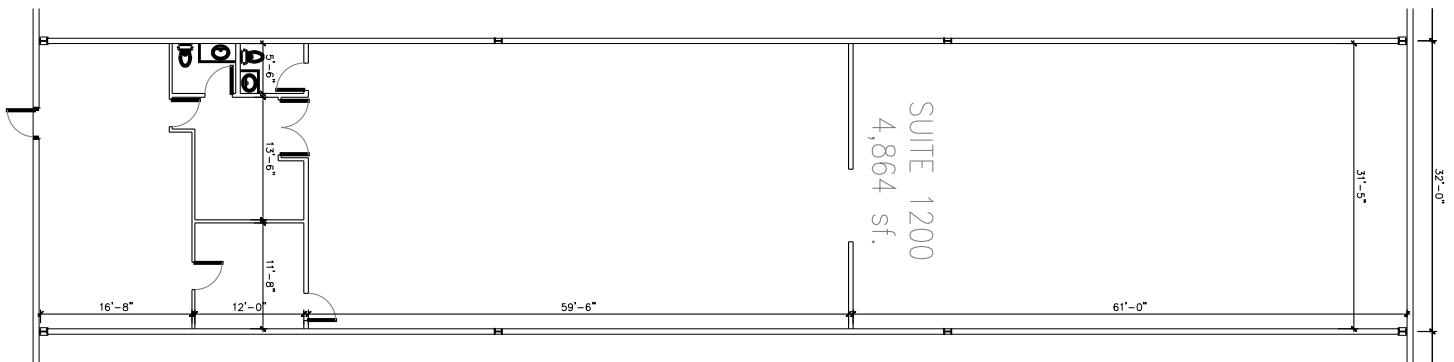
**FOR MORE INFORMATION, PLEASE CONTACT:**

JUSTIN RUBY, SIOR, CCIM | **407.865.0311**
 Justin.Ruby@foundrycommercial.com
 Licensed Real Estate Broker

JOEY WOODMAN | **407.748.5888**
 Joey.Woodman@foundrycommercial.com
 Licensed Real Estate Broker

FOUNDRY
 COMMERCIAL

LONGWOOD, FL

AVAILABLE FOR LEASE

SOUTH SEMINOLE INDUSTRIAL

PROPERTY MAP

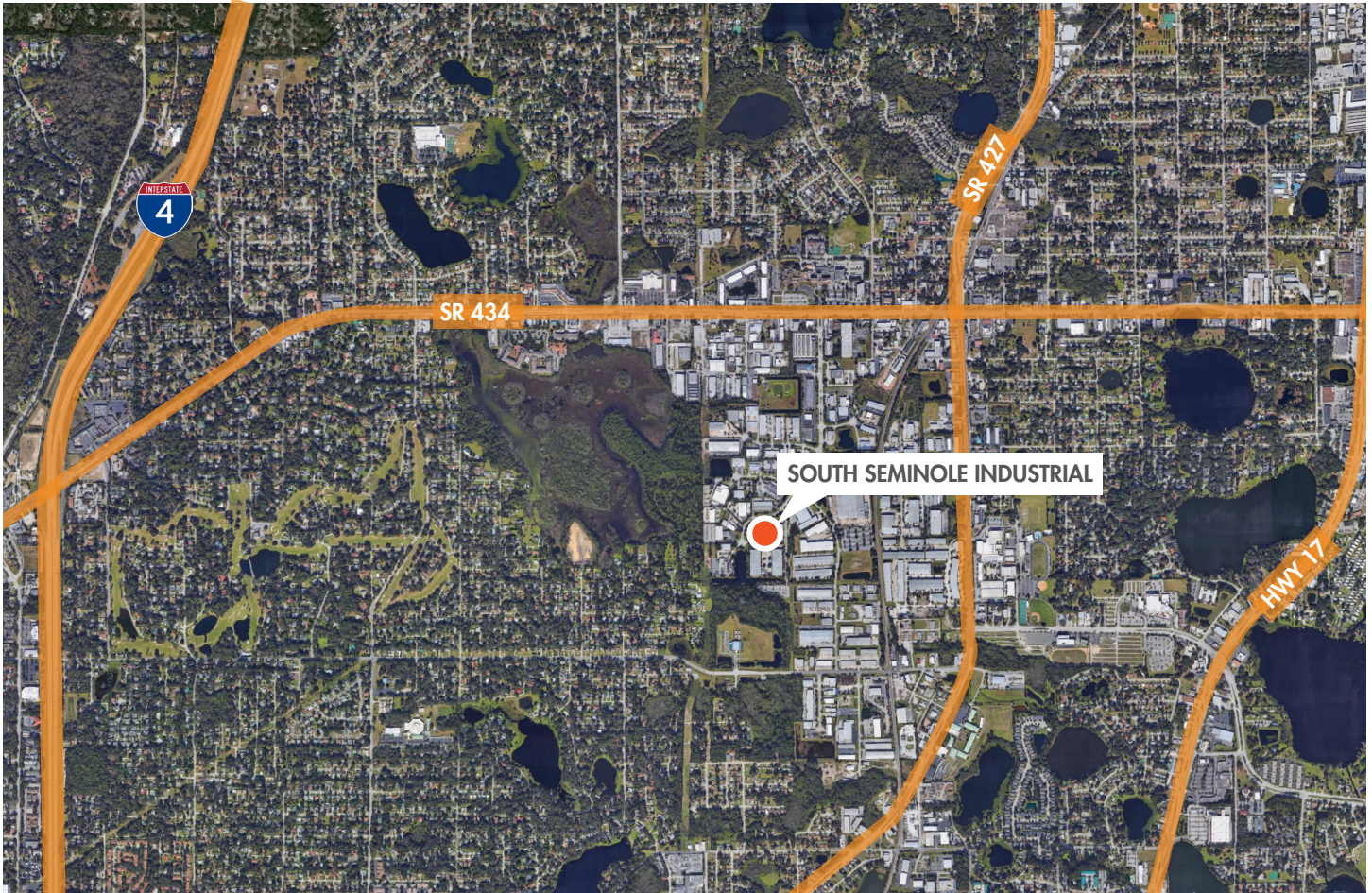

FOR MORE INFORMATION, PLEASE CONTACT:

JUSTIN RUBY, SIOR, CCIM | **407.865.0311**
Justin.Ruby@foundrycommercial.com
Licensed Real Estate Broker

JOEY WOODMAN | **407.748.5888**
Joey.Woodman@foundrycommercial.com
Licensed Real Estate Broker

FOUNDRY
COMMERCIAL

Although the information contained herein was provided by sources believed to be reliable, Foundry Commercial makes no representation, expressed or implied, as to its accuracy and said information is subject to errors, omissions or changes.

foundrycommercial.com