

APPROX. 3,011 SF RETAIL SPACE FOR LEASE

628 SANTA CRUZ AVENUE | MENLO PARK, CA 94025



FOR LEASE

- **Size:** Approx 3,011 SF
- **Rent:** \$4.50sf/mo. NNN
- **Term:** 5 year + Option
- **Condition:** "As-Is" basis

FEATURES

- Updated Storefront
- ADA Restroom
- Sprinklered
- High Ceilings - 19 feet
- Open Floor Plan
- Adjacent to Public Parking
- Walking Distance to Caltrain Station
- Signage Available Front & Rear
- Polished Concrete Floor

MICHAEL BERUBE O: 650.574.7163 | C: 650.678.9290 | Michael@Berube.com

Berube
Company, Inc.

COMMERCIAL
REAL ESTATE

The information contained herein has been provided by sources believed reliable. We do not doubt its accuracy or completeness but we have not verified it and make no guarantee, warranty or representation about it. The information should be verified and evaluated by professionals prior to entering into any contractual relationship relating to this information.

APPROX. 3,011 SF RETAIL SPACE FOR LEASE

FLOOR PLAN - RETAIL SPACE

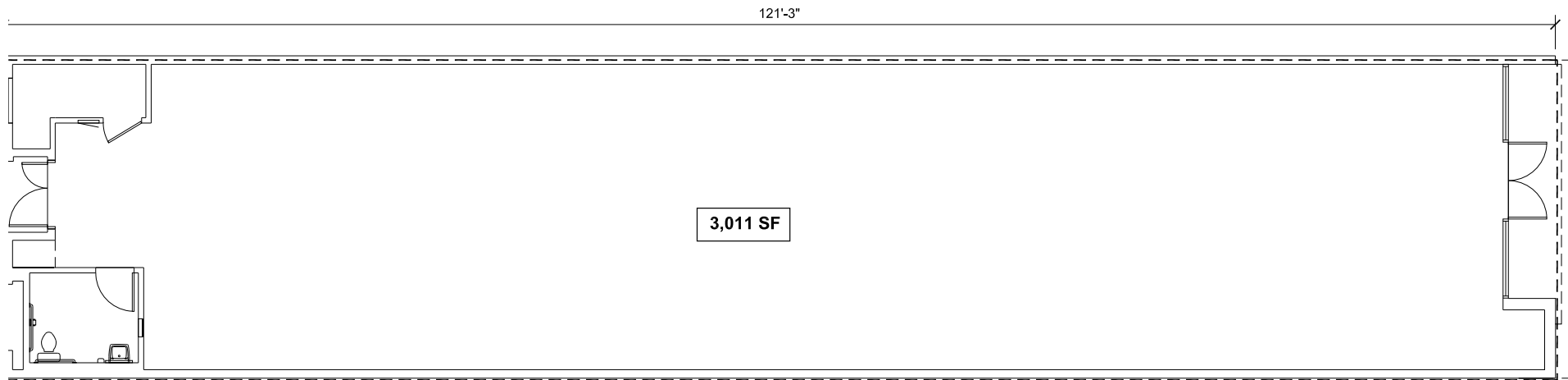

APPROX. 3,011 SF RETAIL SPACE FOR LEASE

NEIGHBORHOOD AMENITIES

DOWNTOWN MENLO PARK

RESTAURANTS

- 1 Left Bank
- 2 Ristorante Carpaccio
- 3 Trellis Restaurant
- 4 Shio! Singapore Kitchen
- 5 Bistro Vida
- 6 Gerry's Cakes
- 7 Subway
- 8 Amici's East Coast Pizzeria
- 9 Round Table Pizza
- 10 Cold Stone Creamery
- 11 The Refuge
- 12 Galata Bistro Mediterranean Grill
- 13 Stacks
- 14 Octopus Japanese Restaurant
- 15 Black Pepper Restaurant
- 16 British Bankers Club
- 17 Jeffrey's Hamburgers
- 18 Cook's Seafood

COFFEE

- 1 Café Borrone
- 2 Peet's Coffee
- 3 Starbucks
- 4 Bagel Street Café
- 5 Coffeebar Menlo Park
- 6 Menlo Cafe
- 7 Mademoiselle Colette



The information contained herein has been provided by sources believed reliable. We do not doubt its accuracy or completeness but we have not verified it and make no guarantee, warranty or representation about it. The information should be verified and evaluated by professionals prior to entering into any contractual relationship relating to this information.