



NORTH SHORE SQUARE

Slidell, Louisiana

North Shore Square is a 621,292 square foot shopping center, located along Interstate 12 and Northshore Boulevard, an intersection containing over 1.7 million square feet of retail. North Shore Square’s primary market consists of St. Tammany Parish, Hancock County, Pearl River County, and surrounding municipalities in Louisiana and Mississippi.



UNDER REDEVELOPMENT

CENTER PROFILE

Total Square Feet	621,292
Number of Stores/Services	4
Number of Levels	1
Number of Parking Spaces	3,140

MAJOR TENANTS

At Home	97,582 SF
Dillard’s	76,954 SF

MARKET DEMOGRAPHICS

3 Mile	
Population	21,535
Number of Households	7,835
Average Household Income	\$66,575

5 Mile	
Population	58,855
Number of Households	21,889
Average Household Income	\$71,327

10 Mile	
Population	115,720
Number of Households	43,524
Average Household Income	\$79,846

Daily Vehicle Count	
I12	67,000
Northshore Blvd	29,000

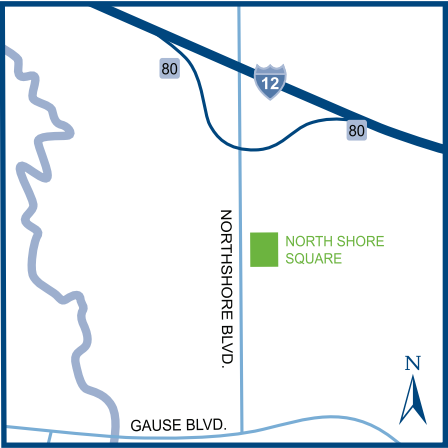

NORTH SHORE SQUARE
150 Northshore Boulevard
Slidell, LA 70460
Phone 985-646-0661

LEASING INQUIRIES

Morguard Management Company Inc.
6305 Airline Drive, Metairie, LA 70003
Phone 504-904-8546
Amanda Punch-Gill Apunchgill@morguard.com
morguard.com



Real Estate Potential. Realized.

NORTH SHORE SQUARE

TENANT LIST

ANCHORS	
At Home	1000
Dillard’s	3000
RESTAURANT/FOOD	
Cane’s	
Olive Garden	OP B2



NORTH SHORE SQUARE

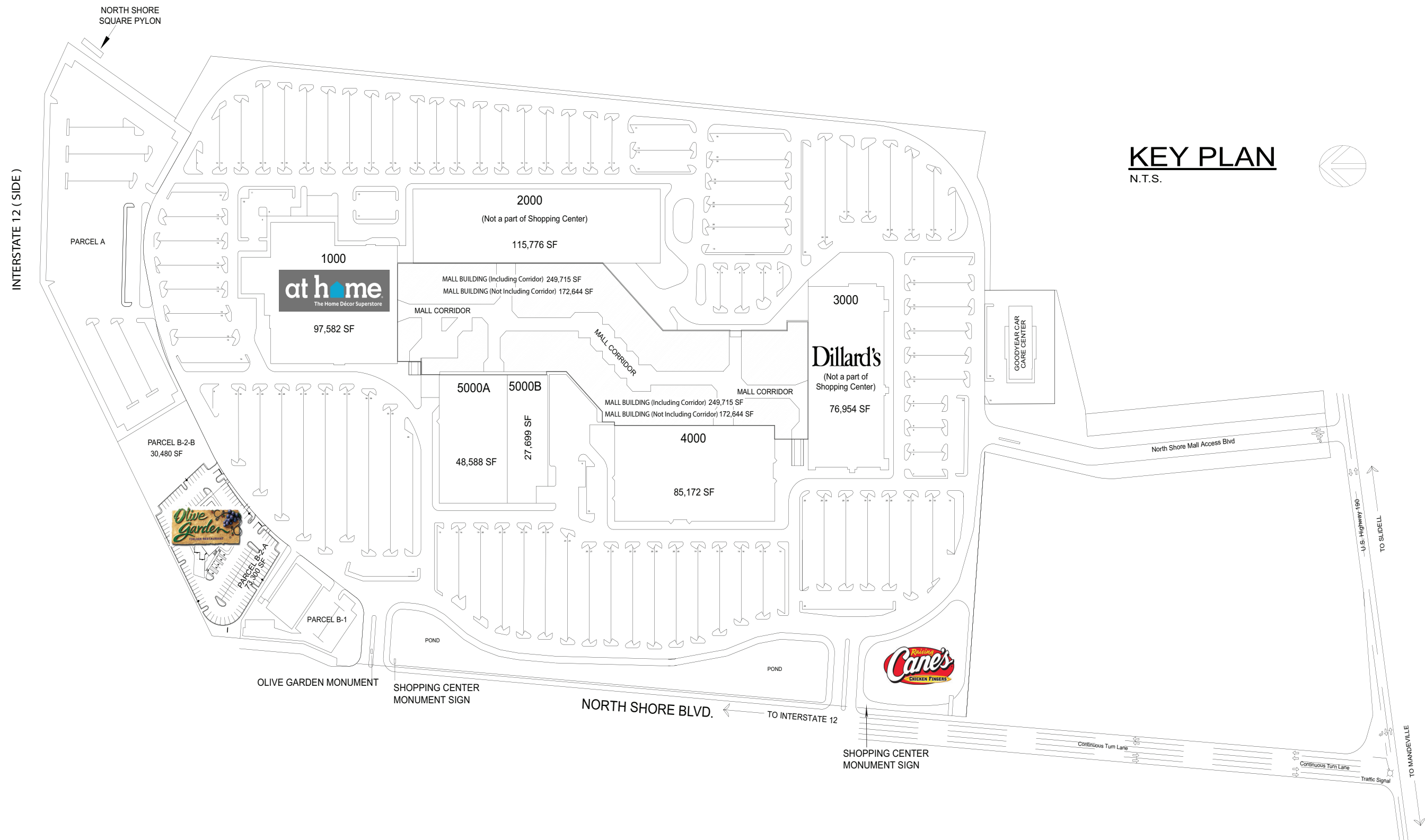

NORTH SHORE SQUARE

