

# ***NORTH WARSON*** INDUSTRIAL CENTER

**FOR LEASE | WAREHOUSE/INDUSTRIAL**

1067 - 1151 N. WARSON ROAD  
ST. LOUIS, MO 63132



**Daniel Bamberger, SIOB**  
Executive Vice President  
+1 314 584 6226  
[daniel.bamberger@colliers.com](mailto:daniel.bamberger@colliers.com)

**Chad Burkemper, SIOB**  
Executive Vice President  
+1 314 584 6279  
[chad.burkemper@colliers.com](mailto:chad.burkemper@colliers.com)



# NORTH WARSON INDUSTRIAL CENTER

## FOR LEASE | Property Details

North Warson Industrial Center is a 317,109 SF industrial park comprised of four industrial buildings with a total 15 tenant spaces. Conveniently located near the intersection of Olive Boulevard and North Lindbergh Boulevard, it lies within the innovative 39 North District and is close to both the Donald Danforth Plant Science Center and the Bayer Campus.

North Warson Industrial Center offers a vast amount of loading options for warehouse tenants and monument signage visible to North Warson Road.

### Major Tenants:



### Available Spaces:

1067 North Warson Road\*

**Building A**

**9,318 SF**

**Lease Rate: \$7.25/SF NNN**

1071 North Warson Road\*

**Building A**

**19,000 SF**

**Lease Rate: \$7.25/SF NNN**

*\*Suites can be combined for a total of 28,318 SF*



# SITE MAP

**BUILDING B**  
99,273 SF

**BUILDING C**  
61,612 SF

**BUILDING D**  
92,081 SF

**BUILDING A**  
64,143 SF

North Warson Road

## AVAILABILITY | BUILDING A

Address	1067 North Warson Road St. Louis, MO 63132
Total Building SF	64,143 SF
Use	Warehouse
Available SF	9,318 SF
Office SF	800 SF
Clear Height	17' 6"
Column Spacing	30' x 30'
Loading Docks	One (1)
Drive-ins	One (1) ramped
Sprinkler System	Wet
Available Date	January 1, 2026

*Can be combined with adjacent suite for a total of 28,318 SF*

Lease Rate:

**\$7.25/SF NNN**

**1067**  
9,318 SF



## AVAILABILITY | BUILDING A

Address	1071 North Warson Road St. Louis, MO 63132
Total Building SF	64,143 SF
Use	Warehouse
Available SF	19,000 SF
Minimum Divisible SF	9,500 SF
Office SF	Approximately 1,500 SF
Clear Height	17' 6"
Column Spacing	30' x 30'
Loading Docks	Four (4)
Sprinkler System	Wet
Available Date	Now

*Can be combined with adjacent suite for a total of 28,318 SF*

Lease Rate:

**\$7.25/SF NNN**



## AVAILABILITY | BUILDING A

### Floor Plan

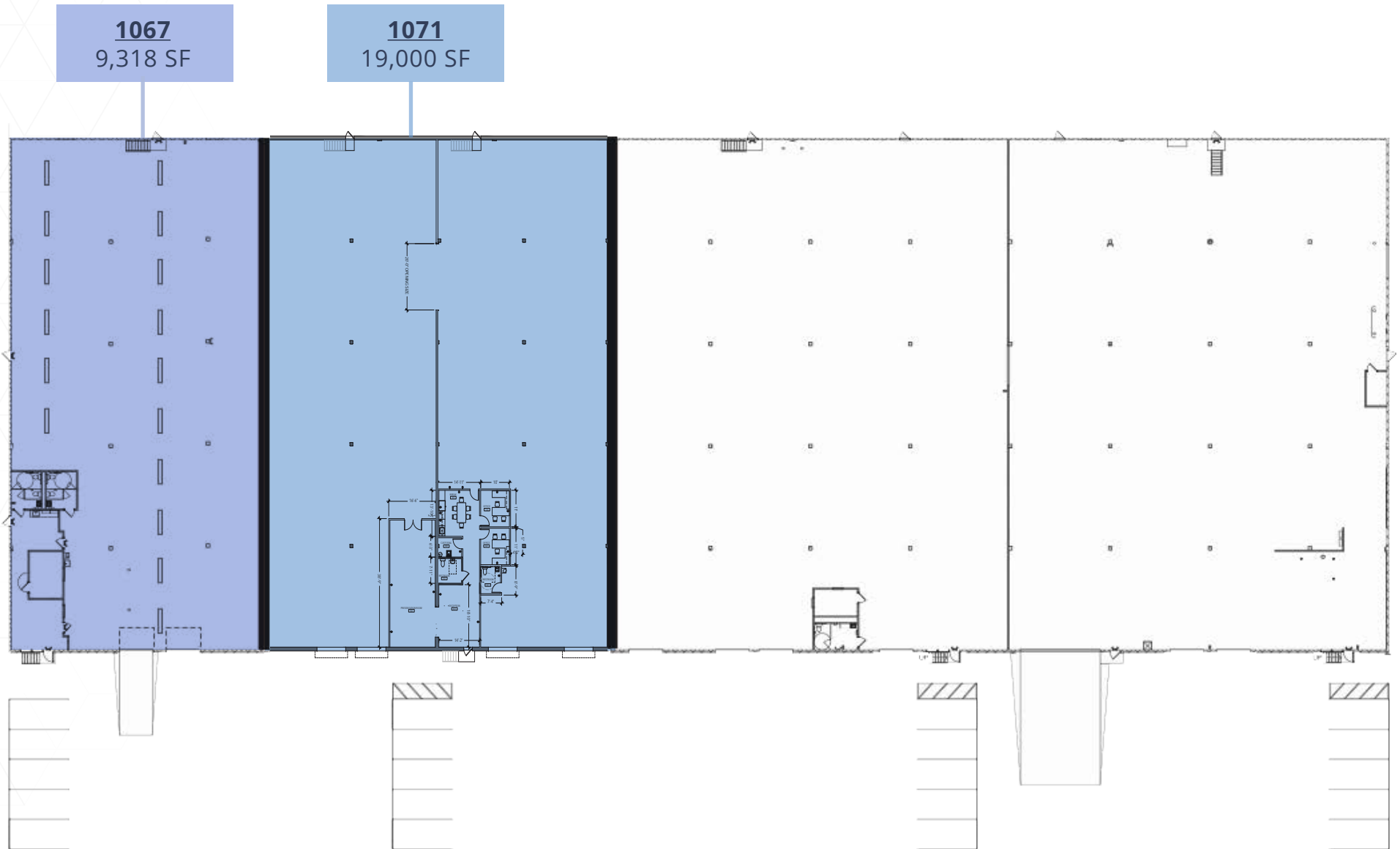

# LOCATION



# ***NORTH WARSON***

## **INDUSTRIAL CENTER**

**FOR LEASE | WAREHOUSE/INDUSTRIAL**

1067 - 1151 N. WARSON ROAD  
ST. LOUIS, MO 63132

**For further information, please contact:**

**Daniel Bamberger, SIOR**  
Executive Vice President  
+1 314 584 6226  
daniel.bamberger@colliers.com

**Chad Burkemper, SIOR**  
Executive Vice President  
+1 314 584 6279  
chad.burkemper@colliers.com

101 S. Hanley Road  
Suite 1400  
Clayton, MO 63105  
+1 314 863 4447  
colliers.com/stlouis



This document/email has been prepared by Colliers for advertising and general information only. Colliers makes no guarantees, representations or warranties of any kind, expressed or implied, regarding the information including, but not limited to, warranties of content, accuracy and reliability. Any interested party should undertake their own inquiries as to the accuracy of the information. Colliers excludes unequivocally all inferred or implied terms, conditions and warranties arising out of this document and excludes all liability for loss and damages arising there from. This publication is the copyrighted property of Colliers and /or its licensor(s). © 2025. All rights reserved. This communication is not intended to cause or induce breach of an existing listing agreement.