

3251 Riverport Dr

13,000 - 54,935 RSF of Office Space for Sublease

3251 RIVERPORT DR
MARYLAND HEIGHTS, MO 63043



NEWMARK
ZIMMER

3251 Riverport Dr

MARYLAND HEIGHTS, MO 63043

Building Summary

- 146,138 SF Class A office building located in Maryland Heights

Space Size

- 2nd Floor: 13,000 - 54,935 RSF

Space Highlights

- Full second floor available (divisible)
- Furniture available
- On-site Cafe
- Excellent glass line throughout

Sublease Rate

- \$15.00/RSF, full service

Parking Ratio

- 5.65/1,000

Sublease Expiration

- 6/30/2026

NEWMARK
ZIMMER

2nd Floor: 13,000 - 54,935 RSF

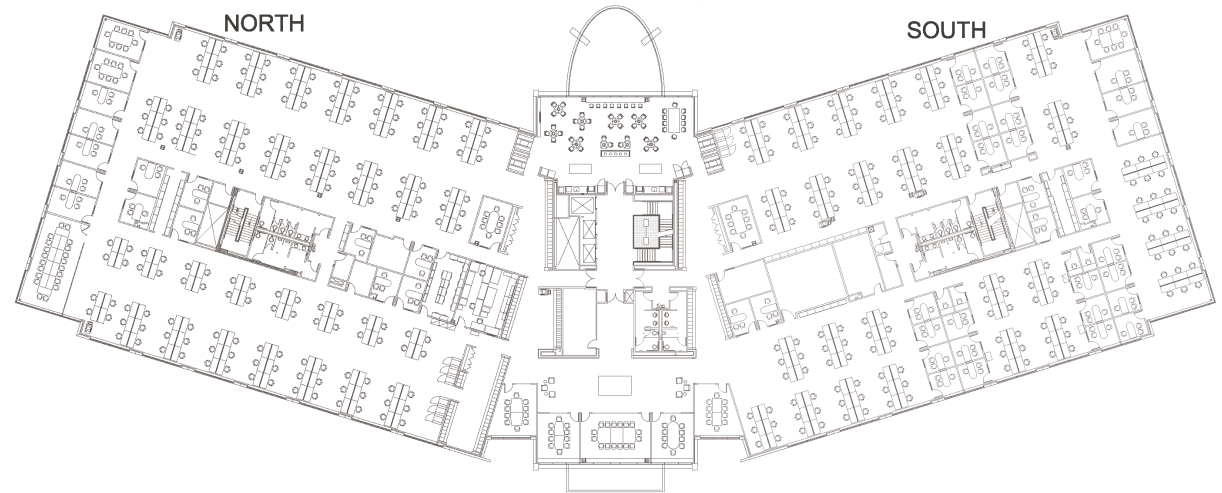

3251 RIVERPORT DR

Interior Photos

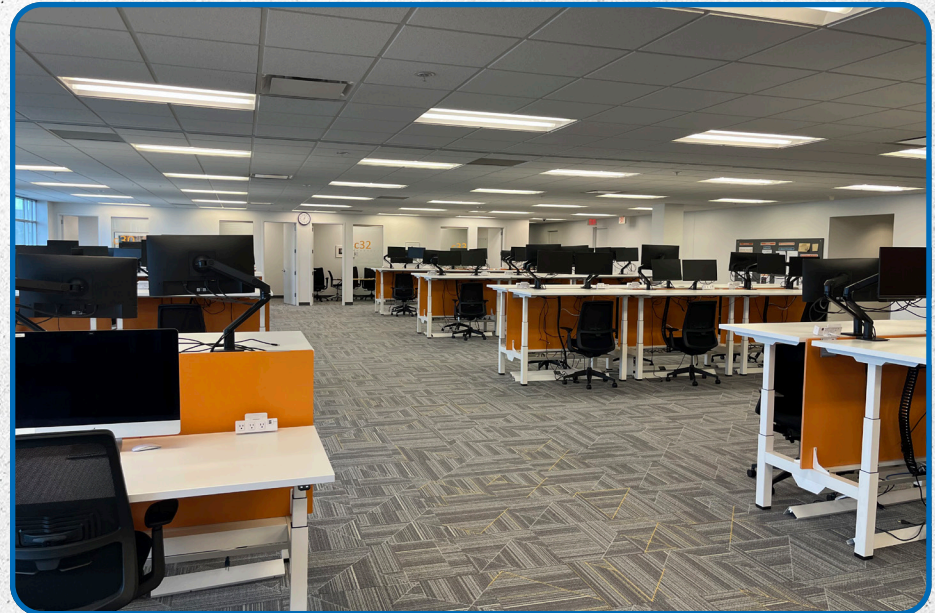



FOR FURTHER INFORMATION, PLEASE CONTACT:

Christian Burns

Associate

t 314-628-0444

cburns@nzimmer.com

Mike Carlson, SIOR, CCIM

Executive Managing Director, Principal

t 314-628-0438

mcarlson@nzimmer.com

Ben Albers

Senior Managing Director

t 314-628-0439

balbers@nzimmer.com

Jay Travis

Director

t 314-628-0442

jtravis@nzimmer.com

8235 Forsyth Boulevard, Suite 200
St. Louis, MO 63105

nmrkzimmer.com

NEWMARK
ZIMMER

The information contained herein has been obtained from sources deemed reliable but has not been verified and no guarantee, warranty or representation, either express or implied, is made with respect to such information. Terms of sale or lease and availability are subject to change or withdrawal without notice.