



# CUSTOM SPEC SUITES AVAILABLE FOR LEASE

UNDER NEW OWNERSHIP & MANAGEMENT BY  
TOP HEALTHCARE REAL ESTATE OWNER

**1800 & 1900 Hollister Drive**  
Libertyville, Illinois 60048

One Oakbrook Terrace  
Suite 400  
Oakbrook Terrace, Illinois 60181  
+1 630 932 1234

[hiffman.com](http://hiffman.com)

## PROPERTY HIGHLIGHTS

Two building Medical Office Campus with Class A Space available for lease. Located within close proximity to Advocate Condell Medical Center and top retail destinations, such as Hawthorn Mall and Mellody Farm.



COMPLETELY NEW  
RENOVATED COMMON  
AREAS & TENANT  
AMENITIES



SYNERGISTIC MIX OF MEDICAL  
CO-TENANTS PRIMARY CARE,  
NEUROLOGY, PULMONOLOGY, ENT,  
OPHTHALMOLOGY, PEDIATRICS

## Contact

Sarah Walker  
+1 630 389 8911  
[swalker@hiffman.com](mailto:swalker@hiffman.com)

Jason Wurtz  
+1 630 693 0692  
[jwurtz@hiffman.com](mailto:jwurtz@hiffman.com)



COVERED PARKING



UNDER NEW OWNERSHIP  
& MANAGEMENT



CLOSE PROXIMITY TO  
ADVOCATE CONDELL  
MEDICAL CENTER



OFFICE VIEWS OF  
FOREST PRESERVE &  
WALKING TRAILS

# 1800 HOLLISTER



## SPACE AVAILABLE

Suite G10	1,788 - 4,982 SF
Suite G18	3,194 - 4,982 SF

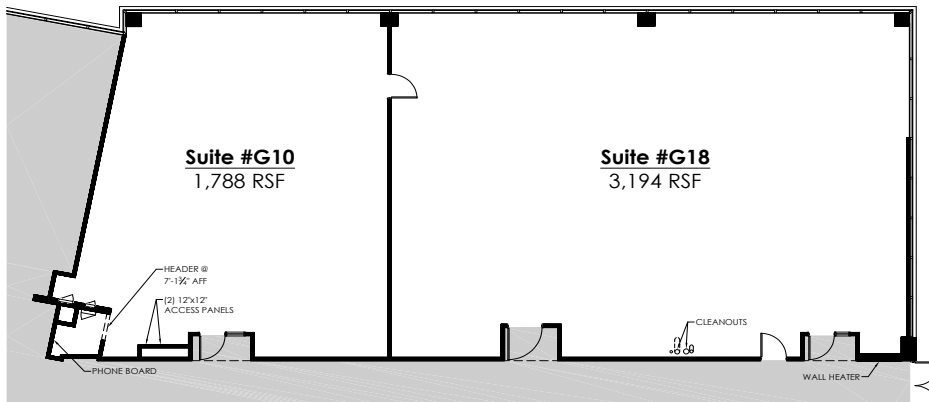
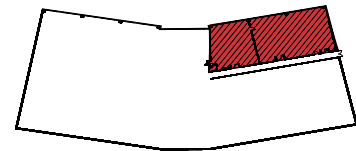

# 1900 HOLLISTER

## AVAILABLE SUITES

Suite 100	1,265 - 2,246 SF
Suite 120	1,429 SF
Suite 130	981 - 2,246 SF
Suite 230	1,700 - 2,989 SF
Suite 260	1,095 SF
Suite 300	1,552 SF
Suite 330	2,259 - 5,815 SF
Suite 350	359 - 5,815 SF
Suite 380	2,048 SF
Suite 390	3,197 - 5,815 SF

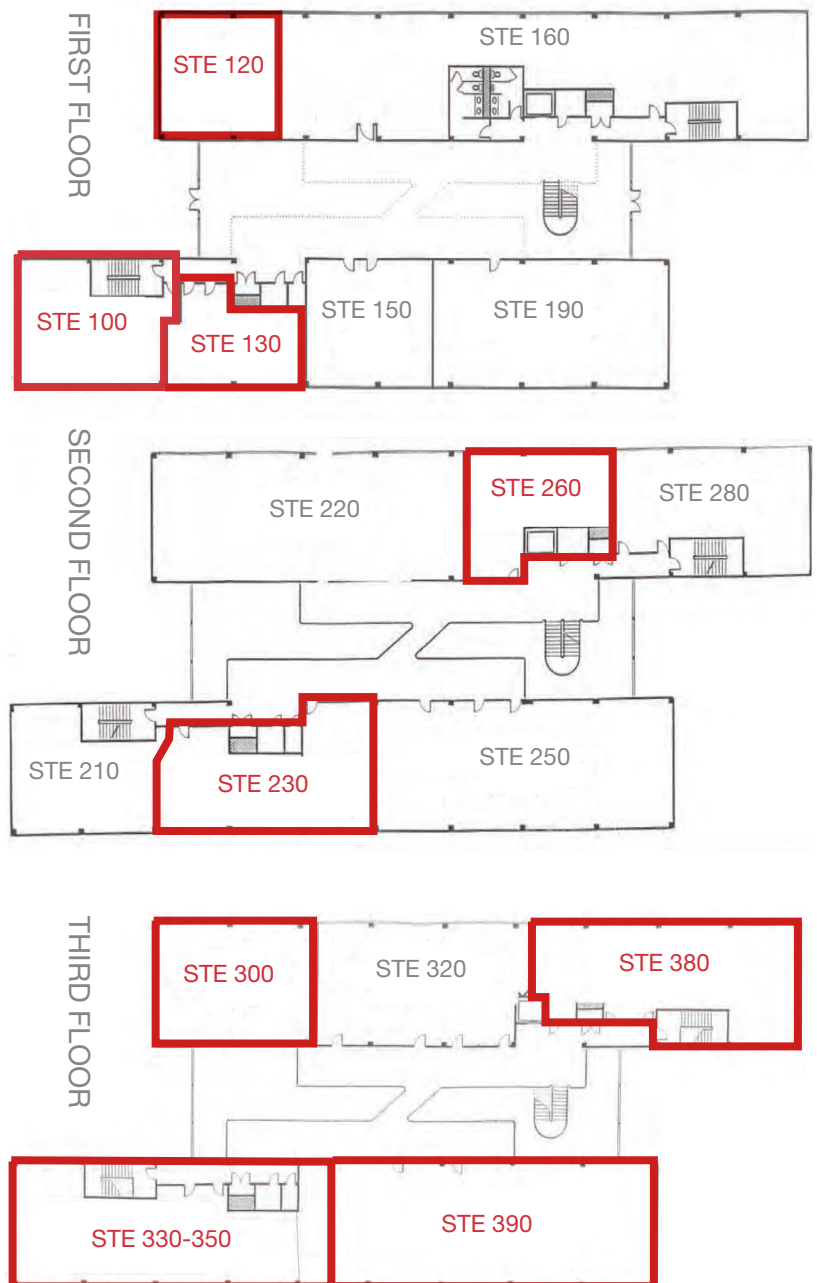
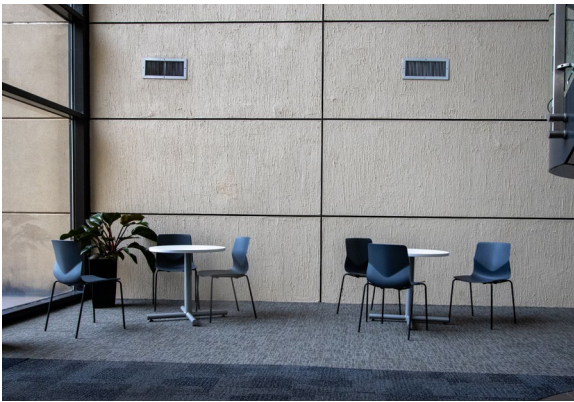



## Contact

Sarah Walker  
 +1 630 389 8911  
 swalker@hiffman.com

Jason Wurtz  
 +1 630 693 0692  
 jwurtz@hiffman.com



One Oakbrook Terrace  
 Suite 400  
 Oakbrook Terrace, Illinois 60181  
 +1 630 932 1234

[hiffman.com](http://hiffman.com)