



**2312
SOUTH
ANDREWS
AVENUE**

Fort Lauderdale, FL 33316

FOR SALE

2,811 SQUARE FEET
OFFICE/RETAIL

FOR SALE

2312 S ANDREWS AVENUE

Fort Lauderdale, FL 33316



INTERIOR PHOTOS

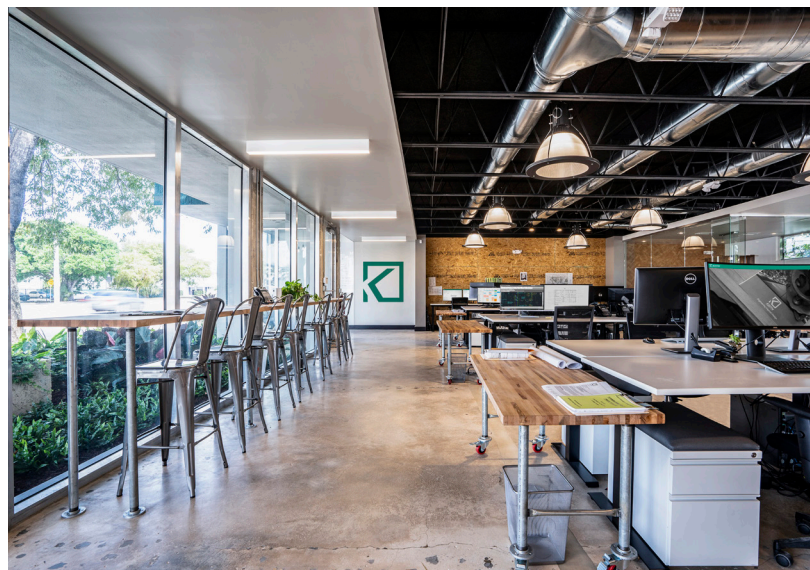

FOR SALE

2312 S ANDREWS AVENUE

Fort Lauderdale, FL 33316



SITE MAP



PROPERTY FEATURES

- 2,811 SF building available for office or retail use.
- Newly renovated with hurricane impact glass, exposed ductwork/ceiling, slab flooring, and state-of-the-art interior finishes.
- High visibility location on Andrews Avenue near SR 84.
- Ease of access to Downtown Fort Lauderdale, Fort Lauderdale/Hollywood International Airport, and major interstates I-595 & I-95.
- 4.12/1,000 parking ratio directly accessible from the rear of the building.
- Asking Price: ~~\$2,250,000~~ Price Reduced to \$2,100,000

FOR SALE

2312 S ANDREWS AVENUE

Fort Lauderdale, FL 33316



FLOOR PLAN

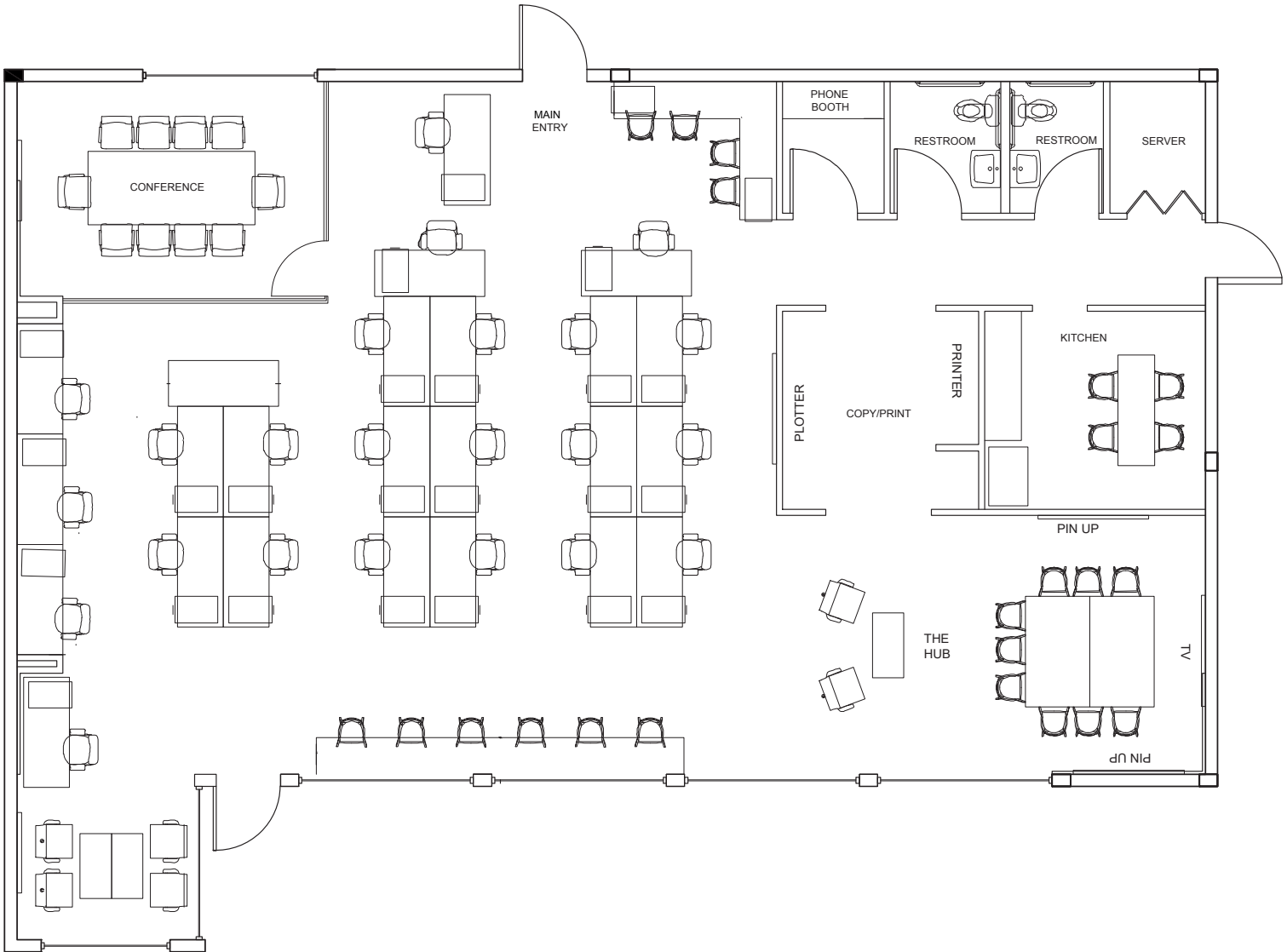

For more information, please contact:

A.J. BELT

Managing Director
+1 954 377 0511
aj.belt@cushwake.com

JEFF HOLDING

Executive Director
+1 954 377 0512
jeff.holding@cushwake.com

TRENT SLATTERY

Senior Associate
+1 954 938 2619
trent.slattery@cushwake.com

CUSHMAN & WAKEFIELD

515 E Las Olas Blvd Suite 900
Fort Lauderdale, FL 33301
cushmanwakefield.com

©2024 Cushman & Wakefield. All rights reserved. The information contained in this communication is strictly confidential. This information has been obtained from sources believed to be reliable but has not been verified. NO WARRANTY OR REPRESENTATION, EXPRESS OR IMPLIED, IS MADE AS TO THE CONDITION OF THE PROPERTY (OR PROPERTIES) REFERENCED HEREIN OR AS TO THE ACCURACY OR COMPLETENESS OF THE INFORMATION CONTAINED HEREIN, AND SAME IS SUBMITTED SUBJECT TO ERRORS, OMISSIONS, CHANGE OF PRICE, RENTAL OR OTHER CONDITIONS, WITHDRAWAL WITHOUT NOTICE, AND TO ANY SPECIAL LISTING CONDITIONS IMPOSED BY THE PROPERTY OWNER(S). ANY PROJECTIONS, OPINIONS OR ESTIMATES ARE SUBJECT TO UNCERTAINTY AND DO NOT SIGNIFY CURRENT OR FUTURE PROPERTY PERFORMANCE.