



Directions: From the 101 Freeway, exit Oxnard Blvd., turn right, then left on Town Center Drive
Amenities: On-site Manager, Receptionist, Conference Room, High-Speed Internet, Voice Mail, Fax, Copier, Fully Equipped Kitchen, Coffee Service, Furnished and Unfurnished Suites

Highlights: Conveniently located near the prestigious River Park development, the Oxnard financial district, the Esplande Shopping Center, with pleasant views of mountains to the north.



Home of the "Instant Office"
Elegant But Affordable

For pricing & availability, contact Mary Squire
 1000 Town Center Dr., Suite 300
 Oxnard, CA 93036
 805-358-8303 • www.rpexecutivesuites.com
mary@rpexecutivesuites.com



Home of the "Instant Office"

Elegant But Affordable

1000 Town Center Dr., Suite 300
 Oxnard, CA 93036

River Park Executive Suites, home of the "instant office," is Ventura's newest, full service executive suites, located in a premier, Class A office building at Oxnard Boulevard and the 101 Freeway.

As a cost-effective, "instant office" alternative to conventional office space, River Park Executive Suites offers tenants phone, reception and internet service on their first day of occupancy, avoiding the wait associated with opening a new office. Forty-six ready-to-use, unfurnished and furnished offices suites (32 with views) providing a professional image are available on a temporary or long-term basis.

Full-time Office Space Plans start at \$650 - \$2,595 per month and Virtual Office Plans start at \$99 - \$199 per month. Plan program information sheets available upon request.

Suite Features & Services

Full-time Office Plans include personalized reception service, phone answering, paging and voice mail, incoming & outgoing daily mail and pickup by FedEx. Each office has high-speed internet access and use of a state-of-the-art conference room with large flat panel display, teleconferencing and internet access. Other amenities include:

- Professionally decorated lobby/reception area
- On-site Business Office Center management
- Professionally equipped common kitchen area with vending, refrigerator, microwave, filtered water, coffee machine
- Utilities included
- 24/7 building access with electronic security
- Access to over 650 conference rooms worldwide
- Weekly janitorial included

Additional services for nominal fees include:

- Secretarial/word processing services
- Access to Business Technology Center
- Postal meter and scales
- Administrative and bookkeeping services

Virtual Office Plans include use of our professional business address. For additional fees, personalized answering service with voice mail, office or conference room usage is available.

River Park

EXECUTIVE SUITES

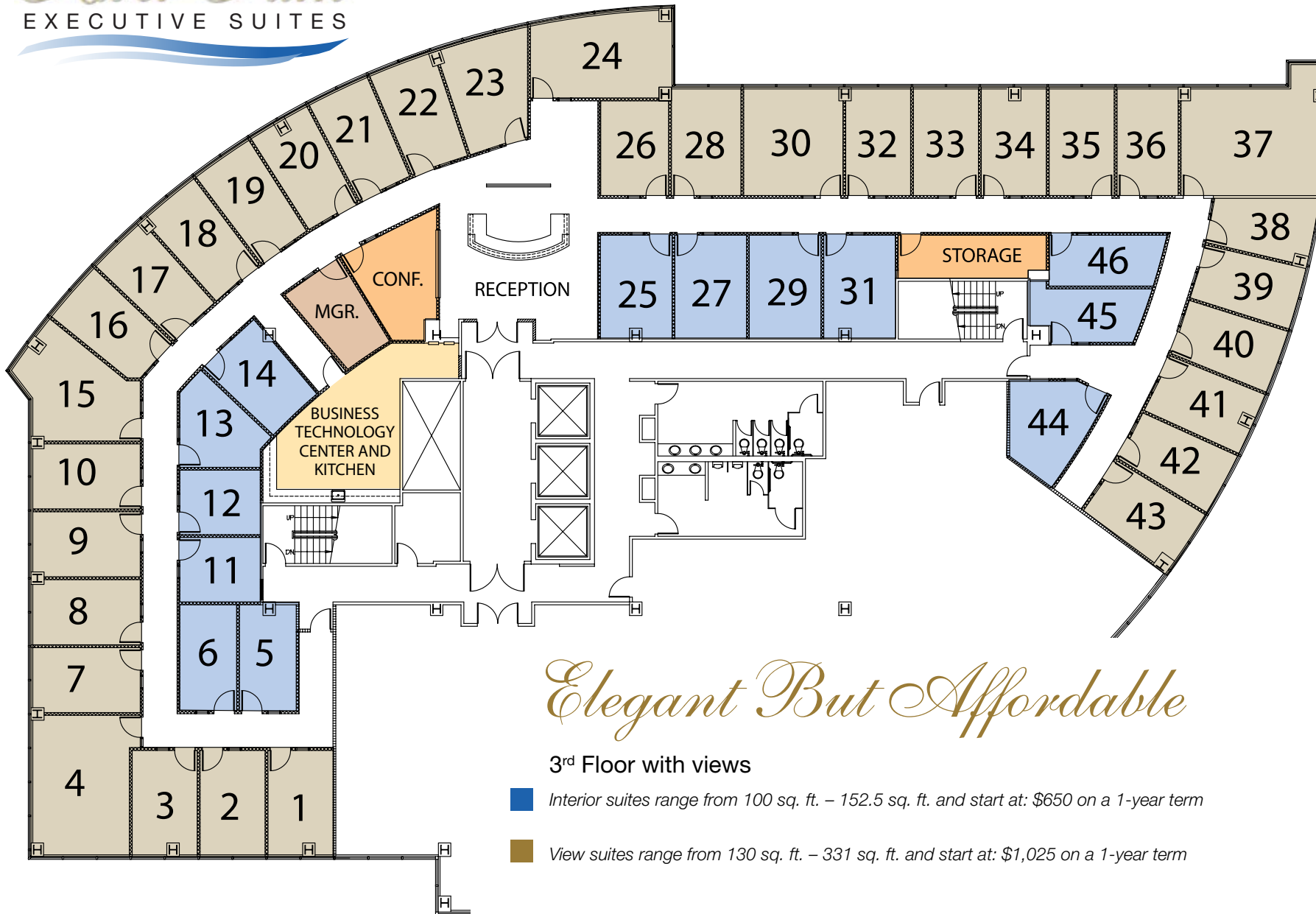

Elegant But Affordable

3rd Floor with views

- Interior suites range from 100 sq. ft. – 152.5 sq. ft. and start at: \$650 on a 1-year term
- View suites range from 130 sq. ft. – 331 sq. ft. and start at: \$1,025 on a 1-year term

SUITE & OFFICE SPECIFICATIONS:

SUITE 1 – 9'-7"x15'-4"	SUITE 24 – 20'-10"x12'-3"
SUITE 2 – 9'-7"x15'-4"	SUITE 25 – 10'-6"x15'-3"
SUITE 3 – 9'-7"x15'-4"	SUITE 26 – 10'-0"x14'-0"
SUITE 4 – 14'-3"x20'-6"	SUITE 27 – 10'-6"x15'-3"
SUITE 5 – 9'-7"x15'-4"	SUITE 28 – 10'-3"x15'-8"
SUITE 6 – 9'-7"x15'-4"	SUITE 29 – 10'-6"x15'-3"
SUITE 7 – 15'-10"x9'-7"	SUITE 30 – 14'-7"x15'-8"
SUITE 8 – 15'-10"x9'-7"	SUITE 31 – 10'-6"x15'-3"
SUITE 9 – 15'-10"x9'-7"	SUITE 32 – 9'-6"x15'-8"
SUITE 10 – 15'-10"x9'-7"	SUITE 33 – 9'-7"x15'-8"
SUITE 11 – 11'-10"x9'-6"	SUITE 34 – 9'-7"x15'-8"
SUITE 12 – 11'-10"x9'-6"	SUITE 35 – 9'-7"x15'-8"
SUITE 13 – 11'-10"x9'-8"	SUITE 36 – 9'-7"x15'-8"
SUITE 14 – 14'-4"x9'-7"	SUITE 37 – 21'-2"x15'-8"
SUITE 15 – 15'-10"x13'-9"	OFFICE 38 – 8'-3"x15'-3"
SUITE 16 – 8'-10"x16'-0"	OFFICE 39 – 8'-8"x15'-3"
SUITE 17 – 8'-8"x16'-0"	OFFICE 40 – 8'-10"x15'-3"
SUITE 18 – 8'-11"x16'-0"	OFFICE 41 – 9'-2"x15'-3"
SUITE 19 – 8'-10"x16'-0"	OFFICE 42 – 8'-7"x15'-3"
SUITE 20 – 8'-10"x16'-0"	OFFICE 43 – 9'-6"x15'-3"
SUITE 21 – 8'-10"x16'-0"	OFFICE 44 – 11'-0"x13'-3"
SUITE 22 – 9'-2"x16'-0"	OFFICE 45 – 16'-8"x7'-10"
SUITE 23 – 11'-0"x16'-0"	OFFICE 46 – 15'-4"x7'-6"