

Industrial | For Lease

5815 E. Executive Dr

Westland, MI

14,472 SF Available



Contact Us

Jacob Ginster

Associate
+1 248 633 6119
jake.ginster@cbre.com

Charles M. Ginster

Senior Vice President
+1 248 760 2439
chuck.ginster@cbre.com

Joseph Hauska

First Vice President
+1 248 763 0463
joseph.hauska@cbre.com

14,472 SF SITUATED ON 1.22 ACRES

5815 E. Executive Dr, Westland, MI

For Lease

Property Features

\$8.50/NNN

Lease Rate

14,472

Square Footage

1.22

Acres

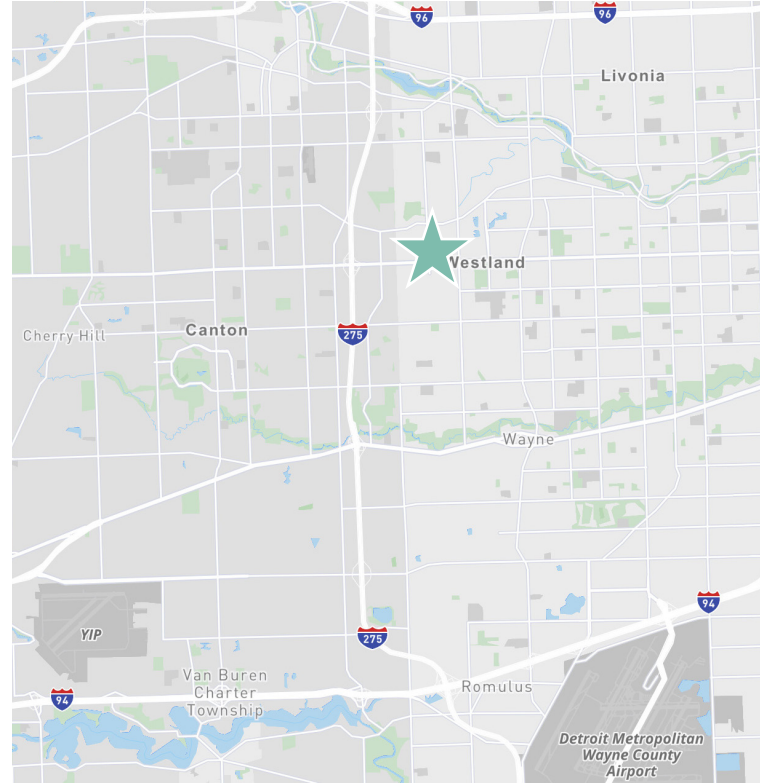

Total Available	14,472 SF	Crane	Two (One) 1 Ton
Available Office	2,835 SF	Zoning	Industrial
Available Warehouse	11,637 SF	Truckwells / Docks	No
Ceiling Height	17'	Grade Level Doors	Three (3) 12'w x 14h
Parking	40 Free Surface Spaces	Year Built	1983

Comments

- + Heavy Power, Fully Air-Conditioned, and Fire Suppression System
- + Well Positioned Location off Ford Rd & E. Executive Dr, Close Proximity to I-275
- + Clean Warehouse, Ample Parking, Excellent Visibility

14,472 SF SITUATED ON 1.22 ACRES

5815 E. Executive Dr, Westland, MI

For Lease

Floor Plan

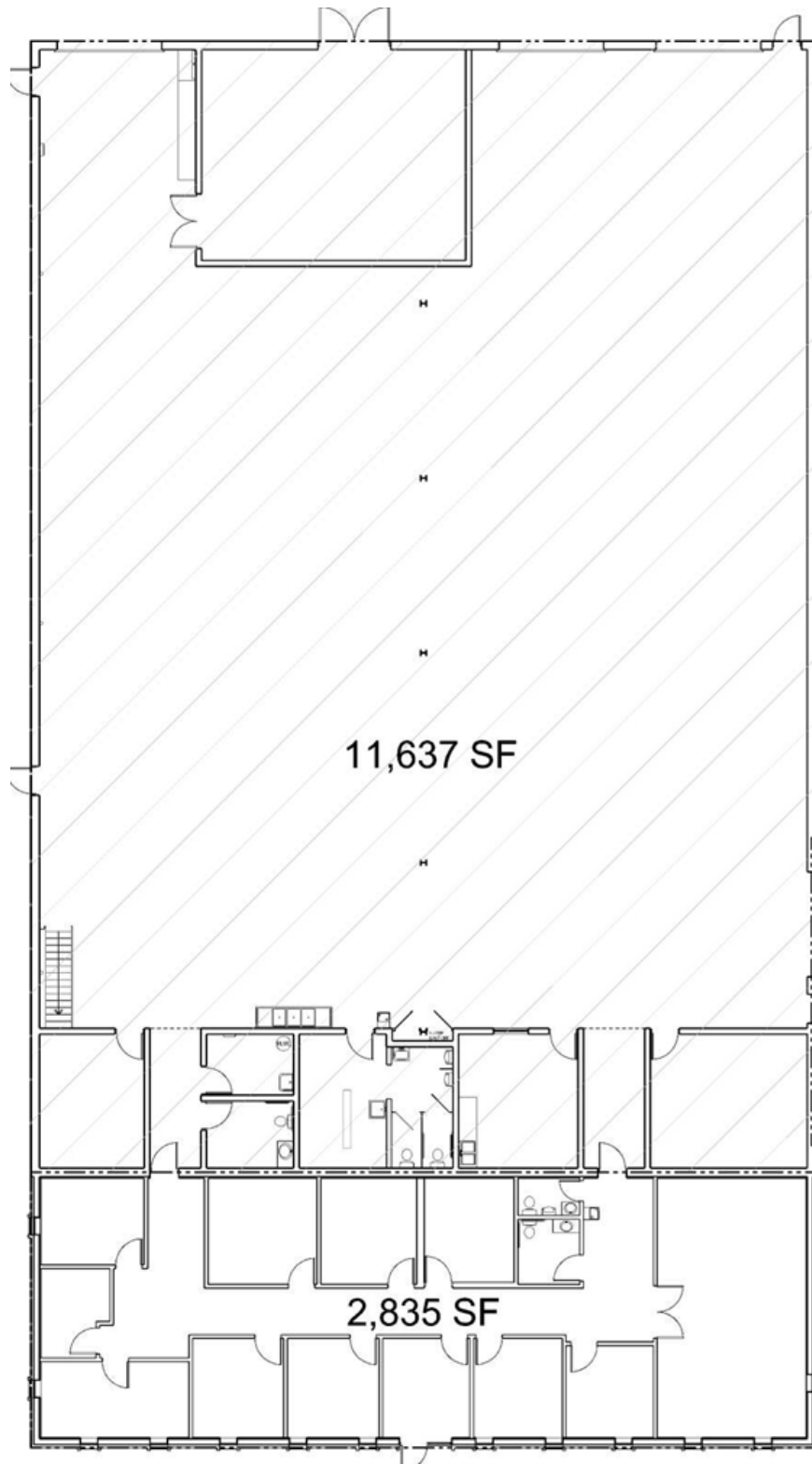

14,472 SF SITUATED ON 1.22 ACRES

5815 E. Executive Dr, Westland, MI

For Lease

Aerial



Contact Us

Jacob Ginster

Associate
+1 248 633 6119
jake.ginster@cbre.com

Charles M. Ginster

Senior Vice President
+1 248 760 2439
chuck.ginster@cbre.com

Joseph Hauska

First Vice President
+1 248 763 0463
joseph.hauska@cbre.com

© 2023 CBRE, Inc. All rights reserved. This information has been obtained from sources believed reliable, but has not been verified for accuracy or completeness. You should conduct a careful, independent investigation of the property and verify all information. Any reliance on this information is solely at your own risk. CBRE and the CBRE logo are service marks of CBRE, Inc. All other marks displayed on this document are the property of their respective owners, and the use of such logos does not imply any affiliation with or endorsement of CBRE. Photos herein are the property of their respective owners. Use of these images without the express written consent of the owner is prohibited.