



1024 E Pike Street

SEATTLE, WASHINGTON

AC AYERS
COMMERCIAL
GROUP

THE PROPERTY ———

Capitol Hill Restaurant/Retail Space

\$1,700,000 | 2,350 Sq Ft | \$723/Sq Ft

Ayers Commercial Group is pleased to present the **rare opportunity** to purchase a **move-in ready restaurant and bar** commercial condo located along Pike Street **in the heart of Capitol Hill**. The property features a fully **built-out kitchen with a Type 1 hood** and a **turnkey bar setup**, allowing a new owner to step in and begin operations immediately. Boasts a **Walk Score of 100**, surrounded by some of Seattle's most popular restaurants, bars, and entertainment venues. **Opportunities like this in Capitol Hill are few and far between** — stop paying rent and own your space in one of Seattle's most dynamic and walkable neighborhoods.

PROPERTY SUMMARY

ADDRESS	1024 E Pike St Seattle, WA 98122
PARCEL NUMBER	556966-0010
SIZE (SF)	1,750 SF (Ground Level) 600 SF (Mezzanine)
CONDOMINIUM	Monique Lofts
YEAR BUILT	1913
ZONING	NC3P-75 (M)
JURISDICTION	City of Seattle

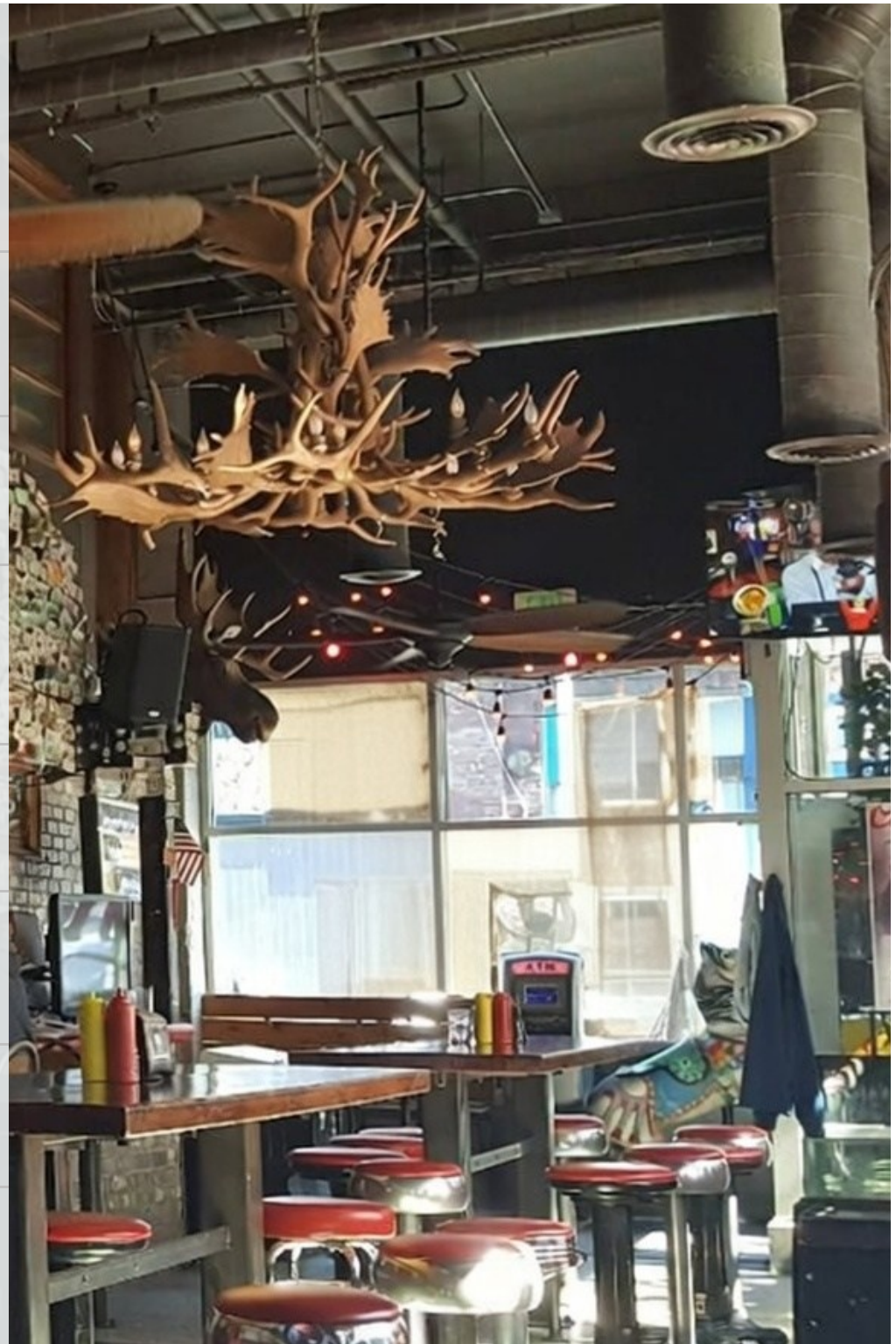

SCALE: 1/4" = 1'-0"

LEGEND

STA01	KITCHEN #1
STA02	KITCHEN #2
STA03	KITCHEN #3
STA04	POS & DISPLAY
STA05	BAR #1
STA06	BAR #2
STA07	SERVER
STA08	SELF-SERVE
STA09	BUS
STA10	DISHWASHING

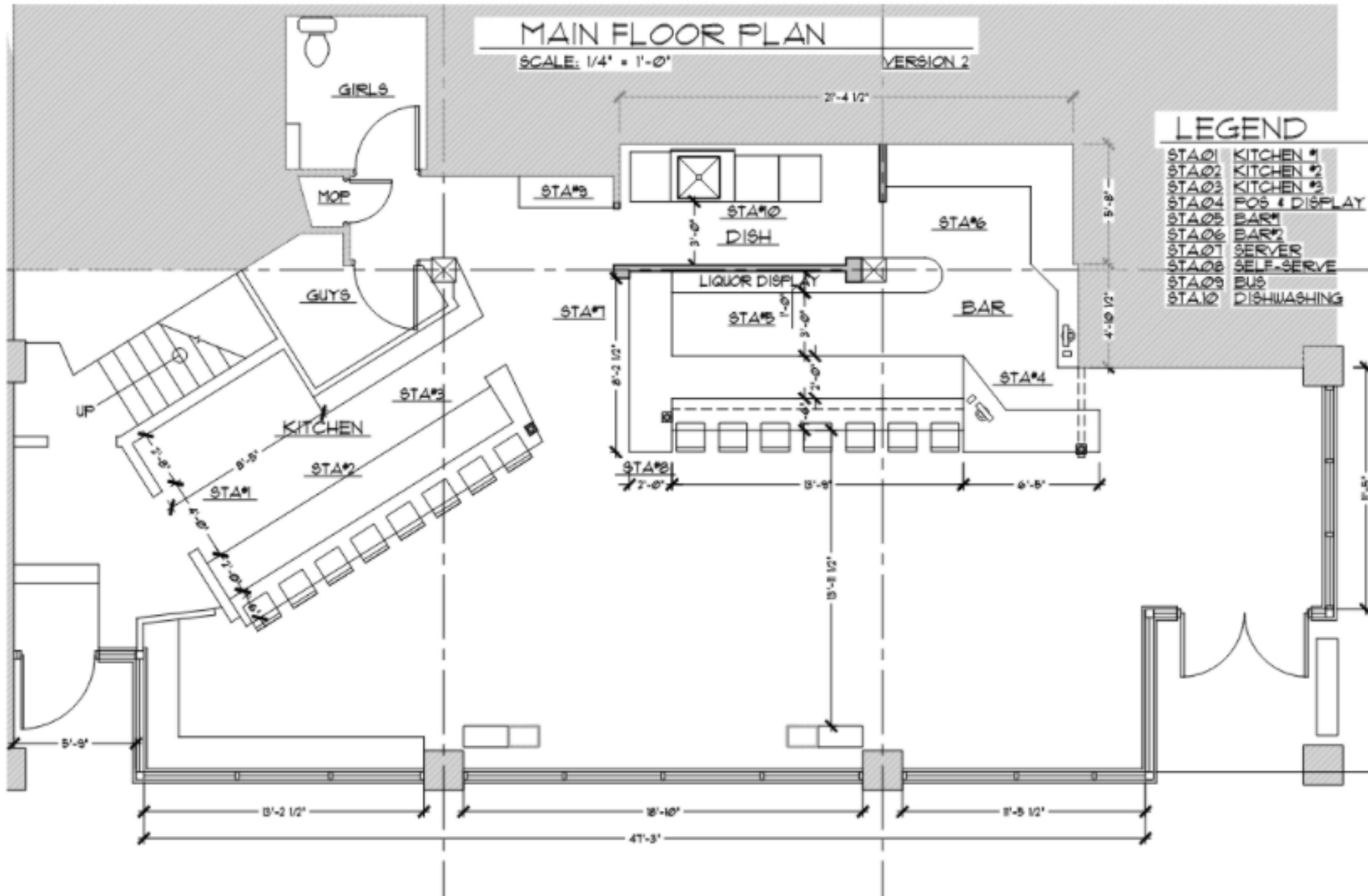

SEATTLE CENTRAL
COLLEGE

Cal Anderson Park

BLICK

Elliott Bay Book Company



SITE



SALT & STRAW

NEUMOS

CHOPHOUSE ROW

ELYSIAN
BREWING

SEATTLE
UNIVERSITY



JEFF AYERS
OWNER | DESIGNATED BROKER
425.275.2406
jeff@ayerscommercialgroup.com

COLE SOREANO
BROKER
206.683.6871
cole@ayerscommercialgroup.com