

A dark, monochromatic photograph of a modern multi-story office building with large windows. Overlaid on the left and bottom portions of the image is a topographic map with white contour lines and a prominent orange line. The orange line starts near the top left, winds down the side of the building, and continues across the bottom. Several small orange squares and a plus sign are also visible on the map overlay.

# EAST SUMMIT

2000 EDMUND HALLEY DRIVE  
RESTON, VA



**CBRE**



# PRIME LOCATION



DIRECT ACCESS TO DULLES INTERNATIONAL AIRPORT



ADJACENT TO THE RESTON TOWN CENTER METRO STATION



14-MINUTE WALK TO THE RESTON TOWN CENTER RETAIL & RESTAURANTS

EAST  
**SUMMIT**  
FULL FLOORS, READY-TO-GO



  
**Panera**  
BREAD  
*Wegmans*

  
RESTON  
TOWN  
CENTER



DIRECT STAIRWELL  
ACCESS TO METRO PLATFORM





CONTIGUOUS TO  
39,538 SF



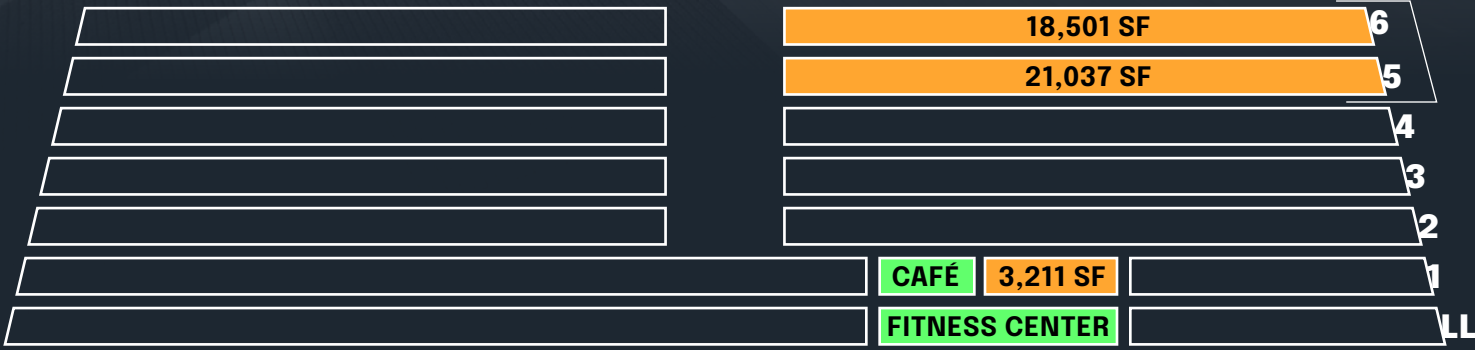

**WEST**  
**SUMMIT**  
2002 EDMUND HALLEY DRIVE

**EAST**  
**SUMMIT**  
2000 EDMUND HALLEY DRIVE



AVAILABLE NOW    AMENITY

# PREMIER ON-SITE AMENITIES

-  WELCOMING LOBBY ENTRANCE
-  FITNESS CENTER
-  ON-SITE CAFÉ
-  LUSH LANDSCAPING





# 1<sup>ST</sup> FLOOR

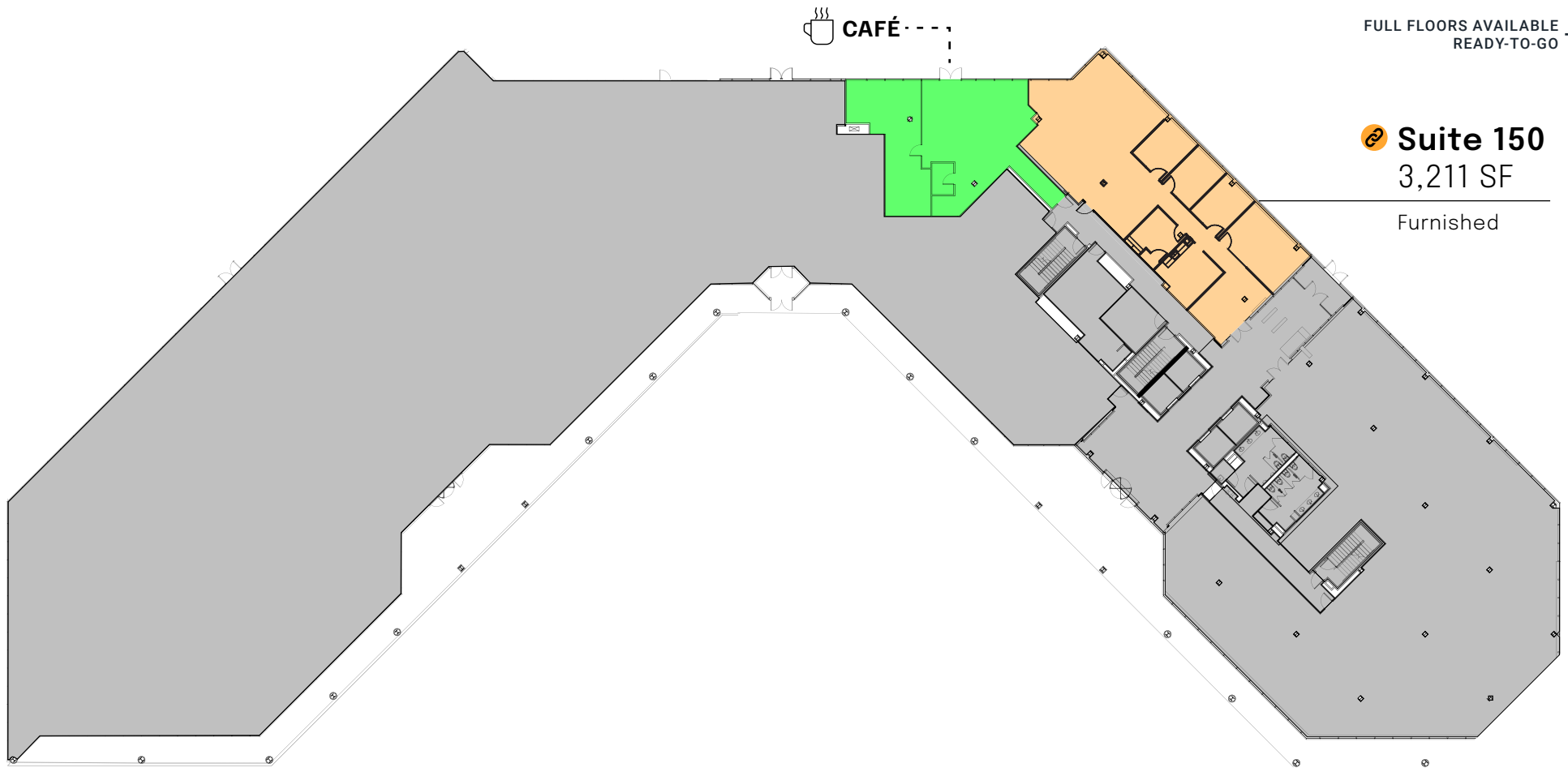

AVAILABLE NOW AMENITY INTERACTIVE

2000 EDMUND HALLEY DRIVE, RESTON, VA

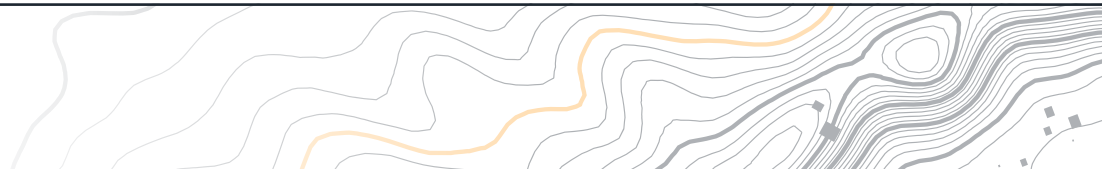



# 5<sup>TH</sup> FLOOR

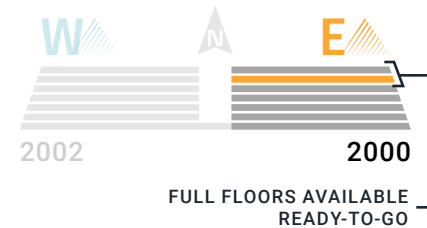

## Suite 500 21,037 SF

Contiguous to  
39,538 SF



PRIVATE BALCONY

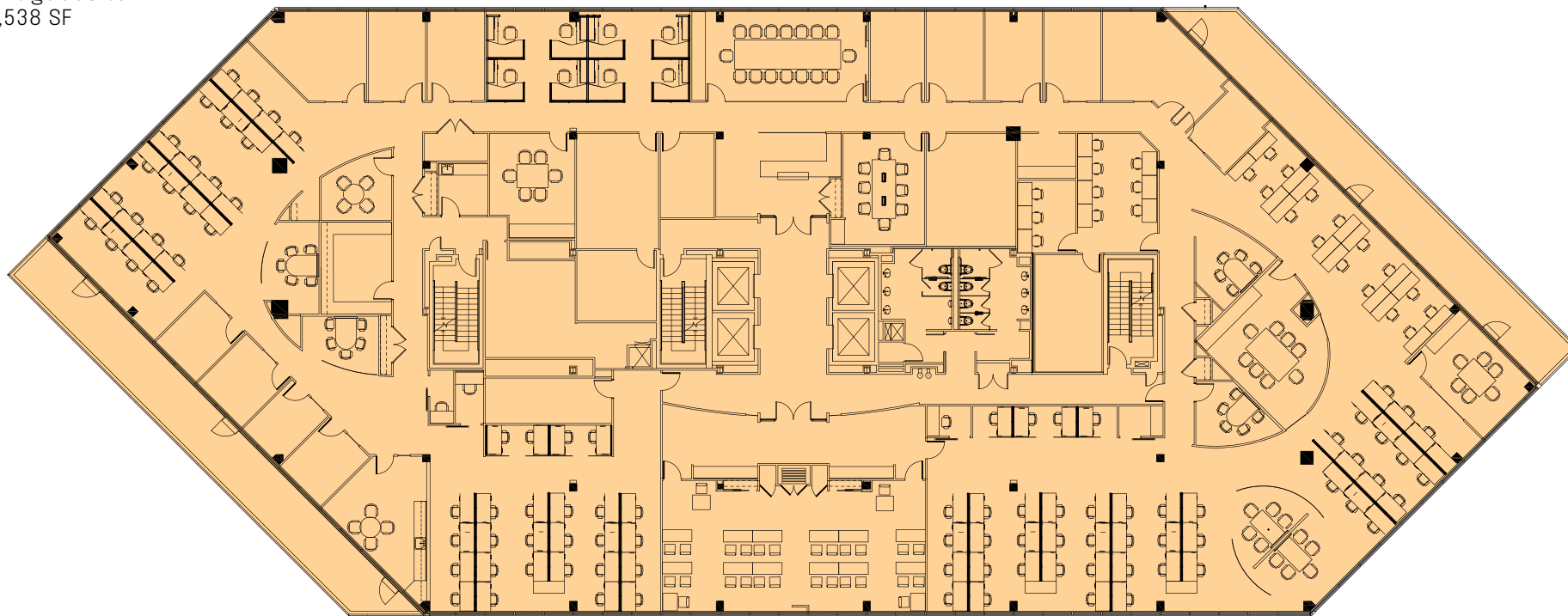

PRIVATE BALCONY

 AVAILABLE NOW  INTERACTIVE

2000 EDMUND HALLEY DRIVE, RESTON, VA

**SUMMIT** **EAST** 





# 6<sup>TH</sup> FLOOR

## Suite 600 18,501 SF

Contiguous to  
39,538 SF

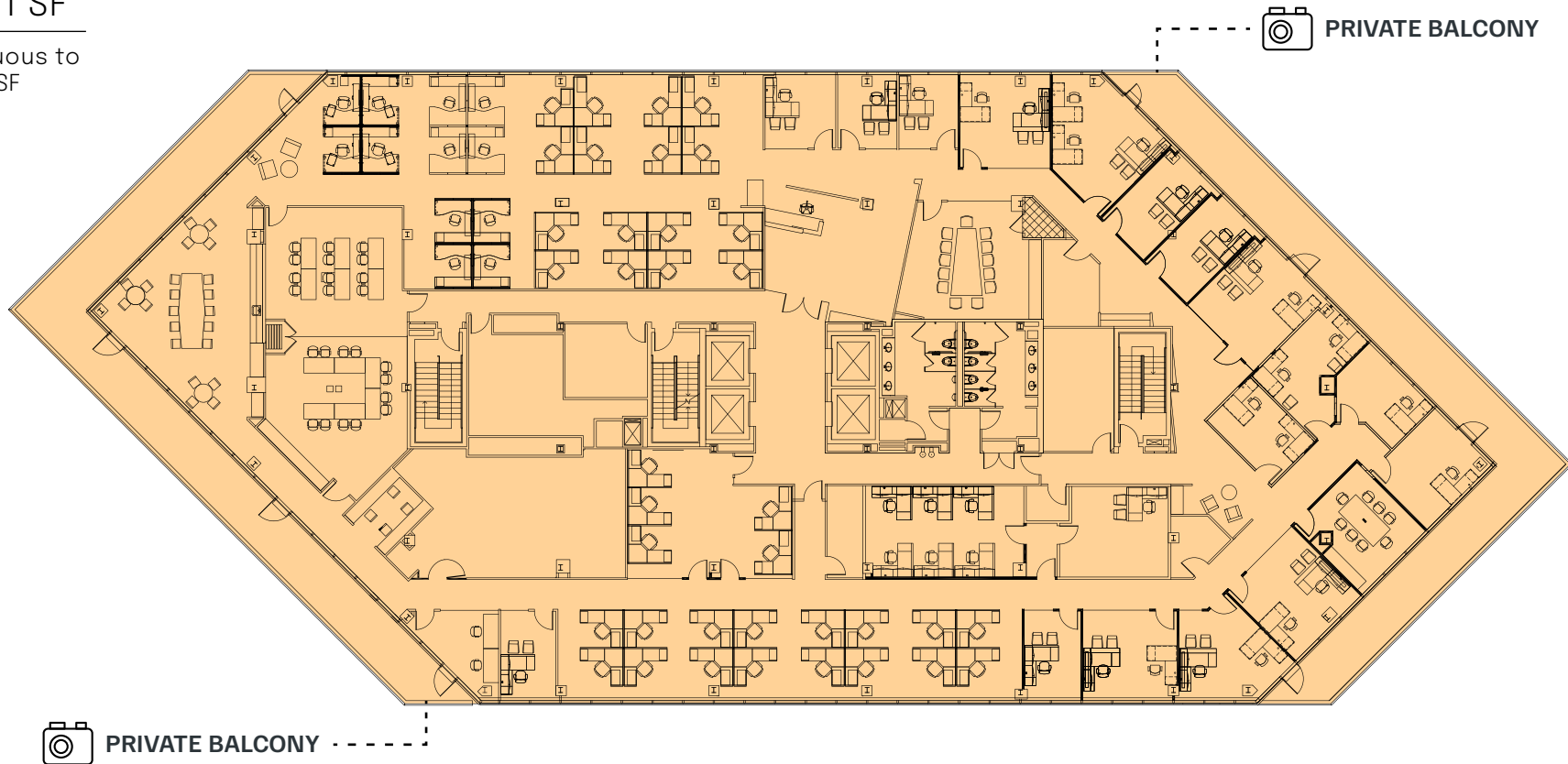

 AVAILABLE NOW  INTERACTIVE

2000 EDMUND HALLEY DRIVE, RESTON, VA

**SUMMIT** **EAST** 

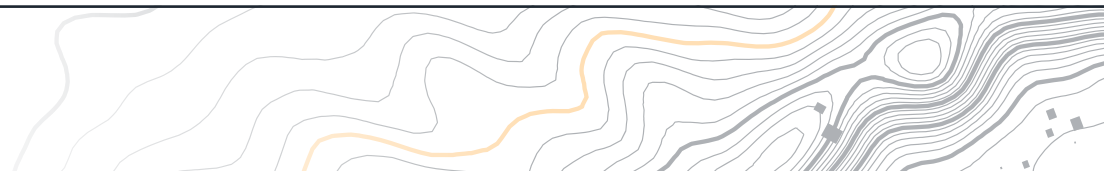





---

People First.<sup>®</sup> It's a simple philosophy we've stood by for over 70 years, and it drives us to go above and beyond every single day. We own and manage an investment portfolio of over 90 properties including 4.0 million square feet of commercial space and over 5,800 apartments in Washington DC, Maryland and Virginia, with care and considerate attention to our residents, tenants and communities. People First<sup>®</sup> is more than just a tagline. It's who we are.

## PEOPLE WITH A PURPOSE

It all started back in 1953 with Norman Bernstein. He was determined to build a real estate management company that puts people first. He believed integrity should be at the core of everything we do – and we're proud to say, seven decades later, it still is. As we evolve and grow, we'll continue to make good decisions that benefit our residents, employees, investors, brokers and communities. What's important to you is important to us: financial strength and stability, steadfast leadership, long-term investments in desirable locations, uncommon service and experiences. We're people who do our best to make your life more incredible.

---

[bmcproperties.com](http://bmcproperties.com)







# SUMMIT

2000 | 2002 EDMUND HALLEY DRIVE



**CBRE**

**Rosanne Richards**

+1 703 905 0207

[rosanne.richards@cbre.com](mailto:rosanne.richards@cbre.com)

**Terry Reiley**

+1 703 905 0236

[terry.reiley@cbre.com](mailto:terry.reiley@cbre.com)

**Brett Schweitzer**

+1 703 905 0253

[brett.schweitzer@cbre.com](mailto:brett.schweitzer@cbre.com)

**Quinn Reiley**

+1 703 905 0211

[quinn.reiley@cbre.com](mailto:quinn.reiley@cbre.com)

©2025 CBRE, Inc. All rights reserved. This information has been obtained from sources believed reliable, but has not been verified for accuracy or completeness. You should conduct a careful, independent investigation of the property and verify all information. Any reliance on this information is solely at your own risk. Photos herein are the property of their respective owners. Use of these images without the express written consent of the owner is prohibited. CBRE and the CBRE logo are service marks of CBRE, Inc. All other marks displayed on this document are the property of their respective owners.