

RIVERSIDE @ 51ST AVE

PHOENIX

2300 South 51st Ave
Phoenix, Arizona



FOR LEASE

±122,321 SF

SUITE 115 & 120



LEASED BY



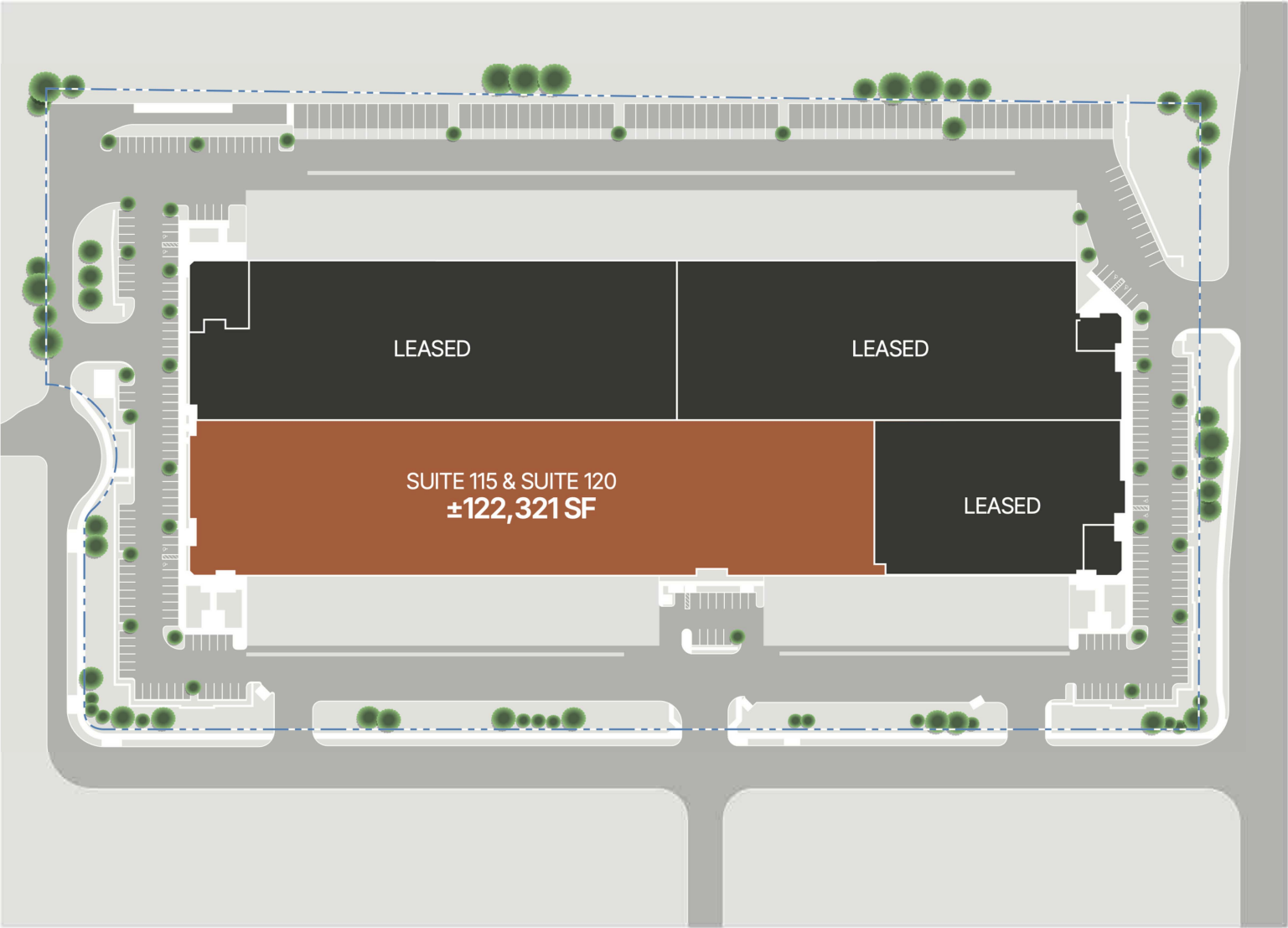

BUILDING FEATURES

Clear Height	30'
Grade Level Doors	3
Dock Doors	30
Truck Court	135'
Column Spacing	56' X 56'
Cooling	EVAP Cooled Warehouse
Sprinklers	ESFR

DIVISIBILITY OPTIONS

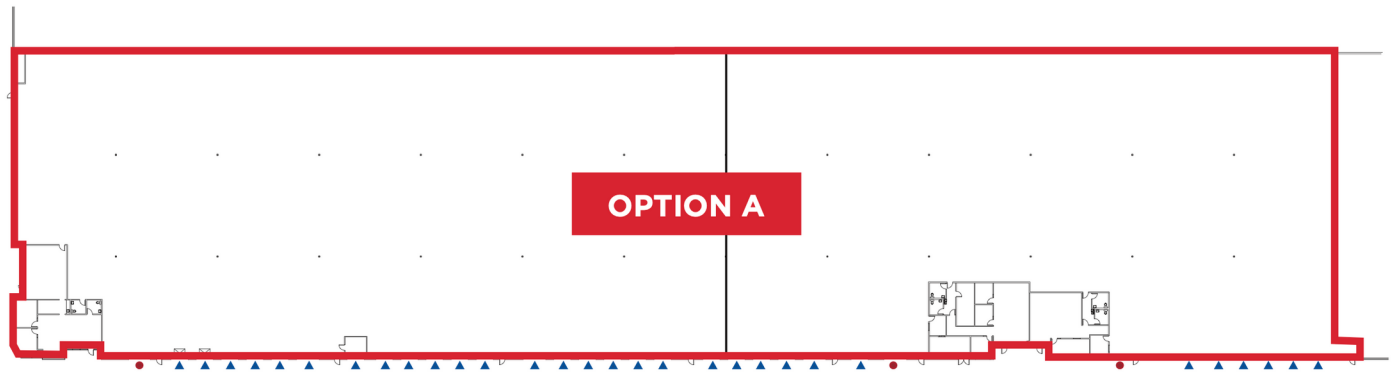

SUITE 115 ±63,131 SF

Office	±2,105 SF
Dock Doors	19
Grade Level	1

SUITE 120 ±52,379 SF

Office	±3,653 SF
Dock Doors	11
Grade Level	2

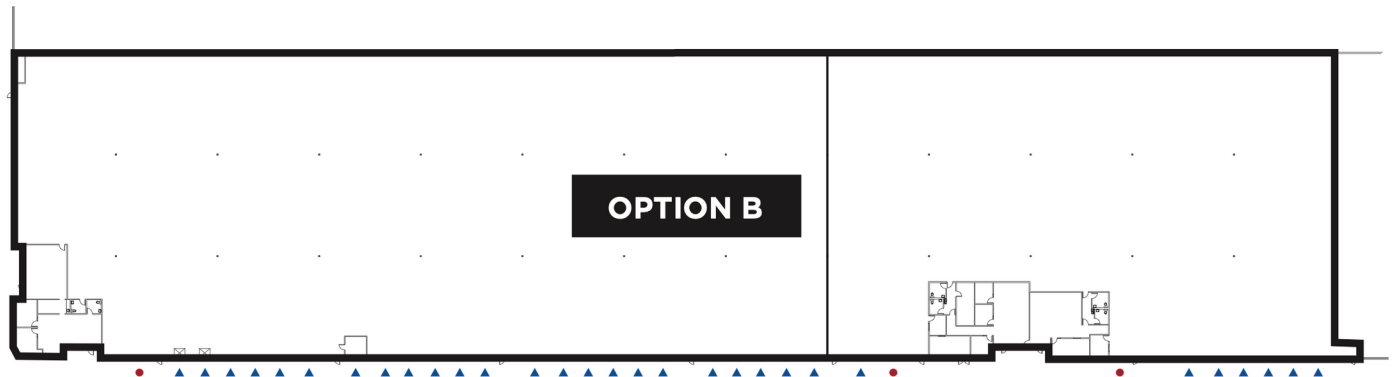

SUITE 115 ±72,520 SF

Office	±2,105 SF
Dock Doors	23
Grade Level	1

SUITE 120 ±42,990 SF

Office	±3,653 SF
Dock Doors	7
Grade Level	2

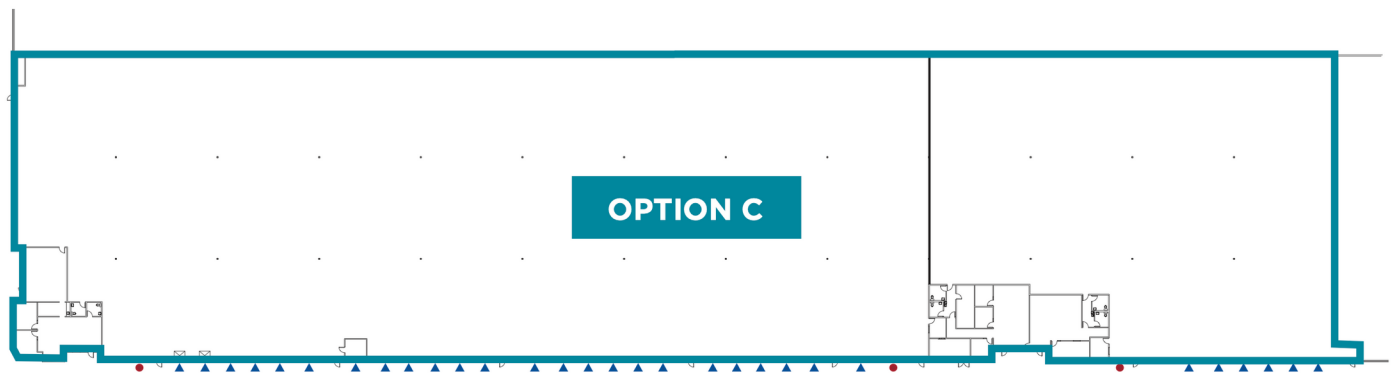

SUITE 115 ±81,909 SF

Office	±2,105 SF
Dock Doors	24
Grade Level	2

SUITE 120 ±33,629 SF

Office	±3,653 SF
Dock Doors	6
Grade Level	1

Committed to Driving Value for Our Customers

Properties with a Competitive Edge

Our scale, proprietary data and local relationships allow our 1,200+ skilled team members to help customers stay ahead of market trends.

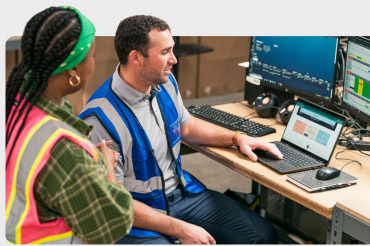
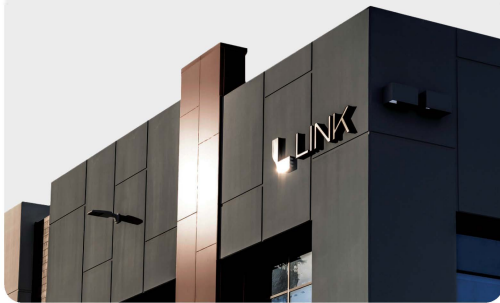

Best-in-Class Customer Service

Our on-the-ground regional teams provide you with local expertise, leveraging data-driven insights to find the right solutions for your business.

Link+

Our digital customer experience platform provides easy access to your property management teams, lease documents, billing and service requests. Sign up today!

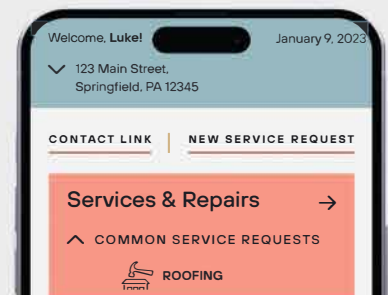

500 Million
Square Foot
Portfolio

Energy Solutions

Our comprehensive energy and utility management program enables customers to achieve savings and access our in-house sustainability experts. Enroll through Link+.



CONTACT INFORMATION

2300 South 51st Ave
Phoenix, Arizona

Phil Haenel

Phil.haenel@cushwake.com
(602) 224-4409

Andy Markham

Andy.markham@cushwake.com
(602) 224-4408

Mike Haenel

Mike.haenel@cushwake.com
(602) 224-4404

Justin Smith

Justin.p.smith@cushwake.com
(602) 586-5938

This is not an offer or acceptance of an offer to lease space. A lease will only be offered or made in a written agreement signed by landlord. No representation or warranty of any kind is made by landlord unless set forth in a written definitive lease executed by the landlord.



LEASED BY

