

7050

JOMAR DRIVE

WHITMORE LAKE, MI



**FOR SALE or
LEASE**

19,128 SF

 **CUSHMAN &
WAKEFIELD**

// PROPERTY DETAILS

Total Square Footage	19,128 SF
Total Land Acreage	5.31 acres
Use	Office/Flex/Lab
Building Class	B
Stories	1
Year Built	2001
Parking	88 surface spaces
Construction	Masonry
Zoning	RTM: Research/technology/manufacturing
Parcel ID	02-20-100-021
Taxes	\$44,639.77 (2024)
SEV	\$999,600
Water/Sewer	Municipal Sewer / Well
Lease Rate:	Contact Broker
Asking Price:	\$1,850,000



MISCELLANEOUS

- Includes private offices and cubicle spaces
- Serene, private atmosphere
- Private offices and open cubicle space
- Large kitchen and breakroom
- Exposed, tall ceilings
- Availability to add overhead door on north end of facility and create approximately 8,000 SF of warehouse space



7050 Jomar Drive
Whitmore Lake, MI 48189

// FLOOR PLAN

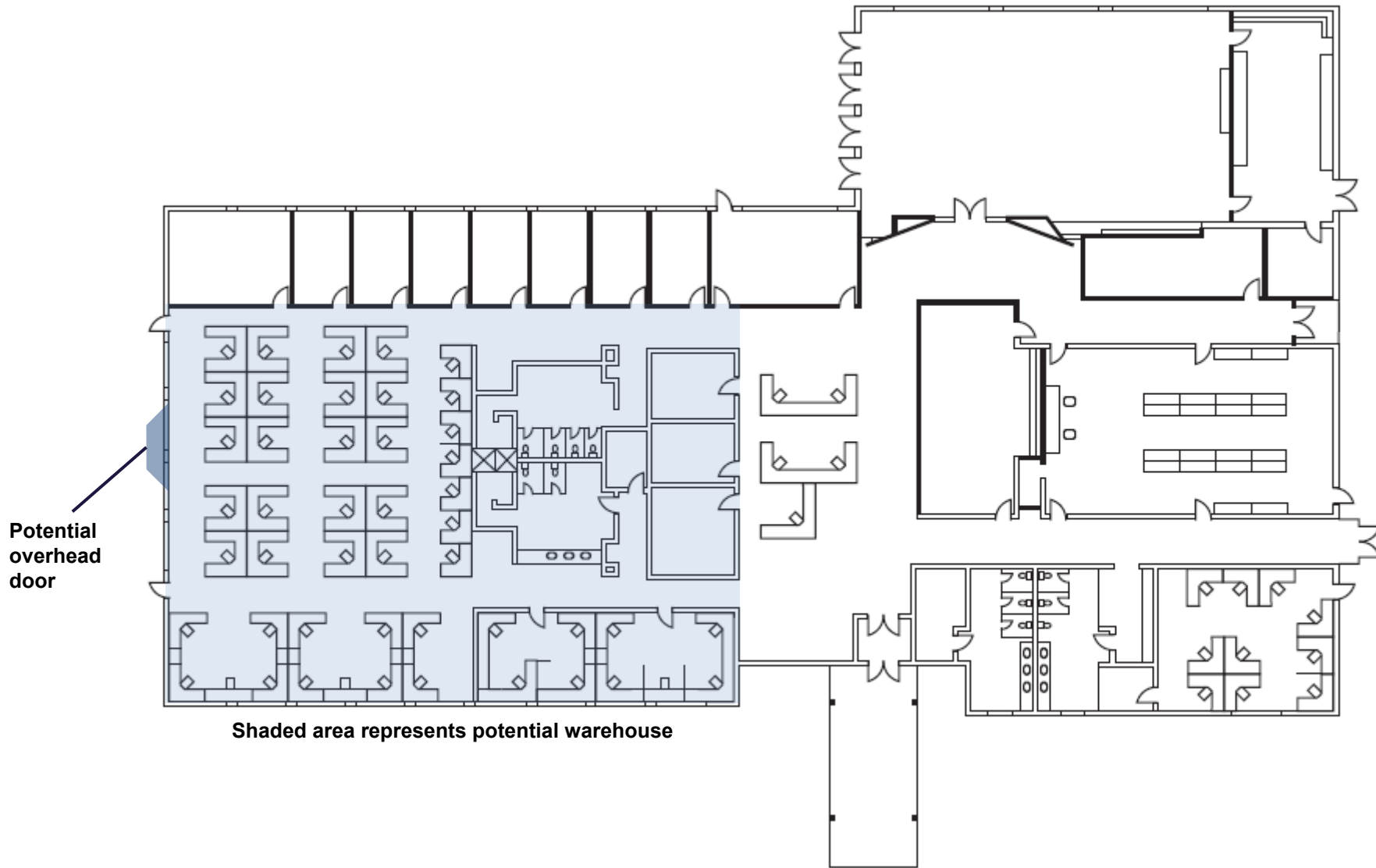

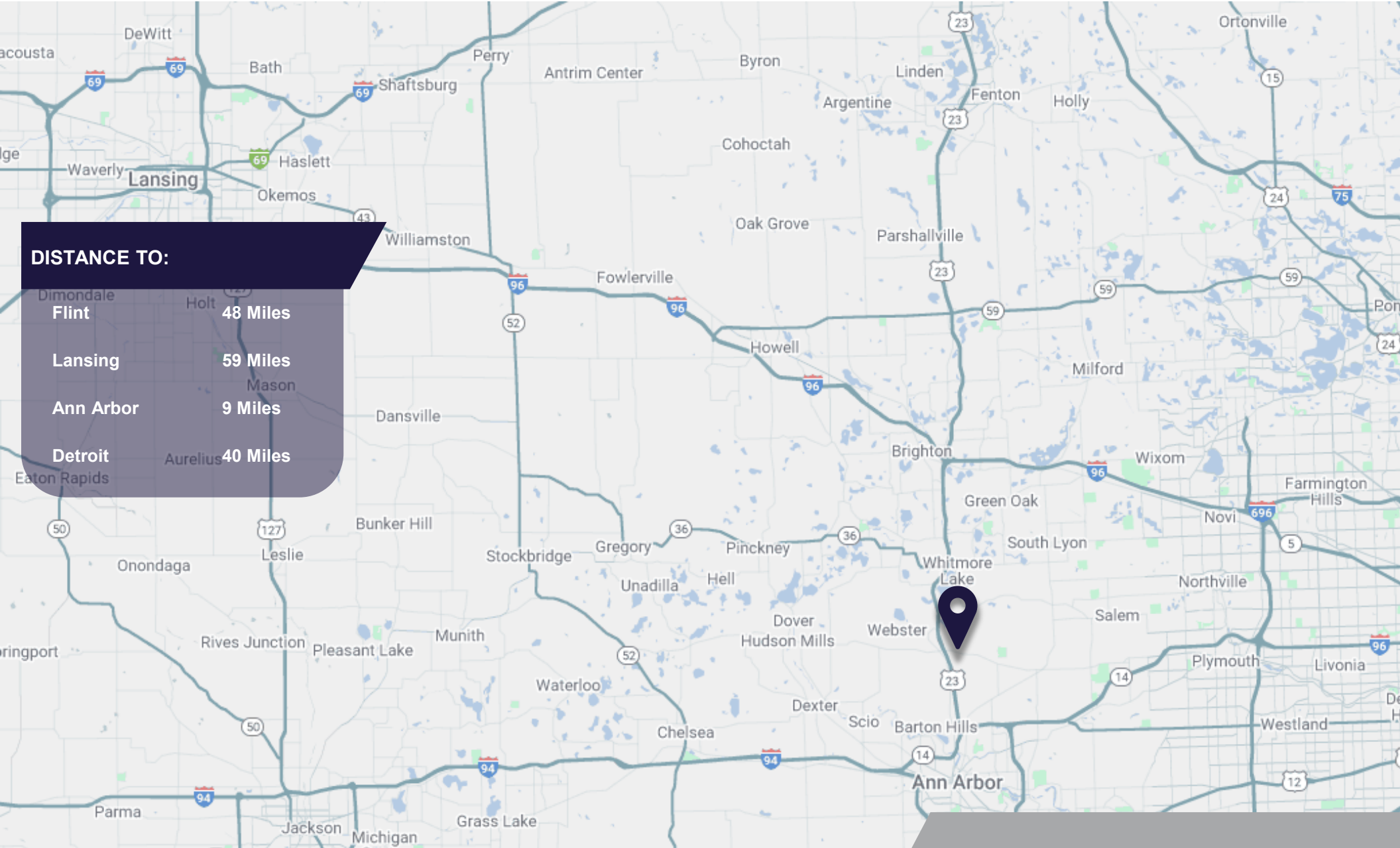

// PHOTOS



7050

JOMAR DRIVE

WHITMORE LAKE, MI



// CONTACT

KYLE PASSAGE
Senior Associate
+1 248 358 6113
kyle.passage@cushwake.com

STEVE KOZAK
Director
+1 248 358 6107
steve.kozak@cushwake.com



©2025 Cushman & Wakefield. All rights reserved. The material in this presentation has been prepared solely for information purposes and is strictly confidential. Any disclosure, use, copying or circulation of this presentation (or the information contained within it) is strictly prohibited, unless you have obtained Cushman & Wakefield's prior written consent. The views expressed in this presentation are the views of the author and do not necessarily reflect the views of Cushman & Wakefield. Neither this presentation nor any part of it shall form the basis of, or be relied upon in connection with any offer, or act as an inducement to enter into any contract or commitment whatsoever. NO REPRESENTATION OR WARRANTY IS GIVEN, EXPRESS OR IMPLIED, AS TO THE ACCURACY OF THE INFORMATION CONTAINED WITHIN THIS PRESENTATION, AND CUSHMAN & WAKEFIELD IS UNDER NO OBLIGATION TO SUBSEQUENTLY CORRECT IT IN THE EVENT OF ERRORS.