



SAURAGE ROTENBERG
COMMERCIAL REAL ESTATE

MIKE STINSON, CCIM

TEL: 225 448-2919
MOBILE: 225 907-7793
EMAIL: MIKE@SR-CRE.COM



FOR LEASE

**9230 FLORIDA BOULEVARD
BATON ROUGE, LA 70815**

\$12/SQ.FT.

2,625 SQ.FT.

HIGHLIGHTS

- Former Health Club for Lease
- **STE D & E** 2,625 SF \$12 PSF NNN
- Total Turn Key Space
- Equipment includes, but is not limited to: leg presses, barbells, squat rack, exercise bikes, some free weights, and mini trampolines
- Rubber Floor
- Mirrors on Walls
- Front Office, Retail Counter
- Locker Rooms & Rest Rooms
- Centrally Located near Florida Blvd. & Arline Hwy. intersection
- Potential Low Cost Opportunity to enter the Health Industry!

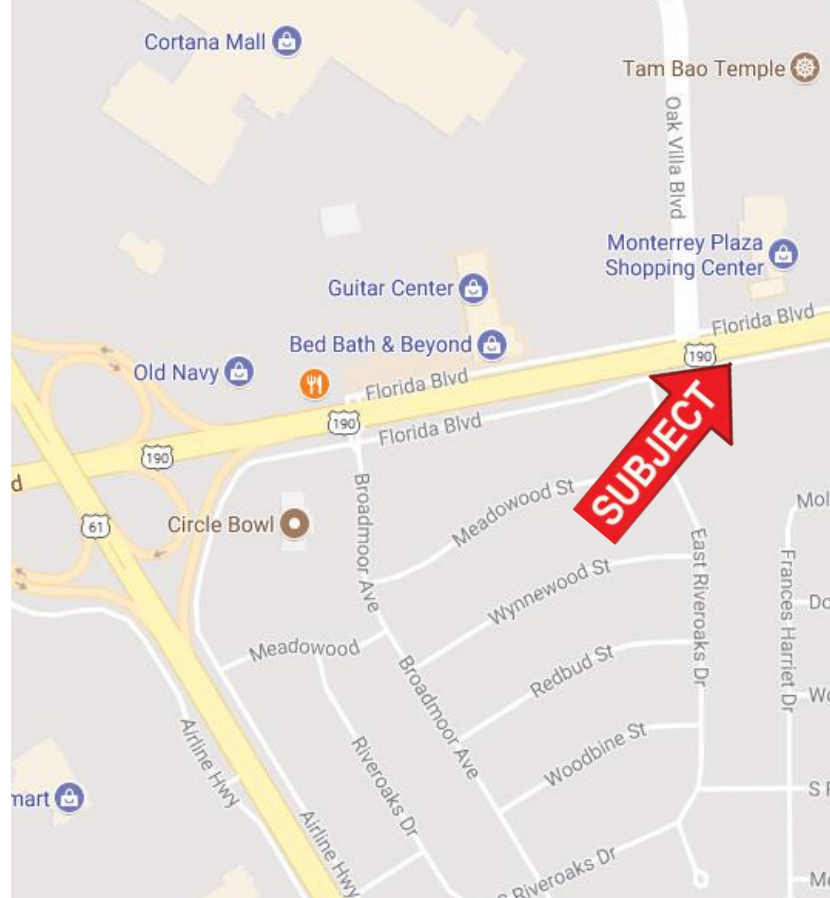

SAURAGE ROTENBERG COMMERCIAL REAL ESTATE, LLC
5135 BLUEBONNET BLVD
BATON ROUGE, LA 70809

TEL 225 766-0000
FAX 225 766-2229

WEB SAURAGEROTENBERG.COM

The information contained herein has either been given to us by property owners or is from sources deemed reliable and is believed to be correct, it is not in any way warranted or guaranteed by Saurage Rotenberg Commercial Real Estate. This information is submitted subject to errors, omissions, changes in price, rental or other conditions, withdrawal without notice, and to any special listing conditions imposed by the principals. Licensed in Louisiana.



SAURAGE ROTENBERG
COMMERCIAL REAL ESTATE

MIKE STINSON, CCIM

TEL: 225 448-2919

MOBILE: 225 907-7793

EMAIL: MIKE@SR-CRE.COM



SAURAGE ROTENBERG COMMERCIAL REAL ESTATE, LLC
5135 BLUEBONNET BLVD
BATON ROUGE, LA 70809

TEL 225 766-0000
FAX 225 766-2229

WEB SAURAGEROTENBERG.COM

The information contained herein has either been given to us by property owners or is from sources deemed reliable and is believed to be correct, it is not in any way warranted or guaranteed by Saurage Rotenberg Commercial Real Estate. This information is submitted subject to errors, omissions, changes in price, rental or other conditions, withdrawal without notice, and to any special listing conditions imposed by the principals. Licensed in Louisiana.



SAURAGE ROTENBERG
COMMERCIAL REAL ESTATE

MIKE STINSON, CCIM

TEL: 225 448-2919

MOBILE: 225 907-7793

EMAIL: MIKE@SR-CRE.COM



SAURAGE ROTENBERG COMMERCIAL REAL ESTATE, LLC
5135 BLUEBONNET BLVD
BATON ROUGE, LA 70809

TEL 225 766-0000
FAX 225 766-2229

WEB SAURAGEROTENBERG.COM

The information contained herein has either been given to us by property owners or is from sources deemed reliable and is believed to be correct, it is not in any way warranted or guaranteed by Saurage Rotenberg Commercial Real Estate. This information is submitted subject to errors, omissions, changes in price, rental or other conditions, withdrawal without notice, and to any special listing conditions imposed by the principals. Licensed in Louisiana.



FLORIDA BOULEVARD

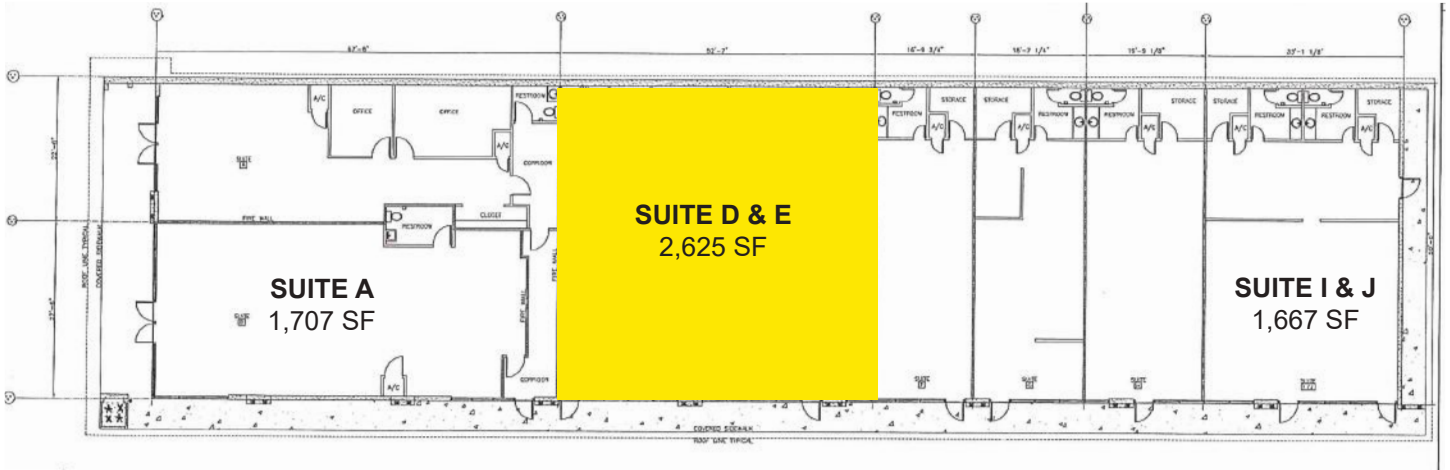

PARKING

PARKING





SAURAGE ROTENBERG
COMMERCIAL REAL ESTATE

MIKE STINSON, CCIM

TEL: 225 448-2919
MOBILE: 225 907-7793
EMAIL: MIKE@SR-CRE.COM



SAURAGE ROTENBERG COMMERCIAL REAL ESTATE, LLC
5135 BLUEBONNET BLVD
BATON ROUGE, LA 70809

TEL 225 766-0000
FAX 225 766-2229

WEB SAURAGEROTENBERG.COM

The information contained herein has either been given to us by property owners or is from sources deemed reliable and is believed to be correct, it is not in any way warranted or guaranteed by Saurage Rotenberg Commercial Real Estate. This information is submitted subject to errors, omissions, changes in price, rental or other conditions, withdrawal without notice, and to any special listing conditions imposed by the principals. Licensed in Louisiana.