

MIXED-USE PROPERTY FOR SALE



# 830 CUMBERLAND HILL ROAD

Woonsocket, RI 02895

**JULIE FRESHMAN, SIOR**  
Vice President  
401.751.3200 x3309  
julie@mgcommercial.com

**GEORGE PASKALIS, SIOR**  
Partner  
401.751.3200 x3303  
george@mgcommercial.com

**MG COMMERCIAL**  
365 Eddy Street, Penthouse Suite  
Providence, RI 02903  
401.751.3200 | mgcommercial.com

# PROPERTY SUMMARY



## PROPERTY DESCRIPTION

830 Cumberland Hill Road consists of three (3) parcels totaling 2.27 acres (Plat Map 42 / Lots 461, 469 and 483). Three (3) structures are located on Lot 483 consisting of a 4,714 SF building (store-front) along Cumberland Hill Road and two (2) buildings (warehouse) towards the back of the property totaling 8,440 SF. Lot 469 contains a covered canopy-type structure totaling approximately 6,000 SF. Lot 461 contains a paved parking area.

## LOCATION DESCRIPTION

830 Cumberland Hill Road in Woonsocket is well-located just to the west of the established business park setting known as the Highland Corporate Park in Woonsocket, Rhode Island. With frontage along well-traveled Cumberland Hill Road (Route 122), the property is highly visible with immediate access to Route 146 and I-295, and is approximately 15 minutes to I-495 and I-95 in Massachusetts.

## OFFERING SUMMARY

Sale Price:	\$1,900,000
Lot Size:	2.27 Acres
Total Building/Structure SF:	19,154 SF

## PROPERTY HIGHLIGHTS

- Three (3) Buildings Totaling 13,154 SF
- Covered Canopy Structure - 6,000 SF
- 2.27 Acres of Land
- Paved Parking/Exterior Storage Areas
- On-Site Expansion Potential
- High Visibility Location
- Close Proximity to Routes 99/146/295

**JULIE FRESHMAN, SIOR**  
Vice President  
401.751.3200 x3309  
julie@mgcommercial.com

**GEORGE PASKALIS, SIOR**  
Partner  
401.751.3200 x3303  
george@mgcommercial.com

365 Eddy Street, Penthouse Suite  
Providence, RI 02903  
mgcommercial.com



# ADDITIONAL PHOTOS & PARCEL MAP

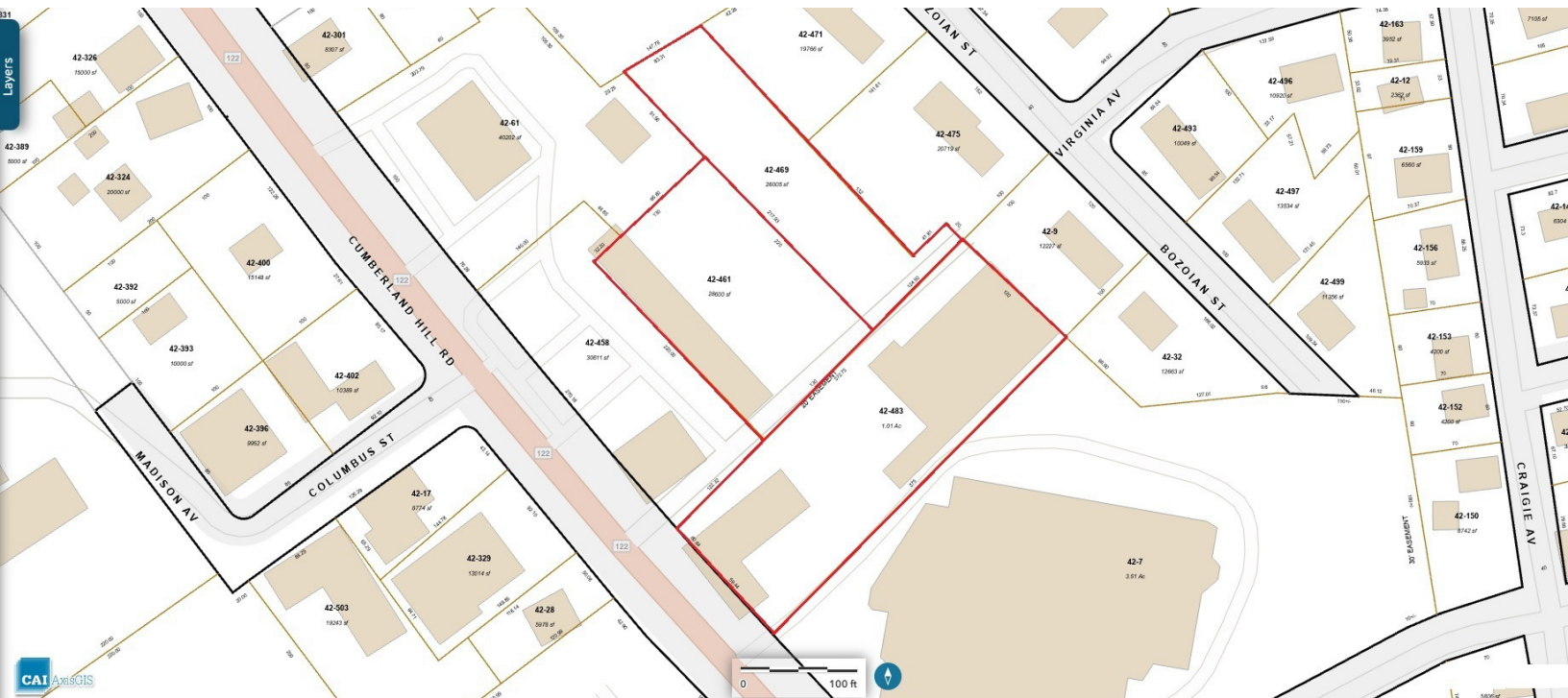

**JULIE FRESHMAN, SIOR**  
 Vice President  
 401.751.3200 x3309  
 julie@mgcommercial.com

**GEORGE PASKALIS, SIOR**  
 Partner  
 401.751.3200 x3303  
 george@mgcommercial.com

365 Eddy Street, Penthouse Suite  
 Providence, RI 02903  
 mgcommercial.com



# LOCATION MAP

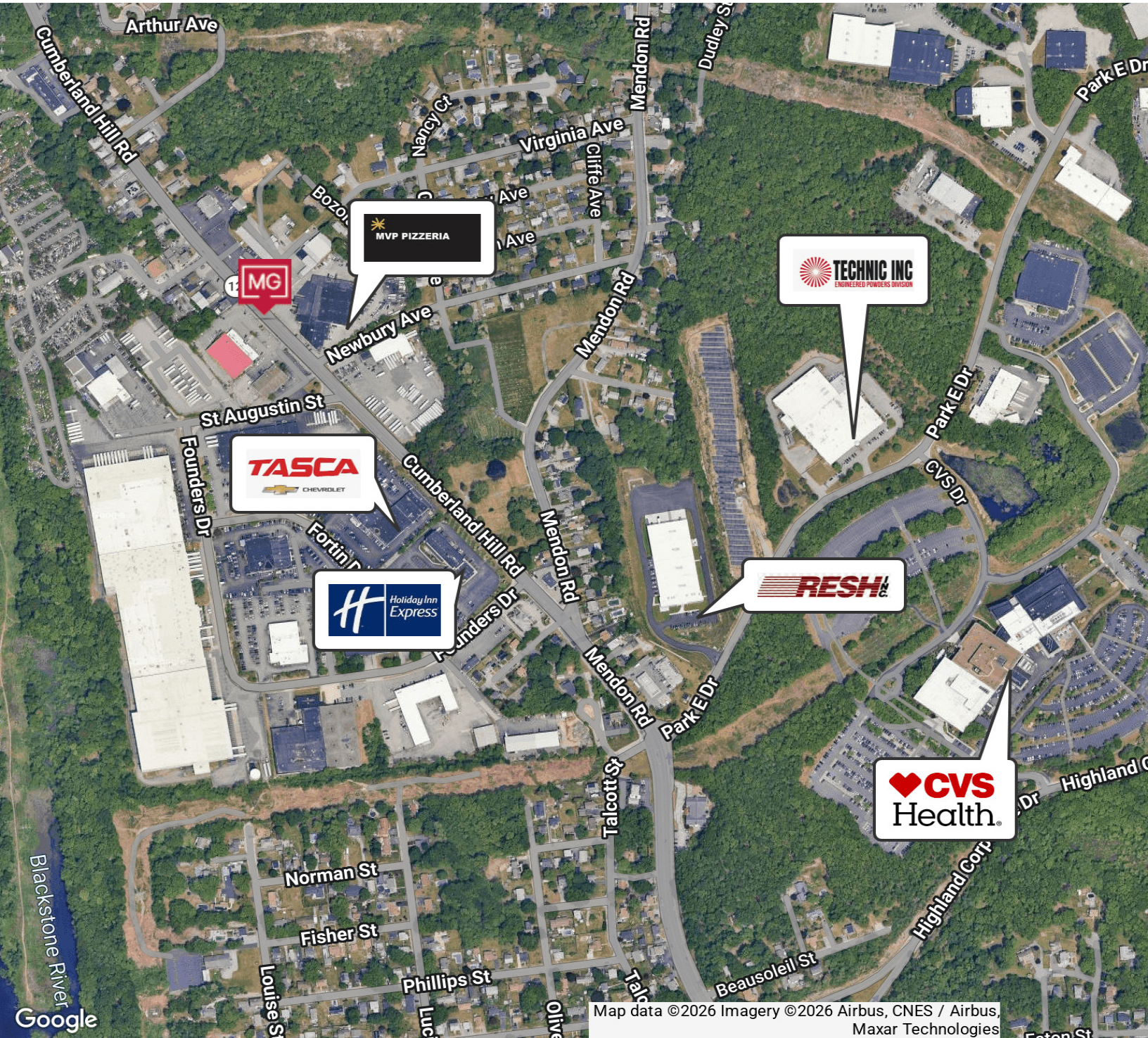

Map data ©2026 Imagery ©2026 Airbus, CNES / Airbus, Maxar Technologies

**JULIE FRESHMAN, SIOR**  
 Vice President  
 401.751.3200 x3309  
 julie@mgcommercial.com

**GEORGE PASKALIS, SIOR**  
 Partner  
 401.751.3200 x3303  
 george@mgcommercial.com

365 Eddy Street, Penthouse Suite  
 Providence, RI 02903  
 mgcommercial.com

