



# CenterPoint Harbor

2711 S Harbor Blvd, Santa Ana, CA

S Harbor Blvd



±11,700 SF LARGE FENCED  
& SECURED YARD AREA



CBRE

**FOR LEASE**  
**±34,513 SF AVAILABLE**



# Building & Location Specifications\*

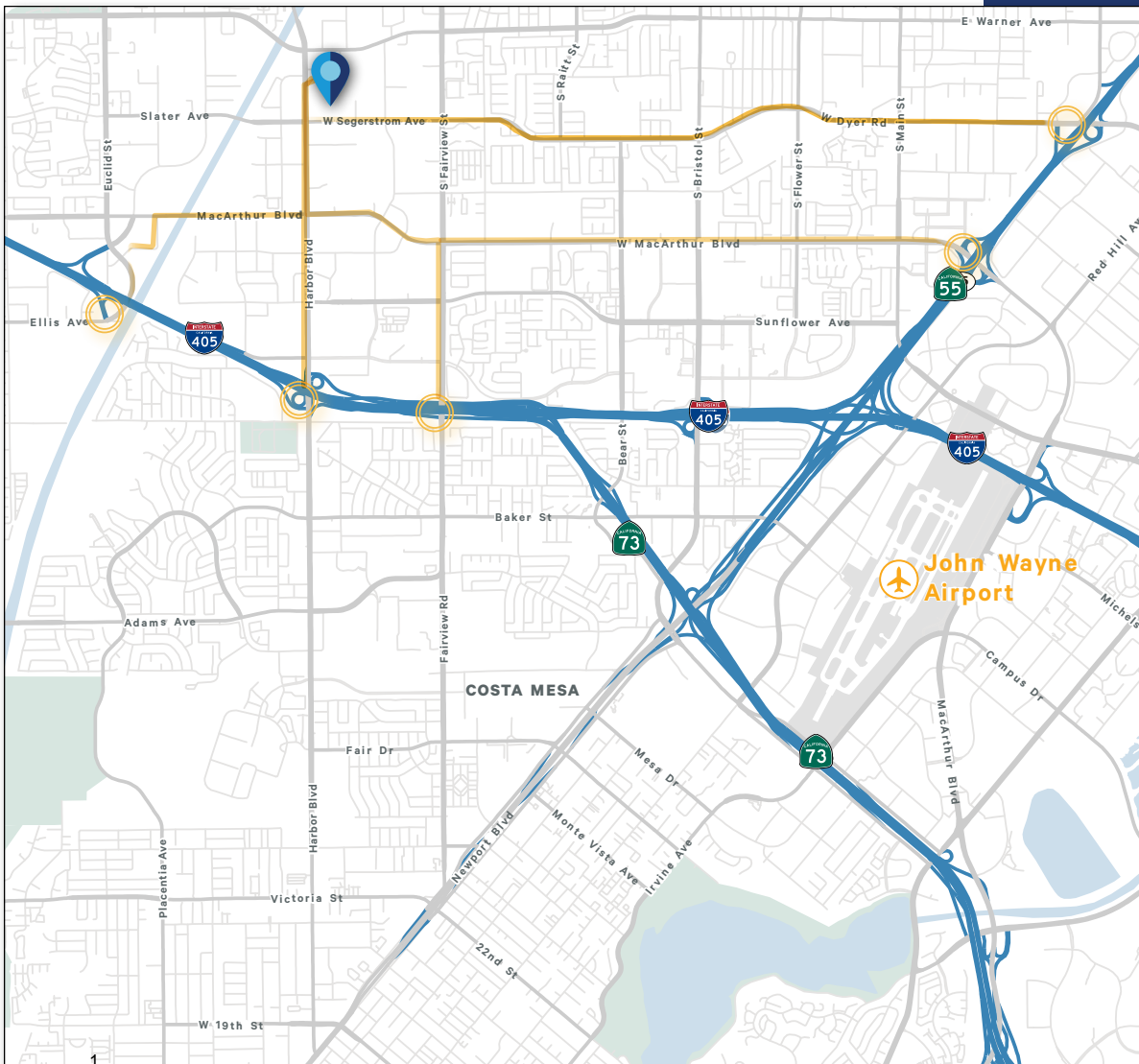

## PROPERTY FEATURES

**±34,513 SF Available**

Freestanding Building

±290 SF Office Area - Recently Renovated

Seven (7) Grade-Level Doors

±16.5' Warehouse Clear Height

800 Amps Power (verify)

±48 Parking Spaces

Ordinary Hazard Fire Sprinklers

LED Motion Sensor Lighting

Clear Span Building

## PROJECT HIGHLIGHTS

±11,700 SF Large Fenced & Secured Yard Area

Three Points of Ingress / Egress

Excellent South Coast Metro Location

Close Proximity to John Wayne Airport & 55, 22 & 405 Freeways

\*Tenant to verify all information

# Site Plan<sup>\*</sup>

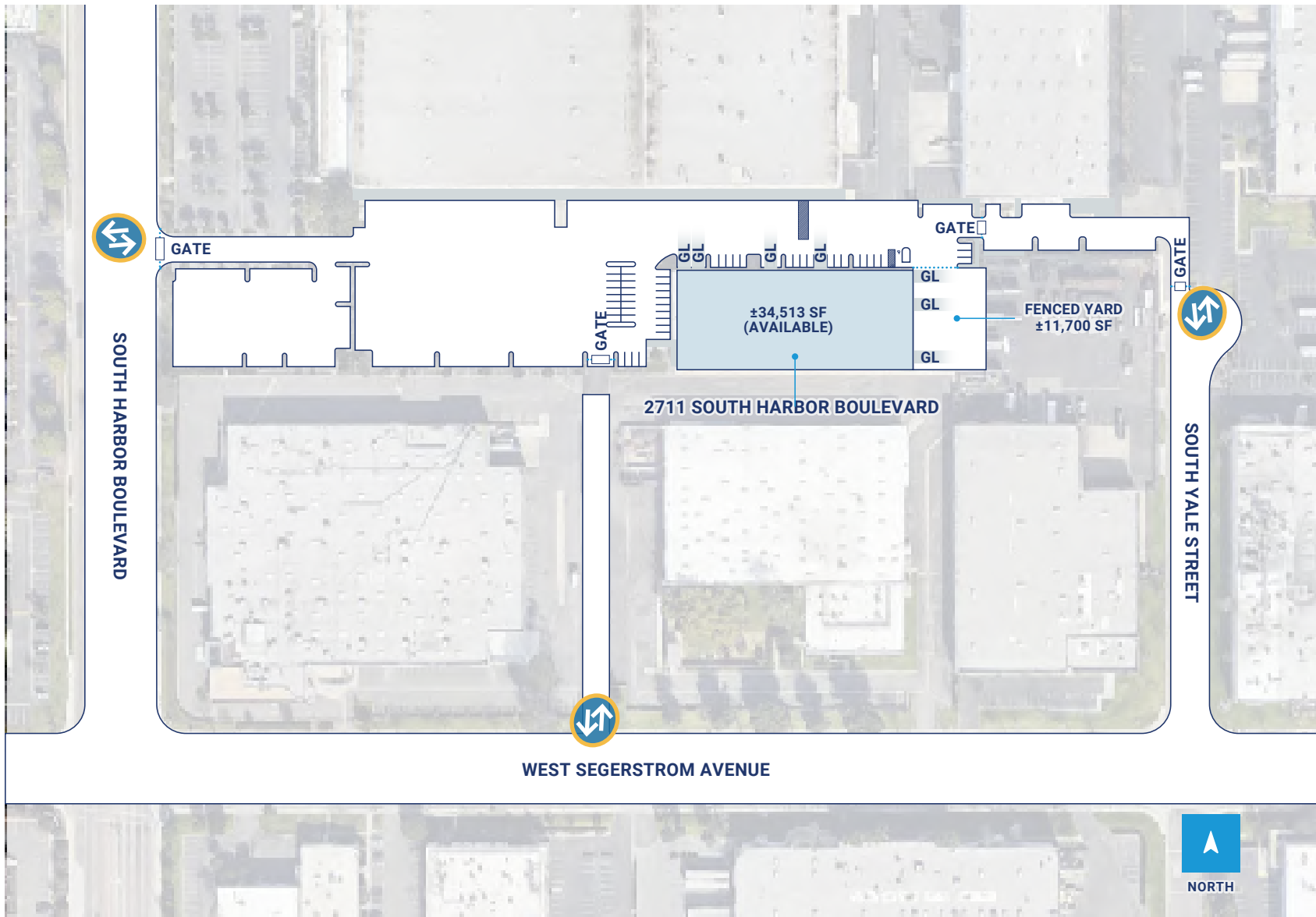

# Floor Plan

2711 S Harbor Blvd

## LEGEND

- ▶ GRADE-LEVEL DOOR
- SUBJECT PREMISES

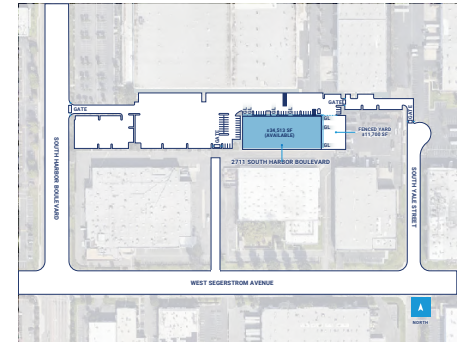

±290 SF Office

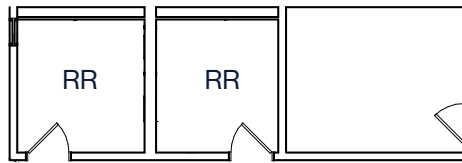









# CenterPoint Harbor

2711 S Harbor Blvd, Santa Ana, CA

## Ben Seybold

Executive Vice President

+1 714 371 9233

ben.seybold@cbre.com

Lic. 01081310

## Sean Ward

Executive Vice President

+1 714 371 9222

sean.ward@cbre.com

Lic. 01415499

## Nick Spatafore

Senior Vice President

+1 949 725 8657

nick.spatafore@cbre.com

Lic. 01353378



CenterPoint

CBRE

© 2024 CBRE, Inc. All rights reserved. This information has been obtained from sources believed reliable but has not been verified for accuracy or completeness. CBRE, Inc. makes no guarantee, representation or warranty and accepts no responsibility or liability as to the accuracy, completeness, or reliability of the information contained herein. You should conduct a careful, independent investigation of the property and verify all information. Any reliance on this information is solely at your own risk. CBRE and the CBRE logo are service marks of CBRE, Inc. All other marks displayed on this document are the property of their respective owners, and the use of such marks does not imply any affiliation with or endorsement of CBRE. Photos herein are the property of their respective owners. Use of these images without the express written consent of the owner is prohibited.