

retail/office FOR LEASE



GREAT BRIDGE COMMONS | 520-524 S. Battlefied Blvd., Chesapeake, Virginia

PROPERTY FEATURES:

- **±1,200 - 3,835 sq. ft. available!** Join **Vino Italian + Bistro, Vogue Lashes & Spa, Sharkey's Cuts & Ryan Bolan Dentistry** at a new 2 acre development located at the corner of South Battlefield Blvd. & Allen Drive; Allen Drive is connected to Johnstown Road!
- **Adjacent to Great Bridge Marketplace, key tenants include:** Butcher's Son Chop House, 3 Amigos Mexican Restaurant
- **Highly sought after trade area** with high average HH income
- **Less than one mile to 168 bypass, main highway to OBX**

DEMOGRAPHICS	1 MILE	3 MILES	5 MILES
Est. Population	9,777	60,571	107,312
Avg HH Income	\$108,359	\$118,457	\$112,961
Households	3,480	20,875	38,227

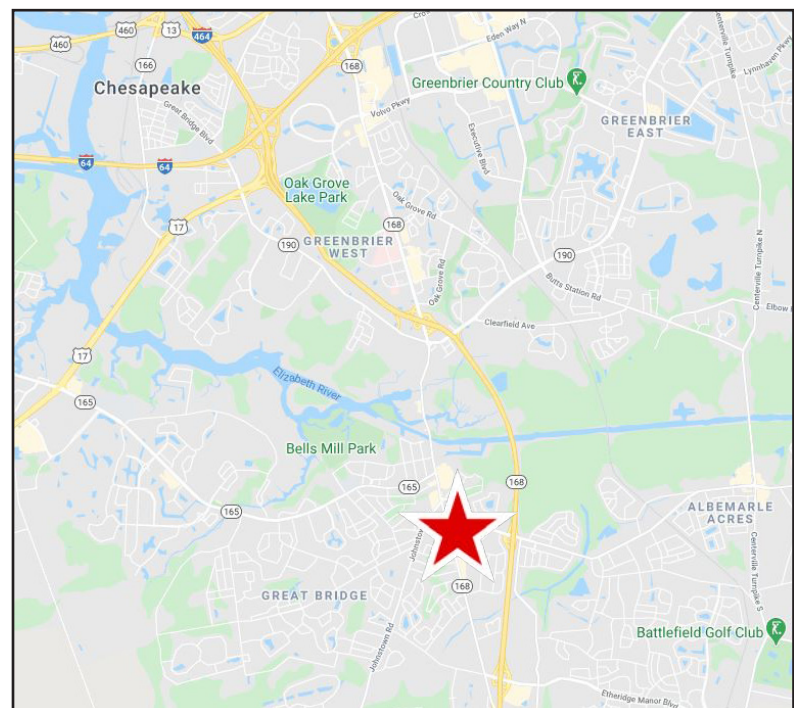

real estate group

Jay Burnell
o: 757.222.0111
m: 757.617.3511
jay@parkerburnell.com

Kristen Huber
o: 757.222.0111
m: 757.714.2341
kristen@parkerburnell.com

RENDERINGS



SITE PLAN

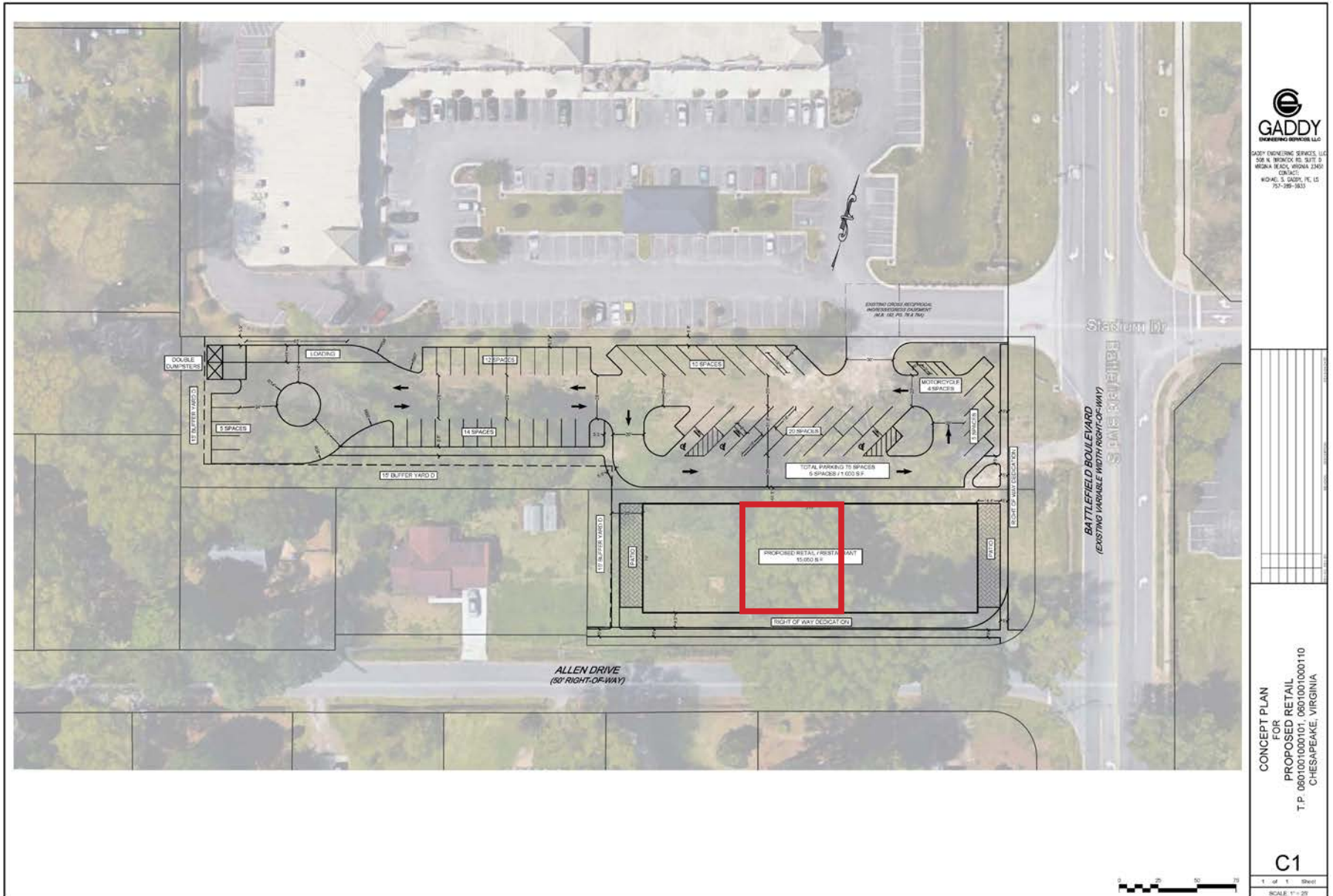

GADDY
ENGINEERING SERVICES, LLC
GADDY ENGINEERING SERVICES, LLC
508 N. WENWOOD RD. SUITE 200
WILMINGTON, VIRGINIA 23404
CONTACT:
MICHAEL S. GADDY, P.E., LE
757-399-1933

CONCEPT PLAN
FOR
PROPOSED RETAIL
T.P. 06010010000101, 06010010000110
CHESAPEAKE, VIRGINIA

C1
1 of 1 Sheet
SCALE: 1" = 25'

FLOOR PLAN

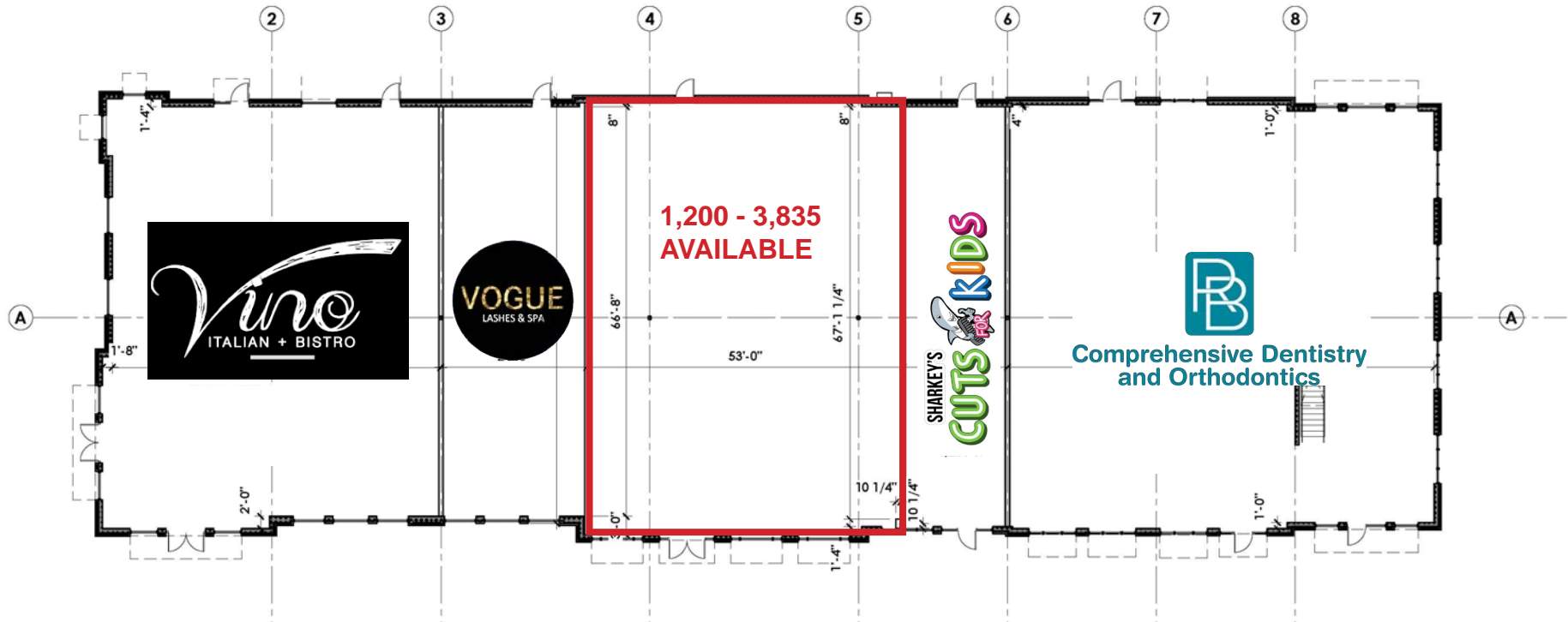

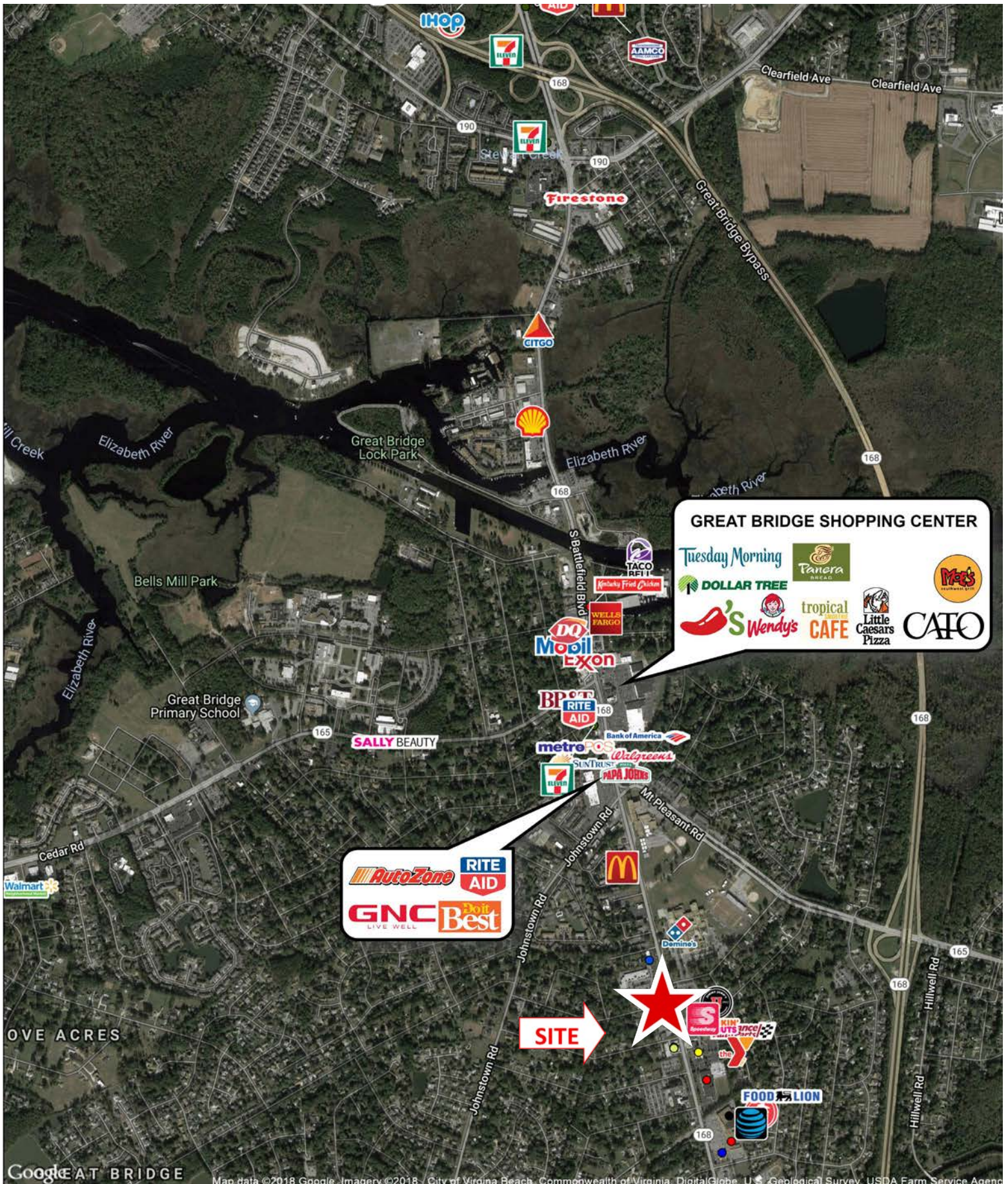

Jay Burnell
 o: 757.222.0111
 m: 757.617.3511
 jay@parkerburnell.com



Kristen Huber
 o: 757.222.0111
 m: 757.714.2341
 kristen@parkerburnell.com