

2022 WASHTENAW AVENUE YPSILANTI, MICHIGAN

LAND FOR GROUND LEASE
1.30 Acres Available



**SIGNATURE
ASSOCIATES**
KNOW SIGNATURE | KNOW RESULTS



PROPERTY FEATURES

- 1.30 acres available
- General Commercial
- Prominent redevelopment site
- Offers frontage on both Whittier and Washtenaw, situated in a highly desirable area of Ypsilanti
- High traffic volumes and close-proximity to Eastern Michigan University, Washtenaw Community College, and St. Joseph Mercy Hospital
- This location is ideal for fast food, mixed-use, childcare, offices, veterinary clinics, medical offices, and a variety of retail uses
- Convenient access to US-23 for a wide range of development options

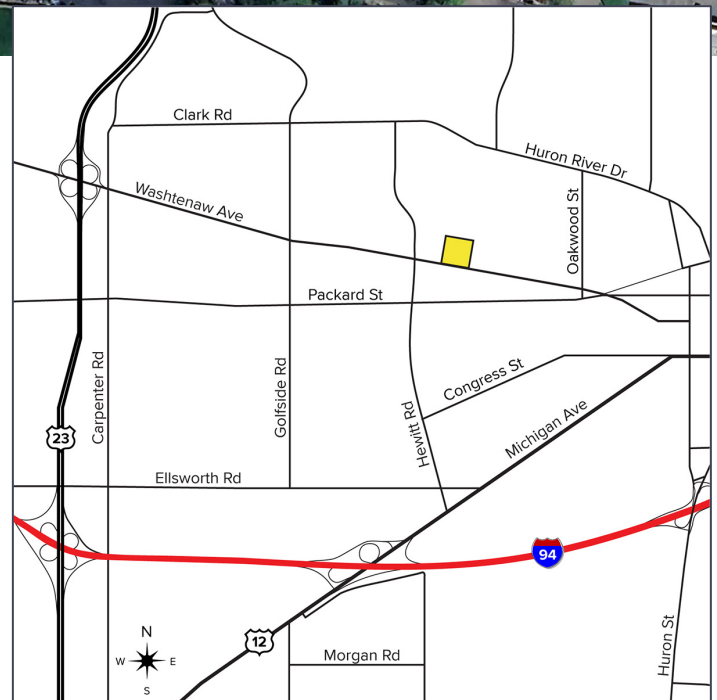

For more information, please contact:

BRUCE D. BAJA

(248) 799 3177

bbaja@signatureassociates.com

ANATOLA SESI

(248) 359 0629

asesi@signatureassociates.com

SIGNATURE ASSOCIATES

One Towne Square, Suite 1200

Southfield, MI 48076

www.signatureassociates.com

Information is subject to verification and no liability for errors or omissions is assumed. Price is subject to change and listing withdrawal.

2022 Washtenaw Avenue – Ypsilanti, Michigan

Land For Ground Lease

1.30
Acres
AVAILABLE

DEMOGRAPHICS

	POPULATION	MED. HH INCOME
1 MILE	13,228	\$66,578
3 MILE	64,174	\$71,130
5 MILE	154,444	\$82,257

TRAFFIC COUNTS (TWO-WAY)

27,954	Washtenaw Ave. E of Hewitt Rd.
28,513	Washtenaw Ave. W of Hewitt Rd.
13,870	Hewitt Rd. N of Washtenaw Rd.
14,263	Hewitt Rd. S of Washtenaw Rd.

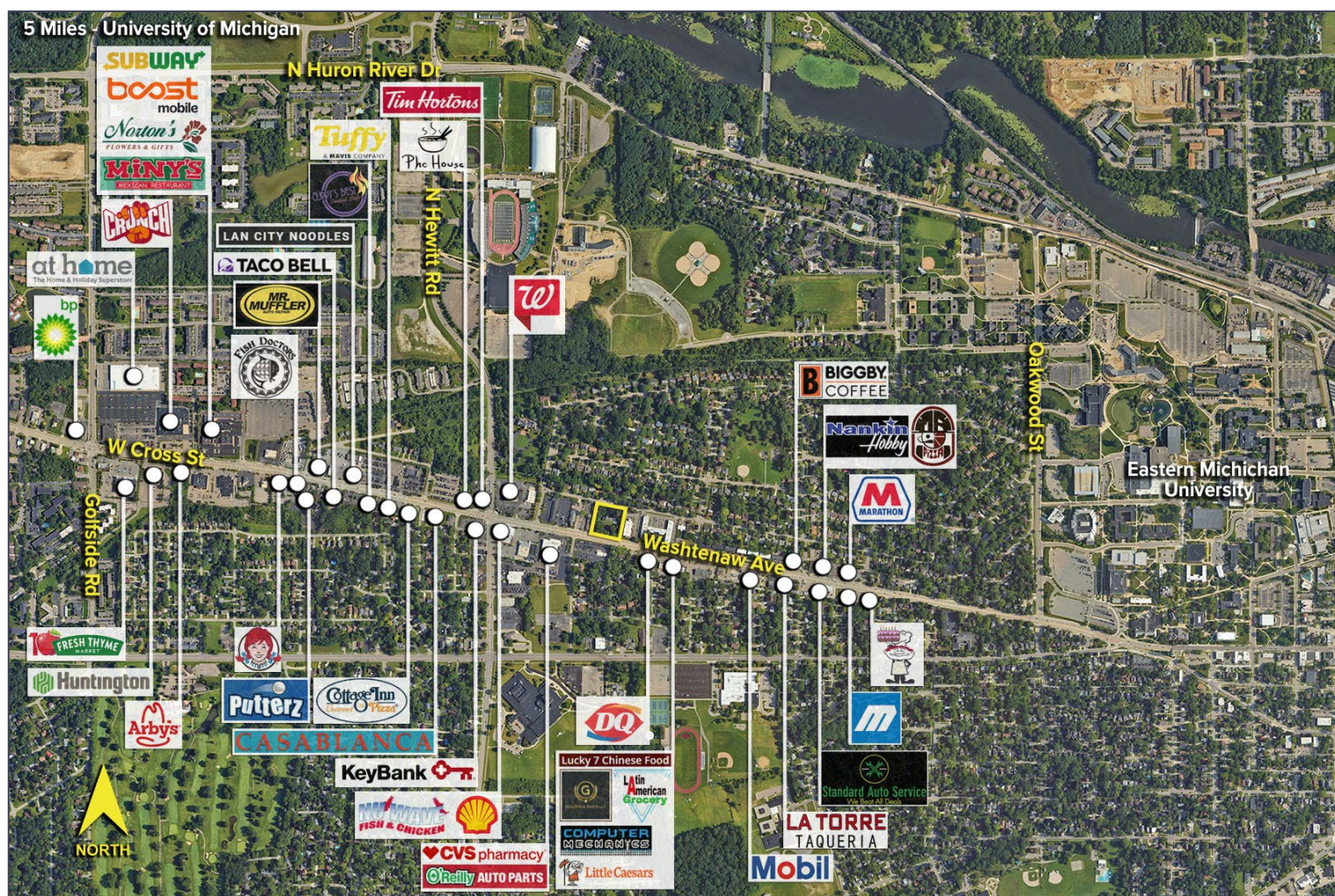

For more information, please contact:

BRUCE D. BAJA
(248) 799 3177
bbaja@signatureassociates.com

ANATOLA SESI
(248) 359 0629
asesi@signatureassociates.com

SIGNATURE ASSOCIATES
One Towne Square, Suite 1200
Southfield, MI 48076
www.signatureassociates.com

Information is subject to verification and no liability for errors or omissions is assumed. Price is subject to change and listing withdrawal.