

Newberg Industrial Park

500 E. Illinois St
Newberg OR 97132

BUILDING DESIGN & SIZES

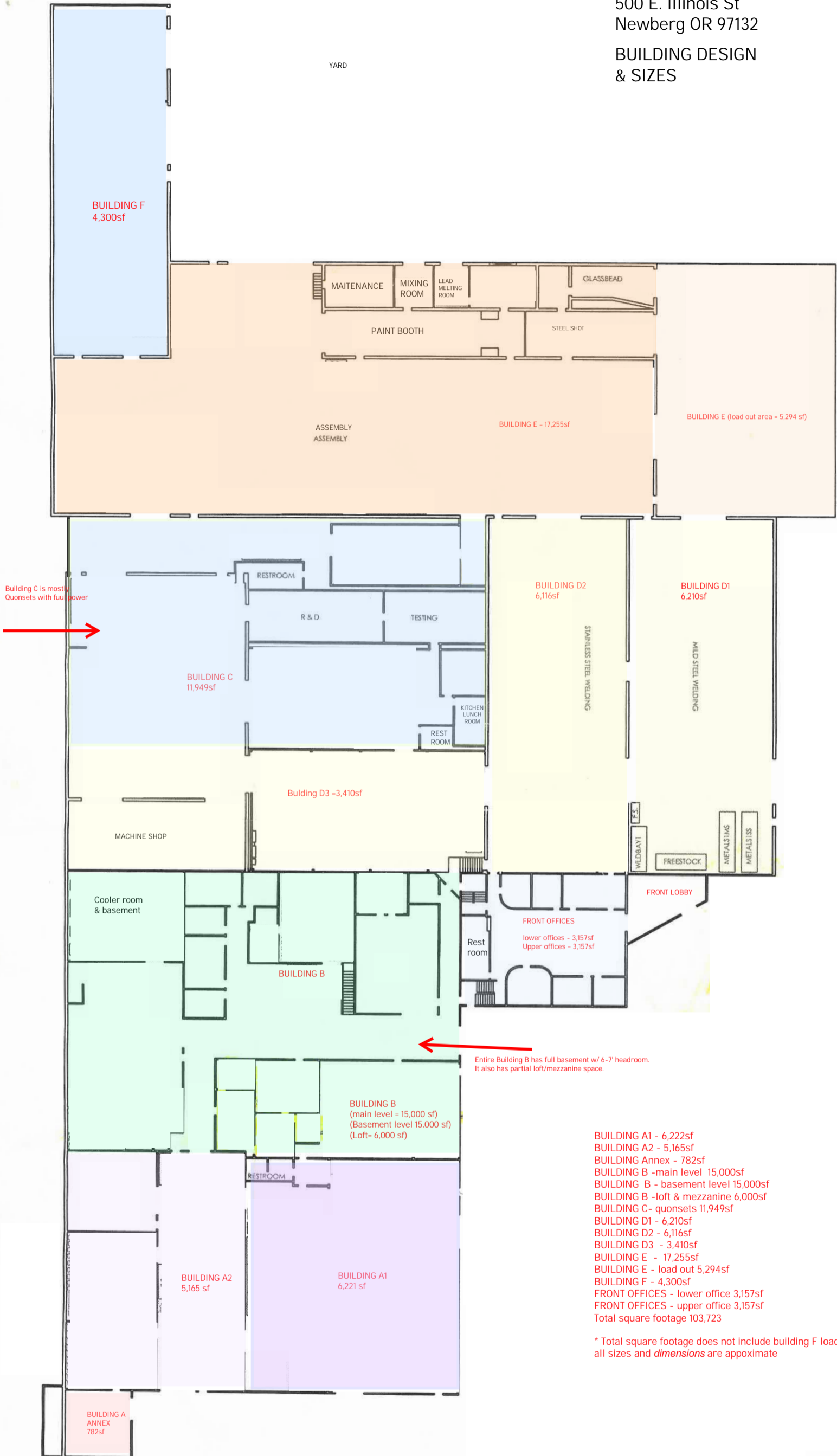

Building C is mostly Quonsets with full power
→

← Entire Building B has full basement w/ 6-7' headroom. It also has partial loft/mezzanine space.

- BUILDING A1 - 6,222sf
- BUILDING A2 - 5,165sf
- BUILDING Annex - 782sf
- BUILDING B -main level 15,000sf
- BUILDING B - basement level 15,000sf
- BUILDING B -loft & mezzanine 6,000sf
- BUILDING C - quonsets 11,949sf
- BUILDING D1 - 6,210sf
- BUILDING D2 - 6,116sf
- BUILDING D3 - 3,410sf
- BUILDING E - 17,255sf
- BUILDING E - load out 5,294sf
- BUILDING F - 4,300sf
- FRONT OFFICES - lower office 3,157sf
- FRONT OFFICES - upper office 3,157sf
- Total square footage 103,723

* Total square footage does not include building F load-out area; all sizes and dimensions are approximate