

FOR SALE

6 Warehouse Condos 1,250 SF to 2,500 SF

4810 WAGES WAY

Sugar Hill, GA 30518

PRESENTED BY:

MATTHEW LEVIN, CCIM

O: 770.209.1700

levinm@svn.com

GA #119351

PROPERTY DETAILS & HIGHLIGHTS

BUILDING NAME	4810 Wages Way, Sugar Hill, GA 30518
UNIT SIZES	1,250 SF - 2,000 SF - 2,500 SF
PRICE	\$275.00 SF
TOTAL BUILDING SIZE	9,500 SF
LOT SIZE	1.18 Acres

For sale are 6 newly constructed warehouse condominium units. Unit A has 2,000 SF. Units B, C, D, and E have 1,250 SF. Unit F has 2,500 SF. Each unit is delivered with a 200 amp electrical panel, fixtured restroom, insulation, 3 sheetrock walls, perimeter outlets, LED lighting and 8'x 10' at grade roll up door. The 16' to 19'10" ceiling height can accommodate a future 9' high mezzanine in up to 30% of the space. The one acre site is zoned highway service business in the city of Sugar Hill.

The location off Nelson Brogdon Boulevard is one block from Peachtree Industrial Boulevard, and minutes to Buford Highway and I-985.



- For sale 6 new warehouse condos 1,250 SF, 2,000 SF and 2,500 SF
- 200 amp service, fixtured restroom, insulation, 3 sheetrock walls,
- Perimeter outlets, LED lighting and 8'x 10' at grade roll up door
- 16' to 19'10" ceiling height allows for a future mezzanine
- 1 acre site highway service business
- Located one block from Peachtree Industrial Blvd and minutes to Buford Hwy and I-985

MATTHEW LEVIN, CCIM

O: 770.209.1700

levinm@svn.com

GA #119351

1.18 ACRE+- SITE ZONED HIGHWAY SERVICE BUSINESS



MATTHEW LEVIN, CCIM

O: 770.209.1700

levinm@svn.com

GA #119351

6 WAREHOUSE CONDOS TOTALING 9,500 SF

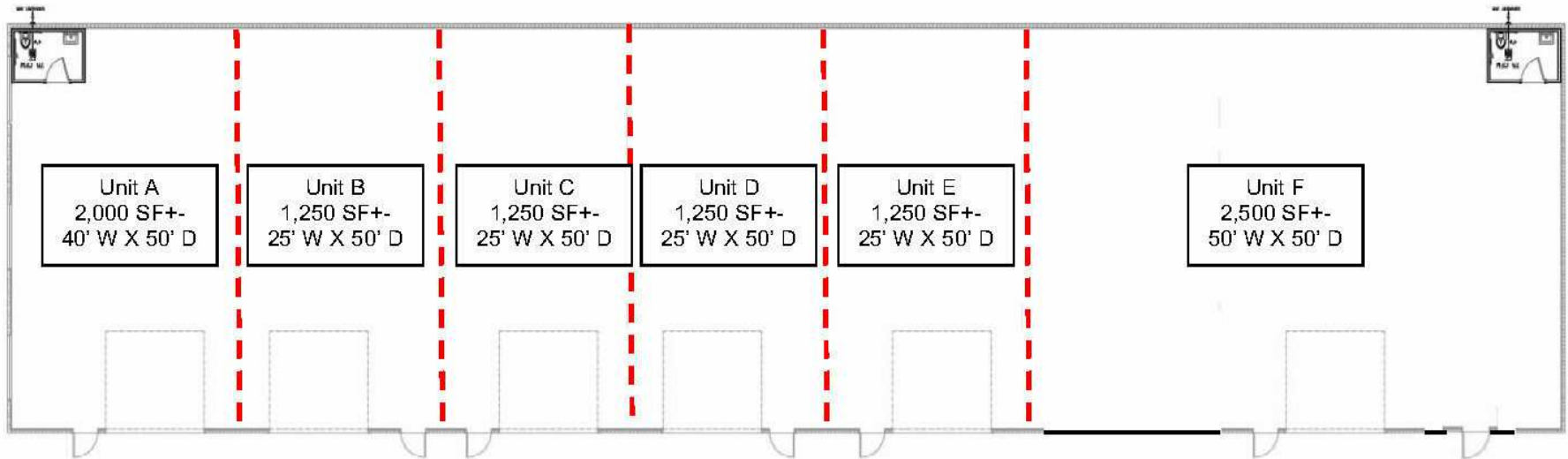

MATTHEW LEVIN, CCIM
O: 770.209.1700
levinm@svn.com
GA #119351

MATTHEW LEVIN, CCIM
O: 770.209.1700
levinm@svn.com
GA #119351

DEMOGRAPHICS MAP & REPORT

POPULATION

	1 MILE	3 MILES	5 MILES
TOTAL POPULATION	6,357	54,156	135,154
AVERAGE AGE	36	37	38
AVERAGE AGE (MALE)	35	36	37
AVERAGE AGE (FEMALE)	37	38	39

HOUSEHOLDS & INCOME

	1 MILE	3 MILES	5 MILES
TOTAL HOUSEHOLDS	2,124	17,543	44,212
# OF PERSONS PER HH	3	3.1	3.1
AVERAGE HH INCOME	\$94,962	\$116,917	\$137,971
AVERAGE HOUSE VALUE	\$360,709	\$420,291	\$482,467

Demographics data derived from AlphaMap

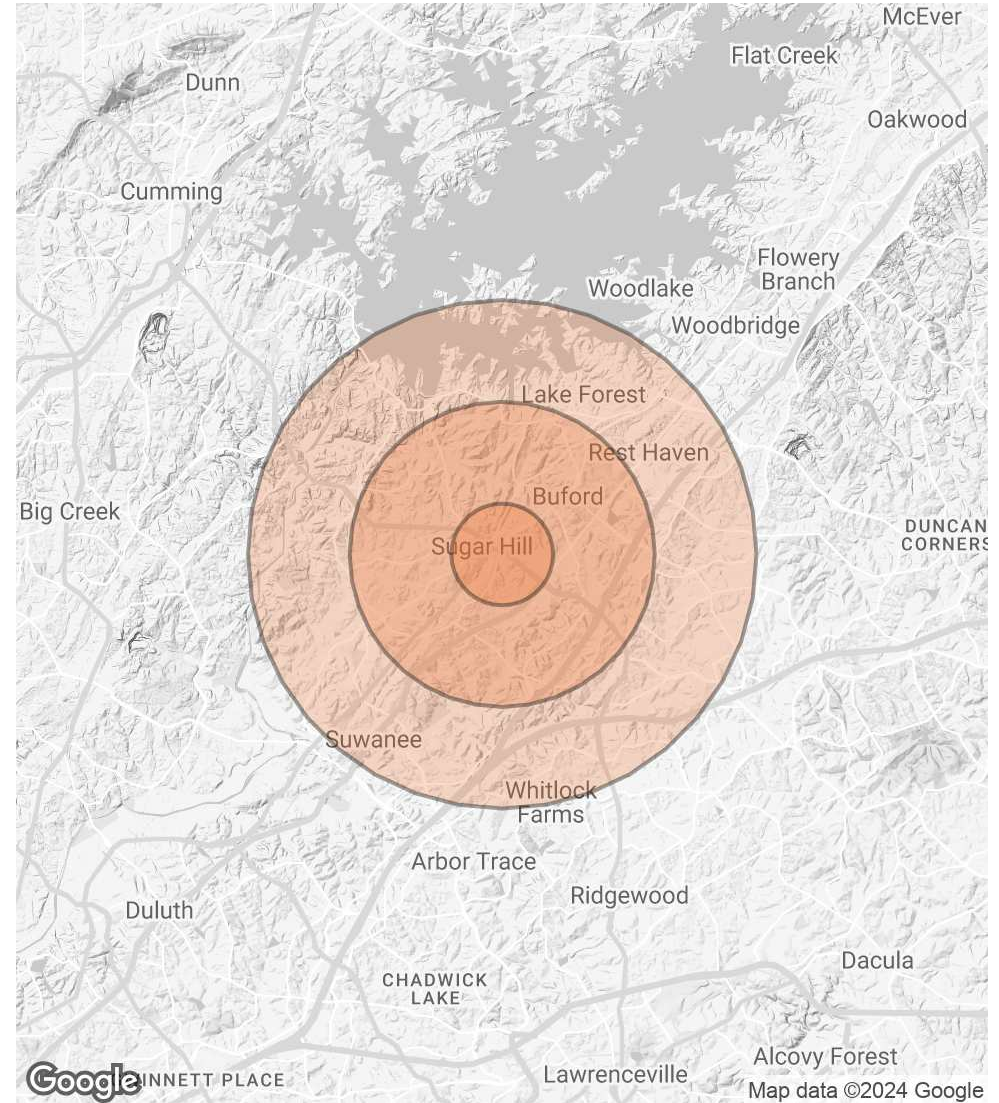

MATTHEW LEVIN, CCIM

O: 770.209.1700

levinm@svn.com

GA #119351

ADVISOR BIO



MATTHEW LEVIN, CCIM

Senior Advisor

levinm@svn.com

Direct: **770.209.1700** | Cell: **678.467.9658**

GA #119351

PROFESSIONAL BACKGROUND

Matthew J. Levin, CCIM, serves as a Senior Advisor for SVN, focusing on the sale and leasing of retail, office and industrial properties. With over 25 years experience in the real estate industry, he has completed over 500 transactions valued at \$300 million. Matthew is a multi-year recipient of the Partner Circle Award, SVN's highest recognition, and consistently performs in the top 100 of advisors nationally.

Prior to joining SVN, Matthew served as President of Dekalb Realty Company. Previously, he served as a \$250 million Commercial Real Estate Non-Performing Loan Portfolio Manager for the Federal Deposit Insurance Corporation (FDIC).

Matthew is a Phoenix Award recipient of the Atlanta Commercial Board of Realtors' Million Dollar Club. He is past president of the Georgia State University, Real Estate Alumni Group, and past chairman of the Scholarship Committee of the Georgia Chapter of CCIM.

Matthew received his Bachelor of Arts from Emory University and Master of Science degree in Real Estate from Georgia State University.

He lives with his wife of over 23 years Valerie and daughter Camille. Matthew is an avid sailor having first learned from his father. "Sailing is much like life, you're heading for a destination and the changes in weather, wind and current require anticipation, attention and adjustment. Getting there can be as interesting as arriving."

SVN | Interstate Brokers

3300 Holcomb Bridge Rd, Ste 240
Peachtree Corners, GA 30092
404.303.1232

MATTHEW LEVIN, CCIM

O: 770.209.1700

levinm@svn.com

GA #119351