

# FOR LEASE

NEW SHELL GAS/C-STORE | 3,940 SF AVAILABLE (DIVISIBLE TO 1,274 SF)

## 1266 READING ROAD

MASON, OH 45040



### OFFERING SUMMARY

Address	1266 Reading Rd Mason, OH 45040
Square Footage	3,940 SF Available Divisible to 1,274 SF End-cap suite w/ Drive-Thru
Year Built	New Construction   Ready for Build-out
Construction	All Brick & Natural Stone Construction
Traffic Count	12,684 VPD
Municipality	City of Mason
Zoning	B-3—Business

**UNDER CONSTRUCTION**

Q4 2023 DELIVERY



**MIKE BASTIN** | DIRECT: 513.618.2823 | CELL: 513.520.4525 | EMAIL: [MIKBASTIN@CBCRELIANTREALTY.COM](mailto:MIKBASTIN@CBCRELIANTREALTY.COM)

2181 VICTORY PARKWAY | SUITE 102  
CINCINNATI, OH 45206

[WWW.CBCRELIANTREALTY.COM](http://WWW.CBCRELIANTREALTY.COM)



©2023 Coldwell Banker Real Estate LLC, dba Coldwell Banker Commercial Affiliates. All rights reserved. Coldwell Banker Commercial® and the Coldwell Banker Commercial are registered service marks owned by Coldwell Banker Real Estate LLC. Coldwell Banker Real Estate LLC, dba Coldwell Banker Commercial Affiliates fully supports the principles of the Fair Housing Act and the Equal Opportunity Act. Each office is independently owned and operated.

# FOR LEASE

NEW SHELL GAS/C-STORE | 3,940 SF AVAILABLE (DIVISIBLE TO 1,274 SF)

1266 READING ROAD

MASON, OH 45040

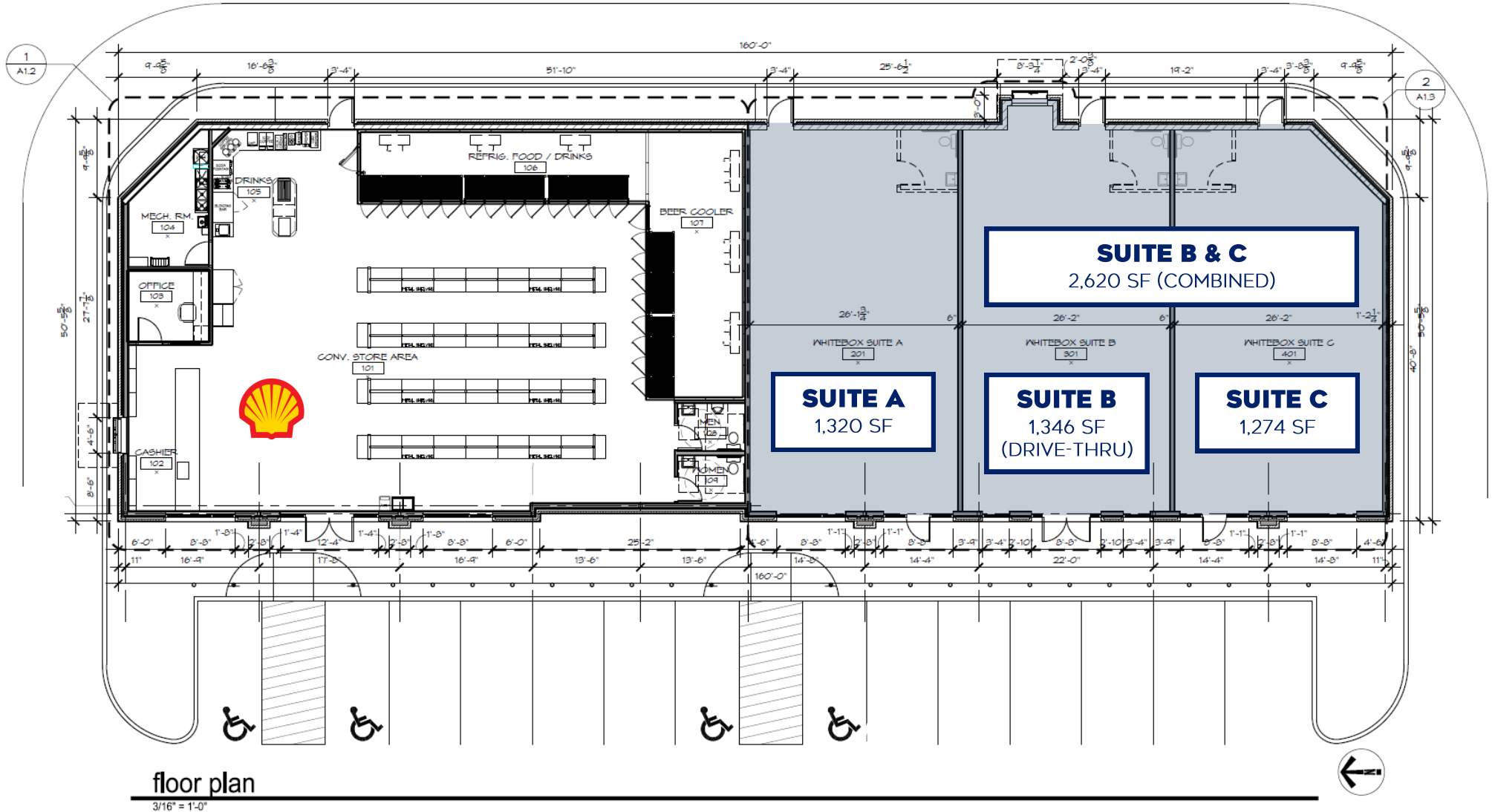

**MIKE BASTIN** | DIRECT: 513.618.2823 | CELL: 513.520.4525 | EMAIL: [MJBASTIN@CBCRELIANTREALTY.COM](mailto:MJBASTIN@CBCRELIANTREALTY.COM)

2181 VICTORY PARKWAY | SUITE 102  
CINCINNATI, OH 45206

[WWW.CBCRELIANTREALTY.COM](http://WWW.CBCRELIANTREALTY.COM)





# FOR LEASE

NEW SHELL GAS/C-STORE | 3,940 SF AVAILABLE (DIVISIBLE TO 1,274 SF)

1266 READING ROAD

MASON, OH 45040



## PROPERTY DETAILS

- Drive-Thru/Pickup Window available
- 41 parking spaces available
- Corner Lot | Reading Rd & Castle Dr
- Excellent Visibility & Monument Signage Available
- Flexible Layout & Configuration
- Busy Shell Gas Station & Convenience Store Co-Tenancy
- Across the street from new Hospital Development
- High Traffic Area—12,684 VPD count

## DEMOGRAPHICS

Radius	1 Mile	3 Mile	5 Mile
Population:			
2023 Total Population	7,966	64,892	155,622
2023 Daytime Population	8,125	70,671	188,992
Income & Home Values:			
2023 Avg HH Income	\$129,170	\$148,316	\$147,029
2023 Median HH Income	\$104,183	\$110,779	\$108,967
2023 Per Capita Income	\$45,978	\$55,183	\$55,992
2023 Average Home Value	\$266,037	\$366,439	\$359,644

**MIKE BASTIN** | **DIRECT:** 513.618.2823 | **CELL:** 513.520.4525 | **EMAIL:** MJBASTIN@CBCRELIANTREALTY.COM

2181 VICTORY PARKWAY | SUITE 102  
CINCINNATI, OH 45206

[WWW.CBCRELIANTREALTY.COM](http://WWW.CBCRELIANTREALTY.COM)

