



## PROPERTY FEATURES

**135 Darling Drive** is a single-story 39,654 SF Class A office/flex building located on a 9-acre wooded lot in Avon Park South in Avon, Connecticut. Avon Park South is the premiere mixed-use business park in the Farmington Valley. The building offers a 5/1,000 parking ratio, an on-grade overhead door, FINELITE lighting and a unique location within a master planned business park.



**For further information, please contact:**

**Maury Smith** | D 860.327.8304 | C 860.748.2508 | [maury.smith@avisonyoung.com](mailto:maury.smith@avisonyoung.com)

**Avison Young** | 225 Asylum Street, 16th Floor | Hartford, CT 06103 | T 860.327.8330

**29,164 SF AVAILABLE | 1st Floor**

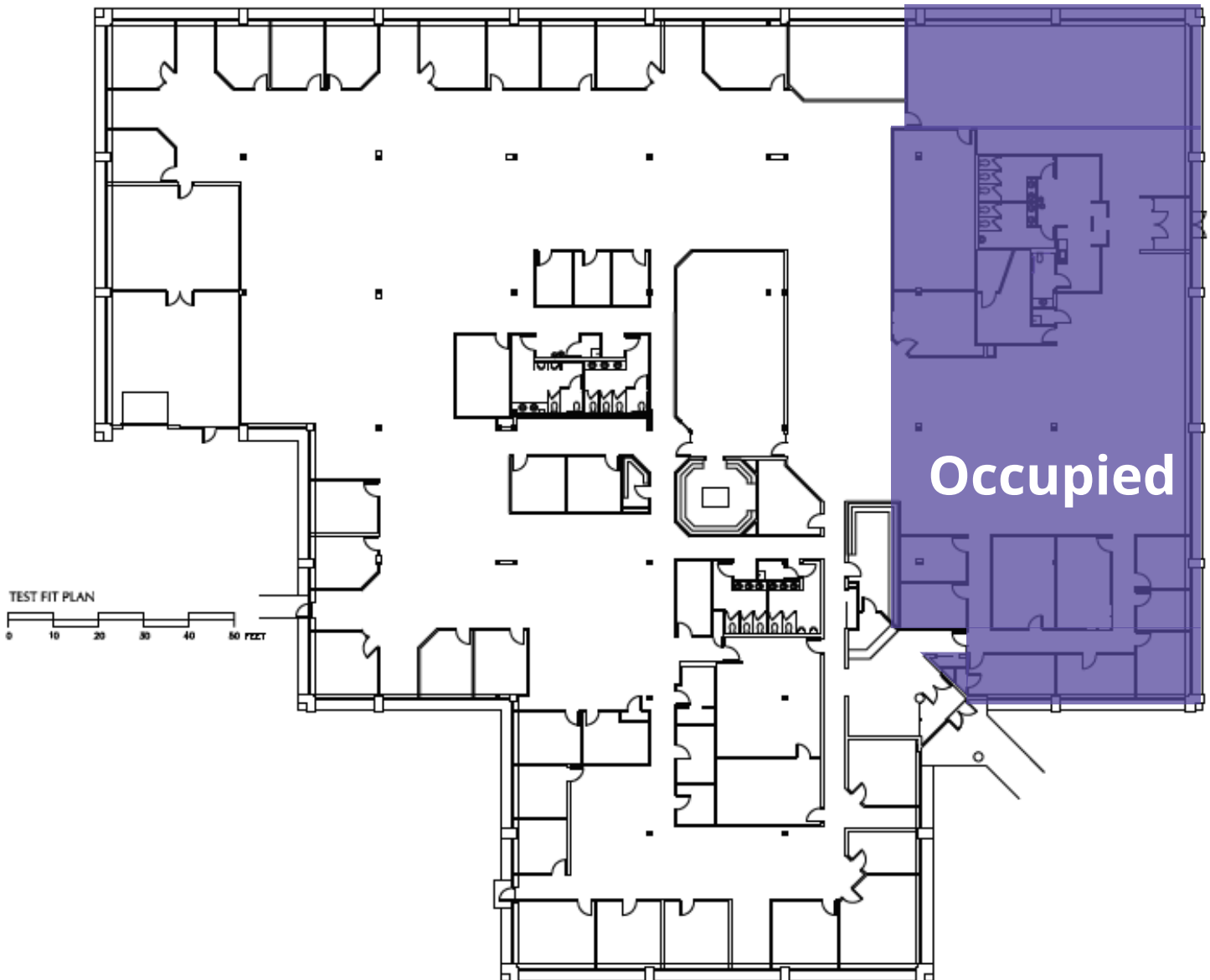

**For further information, please contact:**

**Maury Smith** | D 860.327.8304 | C 860.748.2508 | [maury.smith@avisonyoung.com](mailto:maury.smith@avisonyoung.com)

**Avison Young** | 225 Asylum Street, 16th Floor | Hartford, CT 06103 | T 860.327.8330