



FOR LEASE

8,000-12,000 SF Dead Storage Space

6845 Mimms Dr | Doraville, GA



8,000-12,000 SF Dead Storage Space

6845 Mimms Dr | Doraville, GA 30340



FOR LEASE

±34,395 SF

Building Size

M1

Zoning

Immediate

Available

Contact Broker

Rate & Pricing

PROPERTY HIGHLIGHTS

Available SF	8,000-12,000
Land AC	2.6
Land SF	113,256
Clear Height	19'
Dock High	5
Car Parks Surface	14
Outside Storage	34,000 SF Fenced



6845 Mimms Dr | Doraville, GA 30340

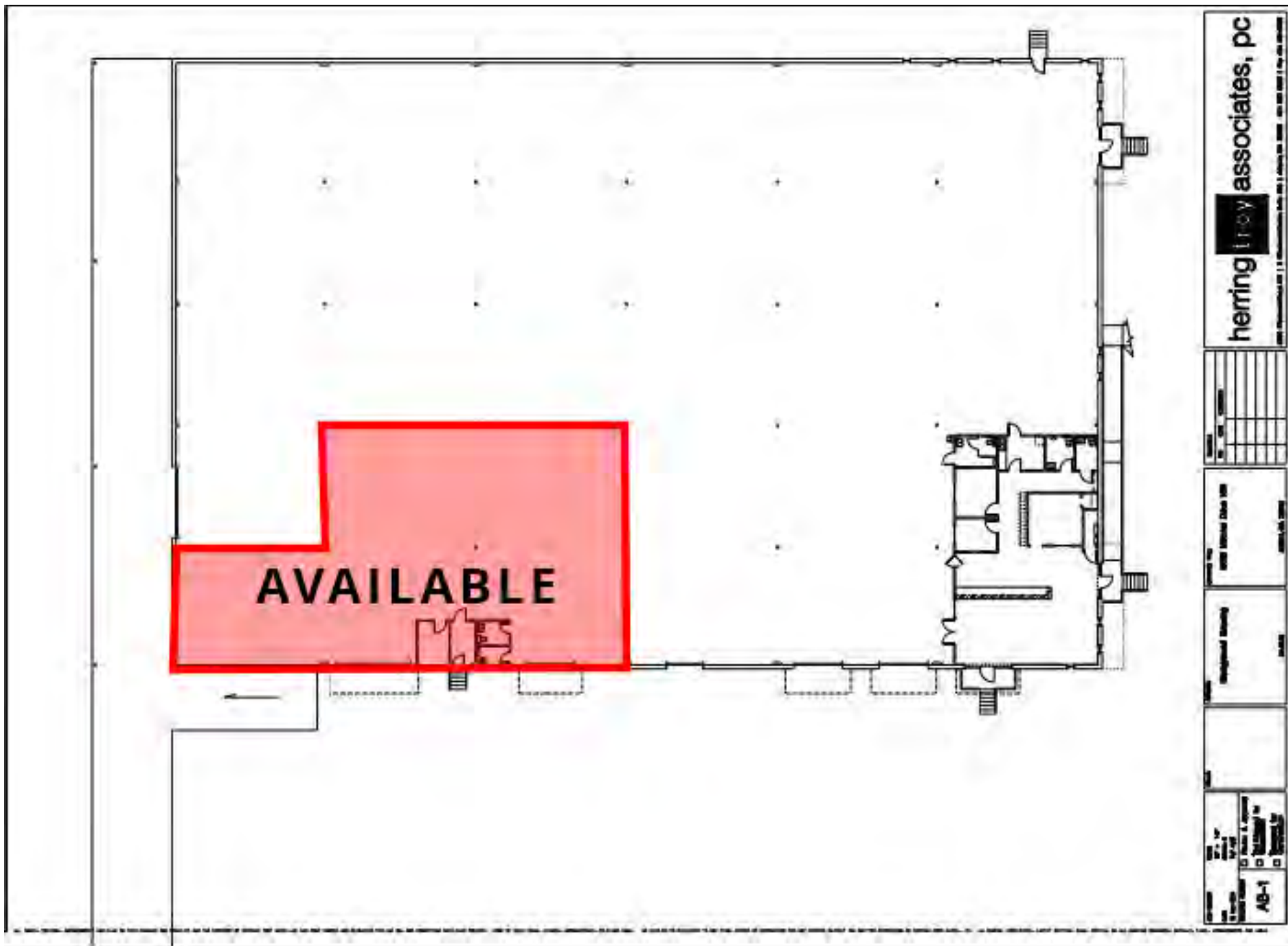

8,000-12,000 SF Dead Storage Space

6845 Mimms Dr | Doraville, GA 30340

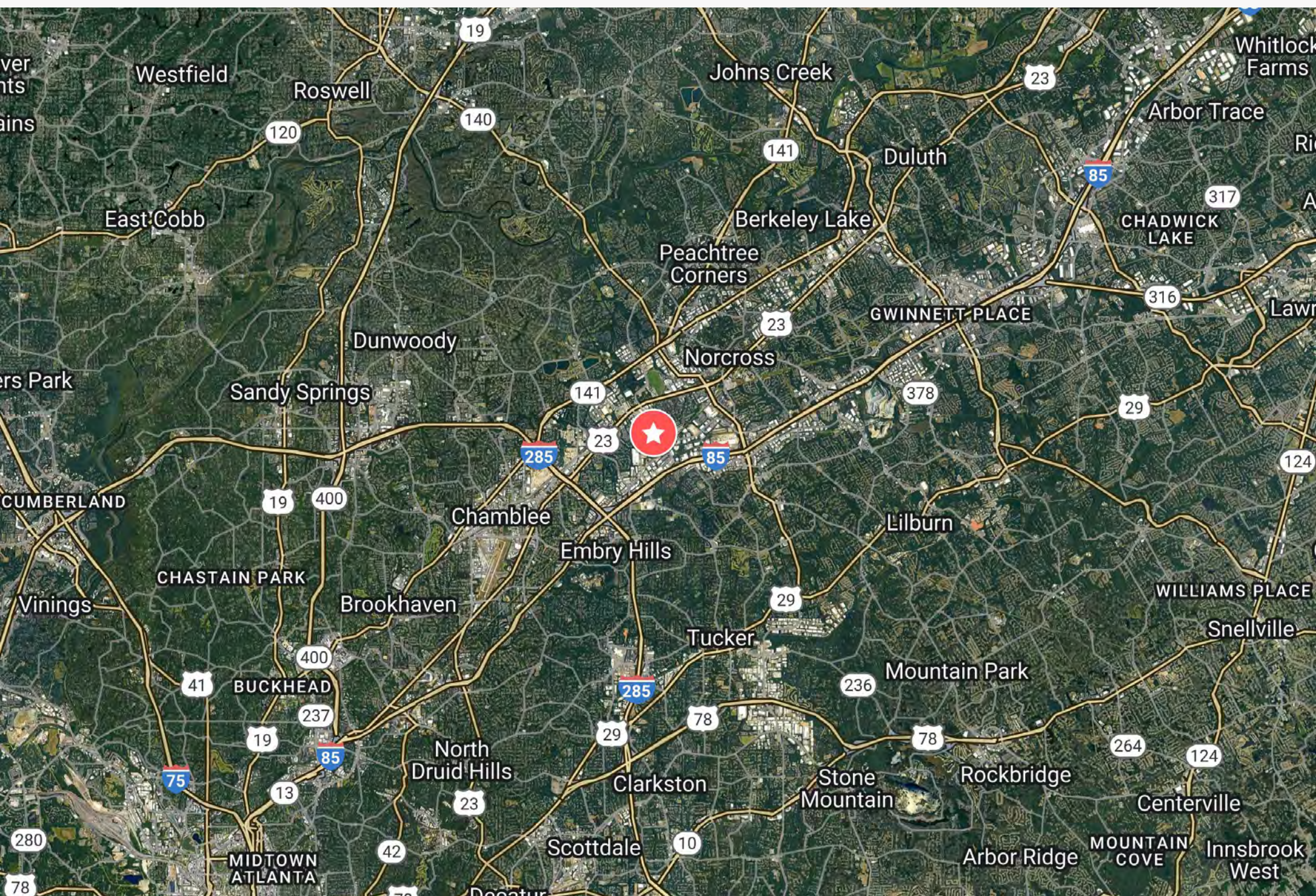



SRS Real Estate Partners
3445 Peachtree Rd NE, Suite 950
Atlanta, GA 30326
404.231.2232

Chip Watson, SIOR
Managing Principal
404.290.3118
chip.watson@srsre.com

Trae Lewis
Associate
678.427.5194
trae.lewis@srsre.com

Joe Hewes
404..625.7525
joe.hewes@srsre.com

SRSRE.COM/Industrial

© SRS Real Estate Partners - Southeast LLC

The information presented was obtained from sources deemed reliable;
however SRS Real Estate Partners does not guarantee its completeness or accuracy.