



Eastern PA Availabilities

The Gateway at Greenway Park

Retail/Office Available For Lease

306 S New Street
Bethlehem, PA 18015



Property Features

- + Total building size is 127,832 SF
- + First floor retail space available: ±1,560 - 8,000 SF
- + 6th floor office spaces available: ±2,900 - ±4,422 SF Shell Space
- + Attached to a 600 car parking garage
- + CRIZ AND LERTA Tax Zone benefits
- + Mixed-use building located minutes from Route 378, Route 412, I-78 and Route 22 in the heart of South Bethlehem

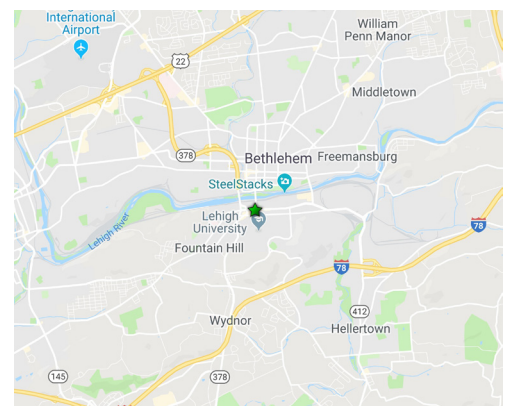

Office Info

- + ±85,220 SF of office space fully leased
- + ±2,900 & 4,422 SF Shell Space available on 6th floor
- + Anchor tenants include: St. Luke's University Health Network, Lehigh University and Venture X

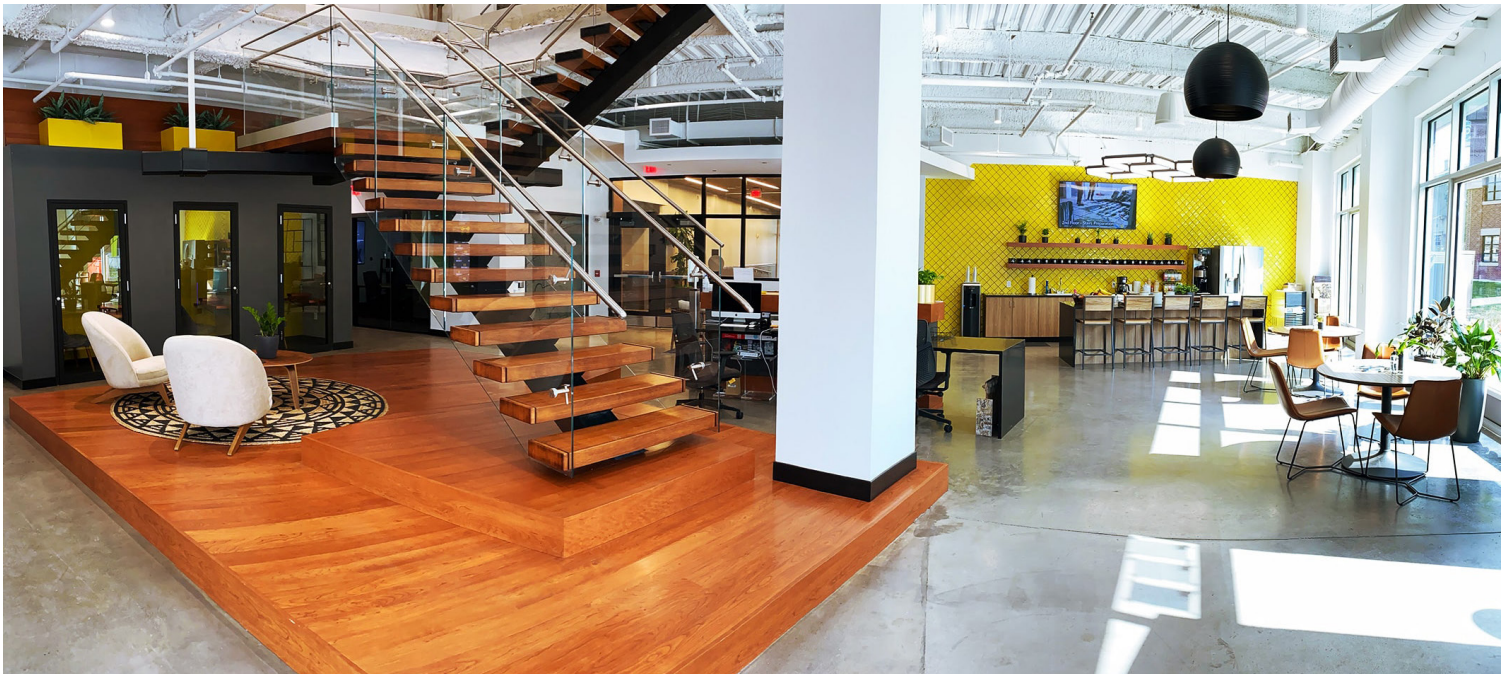
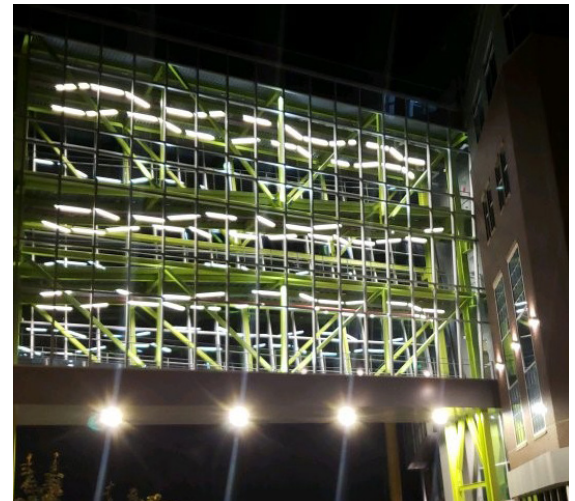

Retail Info

- + Total building size is 127,832 SF
- + First floor retail space available 1,560 - 8,000 SF
- + CRIZ AND LERTA Tax Zone benefits

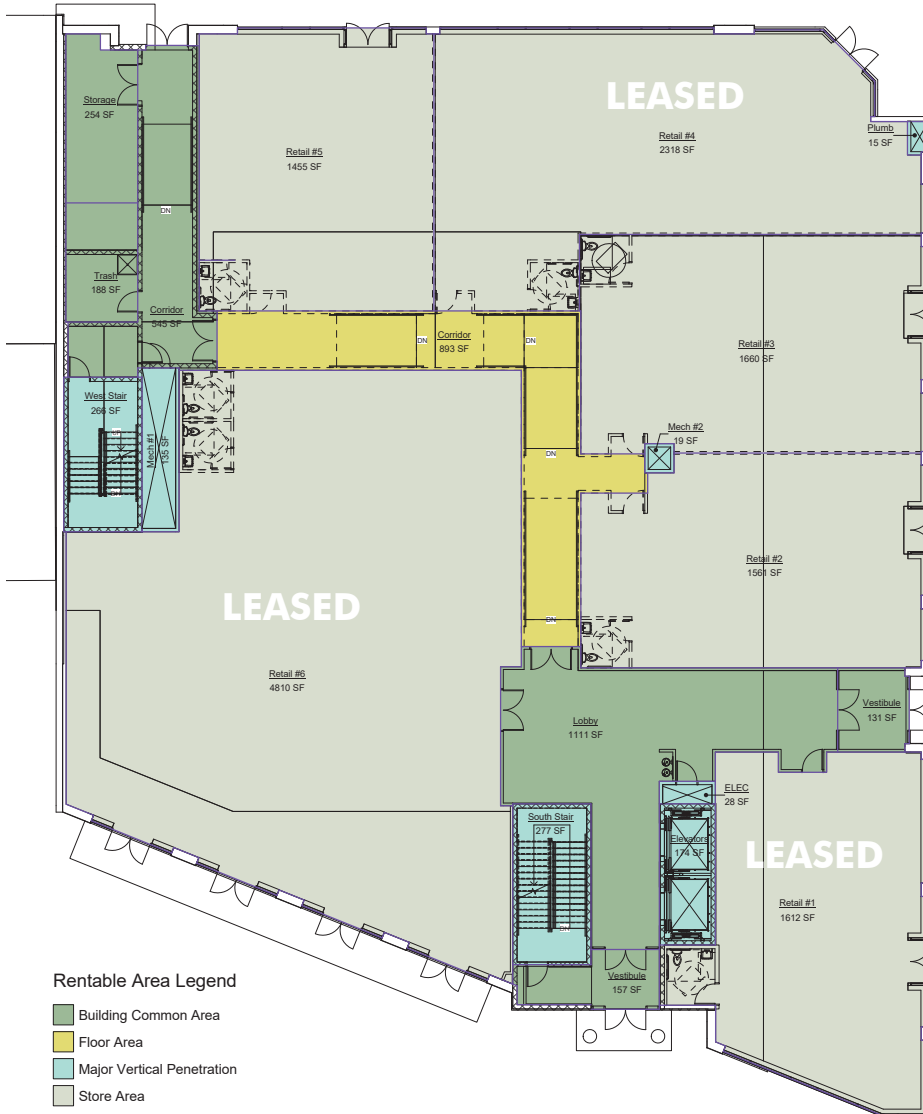

2024 Demographics	1 Mile	3 Miles	5 Miles
Population	27,376	96,281	198,190
Average HH Income	\$69,329	\$90,366	\$94,913
Households	9,772	37,603	75,821

Property Aerial

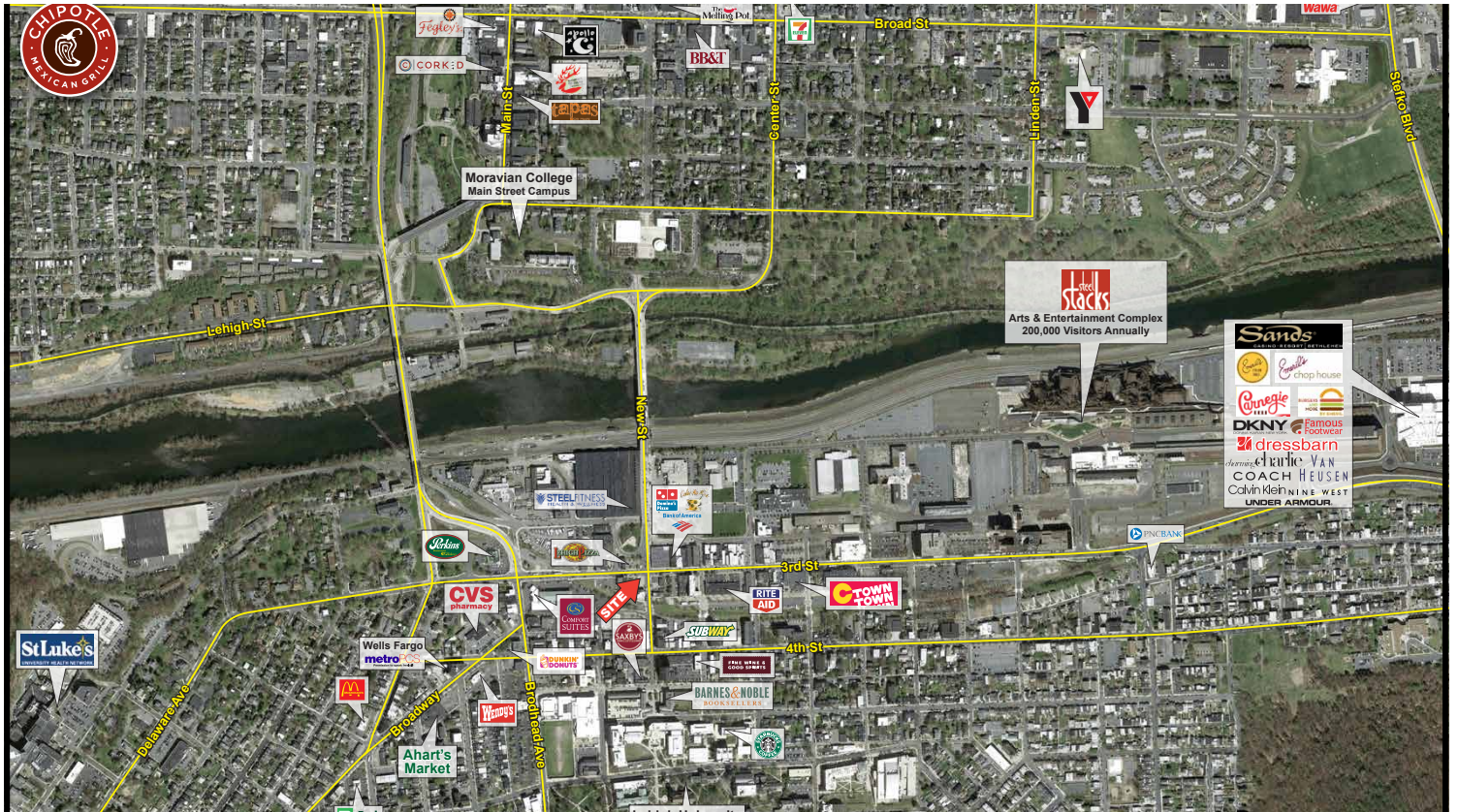

Contact Us

Jody King

First Vice President
+1 610 398 3384
jody.king@cbre.com
Licensed: PA

Pam Hall

Associate
+1 610 398 6900
pamela.hall@cbre.com
Licensed: PA

CBRE, Inc.

1275 Glenlivet Drive
Allentown, PA 18106
+1 610 398 6900
Licensed Real Estate Broker

© 2022 CBRE, Inc. All rights reserved. This information has been obtained from sources believed reliable, but has not been verified for accuracy or completeness. You should conduct a careful, independent investigation of the property and verify all information. Any reliance on this information is solely at your own risk. CBRE and the CBRE logo are service marks of CBRE, Inc. All other marks displayed on this document are the property of their respective owners, and the use of such logos does not imply any affiliation with or endorsement of CBRE. Photos herein are the property of their respective owners. Use of these images without the express written consent of the owner is prohibited.