

Corporate Center Office Building

881 Corporate Drive
Lexington, Kentucky 40503

Property Highlights

- +/-27,247 SF two-story office building
- +/-6,688 SF for lease on the first floor
- 72 parking spaces
- Located in Corporate Center at the intersection of Harrodsburg & New Circle Roads
- Convenient access to Beaumont Centre, Blue Grass Airport, downtown Lexington, upscale residential communities, retail, hotel accommodations, financial institutions and Keeneland Race Course
- Full service rental rate

Space

Suite 101

Lease Rate

\$21.50 SF/yr

Space Size

6,688 SF

For More Information

Paul Ray Smith, Jr

Executive Vice President
O: 859 422 4401
prsmith@naiisaac.com

Zach Smith, CCIM

Senior Associate
O: 859 422 4406
zachsmith@naiisaac.com

Jordan Smith, MRED

Associate
O: 859 224 2000
jsmith@naiisaac.com



NO WARRANTY OR REPRESENTATION, EXPRESS OR IMPLIED, IS MADE AS TO THE ACCURACY OF THE INFORMATION CONTAINED HEREIN, AND THE SAME IS SUBMITTED SUBJECT TO ERRORS, OMISSIONS, CHANGE OF PRICE, RENTAL OR OTHER CONDITIONS, PRIOR SALE, LEASE OR FINANCING, OR WITHDRAWAL WITHOUT NOTICE, AND OF ANY SPECIAL LISTING CONDITIONS IMPOSED BY OUR PRINCIPALS NO WARRANTIES OR REPRESENTATIONS ARE MADE AS TO THE CONDITION OF THE PROPERTY OR ANY HAZARDS CONTAINED THEREIN ARE ANY TO BE IMPLIED.

771 Corporate Drive, Suite 500
Lexington, KY 40503
859 224 2000 tel
naiisaac.com



NO WARRANTY OR REPRESENTATION, EXPRESS OR IMPLIED, IS MADE AS TO THE ACCURACY OF THE INFORMATION CONTAINED HEREIN, AND THE SAME IS SUBMITTED SUBJECT TO ERRORS, OMISSIONS, CHANGE OF PRICE, RENTAL OR OTHER CONDITIONS, PRIOR SALE, LEASE OR FINANCING, OR WITHDRAWAL WITHOUT NOTICE, AND OF ANY SPECIAL LISTING CONDITIONS IMPOSED BY OUR PRINCIPALS NO WARRANTIES OR REPRESENTATIONS ARE MADE AS TO THE CONDITION OF THE PROPERTY OR ANY HAZARDS CONTAINED THEREIN ARE ANY TO BE IMPLIED.

771 Corporate Drive, Suite 500
Lexington, KY 40503
859 224 2000 tel
naiisaac.com

1st Floor

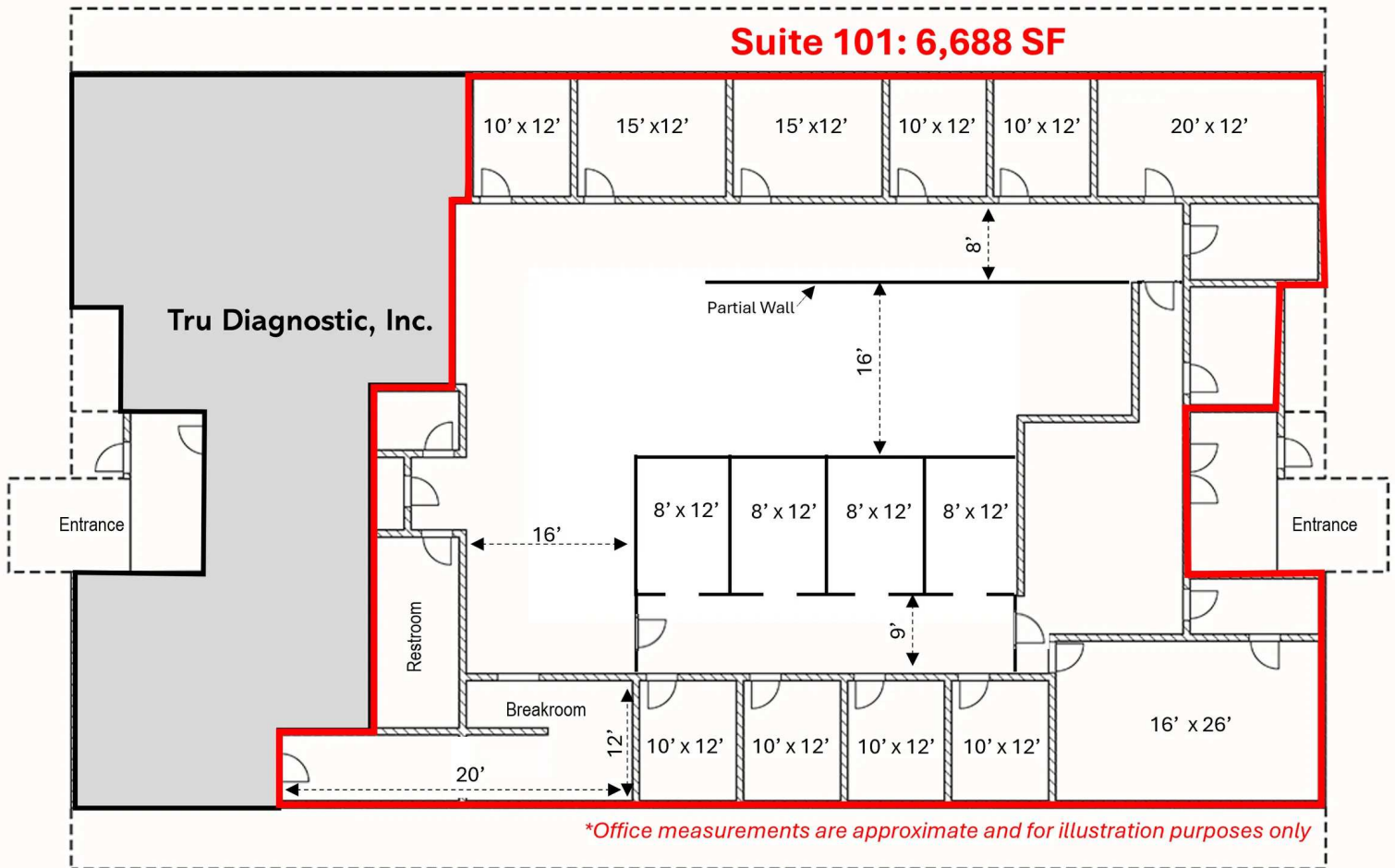

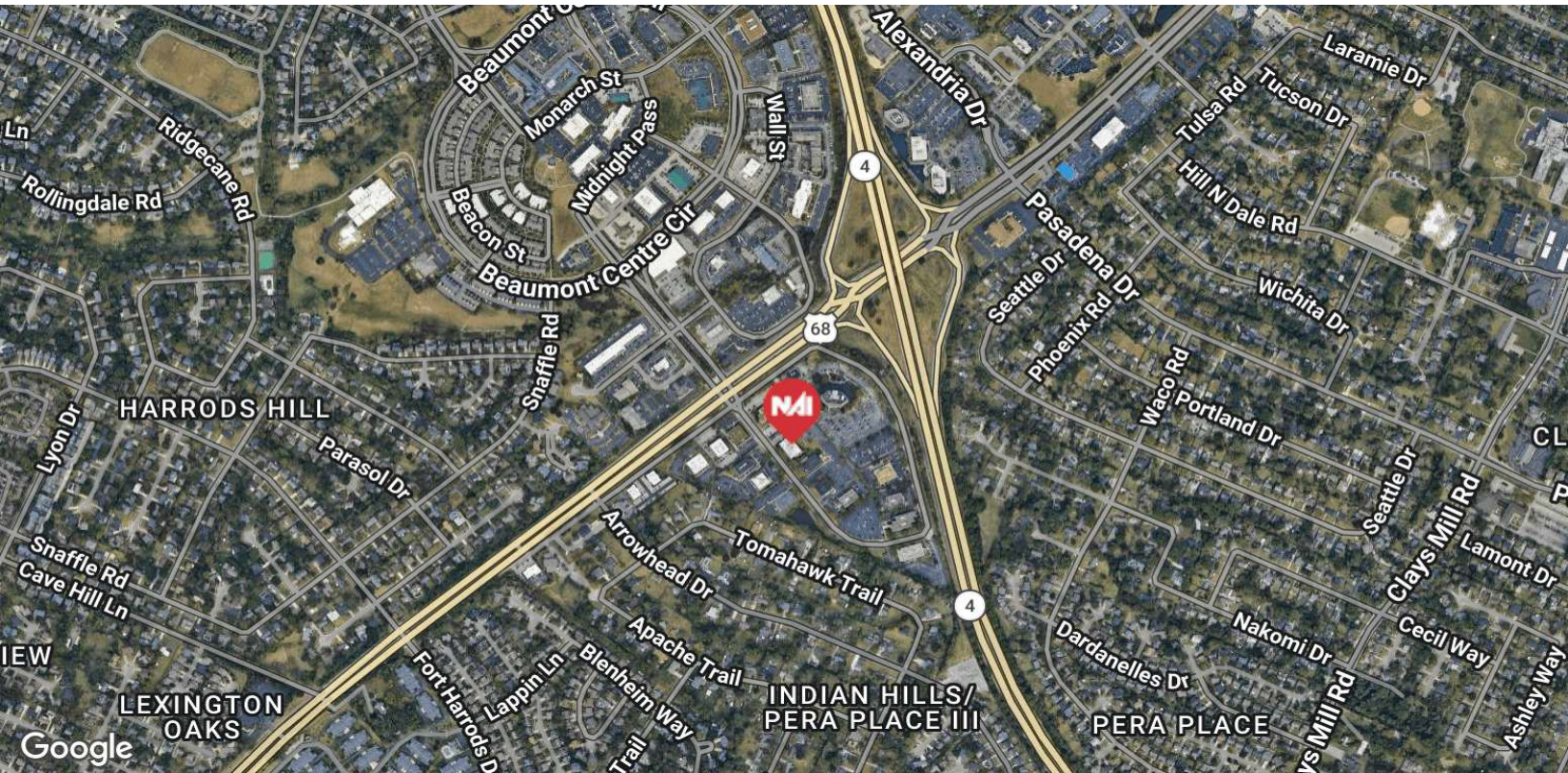
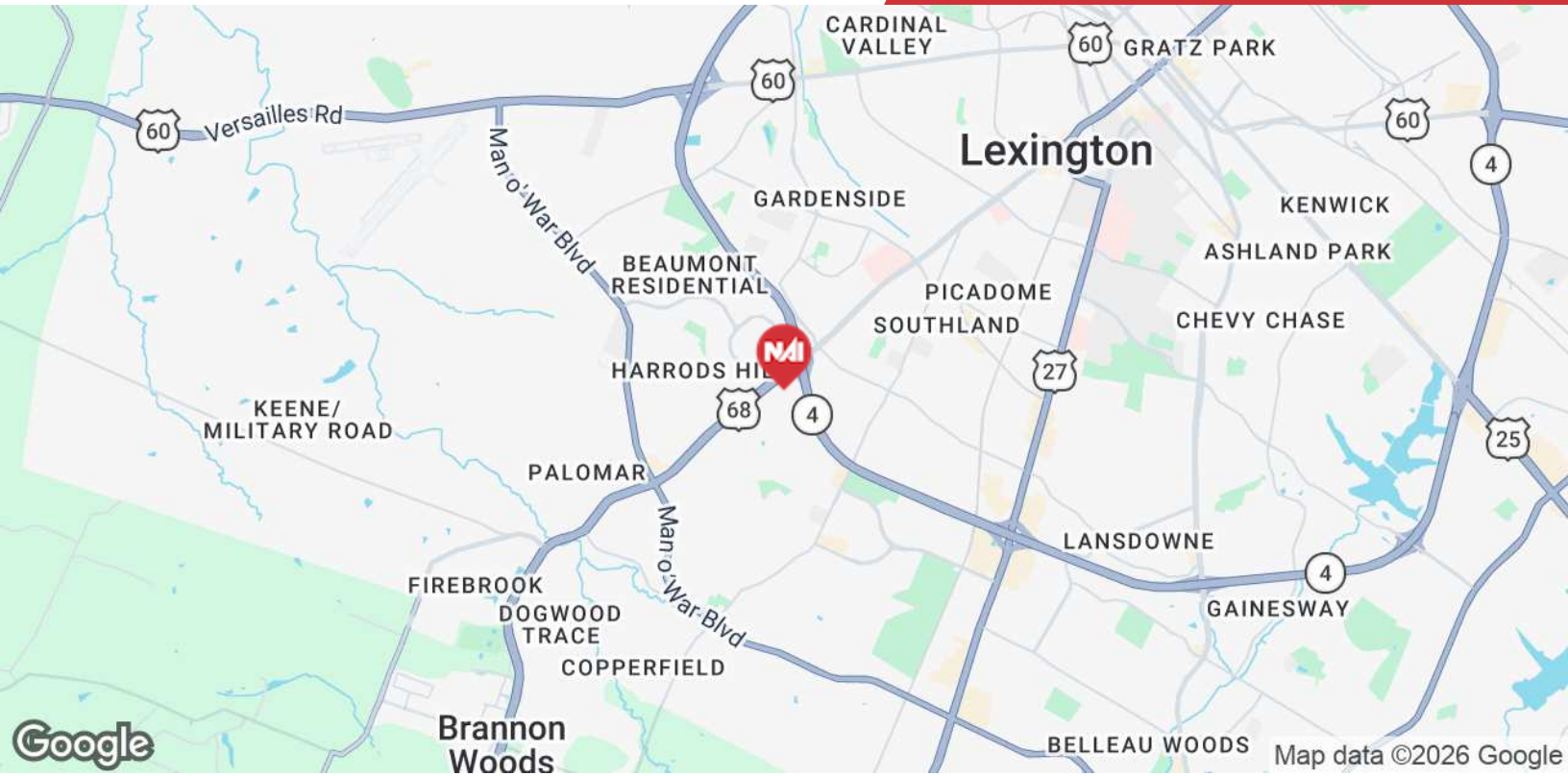

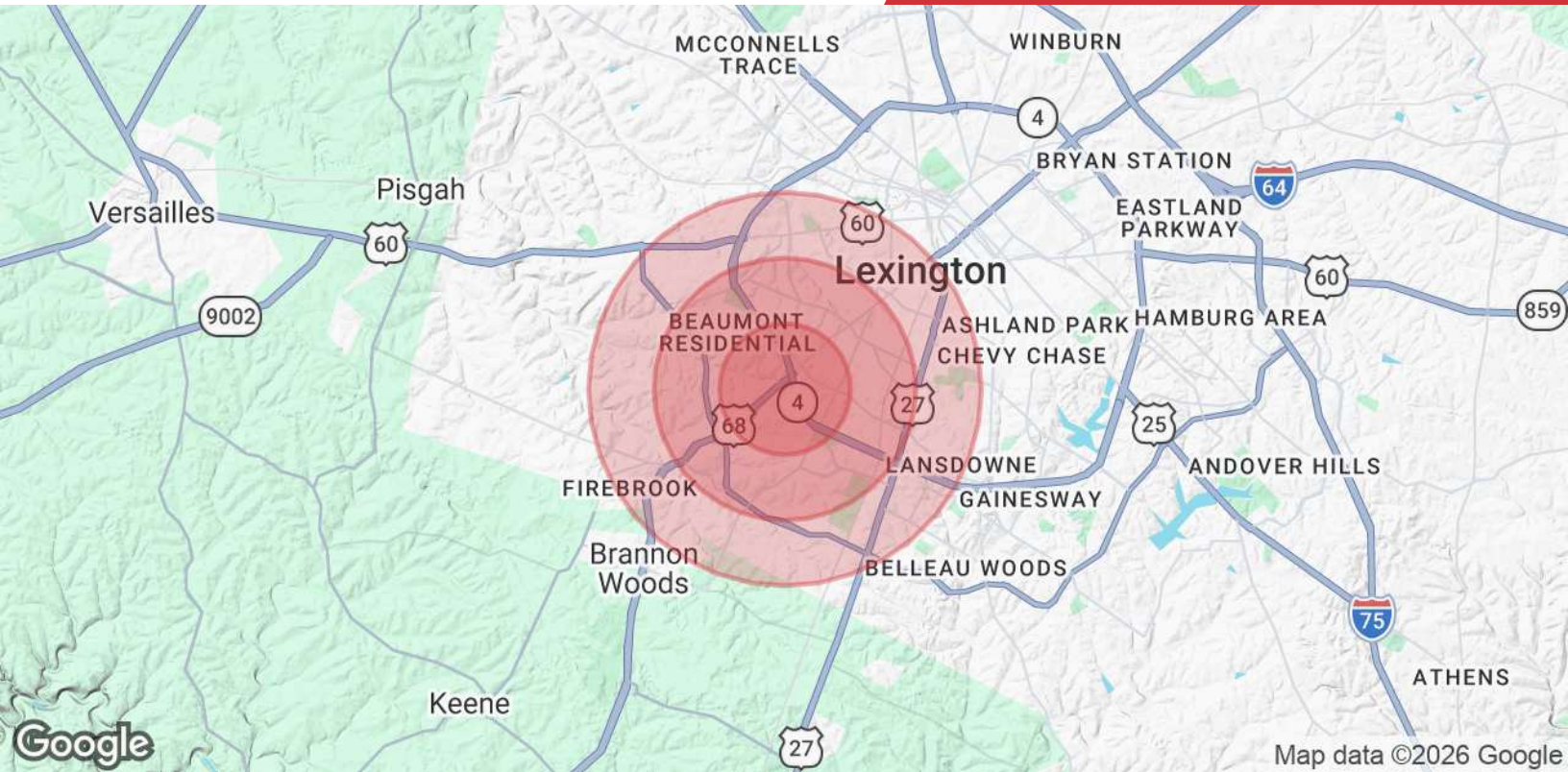

	1 Mile	2 Miles	3 Miles
Population			
Total Population	11,317	36,764	86,136
Average Age	44.9	43.5	38.0
Average Age (Male)	44.1	42.3	37.0
Average Age (Female)	47.6	45.4	39.3
Households & Income			
Total Households	5,041	16,314	37,924
# of Persons per HH	2.2	2.3	2.3
Average HH Income	\$126,905	\$118,588	\$99,421
Average House Value	\$330,679	\$314,324	\$319,468

2025 American Community Survey (ACS)